

COPY NOTICE
The drawing is the property of the above named Professional and is not to be used for any purpose other than the specific project and site named herein, and cannot be reproduced or transmitted in any form or by any means without the express written permission from the Professional.

ISSUE REVISION RECORD	DATE	DESCRIPTION
05-31-2018	INITIAL PERMIT SET	
10-25-2018	CITY COMMENTS	
11-05-2018	CITY COMMENTS	

LEGEND

- BOUNDARY LINE
- CF CONSTRUCTION FENCE
- TREE PROTECTION FENCE
- EXISTING SANITARY SEWER PIPE
- EXISTING STORM PIPE
- EXISTING 6 INCH CURB
- EXISTING SANITARY SEWER STRUCTURE
- PAVEMENT REMOVAL
- EXISTING TO BE REMOVED
- PAVEMENT/CURB REMOVAL BY HAND
- EXISTING SHRUBS TO BE REMOVED
- MILL ASPHALT PER CITY DETAIL SR-6 (SHEET C-7.2)

MANATEE AVENUE WEST

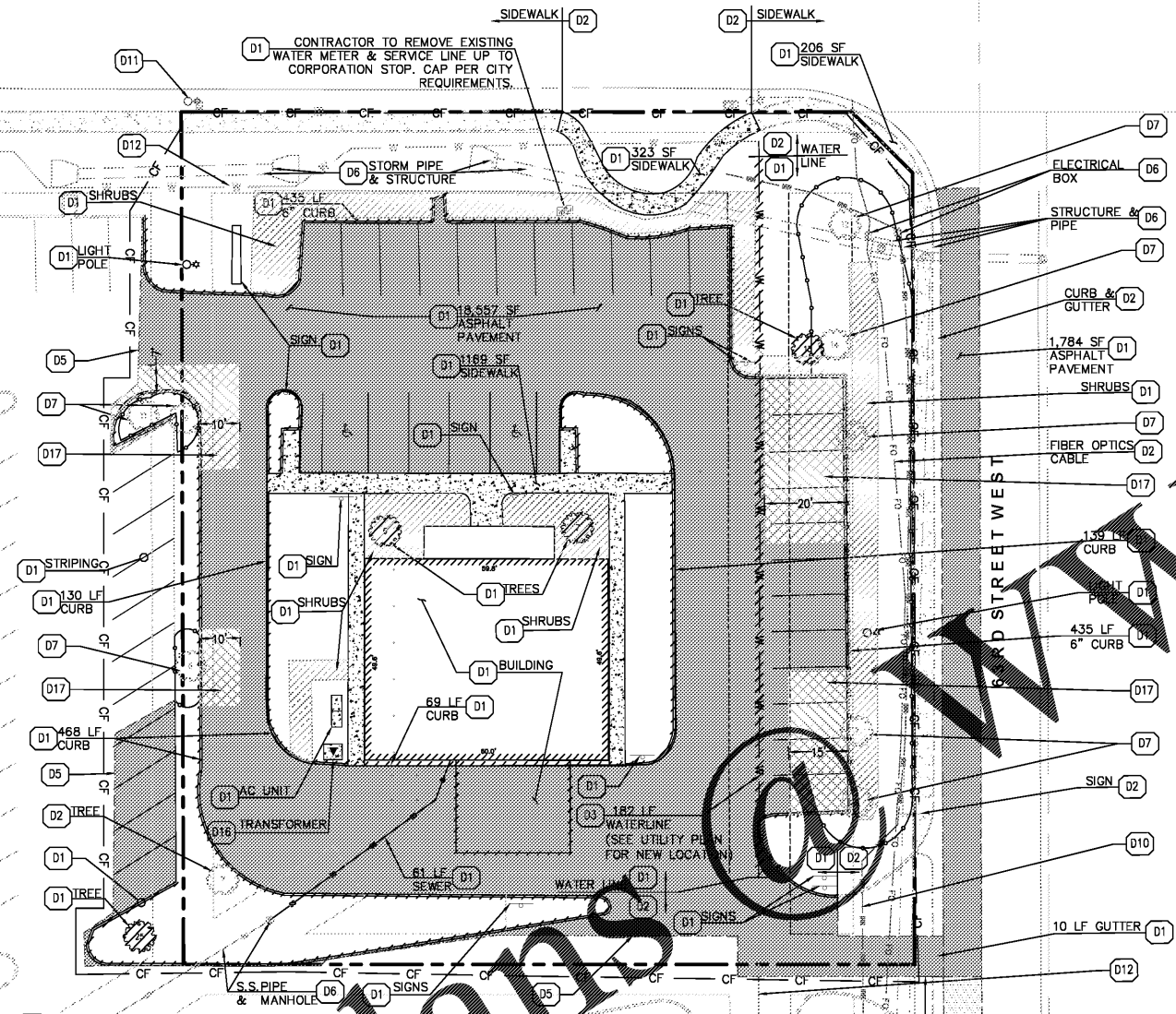

ELECTRICAL & TELEPHONE DEMOLITION NOTES:

- EXISTING UNDERGROUND PRIMARY ELECTRICAL SERVICE AND TRANSFORMER TO BE REMOVED BY UTILITY BACK TO RIGHT OF WAY. UTILITY TO RE-SPACE EXISTING CABLE FOR CONTINUED SERVICE TO ADJACENT CONDOMINIUMS. PLEASE ALLOW SUFFICIENT TIME FOR UTILITY COMPANY TO SCHEDULE AND COMPLETE THIS WORK.
- EXISTING TELEPHONE TERMINAL AND CABLE TO BE REMOVED BY UTILITY BACK TO RIGHT OF WAY. PLEASE ALLOW SUFFICIENT TIME FOR UTILITY COMPANY TO SCHEDULE AND COMPLETE THIS WORK.

GENERAL DEMOLITION NOTES:

- ANY DEMOLITION IS TO BE PERFORMED IN STRICT CONFORMANCE WITH ALL APPLICABLE CITY, COUNTY AND STATE, AND/OR GOVERNING BODY'S STANDARDS.
- THE DEMOLITION PLAN SHALL BE DONE IN CONJUNCTION WITH THE GEOTECHNICAL INVESTIGATION REPORT.
- EROSION AND SEDIMENT CONTROL MEASUREMENTS SHALL BE MAINTAINED AT ALL TIMES DURING DEMOLITION.
- THE PURPOSE OF THIS DRAWING IS TO CONVEY THE OVERALL SCOPE OF WORK AND IT IS NOT INTENDED TO COVER ALL DETAILS OR SPECIFICATIONS REQUIRED TO COMPLY WITH GENERALLY ACCEPTED DEMOLITION PRACTICES. CONTRACTOR SHALL THOROUGHLY FAMILIARIZE HIMSELF WITH THE SITE, SCOPE OF WORK, AND ALL EXISTING CONDITIONS AT THE JOB SITE PRIOR TO BIDDING AND COMMENCING THE WORK. THE DEMOLITION CONTRACTOR SHALL BE SOLELY RESPONSIBLE FOR MEANS, METHODS, TECHNIQUES, OR PROCEDURES USED TO COMPLETE THE WORK IN ACCORDANCE WITH THE CONSTRUCTION DOCUMENTS AND IS LIABLE FOR THE SAFETY OF THE PUBLIC OR CONTRACTOR'S EMPLOYEES DURING THE COURSE OF THE PROJECT.
- THE DEMOLITION PLAN IS INTENDED TO SHOW REMOVAL OF KNOWN SITE FEATURES AND UTILITIES AS SHOWN ON THE SURVEY. THERE MAY BE OTHER SITE FEATURES, UTILITIES, STRUCTURES, AND MISCELLANEOUS ITEMS BOTH BURIED AND ABOVE GROUND THAT ARE WITHIN THE LIMITS OF WORK THAT MAY NEED TO BE REMOVED FOR THE PROPOSED PROJECT THAT ARE NOT SHOWN HEREON. THE CONTRACTOR IS RESPONSIBLE FOR THE REMOVAL OF SUCH ITEMS AT NO ADDITIONAL COST TO THE OWNER.
- THE CONTRACTOR SHALL CONTACT RESPECTIVE UTILITY COMPANIES PRIOR TO DEMOLITION TO COORDINATE DISCONNECTION AND REMOVAL OF EXISTING UTILITIES WITHIN THE AREA OF WORK.
- THE CONTRACTOR SHALL BE SOLELY RESPONSIBLE FOR ANY DAMAGE TO EXISTING UTILITIES THAT ARE INTENDED TO CONTINUE TO PROVIDE SERVICE WHETHER THESE UTILITIES ARE SHOWN ON THE PLAN OR NOT.
- UPON DISCOVERY OF ANY UNDERGROUND TANKS, CONTRACTOR SHALL IMMEDIATELY NOTIFY THE OWNER'S REPRESENTATIVE. NO REMOVAL OF TANKS SHALL OCCUR UNTIL AUTHORIZED BY OWNER.
- DEBRIS SHALL NOT BE BURIED ON THE SUBJECT SITE. ALL UNSUITABLE MATERIAL AND DEBRIS SHALL BE REMOVED FROM THE SITE AND DISPOSED OF IN ACCORDANCE WITH ALL CITY, STATE, AND FEDERAL LAWS AND ORDINANCES.
- ALL MATERIAL EXCEPT THAT BELONGING TO A PUBLIC UTILITY COMPANY OR DENOTED FOR SALVAGE, SHALL BECOME PROPERTY OF THE CONTRACTOR. THE CONTRACTOR SHALL NOTIFY THE OWNER OF WATER, ELECTRIC, OR GAS METERS WHEN THE METERS ARE READY FOR REMOVAL, AND THE CONTRACTOR SHALL BE RESPONSIBLE FOR DISCONNECTING ALL UTILITIES IN COMPLIANCE WITH LOCAL REQUIREMENTS.
- AS SOON AS DEMOLITION WORK HAS BEEN COMPLETED, THE FINAL GRADE OF BACKFILL IN DEMOLITION AREAS SHALL BE COMPACTED PER THE GEOTECHNICAL REPORT TO PRESENT A NEAT, WELL DRAINED APPEARANCE, AND TO PREVENT WATER FROM DRAINING UNNECESSARILY ONTO ADJACENT PROPERTIES. CONTRACTOR SHALL GRADE SITE TO EXISTING STORM DRAINAGE SYSTEM TO REMAIN ON SITE.
- EXISTING TREES TO REMAIN SHOULD BE PROTECTED FROM DAMAGE DURING DEMOLITION AND CONSTRUCTION.
- THE USE OF EXPLOSIVES SHALL NOT BE PERMITTED.
- EXISTING TELEPHONE SWITCH TO BE REMOVED BY UTILITY COMPANY.
- CONTRACTOR SHALL DEMOLISH EXISTING SHRUBS UNLESS OTHERWISE NOTED.

DEMOLITION KEY NOTES

- D1 EXISTING TO BE REMOVED
- D2 EXISTING TO REMAIN
- D3 EXISTING TO BE RELOCATED
- D5 LIMITS OF SAWCUT AND FULL DEPTH PAVEMENT REMOVAL
- D6 EXISTING STRUCTURE TO BE PROTECTED DURING DEMOLITION AND CONSTRUCTION PHASES.
- D7 EXISTING TREE(S) TO BE PROTECTED
- D10 EXISTING IRRIGATION CABLES TO REMAIN. CONTRACTOR TO ENSURE NO INTERRUPTION TO SHOPPING CENTER IRRIGATION SYSTEM. REROUTE WIRING TO MAINTAIN SERVICE.
- D11 EXISTING LIGHT POLE TO REMAIN. CONTRACTOR TO ENSURE NO INTERRUPTION TO SHOPPING CENTER SITE LIGHTING SYSTEM IS INTERRUPTED DURING CONSTRUCTION.
- D12 EXISTING WATER LINE TO REMAIN. CONTRACTOR TO ENSURE NO INTERRUPTION TO WATER SERVICE TO ADJACENT PROPERTY OWNERS DURING CONSTRUCTION.
- D16 EXISTING TRANSFORMER TO BE REMOVED BY UTILITY COMPANY.
- D17 DEMOLITION TO PAVEMENT AND CURB SHALL BE DONE BY HAND IN ORDER TO PREVENT DAMAGE TO THE EXISTING TREE AND THE ROOT ZONE AREA.

48 HOURS BEFORE YOU DIG
CALL SUNSHINE
1-800-432-4770
IT'S THE LAW IN FLORIDA



GRAPHIC SCALE

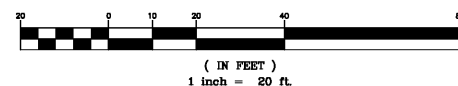

Order Plans

PROFESSIONAL SEAL

PROFESSIONAL IN CHARGE
JOHN NOURZAD
PROJECT MANAGER
WILLIAM LOTZ
QUALITY CONTROL
CHARLES J. BEADLES
DRAWN BY
TREVOR ANDREY

PROJECT
PANERA BREAD

ADDRESS
BRADENTON FLORIDA
6351 MANATEE AVENUE WEST

CLIENT



PROJECT NUMBER
201807580

SHEET TITLE
DEMOLITION PLAN

SHEET NUMBER
C-2.0