

SURFACE SKIMMER DETAIL
N.T.S.

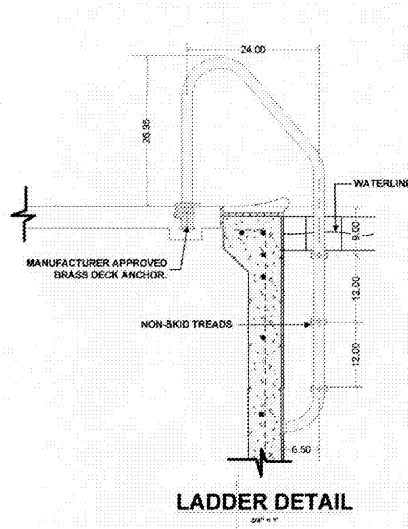

LADDER DETAIL
24" x 17"

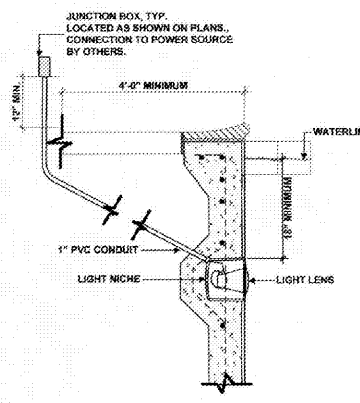

LIGHT DETAIL
3/4" x 1' - 0"

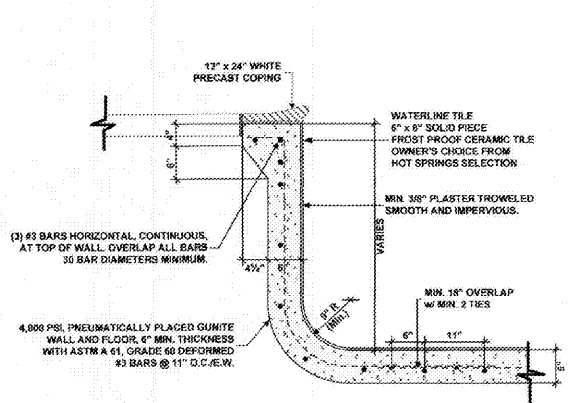

BOND BEAM DETAIL
3/4" x 1' - 0"

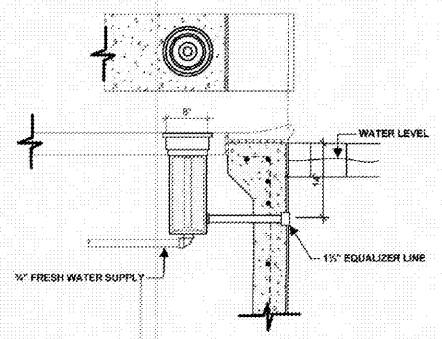

AUTOMATIC FILL DETAIL
N.T.S.

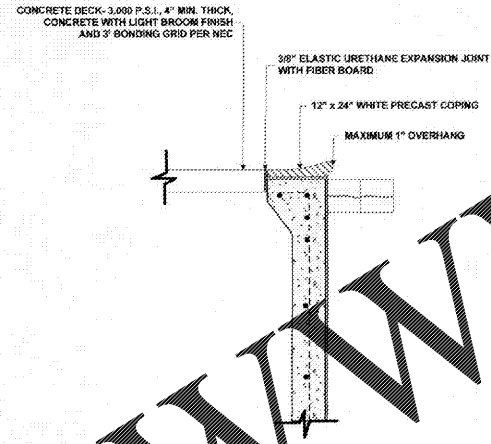

DECK DETAIL

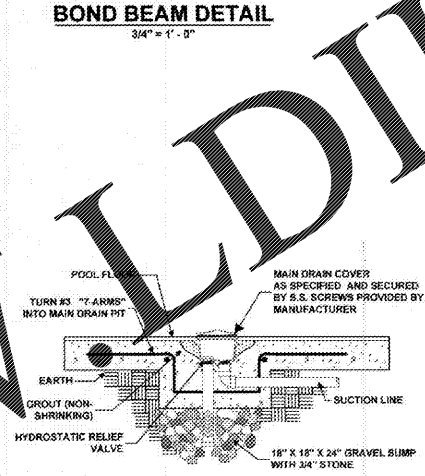

MAIN DRAIN DETAIL
N.T.S.

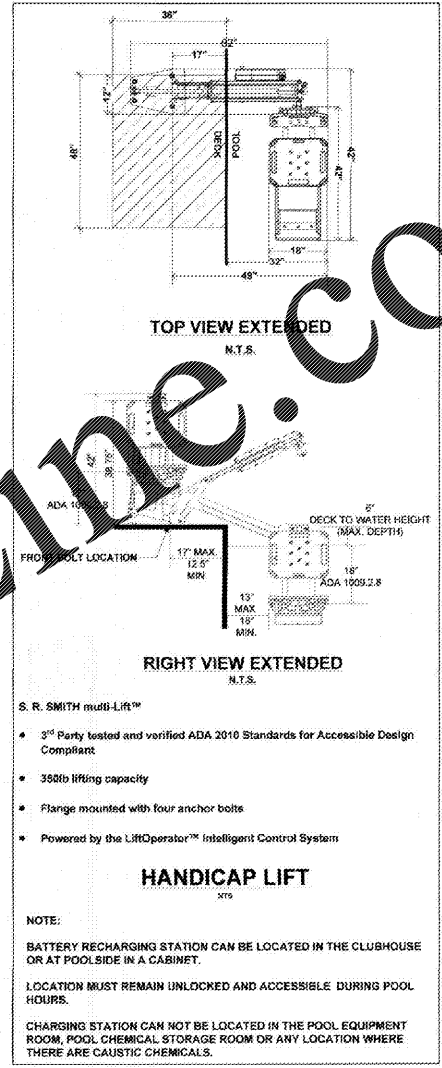

HANDICAP LIFT
N.T.S.

S. R. SMITH multi-Lift™

- 3rd Party tested and verified ADA 2010 Standards for Accessible Design Compliant
- 350lb lifting capacity
- Flange mounted with four anchor bolts
- Powered by the LiftOperator™ Intelligent Control System

NOTE:

BATTERY RECHARGING STATION CAN BE LOCATED IN THE CLUBHOUSE OR AT POOLSIDE IN A CABINET.

LOCATION MUST REMAIN UNLOCKED AND ACCESSIBLE DURING POOL HOURS.

CHARGING STATION CAN NOT BE LOCATED IN THE POOL EQUIPMENT ROOM, POOL CHEMICAL STORAGE ROOM OR ANY LOCATION WHERE THERE ARE CAUSTIC CHEMICALS.

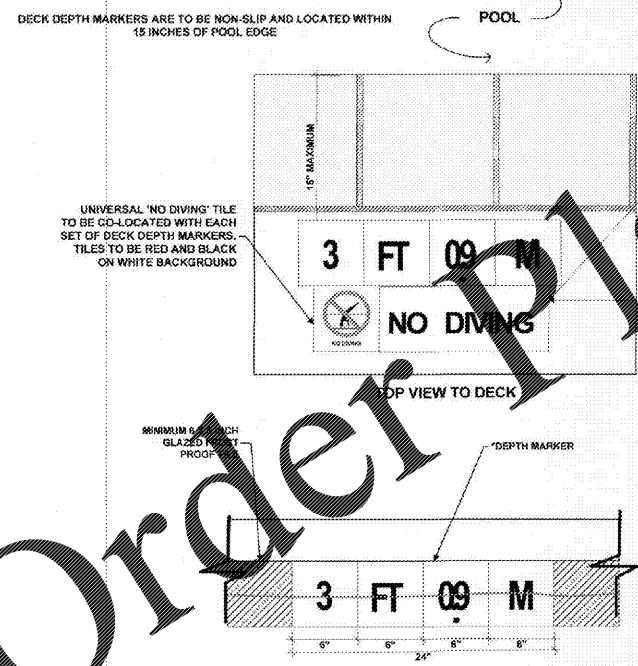

DEPTH MARKER DETAIL
N.T.S.

OWNER'S REQUEST: "NO DIVING" TILE TO BE INSTALLED WITHIN 15" OF POOL EDGE. SEE DETAIL.

"NO DIVING" TILE IN POOL DECK. 4" LETTERING MINIMUM SPACED NO GREATER THAN 3/8" APART. TILES TO BE BLACK NUMERALS AND LETTERS ON WHITE BACKGROUND AS REQUIRED BY WAKE COUNTY HEALTH DEPT.

*DEPTH MARKER LETTERING AND NUMERALS SHALL BE BLACK 4" MINIMUM HEIGHT ON WHITE BACKGROUND

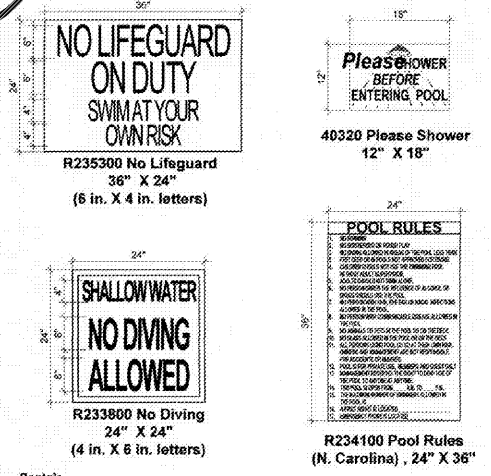

Pentair Pool & Spa Signs
Rainbow's commercial quality pool and spa signs meet specifications and safety requirements of state, county and city health codes. Each sign is constructed of weather-resistant, high impact plastic, screened with permanent inks and finished with brass grommets for easy, secure hanging.

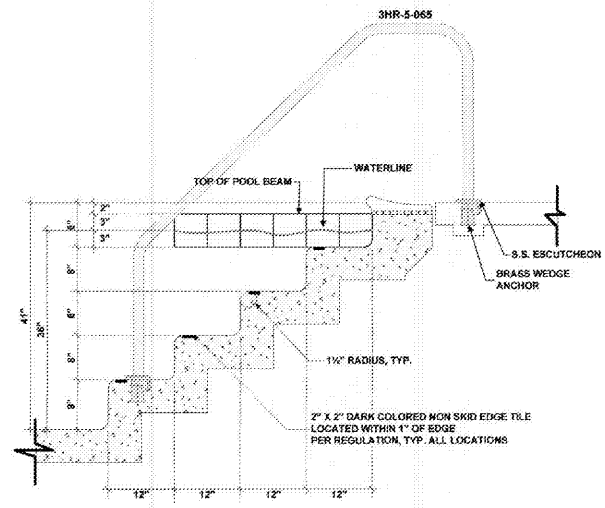

POOL STEP SECTION
3/4" - 1' - 0"

NOTE:

PLANS ARE FOR POOL CONSTRUCTION ONLY.

ALL BUILDING, EQUIPMENT & CHEMICAL ROOM NOTES AND SPECIFICATIONS ARE FOR COORDINATION AND INFORMATION ONLY.

ELECTRICAL DATA IS FOR COORDINATION AND INFORMATION ONLY

IT IS THE RESPONSIBILITY OF OTHERS TO PROVIDE ANY REQUIRED REVISED CONSTRUCTION DRAWINGS INCLUDING BUT NOT LIMITED TO PLUMBING, MECHANICAL AND ELECTRICAL CHANGES NECESSARY FOR POOL PERMIT AND INSTALLATION.

mc millan
pazdan
smith
STRUCTURE

**HOT SPRINGS
POOLS & SPAS**
SINCE 1939

275 HICKORY ROAD
DURHAM, NC 27707 (919) 486-2000 (919) 486-2000

WINDSOR AUGHTRY
HOME2 ASHEVILLE
390 AIRPORT ROAD
ARDEN, NC 28704

SHEET ISSUE:
07/30/18
FOR CONSTRUCTION

REVISIONS		
NUMBER	DESCRIPTION	DATE

PRINCIPAL IN CHARGE:
PROJECT ARCHITECT:
DRAWN BY:

SHEET TITLE:
DETAILS

PROJ. NO.
SP - 5

Order Plans @