

RCP LEGEND

- WALL MOUNTED LIGHT FIXTURE. SEE INT DESIGN DWGS
- R1 RECESSED DOWNLIGHT FIXTURE. SEE ELECT DWGS
- R2 RECESSED WALL WASH LIGHT FIXTURE. SEE ELECT DWGS
- ⊗ R3 RECESSED LIGHT FIXTURE W/ LENS UL WET LABELED. SEE ELECT DWGS
- R4 SMALL RECESSED DOWNLIGHT (HALOGEN LAMP) W/ NARROW BEAM SPREAD. SEE ELECT DWGS
- ⊗ EXTERIOR RECESSED LIGHT FIXTURE. SEE ELECT DWGS
- INTERIOR WALL SCONCE. SEE INT DES DWGS
- ⊗ S-1 CEILING WASH WALL SCONCE. SEE ELECT DWGS
- ⊗ S-2 EXTERIOR WALL SCONCE. SEE ELECT DWGS
- ⊗ S-3 EXTERIOR WALL SCONCE - UP DOWN LIGHTS. SEE ELECT DWGS
- HUNG & SUSPENDED LIGHT FIXTURE. SEE INTERIOR DESIGN DRAWINGS
- DECORATIVE SUSPENDED LIGHT FIXTURE. SEE INTERIOR DESIGN DWGS
- SQUARE SURFACE MOUNT LIGHT FIXTURE. SEE ELECT DWGS
- T-1 2X2 LAY-IN FIXTURE. SEE ELECT DWGS
- T-2 2X4 LAY-IN FIXTURE. SEE ELECT DWGS
- T-3 1X4 SUSPENDED LIGHT FIXTURE. SEE ELECT DWGS
- ⋯ C-1 RECESSED COVE FIXTURE. SEE ELECT DWGS
- G-1 EXTERIOR HEAVY DUTY LIGHT STRING. SEE ELECT DWGS
- IN-GROUND UP-LIGHT. SEE ELECT DWGS
- 5/8" GYP BOARD CEILING ON METAL STUDS
- 2X2 ACOUSTICAL CEILING TILE PERFORATED MINERAL FIBER UNO
- 2X4 ACOUSTICAL CEILING TILES WASHABLE & MOISTURE RESISTANT. MUST BE SUITABLE FOR FOOD PREPARATION AREAS IN FOOD PREP ISLS. NON PERFORATED PLASTIC VINYL FACED MINERAL FIBER
- ARMSTRONG METALWORKS LINEAR EXTERIOR GRADE SUSPENDED CEILING PANELS- 6" WIDTH

BLDG MATERIALS LEGEND

- ARRISCRAFT FULL BED STONE PRODUCT: SHAND STONE COLOR: DRIFTWOOD
- EFS COLOR 1: BENJAMIN MOORE BARREN PLAIN 2111-60
- EFS COLOR 2: BENJAMIN MOORE STARDUST 2128-40
- EFS COLOR 3: YELLOW HIGHLIGHTER 2021-40
- EFS COLOR 4: BENJAMIN MOORE CHANTILLY LACE 2121-70
- EFS COLOR 4: BENJAMIN MOORE GENTLEMEN'S GRAY 2052-20

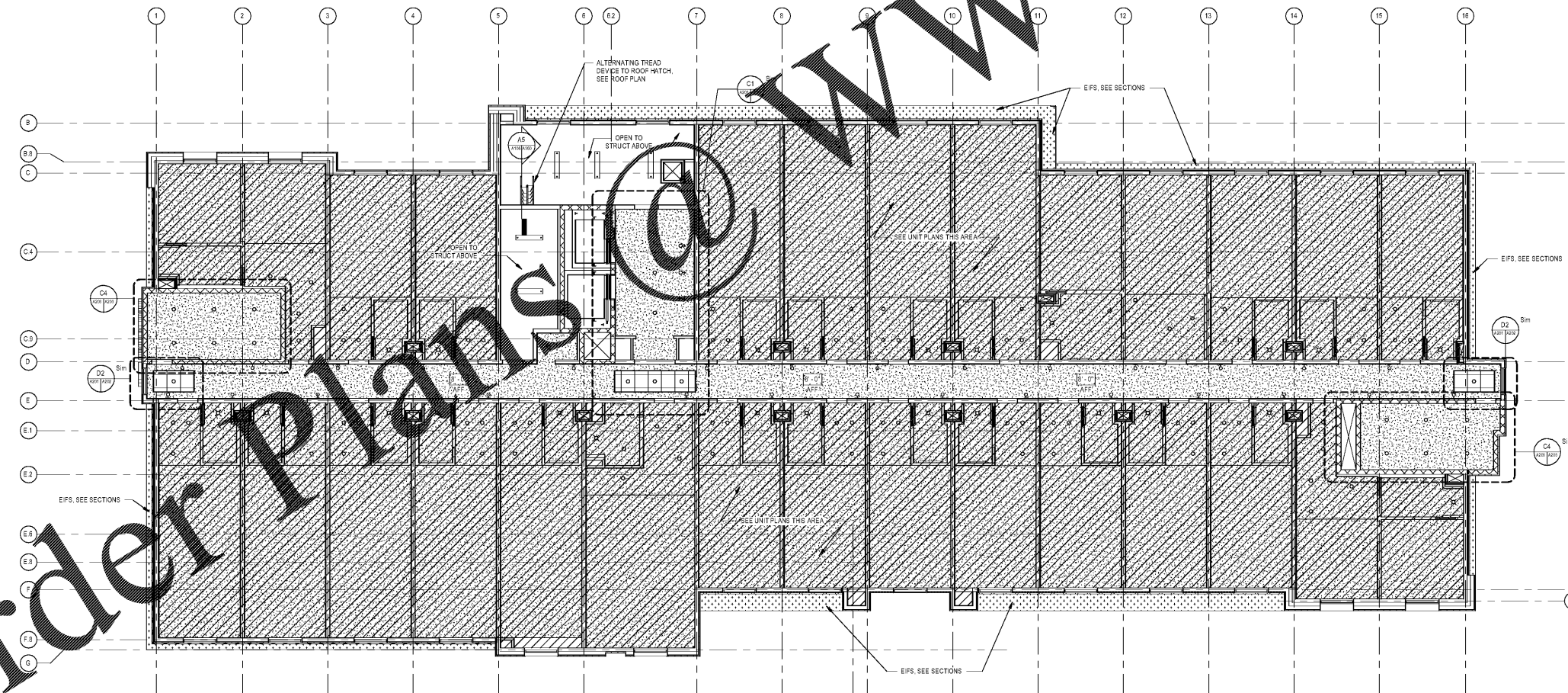
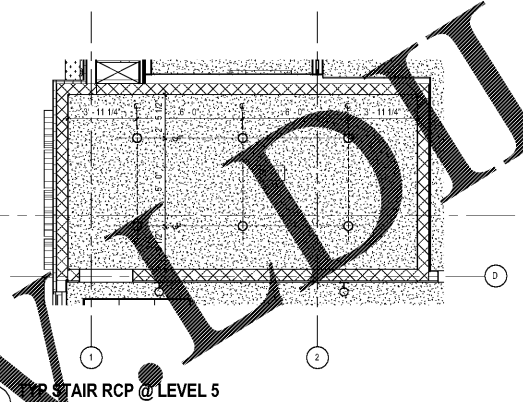

A1 LEVEL 5
1/8" = 1'-0"

mcmillan pazdan smith
ARCHITECTURE

CONSULTANT LOG

MASS

WINDSOR AUGHTRY
HOME2 ASHEVILLE
380 AIRPORT RD.
ASHEVILLE, NC 28704

SHEET ISSUE
07/30/18
FOR CONSTRUCTION

Revisions		
Number	Description	Date

PRINCIPAL IN CHARGE: BZ
PROJECT ARCHITECT: BZ
DRAWN BY: BT

SHEET TITLE:
LEVEL 5 RCP

SHEET NO. PROJ. NO.
A203 017378.00