

LIFE SAFETY NOTES

1. A FIRE DEPARTMENT KEY BOX (KNOX BOX) SHALL BE INSTALLED ON THE FRONT SIDE OF THE BUILDING NEAR THE FRONT DOOR.
2. ELEVATOR KEY BOXES (KNOX BOX) SHALL BE INSTALLED AT THE ELEVATORS.
3. ALL FIRE EXTINGUISHERS SHALL BE MOUNTED ON THE WALL NO MORE THAN 4' AFF.
4. AN APPROVED SIGN SHALL BE INSTALLED AT THE EXTERIOR EXIT DOOR FOR EACH STAR IDENTIFYING THE DOOR AS A STAR EGRESS DOOR.
5. EMERGENCY EVACUATION PLANS SHALL BE INSTALLED IN EACH HOTEL ROOM AND STRATEGICALLY THROUGHOUT THE HOTEL.
6. THE FRONT OUTSIDE DRIVE UP CANOPY SHALL BE LABELED WITH THE HEIGHT RESTRICTIONS ON BOTH SIDES.

LIFE SAFETY LEGEND

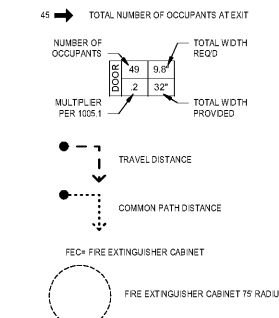

FIRE RATED WALL LEGEND

- *LEGEND IS MEANT TO BE VIEWED IN COLOR. RATINGS MAY NOT BE INDICATED CLEARLY IF PRINTED IN BLACK AND WHITE.
- NON RATED WALL
 - 1 HOUR RATED FIRE PARTITION (RATING REQ'D FOR STRUCTURAL PROTECTION OF WALL ONLY)
 - 1 HOUR RATED FIRE BARRIER-CONTINUOUS FROM SLAB TO UNDERSIDE OF ROOF SHEATHING FLOOR ABOVE (ALL ROOMS WITH A FIRE BARRIER WALLS TO HAVE 1 HOUR RATED FLOOR/CEILING ASSEMBLY PER U.L. JB7)
 - 2 HOUR RATED CMU SHAFT-CONTINUOUS FROM SLAB TO UNDERSIDE OF ROOF SHEATHING ABOVE. SEE SECTIONS
 - 2 HOUR RATED FIRE BARRIER (ALL ROOMS CONTAINED WITH FIRE BARRIER WALLS WITH 1 HOUR RATED FLOOR/CEILING ASSEMBLY PER U.L. JB7)
- *ALL STRUCTURAL BEAMS AND STRUCTURAL FLOOR SYSTEMS SUPPORTING RATED PARTITIONS TO BE LABELED THE SAME AS THE BEAMS AND COLUMNS (WALLS AND PARTITIONS).
- *ALL STRUCTURAL FLOOR SYSTEMS AND STRUCTURAL BEAMS SUPPORTING 2-HR RATED PARTITIONS TO BE LABELED THE SAME AS THE BEAMS AND COLUMNS (WALLS AND PARTITIONS).
- *ALL LOAD BEARING EXTERIOR WALLS TO BE LABELED PER U.L. V404 FOR STRUCTURAL PROTECTION LOCATIONS OF LOAD BEARING EXTERIOR WALLS INDICATED ON THIS PLAN ARE ASSUMED. GC SHALL CONFIRM LOCATIONS OF ALL STRUCTURAL EXTERIOR WALLS WITH STRUCTURAL DRAWINGS PRIOR TO CONSTRUCTION.

- 15 SFI/PERSON
- 50 SFI/PERSON
- 100 SFI/PERSON
- 200 SFI/PERSON
- 300 SFI/PERSON
- Calculating...

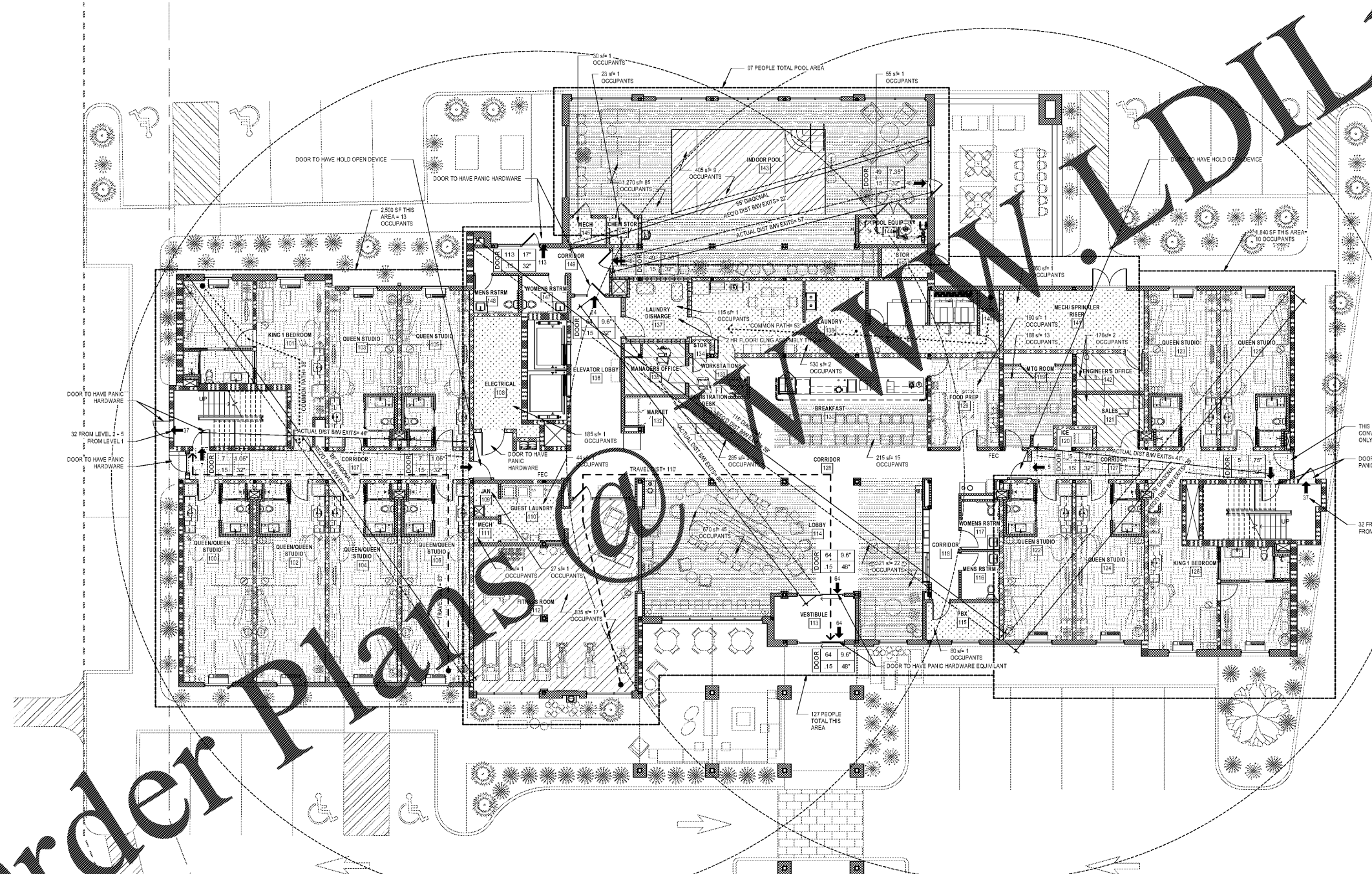
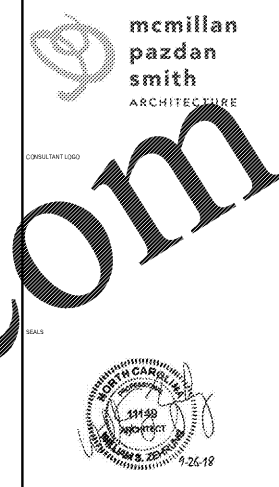

Order Plans @
LEVEL 1 LIFE SAFETY PLAN
 1/8" = 1'-0"

WINDSOR AUGHTRY
 HOME2 ASHEVILLE
 380 AIRPORT RD.
 ARDEN, NC 28704

SHEET ISSUE
 07/30/18
 FOR CONSTRUCTION

Revisions		
Number	Description	Date

PRINCIPAL IN CHARGE: BZ
 PROJECT ARCHITECT: BZ
 DRAWN BY: BT
 SHEET TITLE:
**LIFE SAFETY PLAN-
 LEVEL 1**

SHEET NO. PROJ. NO.
 017378.00

G110