

Order Plans @ WWW.LDILine.com

DEMOLITION NOTES		
1 REMOVE PARTITION COMPLETE.	12 REMOVE PORTION OF EXISTING CONCRETE/ASPHALT COMPLETE FOR INSTALLATION OF RAMP AND LANDING IN NEW WORK. REFER TO STRUCTURAL DWGS.	21 REMOVE EXIST CEILING HUNG HEATERS COMPLETE.
2 REMOVE PORTION OF EXISTING WALL COMPLETE.	13 REMOVE EXISTING TOILET FIXTURES AND ACCESSORIES COMPLETE. FOR REMOVAL OF PLUMBING FIXTURES SEE PLUMBING SHEETS.	22 REMOVE EXISTING LADDER COMPLETE.
3 REMOVE DOOR AND FRAME COMPLETE.	14 REMOVE EXISTING MOP SINK COMPLETE. FOR REMOVAL OF PLUMBING FIXTURES SEE PLUMBING SHEETS.	23 REMOVE EXISTING DRINKING FOUNTAIN COMPLETE. FOR REMOVAL OF PLUMBING FIXTURES SEE PLUMBING SHEETS.
4 REMOVE EXISTING WALL FIXTURES AND FINISHES COMPLETE.	15 REMOVE EXISTING WATER HEATER COMPLETE. FOR REMOVAL OF PLUMBING FIXTURES SEE PLUMBING SHEETS.	24 REMOVE EXISTING COLUMN SURROUND COMPLETE.
5 FLOORING CONTRACTOR (TENANT HIRED) SHALL REMOVE EXISTING VCT FLOORING COMPLETE. GC SHALL NOT INCLUDE IN BID.	16 REMOVE, CAP, OR FILL EXISTING DRAIN COMPLETE. FOR MODIFICATION OF EXISTING PLUMBING SEE PLUMBING SHEETS.	25 REMOVE EXISTING SOFFIT COMPLETE.
6 FLOORING CONTRACTOR (TENANT HIRED) SHALL REMOVE EXISTING CERAMIC TILE AND BASE COMPLETE. GC SHALL NOT INCLUDE IN BID.	17 FOR REMOVAL AND/OR RELOCATION OF EXISTING ELECTRICAL PANELS AND TRANSFORMER SEE ELECTRICAL SHEETS.	26 REMOVE EXISTING CONCRETE STAIR AND LANDING COMPLETE.
7 REMOVE EXISTING BASE COMPLETE.	18 REMOVE PORTION OF EXISTING CONCRETE SLAB AS REQUIRED TO TRENCH FLOOR FOR RELOCATION OF PLUMBING FIXTURES. CONTRACTOR SHALL INCLUDE IN BID ALL TRENCHING REQUIRED TO EXTEND PLUMBING IN NEW WORK. (CONTRACTOR SHALL AVOID SALES FLOOR IF POSSIBLE.)	27 REMOVE EXISTING HANDRAIL COMPLETE.
8 REMOVE EXISTING ACT AND GRID COMPLETE.	19 REMOVE EXISTING WOOD SHELVING, CABINETS AND FIXTURES COMPLETE.	28 REMOVE EXISTING TOILET PARTITION COMPLETE.
9 REMOVE EXISTING LIGHT FIXTURES COMPLETE.	20 REMOVE EXISTING GWB CEILING COMPLETE.	29 REMOVE EXISTING BALER COMPLETE.
10 REMOVE PORTION OF EXTERIOR MASONRY WALL TO 8" BELOW FINISHED FLOOR AS INDICATED FOR INSTALLATION OF DOOR AND STOREFRONT IN NEW WORK. SOFFIT / CANOPY CEILING TO REMAIN INTACT AND SECURED. REFER TO STRUCTURAL DRAWINGS.		30 REMOVE EXISTING OVER HEAD DOOR STORAGE COMPLETE.
11 REMOVE PORTION OF EXTERIOR MASONRY WALL TO EXISTING SLAB AS INDICATED FOR INSTALLATION OF DOOR IN NEW WORK. REFER TO STRUCTURAL DWGS.		

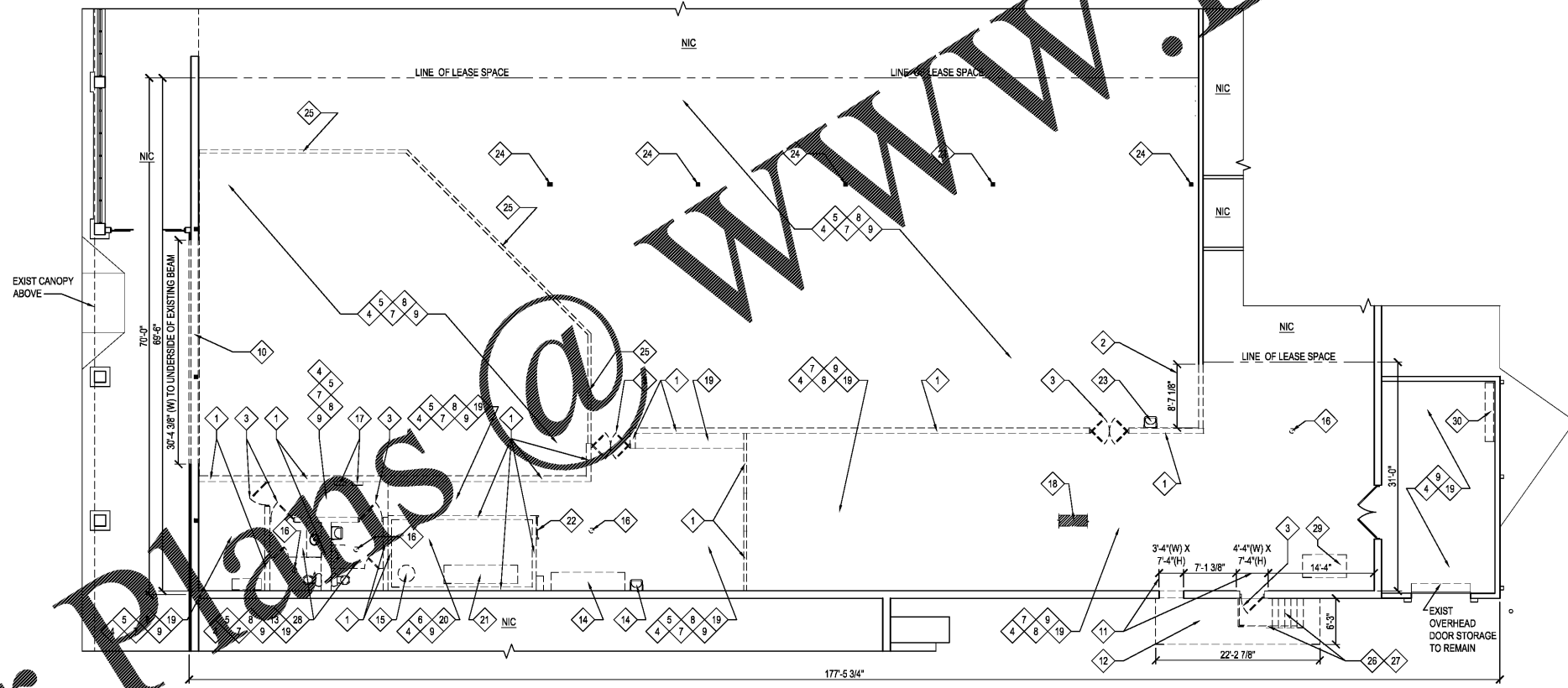

DEMOLITION PLAN  
SCALE: 1/8" = 1'-0"  
NORTH

date		project		design		drawn		checked	
10/10/08	1025.00	RWH	RWH	RWH	DMH				
description		by		date		mark		revisions	

**RRMM ARCHITECTS, P.C.**  
Robert S Berz, Jr, Architect  
Duane M Harver, Architect  
1317 Executive Blvd, Suite 200  
Chesapeake, VA 23320  
(757)622-2828 / fax (757)622-6883

**DOLLAR TREE**  
FORMER HARVEY'S  
FORT VALLEY, GEORGIA  
DEMOLITION PLAN

project drawing sheet

D1