

- NOTES**  
(THIS SHEET ONLY)
- ① PROVIDE AND INSTALL NEW FUSIBLE DISCONNECT SWITCH (F) 30/2/15. PROVIDE NEW FLEXIBLE CONDUIT WITH WIRING FROM DISCONNECT SWITCH TO UNIT. FIELD VERIFY EXACT VOLTAGE AND PHASE OF EXISTING UNIT PRIOR TO INSTALL OR PURCHASING EQUIPMENT. MAINTAIN ALL EXISTING CIRCUITING.
  - ② PROVIDE AND INSTALL NEW FUSIBLE DISCONNECT SWITCH (F) 30/3/20. PROVIDE NEW FLEXIBLE CONDUIT WITH WIRING FROM DISCONNECT SWITCH TO UNIT. FIELD VERIFY EXACT VOLTAGE AND PHASE OF EXISTING UNIT PRIOR TO INSTALL OR PURCHASING EQUIPMENT. MAINTAIN ALL EXISTING CIRCUITING.
  - ③ PROVIDE AND INSTALL NEW FUSIBLE DISCONNECT SWITCH (F) 30/3/30. PROVIDE NEW FLEXIBLE CONDUIT WITH WIRING FROM DISCONNECT SWITCH TO UNIT. FIELD VERIFY EXACT VOLTAGE AND PHASE OF EXISTING UNIT PRIOR TO INSTALL OR PURCHASING EQUIPMENT. MAINTAIN ALL EXISTING CIRCUITING.
  - ④ PROVIDE AND INSTALL NEW FUSIBLE DISCONNECT SWITCH (F) 30/3/30. PROVIDE NEW FLEXIBLE CONDUIT WITH WIRING FROM DISCONNECT SWITCH TO UNIT. FIELD VERIFY EXACT VOLTAGE AND PHASE OF EXISTING UNIT PRIOR TO INSTALL OR PURCHASING EQUIPMENT. MAINTAIN ALL EXISTING CIRCUITING.
  - ⑤ REFER TO MECHANICAL DRAWINGS FOR DEMOLITION IN THIS AREA.

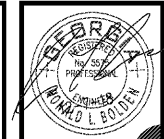

**COPYRIGHT OWNERSHIP**  
This drawing is the property of Foreman Seeley Fountain Architecture and may not be used, copied or revised without expressed written permission.  
© 2018

Revisions:

No.	Description

**HVAC AND ROOFING RENOVATIONS FOR  
BRITT ELEMENTARY SCHOOL**

2503 SKYLAND DRIVE SW  
SNELLVILLE, GEORGIA 30078

Facility Code  
# 3050

**FOREMAN SEELEY FOUNTAIN  
architecture**

3000 Courtyard Lane Drive, Suite 150, Peachtree Corners, Georgia, 30071  
(770) 728-8433  
www.FSFArchitect.com

Sheet Title:  
**ELECTRICAL FLOOR PLAN POWER**

Drawn By: Z.S.G.  
Scale: AS NOTED  
Date: 12/14/2018  
Job No.: 1810  
Sheet No.:

**E4.2**

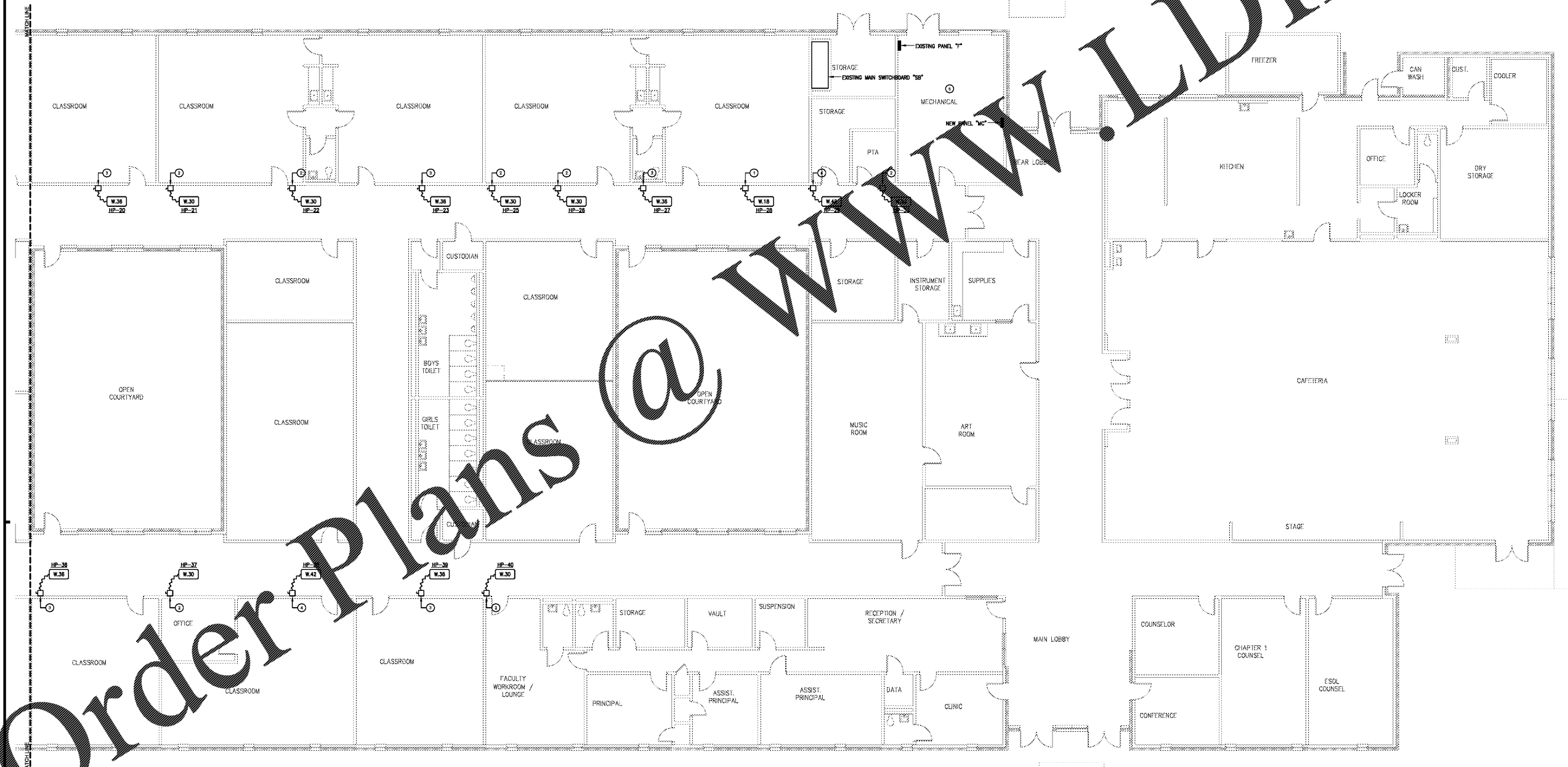

**1 ELECTRICAL PARTIAL FLOOR PLAN - POWER**  
SCALE: 1/8"=1'-0"

FOR PRICING

Order Plans @

WWW.LDILine.com