

- NOTES**
(THIS SHEET ONLY)
- 1 PROVIDE AND INSTALL NEW FUSIBLE DISCONNECT SWITCH (F) 60/3/20. PROVIDE NEW FLEXIBLE CONDUIT WITH WIRING FROM DISCONNECT SWITCH TO UNIT. FIELD VERIFY EXACT VOLTAGE AND PHASE OF EXISTING UNIT PRIOR TO INSTALL OR PURCHASING EQUIPMENT. MAINTAIN ALL EXISTING CIRCUITING.
 - 2 PROVIDE AND INSTALL NEW FUSIBLE DISCONNECT SWITCH (F) 60/3/25. PROVIDE NEW FLEXIBLE CONDUIT WITH WIRING FROM DISCONNECT SWITCH TO UNIT. FIELD VERIFY EXACT VOLTAGE AND PHASE OF EXISTING UNIT PRIOR TO INSTALL OR PURCHASING EQUIPMENT. MAINTAIN ALL EXISTING CIRCUITING.
 - 3 PROVIDE AND INSTALL NEW FUSIBLE DISCONNECT SWITCH (F) 60/3/20. PROVIDE NEW FLEXIBLE CONDUIT WITH WIRING FROM DISCONNECT SWITCH TO UNIT. FIELD VERIFY EXACT VOLTAGE AND PHASE OF EXISTING UNIT PRIOR TO INSTALL OR PURCHASING EQUIPMENT. MAINTAIN ALL EXISTING CIRCUITING.
 - 4 PROVIDE AND INSTALL NEW FUSIBLE DISCONNECT SWITCH (F) 30/3/25. PROVIDE NEW FLEXIBLE CONDUIT WITH WIRING FROM DISCONNECT SWITCH TO UNIT. FIELD VERIFY EXACT VOLTAGE AND PHASE OF EXISTING UNIT PRIOR TO INSTALL OR PURCHASING EQUIPMENT. MAINTAIN ALL EXISTING CIRCUITING.



COPYRIGHT OWNERSHIP
 This drawing is the property of Foreman Seeley Fountain Architecture and may not be used, copied or revised without expressed written permission.
 © 2018

Revisions:

No.	Description

HVAC AND ROOFING RENOVATIONS FOR BRITT ELEMENTARY SCHOOL
 Facility Code # 3050
 2503 SKYLAND DRIVE SW
 SNELLVILLE, GEORGIA 30078

FOREMAN SEELEY FOUNTAIN
 architect
 3000 Courtyard Lane Drive, Suite 150, Peachtree Corners, Georgia, 30071
 (770) 724-8433
 www.FSFarchitect.com

Sheet Title:
ELECTRICAL FLOOR PLAN POWER
 Drawn By: Z.S.G.
 Scale: AS NOTED
 Date: 12/14/2018
 Job No.: 1810
 Sheet No.:

E4.1

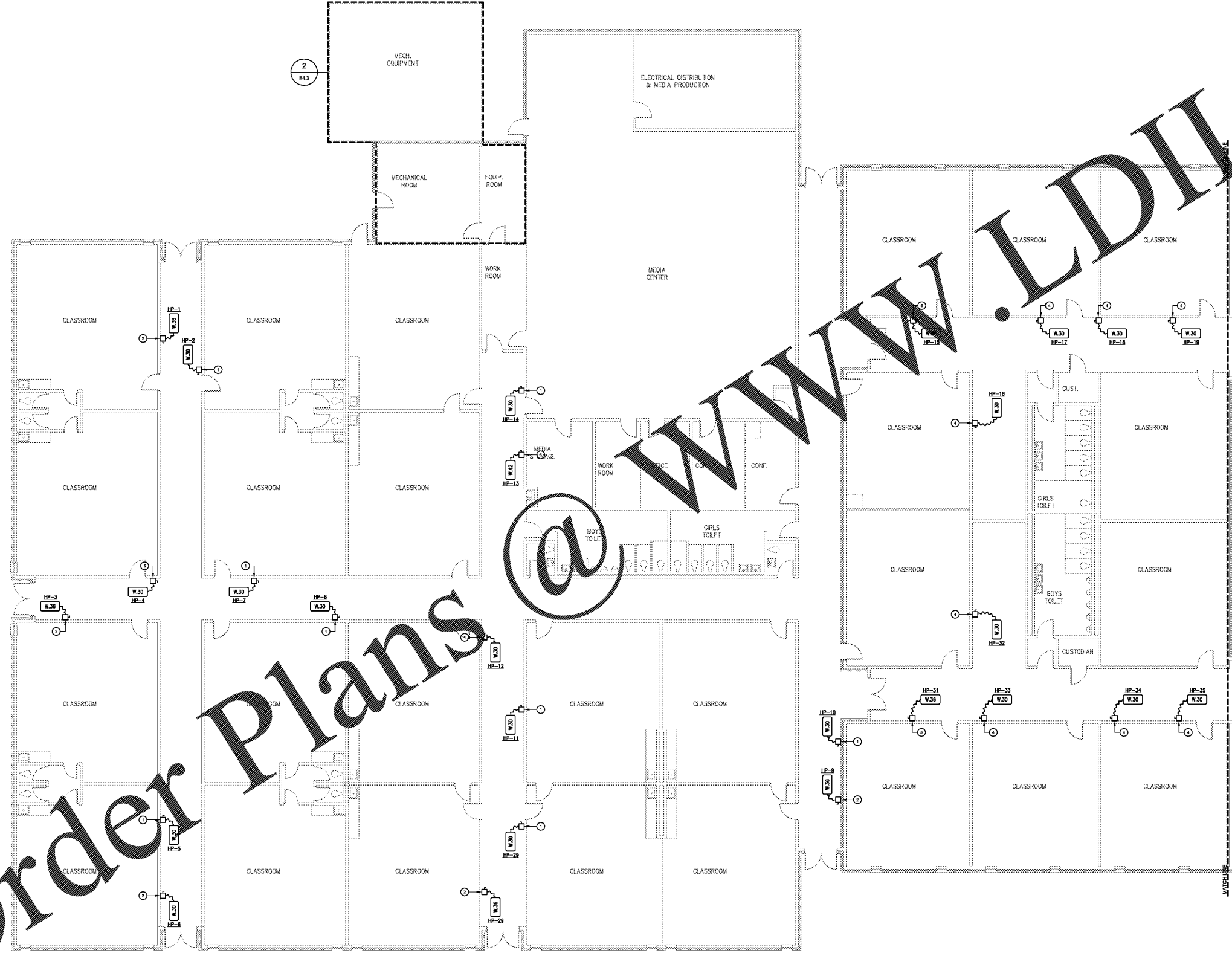

1 ELECTRICAL PARTIAL FLOOR PLAN - POWER
 SCALE: 1/8"=1'-0"

FOR PRICING

Order Plans @ WWW.LDITLine.com