

GENERAL NOTES

1. SEE SHEET M0.1 FOR HVAC NOTES.

KEY NOTES

- ① EXTEND INDIVIDUAL TEMPERED WATER RUNOUTS TO EACH WSHIP WITH NEW FLEXIBLE HOSE KIT. SEE SCHEDULE FOR SIZING.
- ② PROVIDE COPPER CONDENSATE DRAINS FOR REPLACEMENT WSHIPS LOCATED ABOVE THE CEILING. TYPICAL INSULATED ALL NEW CONDENSATE PIPING AND ANY SECTIONS DAMAGED WITH ELASTIMERIC TYPE. ROUTE PIPING AS HIGH AS POSSIBLE FROM CONNECTION WITH HEAT PUMPS.
- ③ REPLACE APPROXIMATELY 120' OF EXISTING REVERSE RETURN PIPING FROM WITH NEW 4" MAIN. MAKE CONNECTIONS FOR REPLACEMENT WSHIPS. SEE SHEET M2.3 FOR CONTINUATION.
- ④ NEW TEMPERED WATER PUMP DIFFERENTIAL PRESSURE SENSOR LOCATION. PROVIDE TRAPS WITH ISOLATION VALVES FOR BAS VENDOR.



COPYRIGHT © 2018
The drawing is the property of Foreman, Seeley Fountain Architects and may not be used, copied or reprinted without expressed written permission.
© 2018

Revisions:

| No. | Description |
|-----|-------------|
| | |
| | |
| | |
| | |

**HVAC AND ROOFING RENOVATIONS FOR
BRITT ELEMENTARY SCHOOL**

2503 SKYLAND DRIVE SW
SNELLVILLE, GEORGIA 30078

Facility Code
3050

FOREMAN | SEELEY | FOUNTAIN
architecture

3001 Gorman Lake Drive, Suite 150, Peachtree Corners, Georgia 30071
(770) 774-8433 | www.seeleyfountain.com | (770) 774-8446

Sheet Title:
CLASSROOM BUILDING NORTH - HVAC PIPING
NEW WORK PART PLAN

Drawn By: GBP
Scale: AS NOTED
Date: 12/14/2018
Job No.: 18JS97
Sheet No.:
M2.4

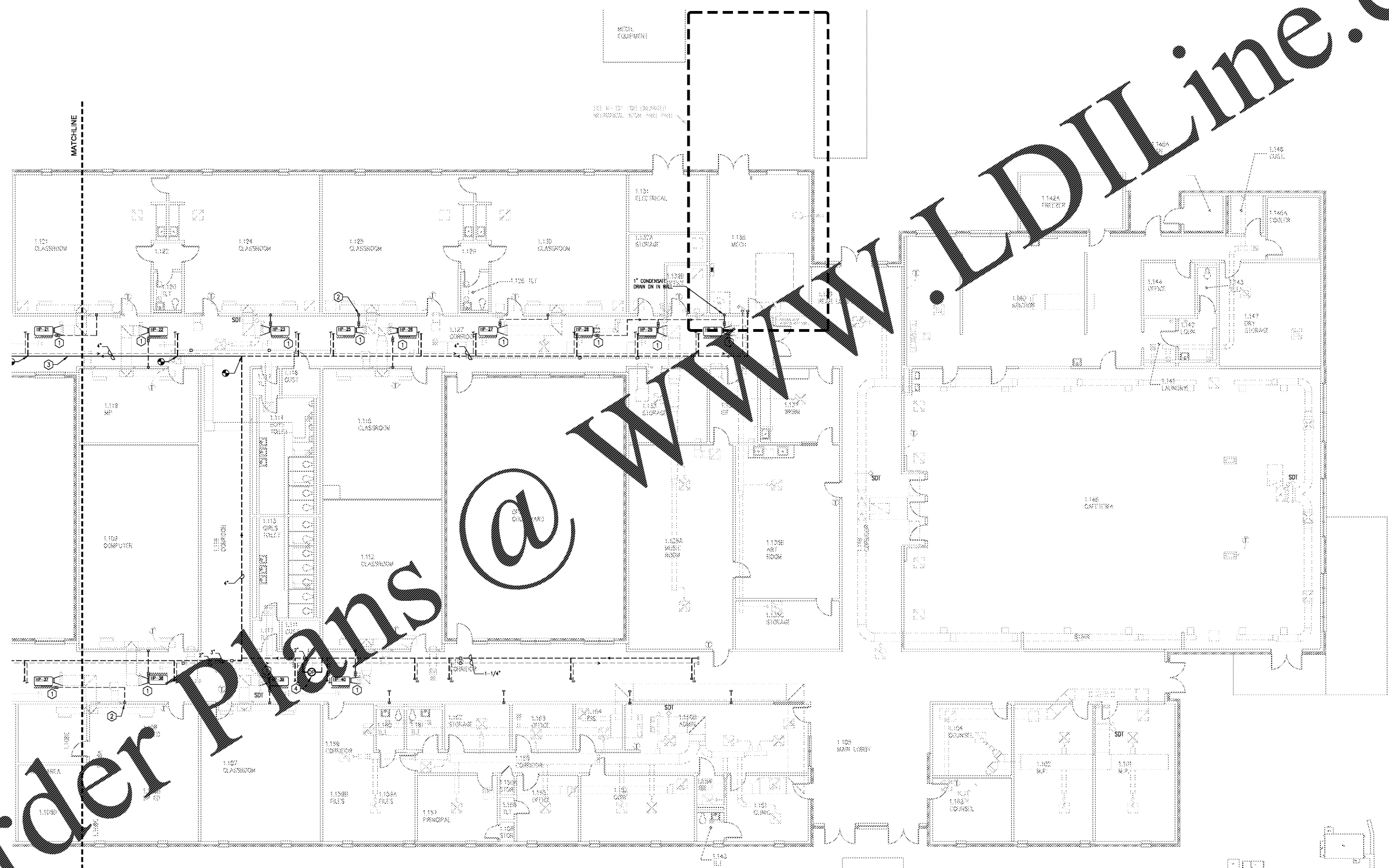

① CLASSROOM BUILDING NORTH - HVAC PIPING NEW WORK PART PLAN
SCALE: 1/8" = 1'-0"

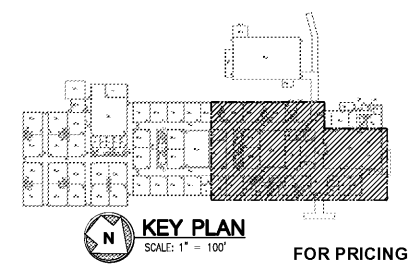

Order Plans @