



Know what's below.
Call before you dig.

THE LOCATIONS OF EXISTING UNDERGROUND UTILITIES AND STRUCTURES ARE APPROXIMATE AND SHOWN FOR INFORMATION ONLY. CONTRACTOR SHALL VERIFY THE EXACT LOCATION OF ALL UTILITIES BEFORE COMMENCING WORK. CONTRACTOR SHALL BE RESPONSIBLE FOR ANY DAMAGE TO EXISTING UTILITIES OR STRUCTURES. CONTRACTOR SHALL PRESERVE ANY AND ALL UTILITIES AND STRUCTURES.

NOTICE: THE CONTRACTOR SHALL BE RESPONSIBLE FOR THE SAFETY OF THE WORKER AND THE PUBLIC. THE CONTRACTOR SHALL BE RESPONSIBLE FOR THE SAFETY OF THE WORKER AND THE PUBLIC. THE CONTRACTOR SHALL BE RESPONSIBLE FOR THE SAFETY OF THE WORKER AND THE PUBLIC.

24 HOUR EMERGENCY CONTACT
GARY CURT
(205) 932-2535



SEC. 28, T13, R2
LIBERTY PARKWAY
VESTAVIA HILLS
JEFFERSON COUNTY, AL

LP DEVELOPMENT, LLC
MARKETPLACE AT THE BRAY - LIBERTY PARK
SITE DEVELOPMENT PLANS
GRADING PLAN - SHOPS

DATE 07-16-2018

9-11-18 UPDATED SET W/CLOUDS

10-8-18 SITE COORDINATION UPDATES

REVISIONS



SCALE 1"=20'

DRAWN BY: DJ

CHECKED BY: BEK

PROJECT MANAGER: BRIAN E. KAY

JOB #: 18000582
FILE CODE: ##
SHEET NO. C302

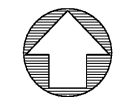

GRADING LEGEND

- EXISTING PROPERTY LINE
- EXISTING RIGHT-OF-WAY
- EXISTING SETBACK LINE
- PROPOSED RIGHT-OF-WAY
- PROPOSED SETBACK LINE
- 1:23 EXISTING MINOR CONTOURS
- 1:23 EXISTING MAJOR CONTOURS
- 1:23 PROPOSED MINOR CONTOUR
- 1:23 PROPOSED MAJOR CONTOUR
- EXISTING STORM LINE
- PROPOSED STORM LINE
- PROPOSED SPOT ELEV.
- SLOPE ARROW
- GRATE INLET
- STORM MANHOLE
- DOUBLE WING CATCH BASIN
- SINGLE WING CATCH BASIN
- AREA INLET
- SANITARY SEWER MANHOLE

GRADING NOTES

1. INFORMATION CONCERNING SITE SOIL CONDITIONS WILL BE PROVIDED BY THE OWNER.
2. CONTRACTOR SHALL BE RESPONSIBLE FOR REMOVAL OF ALL DEBRIS NOT ACCEPTABLE TO THE OWNER AND ENGINEER.
3. IF CONTRACTOR DOES NOT ACCEPT EXISTING TOPOGRAPHY AS SHOWN ON THE PLANS, WITHOUT EXCEPTION, THE CONTRACTOR SHALL MAKE A TOPOGRAPHIC SURVEY AT THEIR OWN EXPENSE AND SUBMIT IT TO THE OWNER FOR REVIEW.
4. CONTRACTOR IS RESPONSIBLE FOR NOTIFYING ALL UTILITIES BEFORE CONSTRUCTION AND VERIFYING LOCATION OF ALL UTILITIES SHOWN OR NOT SHOWN.
5. CONTRACTOR SHALL PROVIDE DRAINAGE AWAY FROM THE BUILDINGS.
6. PRECAST STRUCTURES MAY BE USED AT THE CONTRACTOR'S OPTION.
7. CONTRACTOR SHALL BE RESPONSIBLE FOR COORDINATION AND COST OF THE RELOCATION OF ALL UTILITIES ALONG THE RIGHT OF WAY AND ON THE SITE ASSOCIATED WITH THE CONSTRUCTION OF THIS PROJECT, SUCH AS, BUT NOT LIMITED TO SIGNAL POLES, SIGNAL CONTROLS, DRAINAGE STRUCTURES, TRAFFIC SIGNS, UTILITY POLES, GUY WIRES, ETC.
8. IN ALL AREAS WHERE NEW CURB AND GUTTER ARE INSTALLED, REMOVE ALL OLD CURB AND GUTTER AND SAW CUT A STRAIGHT EDGE ALONG ASPHALT.
9. THE EARTHWORK FOR ALL BUILDING FOUNDATIONS AND SLABS SHALL BE IN ACCORDANCE WITH ARCHITECTURAL PLANS AND SPECIFICATIONS.
10. CONTRACTOR IS RESPONSIBLE FOR REPAIRS OF DAMAGE TO ANY EXISTING IMPROVEMENTS DURING CONSTRUCTION, SUCH AS, BUT NOT LIMITED TO, DRAINAGE, UTILITIES, PAVEMENT, STRIPING, CURBS, ETC. REPAIRS SHALL BE EQUAL TO OR BETTER THAN EXISTING CONDITIONS.
11. ALL SLOPES AND DISTURBED AREAS NOT COVERED BY BUILDING OR PAVEMENT SHALL BE GRADED SMOOTH AND RECEIVE 4 INCHES OF TOPSOIL. CONTRACTOR TO PROVIDE TOPSOIL IF NOT AVAILABLE ON SITE. THE AREAS SHALL BE SEEDED, MULCHED, FERTILIZED AND WATERED TO PROVIDE A HEARTY MOWABLE STAND OF GRASS. SMALL ROCKS MUST BE REMOVED. ANY AREAS DISTURBED FOR ANY REASON PRIOR TO FINAL ACCEPTANCE OF THE PROJECT SHALL BE CORRECTED BY THE CONTRACTOR AT NO ADDITIONAL COST TO THE OWNER.
12. SPOIL FROM FOOTINGS IS THE SITE CONTRACTOR'S RESPONSIBILITY. CONTRACTOR IS TO USE THE SOIL ON SITE OR REMOVE IT FROM THE SITE.
13. EARTHWORK SHALL BE ON AN UNCLASSIFIED BASIS.
14. ANY FILL USED TO INCREASE THE ELEVATION OF THE FLOOR SLAB OR ANY FILL TO BE USED AS BACKFILL SHALL BE CLEAN, GRANULAR MATERIAL. PRIOR TO THE USE OF ANY GRANULAR FILL, GRADATION ANALYSIS SHALL BE PERFORMED ON REPRESENTATIVE SAMPLES OF THE FILL MATERIAL TO DETERMINE WHETHER THE MATERIAL IS SUITABLE AS FILL. COMPACTED FILL SHALL BE PLACED IN LAYERS OF NOT MORE THAN EIGHT INCHES IN THICKNESS, AT MOISTURE CONTENTS WITHIN THREE PERCENT OPTIMUM, AND COMPACTED TO MINIMUM DENSITY OF 95 PERCENT OF THE MAXIMUM DRY DENSITY AS DETERMINED BY THE STANDARD PROCTOR METHOD, ASTM D-698.
15. ALL SYSTEM MANHOLES AND PIPES TO BE FLUSHED CLEAN PRIOR TO TURNING OVER TO THE OWNER.
16. ALL PIPE LENGTHS LISTED ARE BASED ON THE HORIZONTAL DISTANCE FROM CENTER OF STRUCTURE AND USED FOR DESIGN.
17. THE CONTRACTOR IS RESPONSIBLE FOR COMPARING THE STORM SEWER AND SANITARY SEWER CHARTS WITH THE PROFILES FOR THE STORM SEWER AND SANITARY SEWER LINES AND NOTIFYING THE ENGINEER OF ANY CONFLICTS OR DISCREPANCIES PRIOR TO COMMENCEMENT OF CONSTRUCTION.

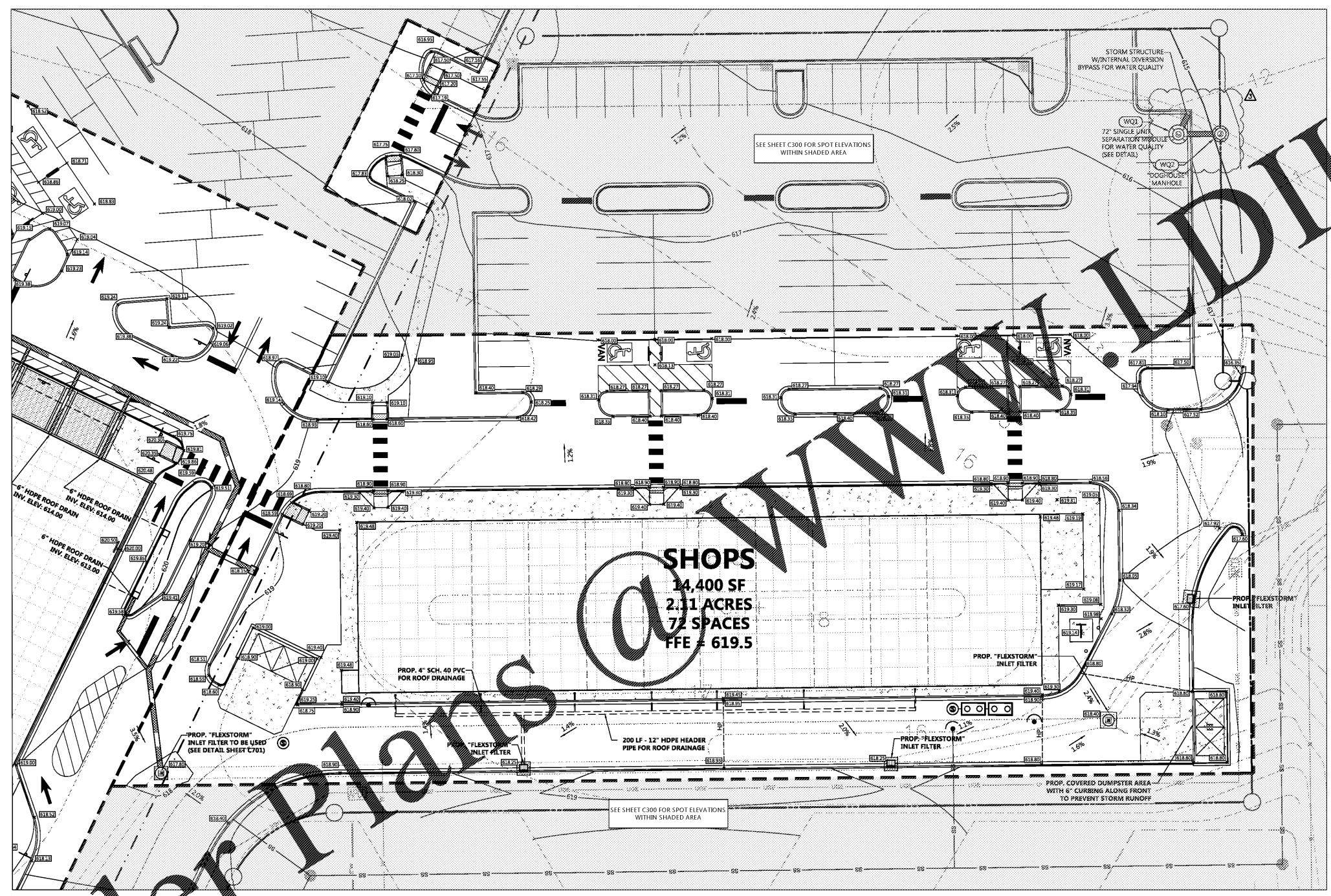

Order Plans @ www.wdw.com

FILE NAME: H:\18000582\Project - 18000582\Drawings\Site\Plan\Grading\PROPOSED - C302 - SHOPS\Grading Plan.dwg LAST SAVED BY: bsherman 10/17/2018 4:48 PM PLOTTED BY: bsherman 10/19/2018 8:48 AM PLOTTED BY: bsherman 10/19/2018 8:48 AM X PLT (C) 2018 ATWELL, L.L.C. ALL RIGHTS RESERVED.