

## TERMITE PROTECTION OF SOILS

TERMITE PROTECTION OF SOILS:  
TERMITE PROTECTION SHALL BE PROVIDED AS DEFINED IN SECTION 1816 OF THE FLORIDA BUILDING CODE. TERMITE TREATMENT SHALL BE PERFORMED AFTER ALL EXCAVATIONS, BACKFILLING AND COMPACTION IS COMPLETED, INCLUDING AREAS OF EXTERIOR CONCRETE OR GRADE WITHIN 1 FOOT OF THE PRIMARY STRUCTURE. RETREATMENT OF SOILS MAY BE REQUIRED IF ANY TREATED SOILS ARE DISTURBED DURING THE CONSTRUCTION PROCESS. ALL TREATED SOILS ARE TO BE PROTECTED FROM RAINFALL DILUTION. REFER TO PROJECT MANUAL FOR ADDITIONAL INFORMATION.

## LIGHT-FRAME TRUSS CONSTRUCTION

THE ROOF STRUCTURE FOR THIS BUILDING IS COMPRISED OF STEEL FRAMES AND PURLINS AS INDICATED IN THE PRE-ENGINEERED METAL BUILDING DRAWINGS. AS PER FLORIDA STATUTE, LIGHT-FRAME TRUSS CONSTRUCTION SIGNS ARE NOT REQUIRED.

## STRUCTURAL NOTES

(REFER TO PROJECT MANUAL FOR ADDITIONAL INFORMATION)

### 1. FOOTINGS & FOUNDATION EXCAVATION:

- A GEOTECHNICAL ANALYSIS HAS BEEN PERFORMED ON THIS SITE. SEE PROJECT MANUAL FOR GEOTECHNICAL INFORMATION. APPROPRIATE RECOMMENDATIONS STATED IN THE GEOTECHNICAL REPORT ISSUED BY UNIVERSAL ENGINEERING SCIENCES DATED JUNE 28, 2018 SHALL BE FOLLOWED.
- THESE FOUNDATIONS HAVE BEEN DESIGNED FOR A SOIL BEARING OF 2500 PSF FOR CONTINUOUS AND ISOLATED FOOTINGS.
- FOUNDATIONS AND SLAB SHOULD BEAR ON ADEQUATELY COMPACTED SUITABLE NATURAL SOILS OR ON PROPERLY PLACED AND COMPACTED ENGINEERED FILL. SEE GEOTECHNICAL REPORT FOR SPECIFIC REQUIREMENTS REGARDING EXCAVATION AND PREPARATION OF SUBGRADE. A GEOTECHNICAL ENGINEER SHOULD BE PRESENT TO DIRECT THE REMOVAL OF UNSUITABLE SOILS AND TO DETERMINE THE ADEQUACY OF THE BEARING SURFACE PRIOR TO PLACEMENT OF THE REINFORCEMENT AND CONCRETE.
- FOOTING WIDTHS TO BE AS SHOWN ON PLANS AND DETAILS. BOTTOM OF FOOTING IS TO BE EXCAVATED SQUARE AND TRUE.
- WHERE ANY OPEN TRENCH HAS BEEN EXPOSED TO RAIN, SNOW OR ICE PRIOR TO POURING CONCRETE, ALL REINFORCING IN THAT TRENCH SHALL BE REMOVED AND THE BOTTOM OF THE TRENCH SHALL BE DRAINED OF ALL WATER AND CLEANED OF MUD, SNOW OR ICE. A GEOTECHNICAL ENGINEER OR HIS TECHNICAL REPRESENTATIVE SHALL INSPECT THE BOTTOM OF THE TRENCH AND OBSERVE THE RE-COMPACTION OF SOILS PRIOR TO PLACING REINFORCEMENT AND POURING OF CONCRETE.
- ALL STRIP FOOTINGS SHALL BE CENTERED UNDER WALLS BEING SUPPORTED AND ALL ISOLATED FOOTINGS SHALL BE CENTERED UNDER COLUMNS, UNLESS NOTED OTHERWISE.
- MINIMUM EXTERIOR FOOTING DEPTH SHALL BE AS INDICATED ON THE FOUNDATION PLAN SHEET S2.
- IN THE EVENT THAT ORGANIC SOIL OR UNCOMPACTED FILL IS FOUND BELOW FOOTINGS OR FLOOR SLABS, IT SHALL BE REMOVED AND REPLACED WITH SELECT FILL, PLACED AND COMPACTED AS DESCRIBED IN THE GEOTECHNICAL REPORT.
- STRUCTURAL FILL SHOULD BE PLACED AND COMPACTED AS INDICATED IN THE GEOTECHNICAL REPORT. ADEQUATE DENSITY AND MOISTURE CONTENT TESTS SHOULD BE PERFORMED TO ENSURE COMPLIANCE WITH PROJECT SPECIFICATIONS. SUBGRADE INSPECTION AND FILL TESTING UNDER CONTROLLED CONDITIONS IS CONSIDERED ESSENTIAL IF THE FOOTINGS ARE TO BE FOUNDED IN FILL. A TESTING FREQUENCY OF AT LEAST ONE FIELD DENSITY TEST FOR EACH 2500 SQUARE FEET OF LIFT, BUT NOT LESS THAN 3 TESTS PER LIFT IS RECOMMENDED WITHIN THE BUILDING AREAS.

### 2. CONCRETE:

- ALL READY MIX CONCRETE SHALL BE 4000 PSI FOR ALL CONCRETE PLACEMENT. DO NOT ADD WATER TO THE MIX DESIGN AFTER DELIVERY TO THE PROJECT SITE.
- EXPOSED EXTERIOR CONCRETE SHALL BE AIR-ENTRAINED (TOTAL AIR CONTENT = 5%). INTERIOR CONCRETE SHALL NOT BE AIR-ENTRAINED.
- UNLESS NOTED OTHERWISE, CONCRETE COVER OVER STEEL REINFORCEMENT SHALL CONFORM TO THE MINIMUM REQUIREMENT BY ACI 318.
- REINFORCEMENT DETAILING AND PLACEMENT SHALL CONFORM TO ACI 318 AND ACI 315, EXCEPT WHERE OTHERWISE INDICATED.
- HOT OR COLD WEATHER CONCRETING SHALL BE IN ACCORDANCE WITH ACI 305-89 AND ACI 306-1-90, RESPECTIVELY.
- ANY CONCRETE PLACED BY MEANS OF PUMPING SHALL BE DONE IN ACCORDANCE WITH ACI 304.2R (82).
- CEMENT SHALL CONFORM TO ASTM C-150 TYPE I.
- AGGREGATES SHALL CONFORM TO ASTM C-33 FOR NORMAL WEIGHT CONCRETE & ASTM C-330 FOR LIGHTWEIGHT CONCRETE.
- READY MIX CONCRETE SHALL BE MIXED AND DELIVERED IN ACCORDANCE WITH ASTM C-94.
- AD MIXTURES MAY BE USED WITH THE APPROVAL OF THE STRUCTURAL ENGINEER. AD MIXTURES USED TO INCREASE THE WORKABILITY OF THE CONCRETE SHALL NOT BE CONSIDERED TO REDUCE THE CEMENT CONTENT. NO CALCIUM CHLORIDE AD MIXTURES ALLOWED.

### 3. SLABS ON GRADE:

- FLOOR SLABS ARE TO BE PLACED AND FINISHED IN ACCORDANCE WITH ACI 302 (SEE PROJECT MANUAL FOR ADDITIONAL INFORMATION).
- THICKNESS TOLERANCE FOR ALL SLABS IS TO BE PER ACI 117 AND IS TO BE NO MORE THAN +3/8" (THICKER) AND NO MORE THAN -1/4" (THINNER) FROM THE DESIGN THICKNESS.
- CONCRETE USED FOR FLOOR SLABS SHALL INCLUDE SUPERPLASTICIZER. SEE PROJECT MANUAL FOR ADDITIONAL INFORMATION.

### 4. REINFORCING:

- REINFORCING BARS SHALL BE BILLET STEEL, ASTM A 615, GRADE 60. PROVIDE CONTINUOUS BENT BARS AT FOOTING STEPS AND 90 DEGREE BENT TIES AT CORNERS, UNLESS OTHERWISE NOTED. LAP SPICES OR EMBEDMENT LENGTHS SHALL CONFORM TO CLASS B SPICE (SEE SPICE TABLE). ADJACENT BAR SPICES IN WALLS AND FOOTINGS TO BE ALTERNATED. ALL FOOTINGS SHALL REQUIRED HOOKED REINFORCING PROJECTED INTO WALLS, PILASTERS OR COLUMNS. THE SIZE AND SPACING OF DOWELS ARE TO MATCH VERTICAL REINFORCING.
- WELDED WIRE FABRIC (WWF) SHALL CONFORM TO THE CURRENT ASTM SPECIFICATION FOR COLD DRAWN STEEL REINFORCEMENT WIRE. LAP ENDS AND EDGES MINIMUM 6" ON CENTER.
- REINFORCING DETAILING, BENDING, AND PLACING SHALL CONFORM TO ACI 315.
- MINIMUM CONCRETE COVERAGE: THE MINIMUM CLEAR DISTANCES BETWEEN REINFORCING STEEL AND FACE OF CONCRETE SHALL BE MAINTAINED UNLESS NOTED OTHERWISE:  
SLABS ON EARTH..... CENTER OF SLAB  
CONCRETE BELOW GRADE, FORMED..... 2"  
CONCRETE BELOW GRADE, UNFORMED AND POURED AGAINST EARTH..... 3"

### 5. LUMBER:

- ALL LUMBER SHALL BE FIRE TREATED IN ACCORDANCE WITH PROJECT SPECIFICATIONS. REFER TO ARCHITECTURAL AND PROJECT MANUAL FOR MORE INFORMATION AND SPECIFIC REQUIREMENTS.
- TREATED LUMBER: IN LOCATIONS WHERE TREATED LUMBER IS SHOWN ON DRAWINGS, THE APPROVED PRESSURE TREATED WOOD SHALL BE ACQ-D (CARBONATE) OR CA-B TREATED WOODS WITHOUT AMMONIA CARRIERS. THE CHEMICAL RETENTION LEVELS SHALL BE NO GREATER THAN 0.4 PCF FOR ACQ-D AND 0.21 PCF FOR CA-B. ALL METAL CONNECTORS ARE TO HAVE A GALVANIZED COATING OF NO LESS THAN 1.85 OUNCES OF ZINC PER SQUARE FOOT PER ASTM A653. ALL BOLTS, SCREWS NAILS AND OTHER FASTENERS ARE TO BE GALVANIZED PER ASTM A153. WHERE TREATED LUMBER IS SHOWN ON EXTERIOR WALLS WITH NO ROOF COVERINGS TO PREVENT DIRECT EXPOSURE TO RAIN, USE HOT DIP GALVANIZED CONNECTORS PER ASTM A123.

### 6. STRUCTURAL STEEL:

- FABRICATOR QUALIFICATIONS: FABRICATOR MUST PARTICIPATE IN THE AISC QUALITY CONTROL PROGRAM AND BE DESIGNATED AN AISC-CERTIFIED PLANT.
- MATERIALS:  
STRUCTURAL STEEL..... ASTM A992, GRADE 50 UNLESS NOTED  
PLATES, ANGLES, CHANNELS AND MISCELLANEOUS STEEL..... ASTM A36  
ANCHOR RODS..... ASTM F1554, GRADE 36  
HIGH STRENGTH BOLTS..... ASTM A325 (3/4") UNLESS NOTED (OF NORTH AMERICAN MANUFACTURE)  
WELDING ELECTRODES..... AWS A5.1 (E70XX)  
PIPE..... ASTM A53, GRADE B  
SQUARE AND RECTANGULAR TUBES AND STRUCTURAL SECTIONS (HSS)..... ASTM A500, GRADE B

### 7. LIGHT GAUGE STEEL: SHALL CONFORM TO THE LATEST EDITION AND THE FOLLOWING:

- ALL LIGHT GAUGE METAL STUDS, JOISTS AND RADDERS ARE TO MEET OR EXCEED INDUSTRY STANDARDS AS SET FORTH BY THE STEEL STUDS MANUFACTURER'S ASSOCIATION.
- LIGHT GAUGE STEEL MEMBER DESIGNATIONS SHOWN ON THE CONSTRUCTION DOCUMENTS ARE SSMA STANDARD DESIGNATIONS.
- ALL LIGHT GAUGE STEEL WALLS SHALL BE Laterally Bridged at 48" O.C. (VERTICALLY) USING 2"x20ga STRIP BRACING ATTACHED TO EACH STUD FLANGE. SOLID BLOCKING WITHIN THE PANELS OF THE STRIP BRACING MUST BE PROVIDED AT EACH END OF WALL, ADJACENT TO WALL OPENINGS, AND AT 8' O.C. MAXIMUM. ALL BRIDGING AND BRACING IS TO BE POSITIVELY CONNECTED TO STUDS.
- SLIP TRACK GAUGES TO MEET OR EXCEED GAUGE OF SUPPORTED STUDS.
- BOLTED TRACK FASTENERS TO BE SPACED AT EACH END OF WALL, ADJACENT TO WALL OPENINGS, AND AT 48" O.C. MAXIMUM.
- POWDER ACTUATED FASTENERS SHALL BE DS HEAVY DUTY 0.177x0.012" LONG MANUFACTURED FROM MODIFIED AISI 1081 STEEL, AUTEMPERED TO A HARDNESS OF 52-56 HRC AND ZINC PLATED IN ACCORDANCE WITH ASTM B633, CLASS II. FASTENERS SHALL BE INSTALLED BY A QUALIFIED OPERATOR IN ACCORDANCE WITH THE MANUFACTURER'S RECOMMENDATIONS. POWDER ACTUATED FASTENERS SHALL BE AS MANUFACTURED BY "HILTI FASTENING SYSTEMS" OR EQUIVALENT.
- ALL LOAD BEARING STUDS TO BE SEATED SQUARELY INTO TOP AND BOTTOM WALL TRACKS WITH NO MORE THAN A 1/8" GAP.
- THE DESIGN OF SLIP TRACKS SHALL CONFORM TO THE GUIDELINES ESTABLISHED IN SSMA TECHNICAL NOTE NO. 1 PUBLISHED JANUARY, 2001.

### 8. GENERAL:

- CONTRACTOR HAS SOLE RESPONSIBILITY TO COMPLY WITH ALL OSHA REGULATIONS.
- THE STRUCTURAL DESIGN OF THE BUILDING IS BASED UPON THE FULL INTERACTION OF ALL ITS COMPONENT PARTS, WITH NO PROVISION MADE FOR CONDITIONS OCCURRING DURING CONSTRUCTION. THE STRUCTURE IS STABLE ONLY IN ITS COMPLETED FORM. THE CONTRACTOR SHALL PROVIDE ADEQUATE BRACING DURING CONSTRUCTION. TEMPORARY SUPPORTS REQUIRED FOR STABILITY DURING ALL INTERMEDIATE STAGES OF CONSTRUCTION SHALL BE DESIGNED, FURNISHED AND INSTALLED BY THE CONTRACTOR. THE CONTRACTOR IS RESPONSIBLE FOR CONSTRUCTION ANALYSIS AND ERECTION PROCEDURES, INCLUDING DESIGN AND ERECTION OF FALSEWORK, TEMPORARY BRACING, ETC. THE STRUCTURAL ENGINEER ASSUMES NO LIABILITY FOR THE STRUCTURE DURING CONSTRUCTION.
- CORRECTIONS DUE TO UNOBSERVED FIELD CONDITIONS OR DIMENSIONAL DISCREPANCIES ON CONSTRUCTION DOCUMENTS MUST BE BROUGHT TO THE ATTENTION OF THE PROJECT ARCHITECT FOR REVIEW AND AUTHORIZATION PRIOR TO CORRECTIVE MEASURES BEING IMPLEMENTED.
- STRUCTURAL DRAWINGS ARE TO BE USED IN CONJUNCTION WITH ARCHITECTURAL, MECHANICAL, AND ELECTRICAL DRAWINGS.
- NOTES AND DETAILS ON DRAWINGS SHALL TAKE PRECEDENCE OVER THESE GENERAL NOTES.
- ALL SHOP DRAWINGS SHALL BE REVIEWED AND APPROVED BY THE PROJECT ARCHITECT/ENGINEER PRIOR TO SUBMITTING TO THE BUILDING DEPARTMENT FOR REVIEW AND APPROVAL.

### 9. SIMPSON "AT-XP" ADHESIVE SYSTEM INTO CONCRETE (APMO UES ER-263):

- CONTRACTOR TO FOLLOW ALL REQUIREMENTS, INSTRUCTIONS, AND RECOMMENDATIONS FOR ADHESIVE APPLICATION.
- SUBSTITUTIONS FOR SIMPSON "AT-XP" ANCHORING ADHESIVE SHALL BE ONLY UPON THE APPROVAL OF THE PROJECT ENGINEER OF RECORD.

### 10. SPECIAL INSPECTIONS REQUIREMENTS:

- OWNER SHALL ENGAGE ONE OR MORE QUALIFIED SPECIAL INSPECTORS AND/OR TESTING AGENCIES TO CONDUCT STRUCTURAL TESTS, CONSTRUCTION MATERIAL TESTING, AND SPECIAL INSPECTIONS SPECIFIED IN THE "STATEMENT OF SPECIAL INSPECTIONS".
- FOR THE SPECIFIC RESPONSIBILITY OF THE OWNER, CONTRACTOR, AND SPECIAL INSPECTOR REFER TO SECTION 01 45 16 OF THE PROJECT MANUAL.

## DESIGN CRITERIA

BUILDING CODE: 2017 FLORIDA BUILDING CODE

### DESIGN LOADS:

ROOF DEAD LOAD.....	5.5 psf
ROOF COLLATERAL LOAD.....	2.5 psf
ADDITIONAL CEILING SYSTEM COLLATERAL AT PARTS AREA "A".....	2.0 psf
ROOF LIVE LOAD.....	20.0 psf
SPRINKLER LOADS	
UNIFORM BRANCH PIPE LOAD.....	0.0 psf
LINEAL LOOP/TEE MAIN PIPE LOAD.....	0.0 pif

### SNOW LOAD:

$P_g = 0$  psf  
 $P_f = 0$  psf  
 $C_e = 1.0$   
 $C_t = 1.0$   
 $I_e = 1.0$

### WIND CALCULATION METHOD: ENVELOPE

$V_{ult} = 130$  mph      $V_{ref} = 110$  mph  
EXPOSURE = "C"  
RISK CATEGORY = II  
BUILDING ENVELOPE GC<sub>w</sub> = 0.18

### MAIN FLOOR RESISTING SYSTEM:

WALL AND ROOFS  $P_{uf} = 18.7$  psf  
PARAPETS  $P_{up} = 6$  psf

### WIND COMPONENTS & CLADDING: All Wind Pressures & Forces in "ASD"

(Wind pressures shown were provided by JS Smith Consulting Engineers, P.C. for design. Components designed by others for use in this project will require wind pressures derived by that supplier.)

WALL AREAS 10 SQUARE FEET OR LESS =	27.0 psf
WALL INTERIOR ZONES =	17.9 psf & -19.8 psf
WALL END ZONES =	17.9 psf & -22.5 psf
PARAPETS AT INTERIOR ZONES =	14.9 psf & -23.8 psf
PARAPETS AT END ZONES =	14.9 psf & -27.1 psf
ROOF INTERIOR ZONES =	7.1 psf & -20.2 psf
ROOF EDGE ZONES =	7.1 psf & -24.0 psf
ROOF CORNER ZONES =	7.1 psf & -24.0 psf

### BASE SHEAR:

$V_x$  WIND = 25.6 k  
SEISMIC = 8.6 k  
 $V_y$  WIND = 23.6 k  
SEISMIC = 8.6 k

### SEISMIC DESIGN: EQUIVALENT FORCE PROCEDURE

$S_s = 0.127$   
 $S_1 = 0.066$   
 $S_{D1} = 0.135$   
 $S_{D2} = 0.106$   
SITE CLASS = D  
SEISMIC DESIGN CATEGORY = B  
 $I_e = 1.0$

### SEISMIC FORCE RESISTING SYSTEM:

STEEL NOT DETAILED FOR SEISMIC  
 $R = 3.00$   
 $C_s = 0.045$   
 $\rho = 1.00$

SPLICE TABLE<sup>1</sup>  
(UNLESS NOTED OTHERWISE)

BAR SIZE	LAP SPICES (in.) <sup>2</sup>		EMBED LENGTH (in.)		
	TOP BARS <sup>3</sup> Class B	OTHERS Class B	TOP BARS <sup>3</sup> ld	OTHERS ld	HOOKS <sup>5</sup> ldh
#3	25	19	19	15	8
#4	33	25	25	19	10
#5	41	31	31	24	12
#6	49	37	37	29	15
#7	71	54	54	42	17

- SPLICE TABLE IS BASED ON THE FOLLOWING:  
A. CONCRETE  $f_c = 4000$  psi  
B. GRADE 60 REBAR  
C. BAR SPACING NOT LESS THAN 2 BAR DIAMETERS OR 1"  
D. CONCRETE COVER NOT LESS THAN ONE BAR DIAMETER
- LAP LENGTHS SHOWN ARE FOR CLASS "B" TENSION SPICES PER ACI 318-11 CHAPTER 12.
- TOP BARS ARE DEFINED AS HORIZONTAL REINFORCEMENT PLACED SO THAT MORE THAN 12" OF CONCRETE IS CAST BELOW THE REINFORCEMENT IN THAT MEMBER.
- STANDARD 90° HOOKS:  
A. RADIUS = 4 BAR DIAMETERS FOR #3 THRU #8  
B. LENGTH = 12 BAR DIAMETERS  
C. HOOK LENGTH MAY BE REDUCED IN ACCORDANCE WITH ACI 318-11 CHAPTER 12.5

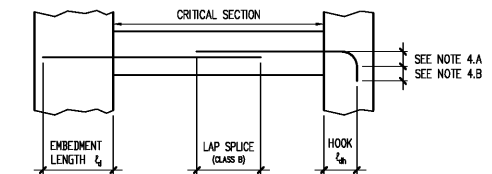

SEE NOTE 4.A  
SEE NOTE 4.B



ALL OTHERS BEARING THIS SEAL ARE AUTHENTICATED. RESPONSIBILITY FOR ALL OTHER PLANS, SPECIFICATIONS OR INSTRUMENTS ARE DISCLAIMED.

JS Smith Consulting Engineers, P.C.  
Florida State Certificate of Authorization No. 20077  
Address: 1100 W. State St., Suite 1000, Jacksonville, Florida 32202  
1001 W. State St., Suite 1000, Jacksonville, Florida 32202  
PHONE: (904) 241-1100 FAX: (904) 241-1100

PROJECT:  
NEW O'REILLY AUTO PARTS STORE  
463352 SR 200  
YULEE, FL 32097

STRUCTURAL NOTES

O'Reilly  
CORPORATE OFFICES  
233 SOUTH PATTERSON  
SPRINGFIELD, MISSOURI 65802  
(417) 862-2674 TELEPHONE

DRAWN BY: BTJ  
CHECKED BY: AS  
DATE: 10/19/18  
REVISION:  
PROJECT NUMBER: YUL  
SHEET NUMBER: S1.1

Order Plans @