

**Order Plans**

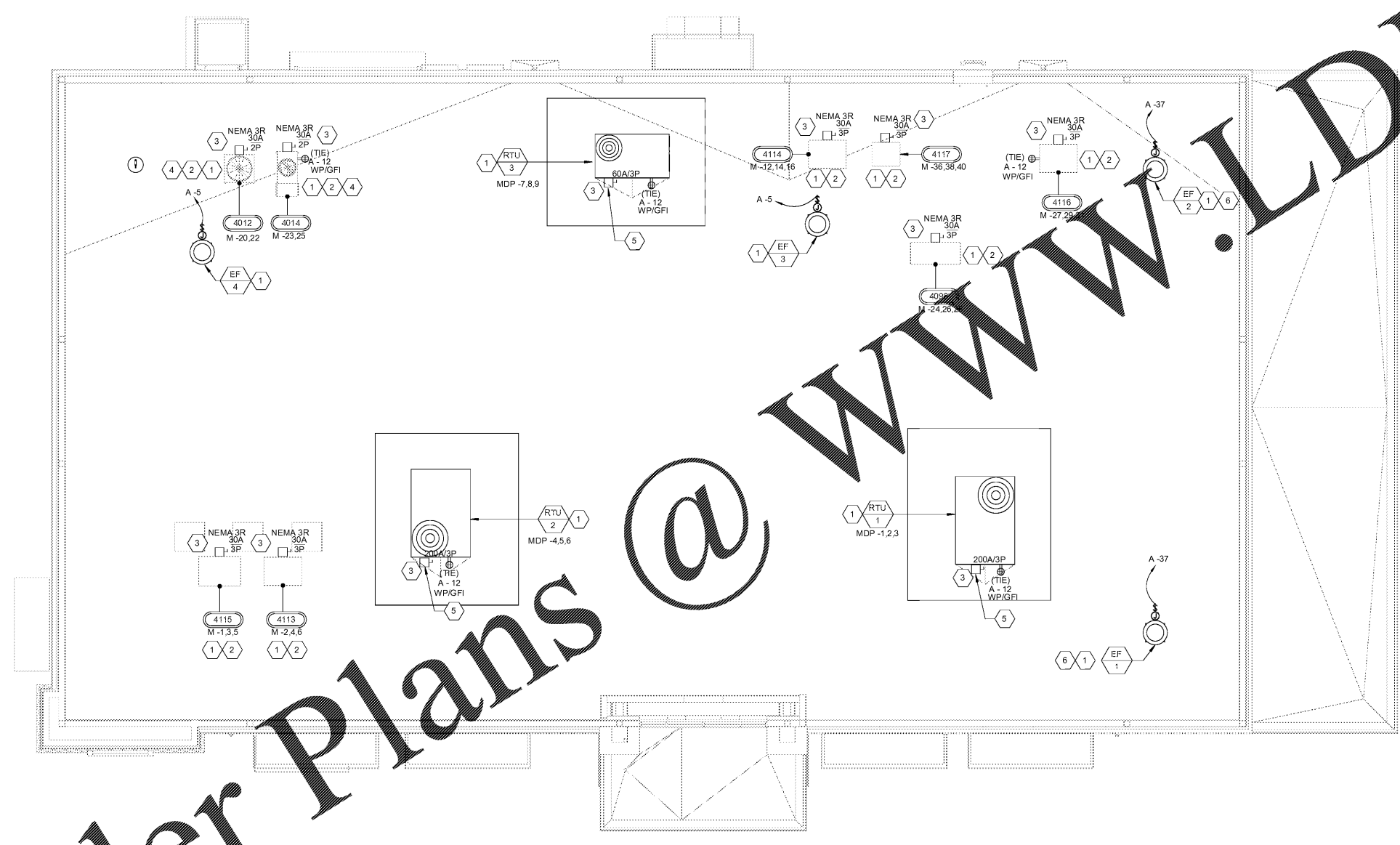

**ELECTRICAL ROOF PLAN**  
3/18

**GENERAL NOTES**

1. DISCONNECTS FOR HVAC EQUIPMENT FURNISHED BY HVAC MANUFACTURER.
2. DISCONNECTS FOR REFRIGERATION EQUIPMENT PROVIDED BY EC.
3. RECEPTACLES SHOWN ON HVAC EQUIPMENT PROVIDED BY HVAC MANUFACTURER. WIRING TO THE RECEPTACLES BY EC.
4. ELECTRICAL CONTRACTOR TO APPLY NAME LABELS TO COMPRESSOR HOUSINGS AFTER INSTALLATION. LABELS SUPPLIED BY RACETRAC.

**RaceTrac**

THESE PLANS ARE SUBJECT TO FEDERAL COPYRIGHT LAWS. ANY USE OF SAME WITHOUT THE EXPRESSED WRITTEN PERMISSION OF RACETRAC PETROLEUM, INC. IS PROHIBITED. © 2016 RACETRAC PETROLEUM INC.



**ARCHITECTURE  
ENGINEERING**  
3680 Pleasant Hill Road  
Suite 200  
Duluth, Georgia 30096  
p 770.622.9858  
f 770.622.9535  
www.hillfoleyrossi.com

© Copyright (as dated below)  
This drawing and all reproctions thereof are the property of Hill Foley Rossi & Associates, LLC (HFR). It is intended for the sole use of the project named herein. Reproduction without the written consent of HFR is prohibited. All copies are to be returned to HFR upon project completion.

**ISSUE/REVISION RECORD**

DATE	DESCRIPTION
09/04/18	ISSUED FOR PERMIT

**RaceTrac**

RACETRAC PETROLEUM, INC.  
200 GALLERIA PARKWAY SOUTHEAST  
SUITE 900  
ATLANTA, GEORGIA 30339  
(770) 431-7600

**PROJECT NAME**  
**PEACHTREE  
PKWY & ENG.**

**PEACHTREE  
CORNERS**  
5780 PEACHTREE PKWY  
PEACHTREE CORNERS, GA  
**RACETRAC STORE NUMBER**  
**1201**

PROTOTYPE SERIES 5.5K 2.0  
2018 RH MO

**PLAN MODIFICATION NOTICE**

SPB NO.	DATE

**PROFESSIONAL SEAL**



09/04/18  
**PROJECT NUMBER**  
18.703.00

**SHEET TITLE**  
**ROOF POWER  
PLANS**

**SHEET NUMBER**  
**E200**  
ISSUED FOR PERMIT

**SHEET KEYNOTES**

1. ELECTRICAL CONTRACTOR SHALL PROVIDE ALL INTERCONNECTING WIRE AND OVER CURRENT PROTECTION REQUIRED BY THE MANUFACTURER. REFER TO INSTALLATION INSTRUCTIONS.
2. ROUTE BRANCH CIRCUITS DOWN THROUGH ROOF VIA REFRIGERANT LINE ROOF JACK PROVIDED AND INSTALLED BY MECHANICAL CONTRACTOR. COORDINATE 'ATR HUB' LOCATIONS WITH ARCHITECTURAL & MECHANICAL DRAWINGS.
3. PROVIDE FUSES ACCORDING TO MANUFACTURER RECOMMENDATIONS.
4. CONDENSER TO BE FED FROM ITS ASSOCIATED ICE MAKER ON SALES FLOOR.
5. DISCONNECT SWITCH INTEGRAL TO UNIT. REFERENCE MECHANICAL SHEETS FOR ADDITIONAL INFORMATION.
6. EXHAUST FANS EF-1 & EF-2 SHALL BE CONTROLLED BY OCCUPANCY SENSOR IN RESTROOMS.