

Order Plans

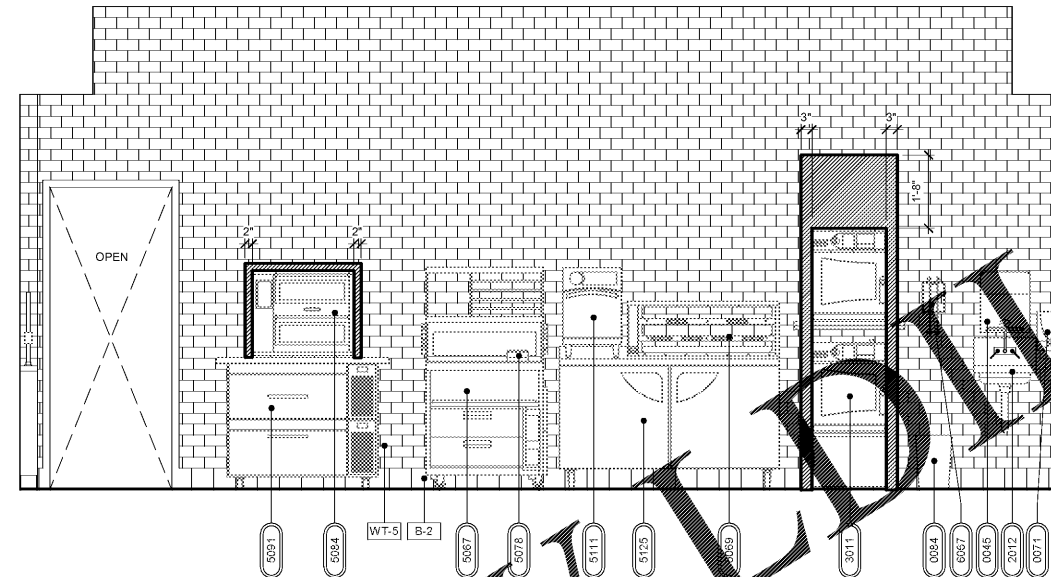

2 BACK OF FOOD BAR ELEVATION CLEARANCES
1/2" = 1'-0"

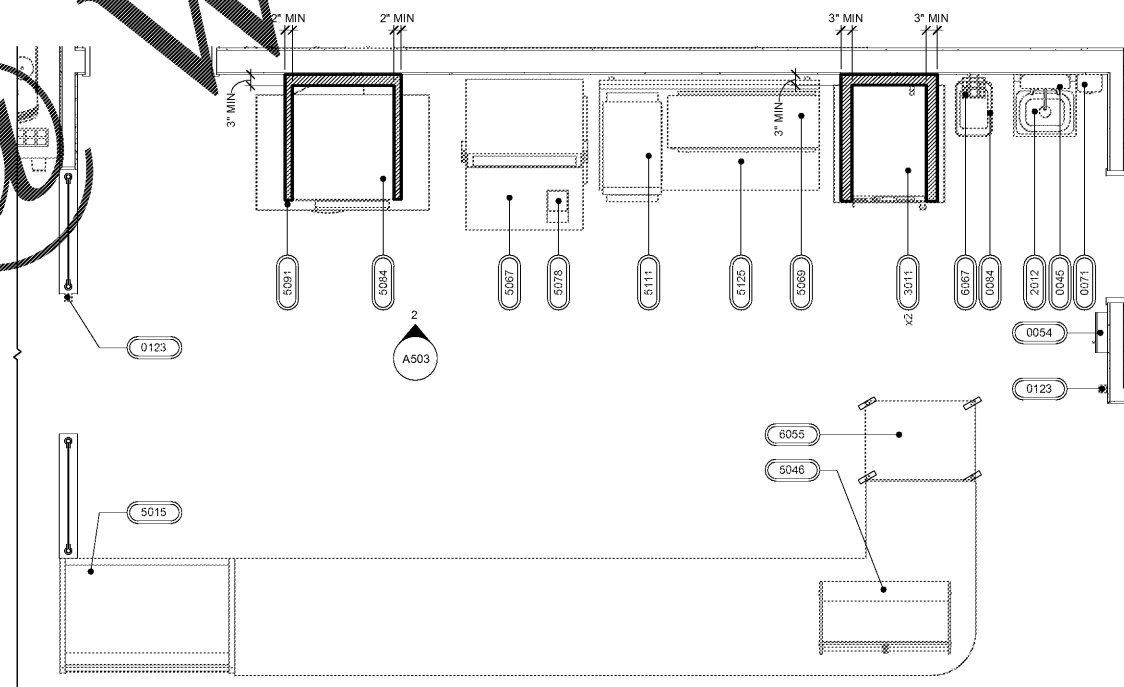

1 FOOD AREA PLAN CLEARANCES
1/2" = 1'-0"

GENERAL NOTES

- ALL FINISH FLOOR ELEVATIONS TAKEN FROM TOP OF TILE
- ALL INTERIOR METAL STUDS ARE 3-5/8" UNLESS NOTED OTHERWISE
- ALL GYPSUM BOARD TO BE 5/8" THICK GREENBOARD UNLESS NOTED OTHERWISE
- INSTALL GYPSUM BOARD ON OUTSIDE FACES OF WALK-IN COOLERS
- PROVIDE DRYWALL FINISH LEVEL 4 WHERE FLAT PAINTS, LIGHT FIXTURES OR WALL COVERINGS ARE TO BE APPLIED
- PROVIDE DRYWALL FINISH LEVEL 5 WHERE GLOSS, SEMI-GLOSS, ENAMEL, OR NON-TEXTURED FLAT PAINTS AS SPECIFIED OR WHERE SEVERE LIGHTING CONDITIONS OCCUR
- ALL SELF-SERVICE STATIONS SHALL BE INSTALLED TO HAVE A MAX. REACH HEIGHT OF 48" MEASURED TO THE HIGHEST OPERABLE PART
- COFFEE, FROZEN DRINK DISPENSER AND YOGURT MACHINES TO COMPLY WITH THE REACH RANGES OF 15" LOW AND 48" HIGH PER 9010.2.1.7 STR. CODES SECTION 904.5.1
- SEE SHEET A500 FOR FINISH AND MATERIAL SCHEDULE
- SEE SHEET A141 FOR EQUIPMENT SCHEDULE
- ALL SHELVING SHALL BE INSTALLED BY RACETRAC VENDOR

EQUIPMENT CLEARANCE FINISH

= AREA OF REQUIRED CLEARANCE

RaceTrac

THESE PLANS ARE SUBJECT TO FEDERAL COPYRIGHT LAWS. ANY USE OF SAME WITHOUT THE EXPRESSED WRITTEN PERMISSION OF RACETRAC PETROLEUM, INC. IS PROHIBITED. 2016 RACETRAC PETROLEUM INC.

DESIGN PROFESSIONALS



ARCHITECTURE
ENGINEERING

3680 Pleasant Hill Road
Suite 200
Duluth, Georgia 30096
p 770.622.9858
f 770.622.9535
www.hillfoleyrossi.com

© Copyright (as stated below)
This drawing and all information thereon are the property of Hill Foley Rossi & Associates, LLC (HFR). It is intended for the use of the project named herein. Reproduction without the written consent of HFR is prohibited. All rights are to be retained to HFR upon project completion.

ISSUE/REVISION RECORD

DATE	DESCRIPTION
09/04/18	ISSUED FOR PERMIT

RaceTrac

RACETRAC PETROLEUM, INC.
200 GALLERIA PARKWAY SOUTHEAST
SUITE 900
ATLANTA, GEORGIA 30339
(770) 431-7600

PROJECT NAME

PEACHTREE
PKWY & ENG.

PEACHTREE
CORNERS

5780 PEACHTREE PKWY
PEACHTREE CORNERS, GA

RACETRAC STORE NUMBER

1201

PROTOTYPE SERIES 5.5K 2.0

2018 RH MO

PLAN MODIFICATION NOTICE

SPB NO. DATE

STANDARD PLAN BULLETINS (SPB) MODIFY THE PROTOTYPE SERIES SET NOTED ABOVE. THE LISTED SPB REPRESENTS THE LATEST MODIFICATION INCORPORATED TO THIS PROTOTYPE SERIES SET AT ORIGINAL RELEASE. THE ISSUE/REVISION RECORD COLUMN ABOVE LISTS ANY REVISIONS OR SPB INCORPORATED IN THIS SET AFTER THE ORIGINAL RELEASE. CONTACT RACETRAC ENGINEERING AND CONSTRUCTION FOR ANY SUBSEQUENT BULLETINS NOT INCORPORATED HEREIN.

PROFESSIONAL SEAL



PROJECT NUMBER

18.703.00

SHEET TITLE

EQUIPMENT
CLEARANCES

SHEET NUMBER

A503

ISSUED FOR PERMIT