

12 TOWER ACCESS DOOR
1 1/2" = 1'-0"

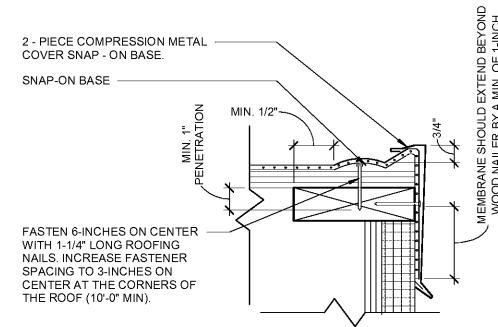

11 2 - PIECE COMPRESSION EDGE
3" = 1'-0"

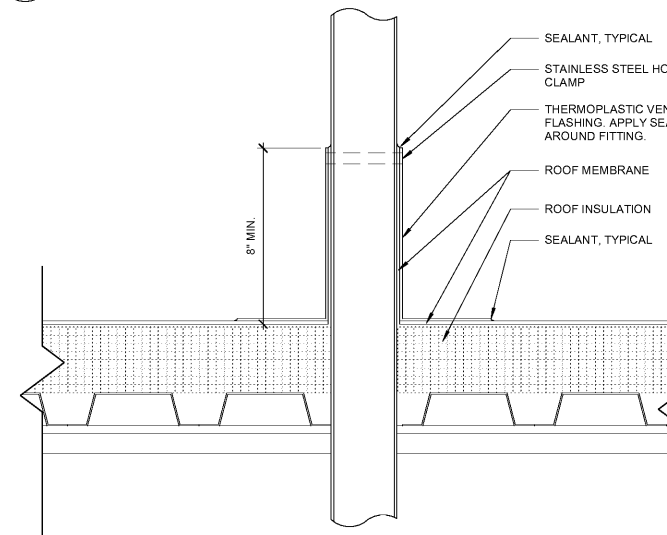

8 TYPICAL PIPE ROOF PENETRATION DETAIL
3" = 1'-0"

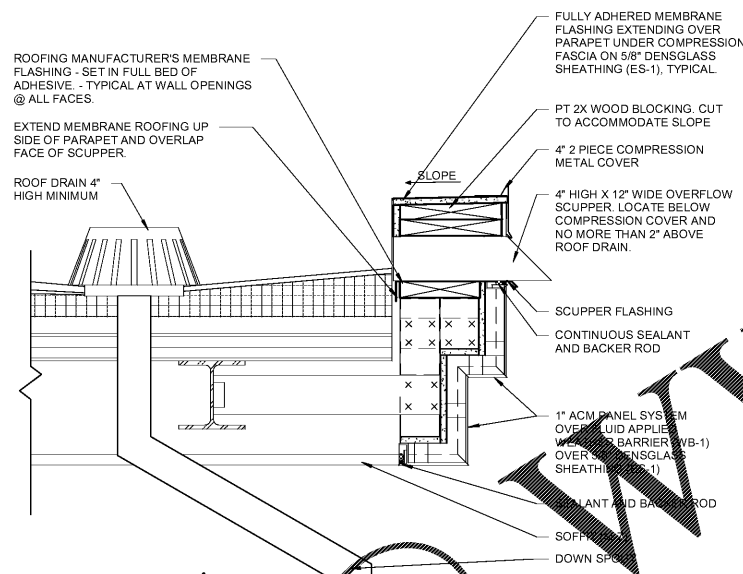

7 OVERFLOW SCUPPER DETAIL
1 1/2" = 1'-0"

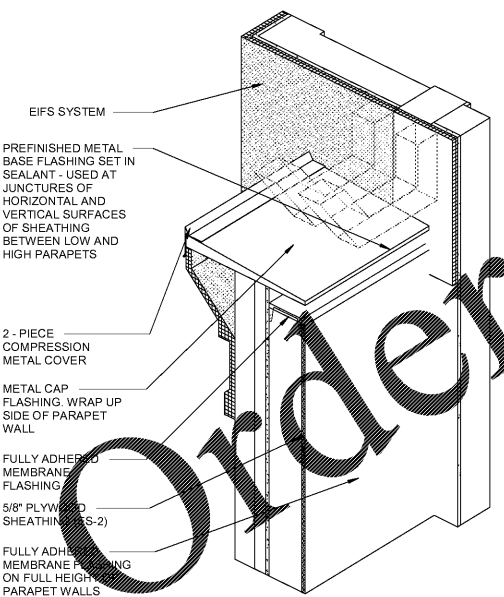

4 CORNICE AXONOMETRIC

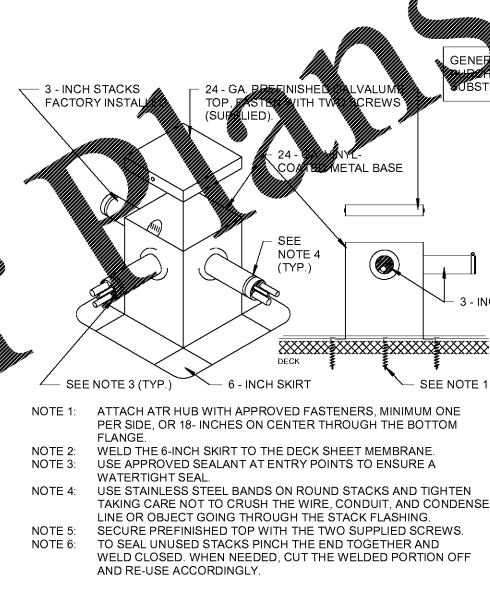

3 ATR HUB
12" = 1'-0"

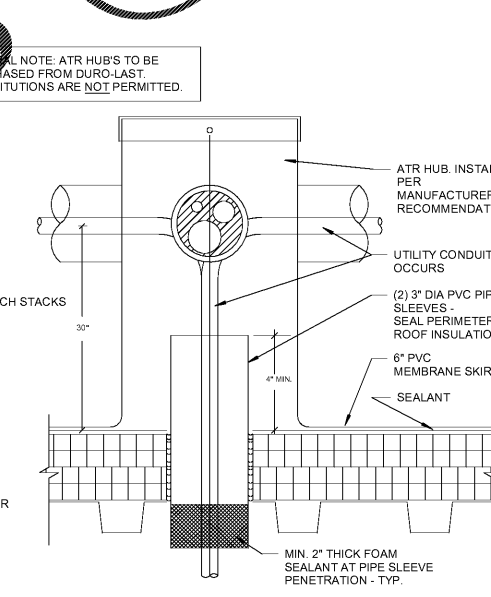

2 MECH/FAN CURB DETAIL
3" = 1'-0"

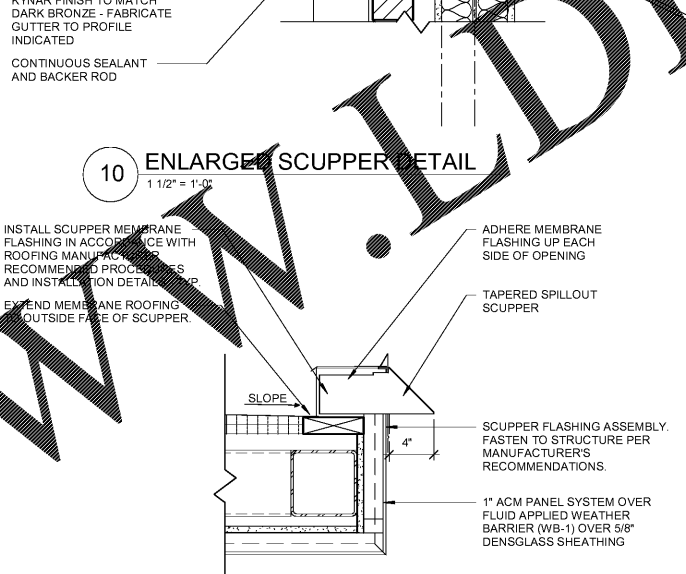

10 ENLARGE SCUPPER DETAIL
1 1/2" = 1'-0"

6 SCUPPER DETAIL AT HIGH TOWER
1 1/2" = 1'-0"

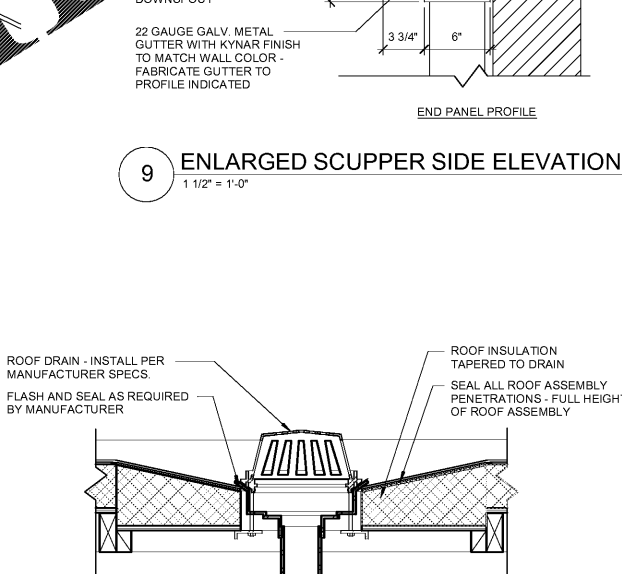

9 ENLARGED SCUPPER SIDE ELEVATION
1 1/2" = 1'-0"

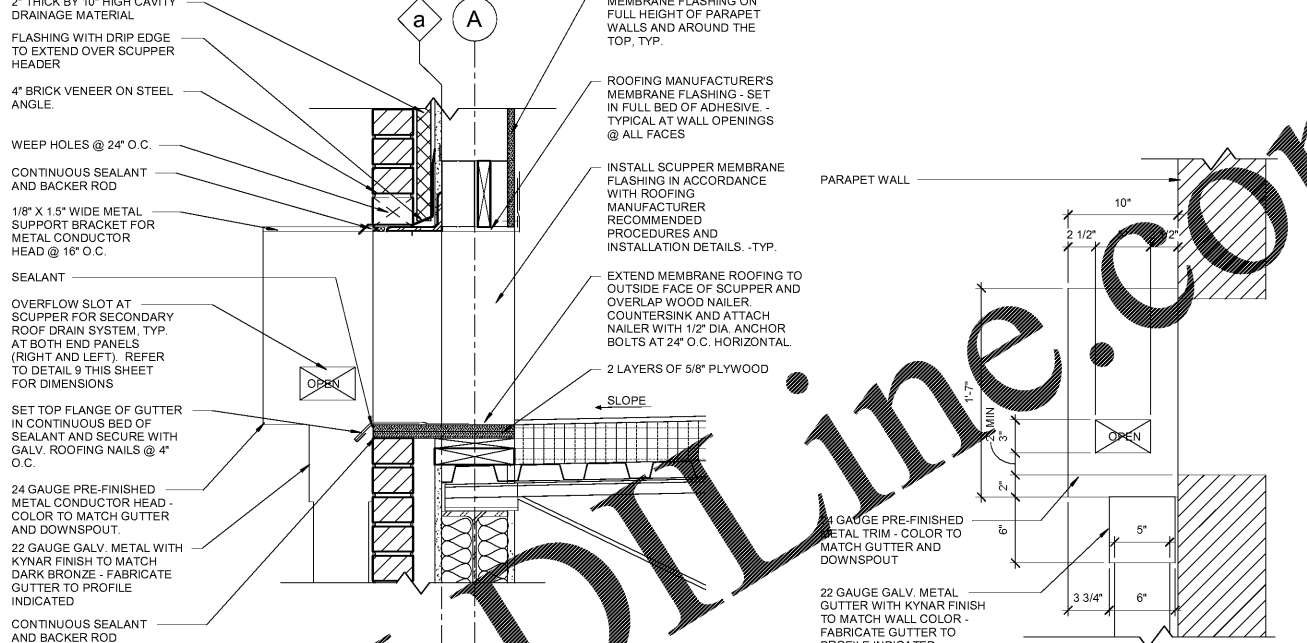

10 ENLARGE SCUPPER DETAIL
1 1/2" = 1'-0"

6 SCUPPER DETAIL AT HIGH TOWER
1 1/2" = 1'-0"

5 ROOF DRAIN DETAIL
1 1/2" = 1'-0"

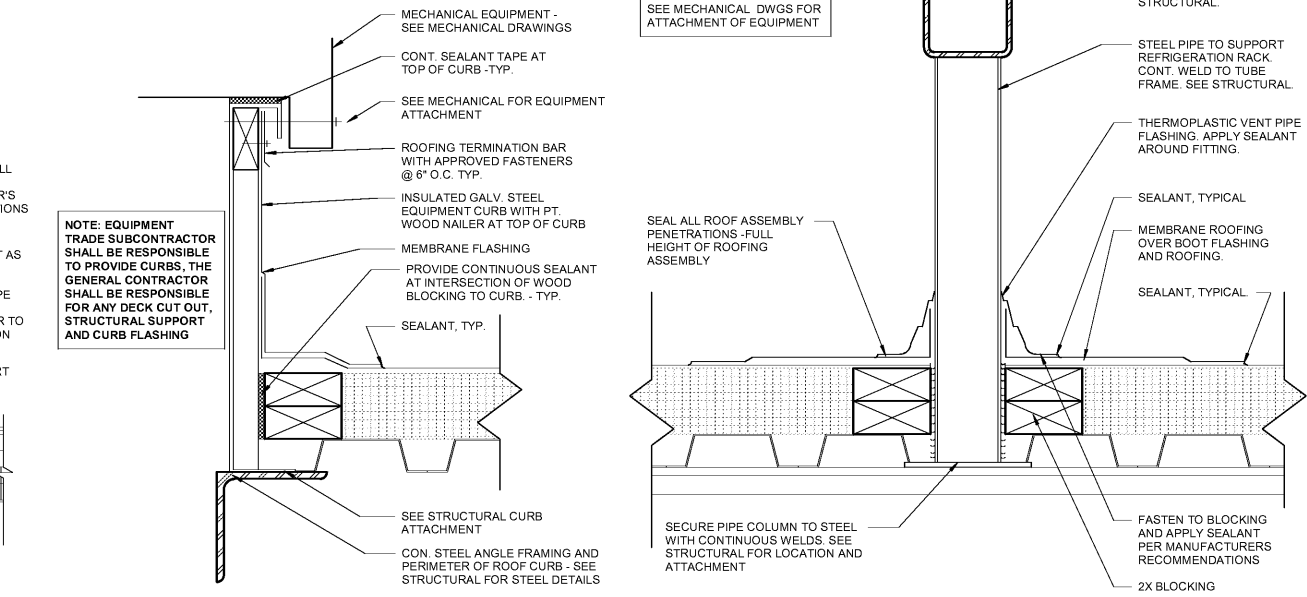

1 REFRIGERATION SUPPORT RACK
3" = 1'-0"

ISSUE/REVISION RECORD

DATE	DESCRIPTION
09/04/18	ISSUED FOR PERMIT

PROJECT NAME
PEACHTREE PKWY & ENG.

PROJECT ADDRESS
**PEACHTREE CORNERS
5780 PEACHTREE PKWY
PEACHTREE CORNERS, GA**

RACETRAC STORE NUMBER
1201

PROTOTYPE SERIES 5.5K 2.0
2018 RH MO

PLAN MODIFICATION NOTICE

SPB NO. DATE

STANDARD PLAN BULLETINS (SPB) MODIFY THE PROTOTYPE SERIES SET NOTED ABOVE. THE LISTED SPB REPRESENTS THE LATEST MODIFICATION INCORPORATED TO THIS PROTOTYPE SERIES SET AT ORIGINAL RELEASE. THE ISSUE/REVISION RECORD COLUMN ABOVE LISTS ANY REVISIONS OR SPB INCORPORATED IN THIS SET AFTER THE ORIGINAL RELEASE. CONTACT RACETRAC ENGINEERING AND CONSTRUCTION FOR ANY SUBSEQUENT BULLETINS NOT INCORPORATED HEREIN.

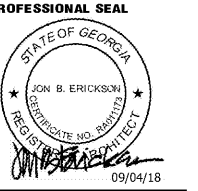

PROJECT NUMBER
18.703.00

SHEET TITLE
ROOF DETAILS

SHEET NUMBER
A201
ISSUED FOR PERMIT