

GENERAL NOTES

- ALL ENTRANCE/EXIT DOORS TO BUILDING SHALL BE MADE ACCESSIBLE TO PERSONS WITH DISABILITIES AND BE OPERABLE FROM THE INSIDE WITHOUT THE USE OF ANY SPECIAL KNOWLEDGE OR EFFORT.
- LATCHING AND LOCKING DOORS THAT ARE HAND ACTIVATED AND WHICH ARE IN A PATH OF TRAVEL SHALL BE OPERABLE WITH A SINGLE EFFORT BY LEVER TYPE HARDWARE, PANIC BARS, PUSH/PULL ACTIVATING BAR, OR OTHER HARDWARE DESIGNED TO PROVIDE PASSAGE WITHOUT REQUIRING THE ABILITY TO GRASP OR TWIST THE OPENING HARDWARE. LOCKED EXIT DOORS SHALL BE OPERABLE IN THE EGRESS DIRECTION.
- HAND ACTIVATED DOOR OPENING HARDWARE SHALL BE CENTERED BETWEEN 34" AND 48" ABOVE THE FLOOR.
- EVERY DOORWAY WHICH IS LOCATED IN A PATH OF TRAVEL SHALL PERMIT THE INSTALLATION OF A DOOR NOT LESS THAN 3FT IN WIDTH AND NOT LESS THAN 6" IN HEIGHT. WHEN INSTALLED, EXIT DOORS SHALL BE OPERATE AS ABOVE IN EGRESS DIRECTION.
- FOR HINGED DOORS, THE OPENING WIDTH SHALL MEASURED WITH THE DOOR POSITIONED AT AN ANGLE OF 90 DEGREES FROM ITS CLOSED POSITION.
- THE BOTTOM 10" OF ALL DOORS (EXCEPT AUTOMATIC SLIDING DOORS) SHALL BE A SMOOTH, LEVEL SURFACE. AUTOMATIC SLIDING DOORS SHALL ALLOW THE DOOR TO BE OPENED BY A WHEELCHAIR FOOTREST WITHOUT CREATING A TRAP OR HAZARDOUS CONDITION. WHERE HORIZONTAL BARRED GLASS IS USED, A 10" HIGH SMOOTH PANEL SHALL BE INSTALLED ON THE FLUSH SIDE OF THE DOOR WHICH WILL ALLOW THE DOOR TO BE OPENED BY A WHEELCHAIR FOOTREST WITHOUT CREATING A TRAP OR HAZARDOUS CONDITION. MAXIMUM EFFORT TO OPERATE DOORS SHALL NOT EXCEED 8.5 POUNDS FOR EXTERIOR DOORS, 5 POUNDS FOR INTERIOR DOORS AND 15 POUNDS FOR FIRE DOORS. WHEN SUCH EFFORT IS APPLIED AT RIGHT ANGLES TO HINGED DOORS AND AT THE CENTER PLANE OF SLIDING OR FOLDING DOORS, COMPENSATING DEVICES OR AUTOMATIC DOOR OPERATORS MAY BE UTILIZED TO MEET THE ABOVE STANDARDS. WHEN FIRE DOORS ARE REQUIRED, THE MAXIMUM EFFORT TO OPERATE THE DOOR MAY BE INCREASED TO THE MAXIMUM ALLOWABLE TO THE APPROPRIATE ADMINISTRATIVE AUTHORITY NOT TO EXCEED 15 POUNDS.
- THE SEPARATION DISTANCE TO EXIT OR EXIT ACCESS DOORWAY SHALL BE MEASURED PER JURISDICTIONAL REQUIREMENT.

RaceTrac
COPYRIGHT NOTICE
 THESE PLANS ARE SUBJECT TO FEDERAL COPYRIGHT LAWS. ANY USE OF SAME WITHOUT THE EXPRESSED WRITTEN PERMISSION OF RACETRAC PETROLEUM, INC. IS PROHIBITED. 2016 RACETRAC PETROLEUM INC.

DESIGN PROFESSIONALS
CHRISTOPHER HILLFOLEYROSSI & ASSOCIATES
 ARCHITECTURE
 ENGINEERING
 3680 Pleasant Hill Road
 Suite 200
 Duluth, Georgia 30096
 p 770.622.9858
 f 770.622.9535
 www.hillfoleyrossi.com

ISSUE/REVISION RECORD

DATE	DESCRIPTION
09/04/18	ISSUED FOR PERMIT

RaceTrac
 RACETRAC PETROLEUM, INC.
 200 GALLERIA PARKWAY SOUTHEAST
 SUITE 900
 ATLANTA, GEORGIA 30339
 (770) 431-7600

PROJECT NAME
PEACHTREE PKWY & ENG.

PEACHTREE CORNERS
 5780 PEACHTREE PKWY
 PEACHTREE CORNERS, GA
RACETRAC STORE NUMBER
1201

PROTOTYPE SERIES 5.5K 2.0
2018 RH MO
PLAN MODIFICATION NOTICE

SPB NO. DATE

STANDARD PLAN BULLETINS (SPB) MODIFY THE PROTOTYPE SERIES SET NOTED ABOVE. THE LISTED SPB REPRESENTS THE LATEST MODIFICATION INCORPORATED TO THIS PROTOTYPE SERIES SET AT ORIGINAL RELEASE. THE ISSUE/REVISION RECORD COLUMN ABOVE LISTS ANY REVISIONS OR SPB INCORPORATED IN THIS SET AFTER THE ORIGINAL RELEASE. CONTACT RACETRAC ENGINEERING AND CONSTRUCTION FOR ANY SUBSEQUENT BULLETINS NOT INCORPORATED HEREIN.

PROFESSIONAL SEAL

STATE OF GEORGIA
 JON B. ERICKSON
 REGISTERED PROFESSIONAL ARCHITECT
 09/04/18

PROJECT NUMBER
 18.703.00

SHEET TITLE
ACCESSIBILITY PLAN

SHEET NUMBER
A002
 ISSUED FOR PERMIT

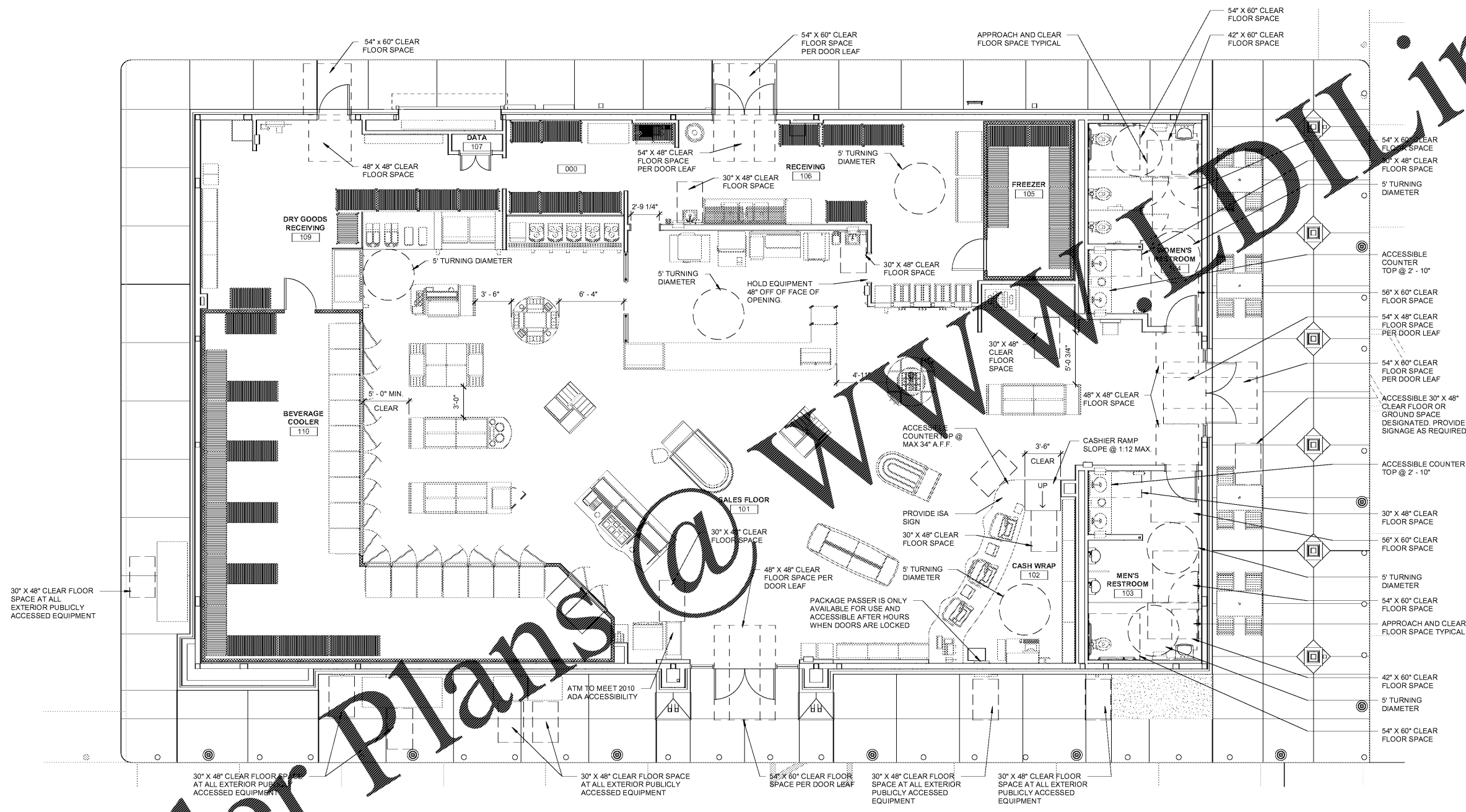

1 ACCESSIBILITY PLAN

Order Plans @