

1 **PUMP ISLAND DETAIL** N.T.S.

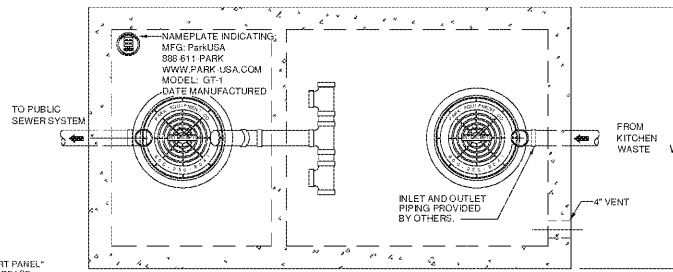

PLAN VIEW

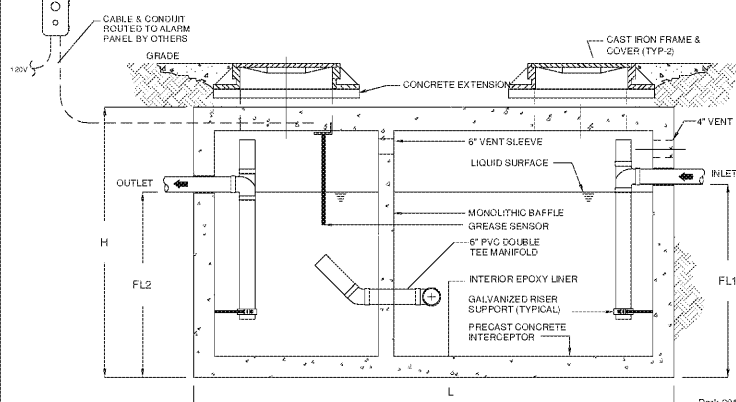

ELEVATION

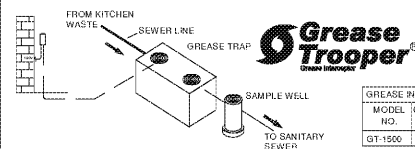

GREASE INTERCEPTOR SCHEDULE							
MODEL NO.	CAPACITY USQM	GREASE CAP. (LBS)	EMPTY WT (LBS)	LENGTH L	WIDTH W	HEIGHT H	INLET/OUTLET FL1/FL2
GT-1500	1,500	3,300	16,050	9'-2"	5'-8"	7'-0"	5'-0"/5'-6"

OTHER SIZES ARE AVAILABLE. CONTACT SALES FOR MORE INFORMATION.

Specifications

CONCRETE: Class II concrete with design strength of 4500 PSI at 28 days. Units of monolithic construction at floor, first stage of wall and built up sectional riser to required depth. (Monolithic baffle required, slide-in type is not acceptable).

REINFORCEMENT: Grade 60 reinforced with steel rebar conforming to ASTM A515 on required cantors or equal.

C.I. CASTINGS: Manhole frames, covers or grates are manufactured of gray cast iron conforming to ASTM A147 Class 30. Manhole shall be nominal 24 inch diameter and be traffic.

Engineering Data

The grease interceptor is structural and shall comply with applicable plumbing codes recommended in monolithic construction. Consult local authority for specific application requirements.

Shop drawings shall include complete structural analysis calculations certified by a professional engineer.

Consult with Park Equipment Company for exact dimensions & shipping information.



GREASE INTERCEPTOR SERIES GT		1,500 GALLON CAPACITY	
NONE	DWG. NO.	REV.	
DATE	2012	GT-1	A

GREASE TRAP
1,500 GALLON CAPACITY
& SAMPLE WELL DETAILS
"OR APPROVED EQUAL"

4 **SD2** 1. ENGINEER OF RECORD APPROVAL REQUIRED FOR "APPROVED EQUAL" N.T.S.

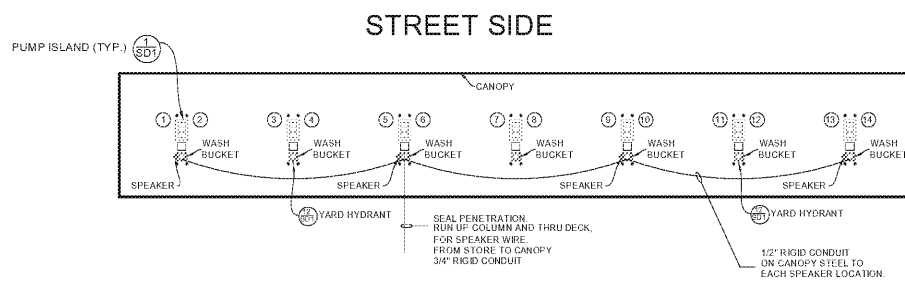

STREET SIDE



STORE SIDE

2 **SD2** 1. SINGLE ROW OF 7 MPD'S
2. REFER TO CANOPY PLANS FOR CANOPY DIMENSIONS AND COLUMN LOCATIONS. N.T.S.

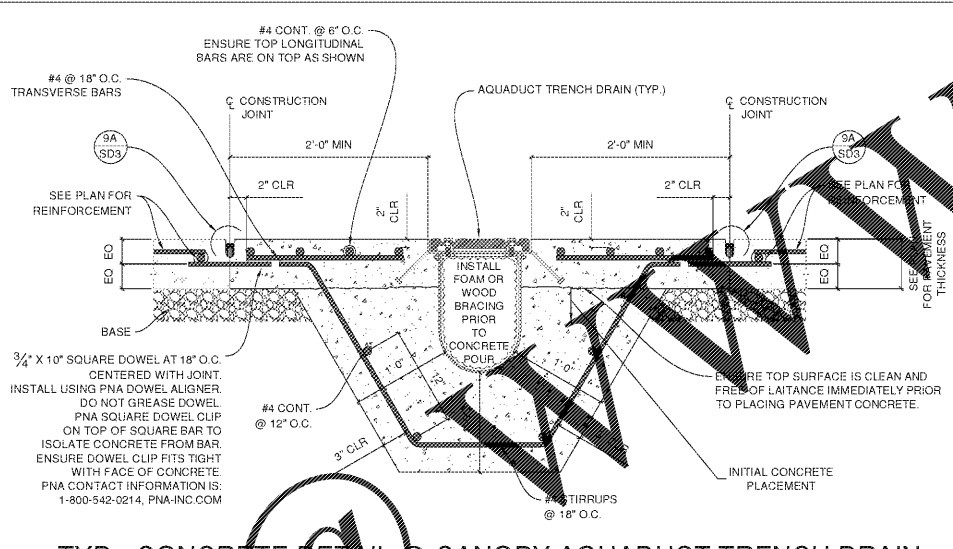

5 **SD2** **TYP. CONCRETE DETAIL @ CANOPY AQUADUCT TRENCH DRAIN** N.T.S.

- G.C. MUST READ INSTALLATION INSTRUCTIONS PRIOR TO INSTALLATION OF AQUADUCT TRENCH DRAIN.
- REFER TO DETAIL (SD2) FOR BRACING RECOMMENDATIONS.
- EACH TRENCH DRAIN IS INDIVIDUALLY DIMENSIONED AND SIZED BY AQUADUCT, INC. (REFER TO DESIGN SPECS FOR EXACT SIZING.)
- SOME PROJECTS MAY HAVE MULTIPLE TRENCH DRAINS ON SITE. (REFER TO "GRADING PLAN" FOR EXACT LOCATIONS.)

NOTES:

- LIGHT POLES SHALL BE AS PER AAL PROVIDED BY RACETRAC AND TO BE INSTALLED BY GENERAL CONTRACTOR. SEE SITE PLAN FOR POLE LOCATIONS.
- LIGHT FIXTURES SHALL BE AS PER SPECTRA SP2 AREA LIGHTING MODEL WITH 190 FOOT MAX. CEILING. DR POST TOP MOUNT WITH A MAXIMUM EFFECTIVE PROJECTED AREA OF 0.63 S.F. (REFER TO "PHOTOMETRIC PLAN" FOR DETAILS). ONE LIGHT FIXTURE PER POLE.

WIND DESIGN CRITERIA BASED ON THE FOLLOWING:

ASCE 7-10
 WIND-50 MPH WITH EXPOSURE C RISK CATEGORY II
 V₅₀-50 MPH
 C. V₅₀-50 MPH
 D. IMPORTANCE FACTOR I = 1.0
 E. DESIGN WIND PRESSURE = -19.2 PSF

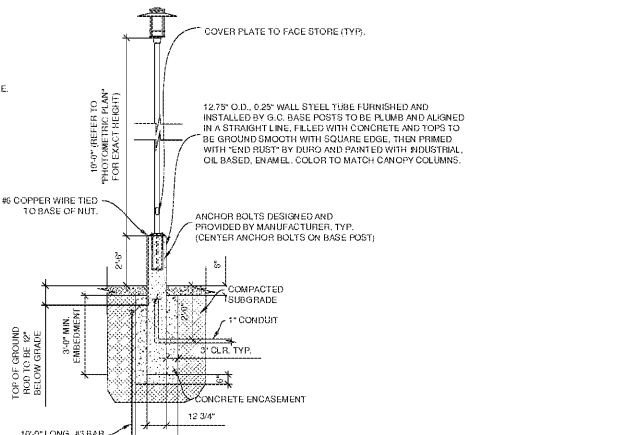

7 **SD2** **TYP. DECORATIVE LIGHTING SECTION 120 MPH WIND (Vult)** N.T.S.

- LIGHT POLES SHALL MEET 93 MPH WIND (V₉₃), 120 MPH (V₁₂₀).
- CONCRETE SHALL HAVE A 28 DAY COMPRESSIVE STRENGTH (F_c) OF 3,500 PSI FOR ALL LIGHT POLE FOOTINGS.
- ALL REINFORCING STEEL SHALL BE NEW DOMESTIC DEFORMED BILLET STEEL CONFORMING TO ASTM A-615 GRADE 60.

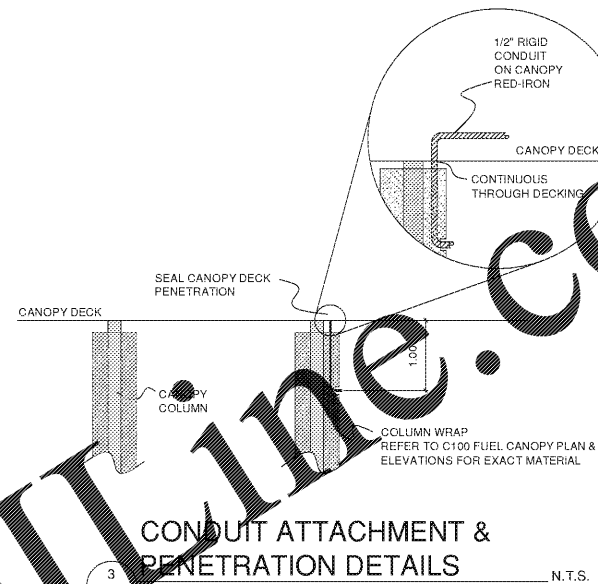

3 **SD2** **CONDUIT ATTACHMENT & PENETRATION DETAILS** N.T.S.

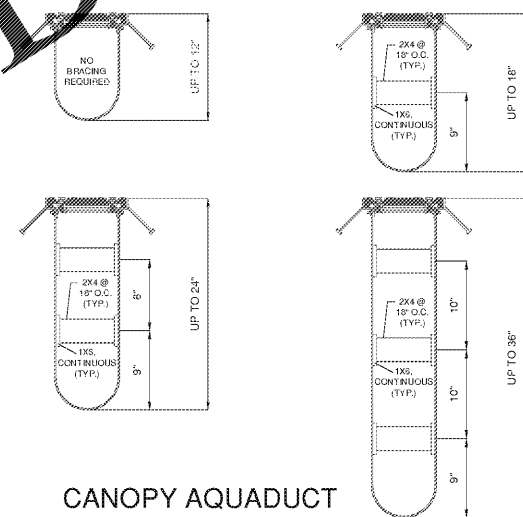

6 **SD2** **CANOPY AQUADUCT TRENCH DRAIN BRACING LAYOUT DETAILS** N.T.S.

- OVER 36" ADD AN ADDITIONAL LEVEL OF BRACING FOR EACH ADDITIONAL 12" OF DEPTH.

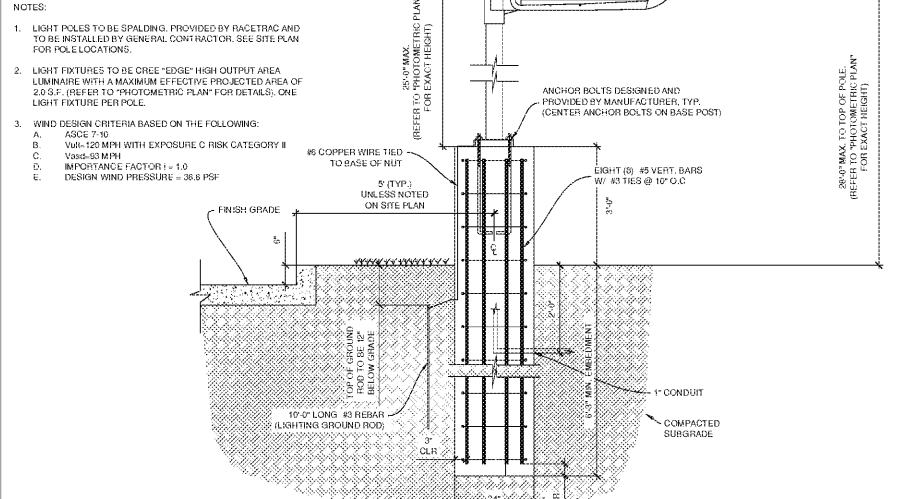

8 **SD2** **TYP. SITE LIGHTING SECTION 120 MPH WIND (Vult)** N.T.S.

- LIGHT POLES SHALL MEET 93 MPH WIND (V₉₃), 120 MPH (V₁₂₀).
- CONCRETE SHALL HAVE A 28 DAY COMPRESSIVE STRENGTH (F_c) OF 3,500 PSI FOR ALL LIGHT POLE FOOTINGS.
- ALL REINFORCING STEEL SHALL BE NEW DOMESTIC DEFORMED BILLET STEEL CONFORMING TO ASTM A-615 GRADE 60.
- CONCRETE ABOVE FINISH GRADE TO BE SMOOTH WITH RUBBED FINISH.
- CONCRETE LIGHT POLE BASES TO BE PAINTED TO MATCH BOLLARD.

02/25/18	06/29/18								
1 JURISDICTIONAL COMMENTS									
5 OWNER REVISIONS & JURISDICTIONAL COMMENTS									
 10000 HIGHWAY SUITE 200 DALLAS, GEORGIA 30096 (770) 325-3357									
THESE PLANS ARE SUBJECT TO FEDERAL COPYRIGHT LAWS. ANY USE OF SAME WITHOUT THE WRITTEN PERMISSION OF RACETRAC PETROLEUM, INC. IS PROHIBITED.									
 RACETRAC PETROLEUM, INC. 200 GALLERIA PARKWAY, SUITE 900, ATLANTA, GA 30339 (770) 431-7600									
RACETRAC STANDARD DETAILS PEACHTREE CORNERS RACETRAC 5780 PEACHTREE PARKWAY PEACHTREE CORNERS, GEORGIA GWINNETT COUNTY DIST. 6, LL 284, PARCELS: 6-284-16, 18, 40, 56									
DRAWN BY: JCW		DATE: 01/15/2018		SCALE: NTS		DRAWING NAME: 4607.00-SD-DETAILS.dwg			
SD2		1		SHEET NO.		VERSION			