

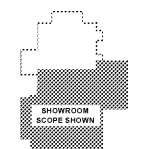

Signed & Sealed: 08/30/18
Copyright © 2014 YSM Design, P.C.
All rights reserved. No part of this document may be reproduced or transmitted in any form or by any means electronic or mechanical, including photocopying, recording, or by any information storage and retrieval system, without the prior written permission of YSM Design, P.C. It is to be returned upon request. Please do not write or mark on the original drawing.

Rev	Date	Comments
	08/30/18	Permit/Bid Set

BID SET
Every Contractor or Subcontractor, by submitting a bid for this project declares that they have reviewed all aspects of this project and have included all work required to provide a complete project that meets all building codes.
If questions or discrepancies are found between trades, these should be submitted by the Bidding General Contractor as a Request For Information before bids are due. These clarifications will be issued to all Bidders in Atlanta. No consideration will be given after the bid date for issues that could clearly have been answered during the Bidding Period.
Information to all Bidders:
For more information about this bid, including a list of the most current documents, instructions to Bidders, Responsibility Chart, answers to RFI, etc., go to project website. Note this address will be provided to bidders with invitation to bid.
It is the responsibility of ALL Bidders to become familiar with this site and the additional information that is contained therein. If you do not have access to the internet you MUST contact your General Contractor for this information. No Change Orders will be accepted for not reviewing this information.
No consideration will be given for Change Order Requests based on any of the following:
1. Items requiring clarification but not clearly indicated as an exception on the bid set.
2. Items requiring clarification but not submitted to Architect as a request for information during bidding.
3. Items deemed to be industry standards for a particular system or assembly.
4. Items that can reasonably be inferred from contract documents.



Key Plan - Proposed



JIM ELLIS CADILLAC
5880 PEACHTREE BLVD
ATLANTA, GA 30341

Project:
JIM ELLIS CADILLAC
5880 PEACHTREE BLVD
ATLANTA, GA 30341

Project Number: 18020
Drawn By: GD
Checked By: DF
Approved By: SM

Sheet Title:
DOMESTIC WATER PLAN - FIRST FLOOR

Sheet Number:
P301

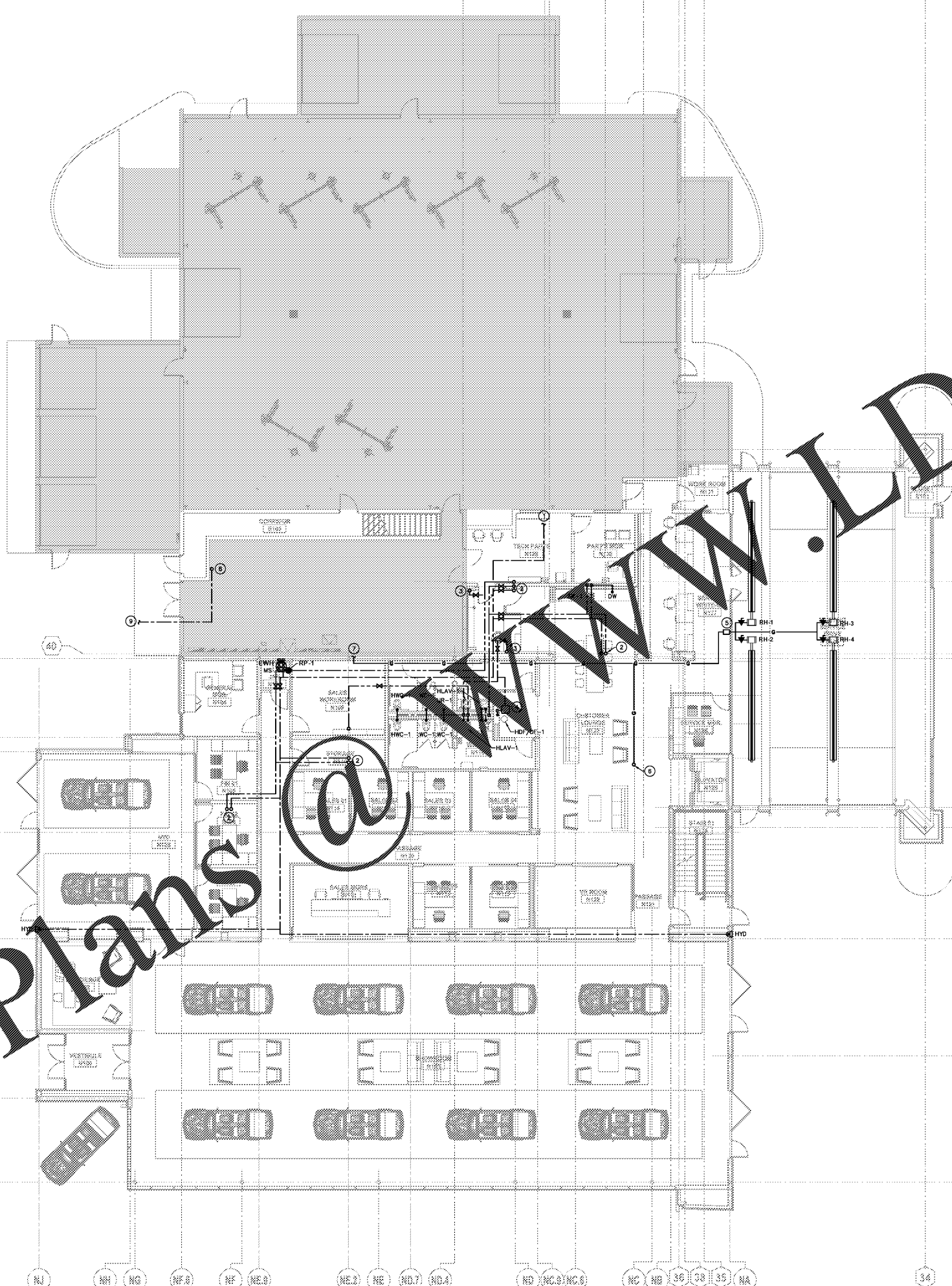

- KEY NOTES**
- CONNECT NEW 2" COLD WATER LINE TO EXISTING 1-1/2" COLD WATER LINE. FIELD VERIFY EXACT LOCATION.
 - HOT AND COLD WATER LINES TO SECOND FLOOR. SEE SHEET P302 FOR CONTINUATION.
 - COLD WATER LINE TO SECOND FLOOR. SEE SHEET P302 FOR CONTINUATION.
 - DRINKING FOUNTAIN CHILLER ABOVE CEILING. SEE PLUMBING FIXTURE SCHEDULE ON SHEET P001 FOR DETAILS.
 - PROVIDE GAS CONNECTION WITH PRESSURE REGULATOR FROM 2.0 PSI TO 0.5 PSI (TYPICAL OF ALL). SEE GAS CONNECTION DETAIL ON SHEET P001.
 - GAS LINE TO ROOF. SEE SHEET P203 FOR CONTINUATION.
 - CONNECT TO EXISTING GAS LINE THIS AREA. FIELD VERIFY EXACT LOCATION.
 - 6" FIRE SPRINKLER RISER. COORDINATE EXACT LOCATION WITH ARCHITECT OR OWNER.
 - 6" FIRE SPRINKLER LINE BELOW GRADE. SEE CIVIL PLANS FOR CONTINUATION.

EXISTING PLUMBING SYSTEM SERVICING NOTES

CONTRACTOR SHALL PROVIDE SERVICING OF ALL EXISTING SANITARY SYSTEMS. SERVICE SHALL INCLUDE JETTING / CLEANING AND A SEWER CAMERA OF ALL PIPING WITH REPORT OF FINDINGS. CONTRACTOR SHALL PROVIDE REPAIR RECOMMENDATIONS FOR ANY DEFICIENCIES SUCH AS DIPS AND BREAKAGES FOUND IN SYSTEM WITH COSTS FOR EACH FINDING.

NOTE
PLUMBING CONTRACTOR SHALL VERIFY LOCATION, SIZE, DIRECTION OF FLOW AND INVERTS OF ALL EXISTING UTILITIES PRIOR TO BEGINNING OF CONSTRUCTION. ADVISE ENGINEER OF ANY DISCREPANCIES.

DOMESTIC WATER ADD ALTERNATE

PROVIDE ALTERNATE PRICE TO INCREASE THE BUILDING'S DOMESTIC WATER SERVICE TO A 2" LINE WITH A 1-1/2" WATER METER. WATER LINE SIZE SHALL BE INCREASED FROM WHERE THE DOMESTIC WATER ENTERS THE BUILDING UP TO THE NEW WATER LINE.

1 DOMESTIC WATER PLAN - FIRST FLOOR
1/8" = 1'-0"

Order Plans

WWW.LDLINE.COM

REQUIRED FOR CONSTRUCTION