

D:\esanz\2018\JIM ELLIS CADILLAC_08122018.rvt
8/31/2018 3:07 PM

Order Plans

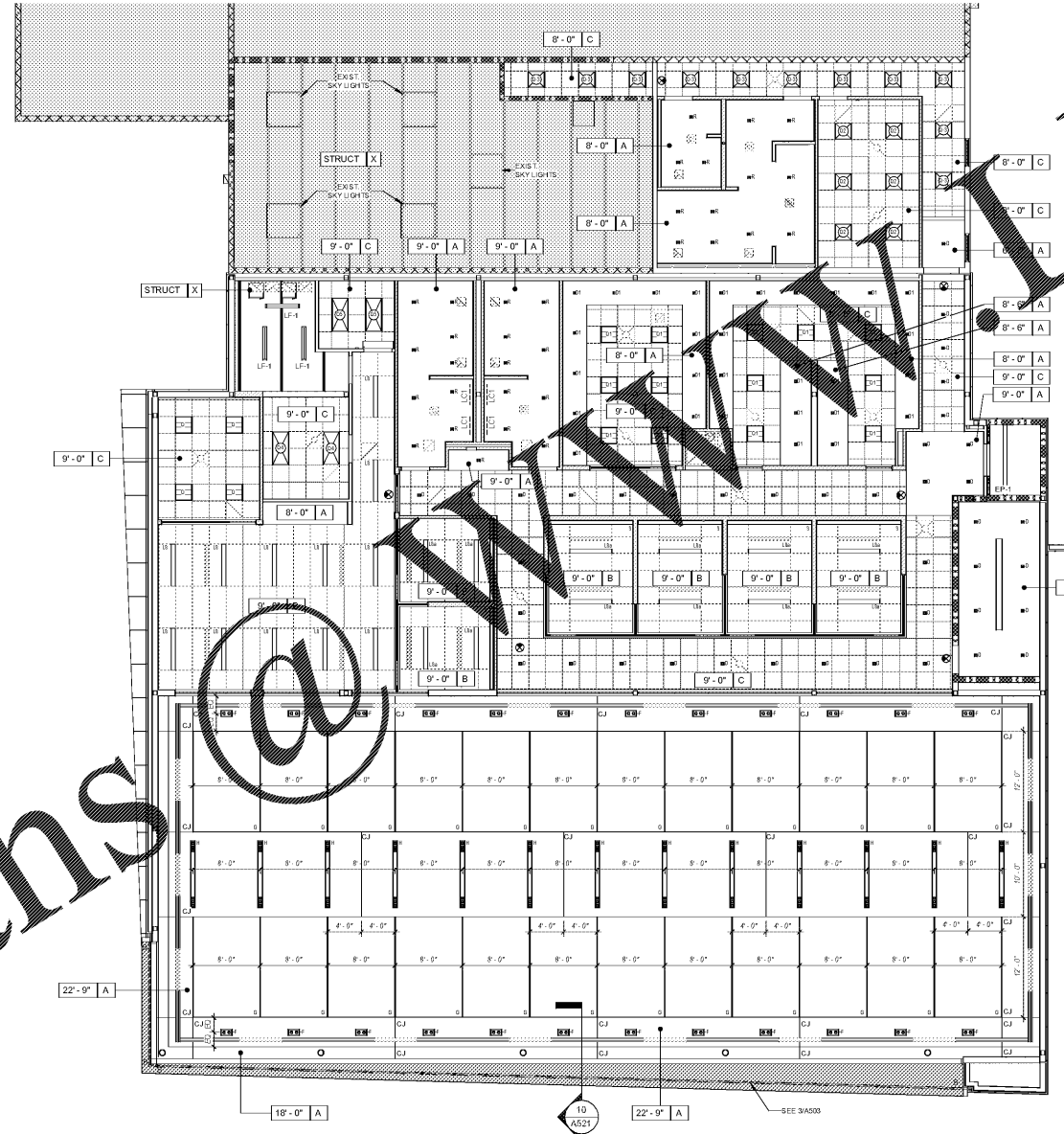

RCP NOTES

1. PROVIDE CONCEALED FIRE SPRINKLER HEADS IN ALL GYP CEILINGS. PROVIDE CONCEALED FIRE SPRINKLER HEADS IN ALL SPECIALTY "MONOLITHIC" TILE CEILINGS, SUCH AS HUNTER DOUGLAS "TECHNICAL" AND "ARTIST" SERIES TO GUARANTEE.
2. INSURE ALL CONTROL JOINTS IN ALL GYP CEILINGS AND SOFFITS. INSTALL AT ALL INSIDE CORNERS AND COLUMN/PIER INTERSECTIONS, AND AT OTHER LOCATIONS AS SHOWN.
3. ALL GYP "CLOUD" CEILINGS SHALL RECEIVE A LEVEL 5 FINISH.

SITE LIGHTING NOTES

1. UNLESS OTHERWISE LIMITED BY AHJ, PROVIDE MIN. AVERAGE 30 FOOT CANDLES AT THE FRONT LINE.
2. PROVIDE MINIMUM 1.5 FOOT CANDLE UNIFORMITY ACROSS THE WAREHOUSE AND CUSTOMER PARKING AREA OF THE SITE.
3. PROVIDE ONE (1) WAX - TO 4M AT THE FRONT LINE AND INVENTORY AREAS IMMEDIATELY ADJACENT TO THE FRONT OF THE WAREHOUSE.
4. PROVIDE ALL POLE LIGHTS WITH AN ANGLE COB-41 2-PIN DIMMING RECEPTACLE.
5. PROVIDE EVERY OTHER POLE WITH A 120V CONVENIENCE OUTLET.
6. PROVIDE CUTOFF SHIELD AS REQUIRED TO MEET ZONING REQUIREMENTS, AND TO MEET LEED TITLE 24 REQUIREMENTS WHERE APPLICABLE.

INDOOR LIGHTING NOTES

1. SEE ELECTRICAL DRAWINGS FOR COMPLETE LIGHTING INFORMATION. LIGHT FIXTURES SHOWN ON THE ARCHITECTURAL PLAN ARE FOR COORDINATION ONLY.
2. UNLESS NOTED OTHERWISE, VEHICLE DISPLAY LIGHTING SHALL BE 400K AND 300K MINIMUM.
3. GC AND LIGHTING VENDORS SHALL EXAMINE THE SPECIFICATIONS FOR SPECIAL CEILING SYSTEMS DRAWINGS AND COORDINATE LIGHTING AND MECHANICAL FIXTURES AS REQUIRED.

CEILING LEGEND

	HVAC SUPPLY - SEE MECHANICAL		EXHAUST - SEE MECH.
	HVAC RETURN - SEE MECHANICAL		CEILING ACCESS PANEL
	SLOT DIFFUSER - SEE MECHANICAL		SLOT LIGHT - SEE ELECTRICAL
	LAY IN LIGHT FIXTURE ELECTRICAL		EMERGENCY LIGHT - SEE ELECTRICAL
	EMERGENCY LIGHT - SEE ELECTRICAL		ALL PACK - ELECTRICAL
	RECESSED DOWNLIGHT ELECTRICAL		RECESSED WASHDOWN ELECTRICAL

CEILING SCHEDULE

A	GYP 5/8" WALLBOARD - SEE FINISH SCHEDULE FOR PAINT
B	ACOUSTICAL TILE (ACT-1)
C	2" X 2" ACOUSTICAL TILE (ACT-2)
D	
H	
L	
M	
N	
X	EXPOSED TO STRUCTURE, PAINTED PT-1
Z	

HATCH AREA

	HATCH AREA INDICATES 1-HOUR RATED ASSEMBLY		HATCH AREA INDICATES 2-HOUR RATED ASSEMBLY
--	--	--	--

SCOPE OF WORK LEGEND

NOTE: THESE DESIGNATIONS ARE SPECIFIC TO EACH DRAWING SHEET. GC SHALL REVIEW SCOPE INDICATED ON EVERY SHEET.

- HATCH REPRESENTS AREAS OUT OF PROJECT SCOPE. NO WORK SHALL BE DONE IN THESE AREAS, U.O.
- IN-SCOPE WORK IS SPECIFICALLY DETAILED IN THE CONSTRUCTION DOCUMENTS.
- HATCH REPRESENTS AREAS OF LIMITED SCOPE. SEE NOTE BELOW.

LIMITED SCOPE INCLUDES WALL PAINT, WALL BASE, ELECTRICAL DEVICE COVER PLATES & OFFICERS, GRILLES, AND REGISTER.
REPAIR AND PREP EXISTING CONSTRUCTION AS REQUIRED PRIOR TO PAINTING FOR "LIKE NEW" CONDITION. REPAIR/REPLACE WALL BASE & ELECTRICAL DEVICE COVER PLATES AS REQUIRED. REPLACE DAMAGED OFFICERS AND GRILLES TO MATCH ADJACENT SPECIFICATION, AND CLEAN ALL DIFFUSERS AND GRILLES DETERMINED TO REMAIN. THESE ITEMS MUST BE VISIBLY INSPECTED BY THE GC TO DETERMINE SCOPE AND PRICE FOR THE CLIENT AT THE TIME OF BID. THESE ITEMS ARE NOT SPECIFICALLY INDICATED IN THIS SET OF CONSTRUCTION DOCUMENTS.

ysm DESIGN
SPECIALTY AUTOMOTIVE DESIGN & CONSTRUCTION

1320 Ellsworth Industrial Blvd
Suite A-100
Atlanta GA 30318
404-249-4555
404-355-6356
www.ysmdesign.com



Signed & Sealed: 31 AUG 2018

Copyright (c) 2018 YSM Design, P.C.
All rights reserved. Specifications, computer files, text data, notes and other documents and information prepared by YSM Design, P.C. are the work product of YSM Design, P.C. and shall remain confidential, including copyright therein.
This drawing may not be reproduced in whole or in part without written permission of YSM Design, P.C. or its authorized representative. Such as stated in any other valid on the original drawing.

Rev	Date	Comments

BID SET

Every Contractor or Subcontractor, by submitting a bid for this project declares that they have reviewed all aspects of this project and have included all work required to provide a complete project that meets all building codes.

If questions or discrepancies are found between trades, these should be submitted by the building General Contractor as a Request for Information on this bid. These clarifications will be issued to all Bidders in Atlanta. No consideration will be given after the bid date for issues that could clearly have been assumed during the bidding period.

Information to all Bidders:
For more information about this bid, including a list of the most current documents, instructions to Bidders, Responsibility Chart, answers to RFI, etc., go to project website. Note: this address will be provided to bidders with invitation to bid.

It is the responsibility of ALL Bidders to become familiar with this set and the additional information that is contained therein. If you do not have access to the internet, you MUST contact your General Contractor for this information. NO Change Orders will be accepted for not reviewing this information.

No consideration will be given for Change Order Requests based on any of the following:

1. Items requiring clarification but not clearly indicated as an exception on the bid.
2. Items requiring clarification but not submitted to Architect as a request for information during bidding.
3. Items deemed to be industry standard for a particular system or assembly.
4. Items that can reasonably be inferred or assumed from contract documents.



Client:
JIM ELLIS CADILLAC
5880 PEACHTREE BLVD
ATLANTA, GA 30341

Project:
JIM ELLIS CADILLAC
5880 PEACHTREE BLVD
ATLANTA, GA 30341

Project Number: 18020
Drawn By: Author
Checked By: Checker
Approved By: Approver

Sheet Title:
RCP

Sheet Number:
A182