

D:\sales\12019 - JIM ELLIS CADILLAC - eanaher.rvt  
 8/3/2018 3:07 PM

Order Plans

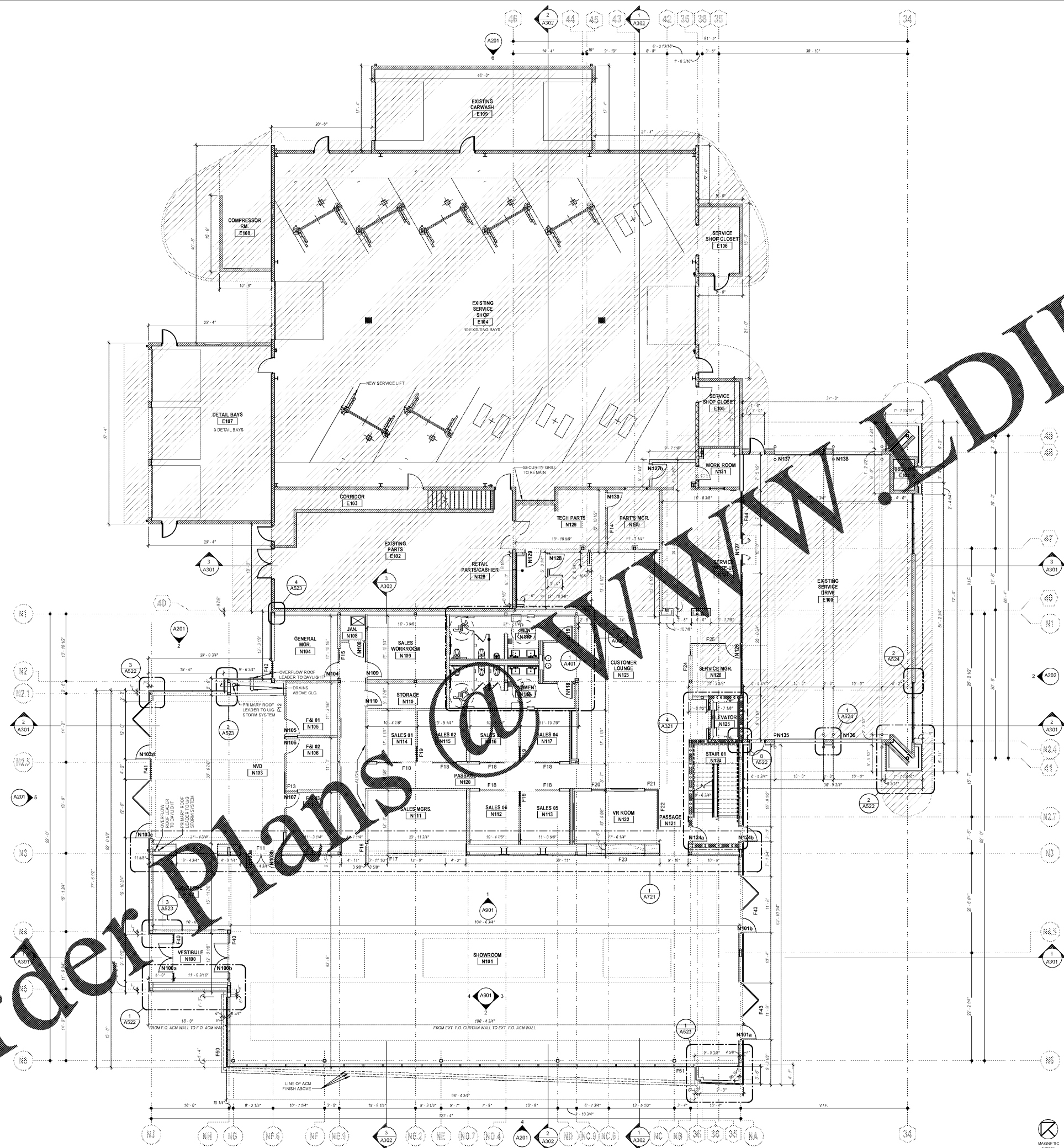

**PLAN NOTES**

- SEE CODE PLAN FOR FIRE EXTINGUISHERS
- SEE SLAB PLANS FOR SLAB EDGES, HEIGHTS, MESSGS, AND MASONRY WALLS THAT FORM SLAB EDGES
- SEE ADA PLAN FOR ACCESSIBLE ROUTE, CLEARANCES AND FLOOR ELEVATION CHANGES
- SEE F&E PLAN FOR FURNITURE, FIXTURES, MILLWORK, AND EQUIPMENT
- ALL DIMENSIONS ARE TO FACE UNLESS OTHERWISE NOTED
- SEE FINISH PLAN FOR WALL, TILE AND WOOD WALL PANEL LOCATIONS
- SEE PARTITION TYPES LEGEND FOR PARTITION SECTION AND DESCRIPTION
- PARTITION SHOWINGS FOR ARCHITECTURAL COORDINATION, WHERE PROVIDED, REFER TO METAL STUD ENGINEERING DRAWINGS FOR STUD SIZES
- TOP ELEVATION REPRESENTS TOP OF GYP FINISH. STUD FRAMING MAY CONTINUE TO DECK, OR BE BRACED TO DECK, AS REQUIRED BY ENGINEER STUD DRAWINGS. GC SHALL FIELD COORDINATE WITH OTHER BUILDING SYSTEMS

**METAL STUD ENGINEERING**

ALL METAL STUD CONSTRUCTION SHALL BE DESIGNED AND SEALED BY AN ENGINEER LICENSED IN THE JURISDICTION WHERE THIS PROJECT IS LOCATED. IF ENGINEER STUD DRAWINGS AND CALCULATIONS ARE NOT PROVIDED BY THE DESIGN TEAM AS PART OF THE CONTRACT DOCUMENTS, THE GC AND ITS SUBCONTRACTOR SHALL PROVIDE STUD ENGINEERING DRAWINGS AND CALCULATIONS, SEALED BY AN ENGINEER, SUBMITTED TO THE DESIGN TEAM FOR REVIEW, AND SUBMITTED TO THE LOCAL AUTHORITY HAVING JURISDICTION AS REQUIRED.

SEE STRUCTURAL DRAWINGS, STUD DRAWINGS, AND SPECIFICATIONS FOR DESIGN CRITERIA.

NOT ALL STUD FRAMING MAY BE SHOWN. GC SHALL PROVIDE STUD FRAMING AT ALL LOCATIONS WHERE SHEATHING AND FINISHES ARE SHOWN THAT REQUIRE SUPPORT.

- THESE ITEMS, INCLUDING MEMBER SIZES, SPACING, AND CONNECTIONS, SHALL BE ENGINEERED:
  - ALL EXTERIOR FRAMING
  - INTERIOR AND EXTERIOR CONNECTIONS WHERE STUDS ARE HUNG FROM THE DECK OR STRUCTURE ABOVE
  - INTERIOR FRAMING USED AS SUPPORT FOR ACCORDIAN PARTITIONS
  - INTERIOR PARTITIONS TO DECK OR STRUCTURE ABOVE AND TO FLOOR, FLOOR FINISHED INTERIOR PARTITIONS
- THESE ITEMS ARE THE SOLE RESPONSIBILITY OF THE GENERAL CONTRACTOR AND SUBCONTRACTOR. DO NOT REQUIRE SEALED ENGINEERING (SUBJECT TO LOCAL AUTHORITY REQUIREMENTS):
  - INTERIOR PARTITIONS LESS THAN 11 FT HEIGHT
  - INTERIOR PARTITION OVER-HEAD BRACING
  - CONNECTIONS TO STRUCTURE ABOVE AND TO FLOOR
- INTERIOR PARTITIONS TO RECEIVE TELEVISIONS SHALL BE ENGINEERED FOR DEFLECTION UNDER AND FOR 11 AS RECOMMENDED BY THE TELEVISION MANUFACTURER OR TELEVISION MANUFACTURER. UNLESS APPROVED BY THE STRUCTURAL ENGINEER OR PROFESSIONAL ENGINEER.
- DEFLECTION REFER TO STUDS AND/OR STUDS ENGINEERING DRAWINGS. IF NOT SHOWN, LIMIT DEFLECTION TO 1/16" PER BACK AND 1/8" PER FRONT. AND LOAD WHEN BACKING EPS OR METAL PANEL SIDING.
- IN JURISDICTIONS REQUIRING NDA OR OTHER APPROVALS FOR SYSTEMS INCLUDING, BUT NOT LIMITED TO, EPS, STUDS, METAL PANELS, AND MASONRY PARTS, THE NDA DESIGN WILL GOVERN. PLEASE REFER TO NDA NUMBERS SHOWN IN THESE DRAWINGS.
- UNLESS OTHERWISE INDICATED BY ENGINEERING DETAILS STUD SPACING MAY BE 24" O.C.

**SCOPE OF WORK LEGEND**

NOTE: THESE DESIGNATIONS ARE SPECIFIC TO EACH DRAWING SHEET. GC SHALL REVIEW SCOPE INDICATED ON EVERY SHEET.

- HATCH REPRESENTS AREAS OUT OF PROJECT SCOPE, NO WORK SHALL BE DONE IN THESE AREAS, U.N.O.
- IN-SCOPE WORK IS SPECIFICALLY DETAILED IN THE CONSTRUCTION DOCUMENTS.
- HATCH REPRESENTS AREAS OF LIMITED SCOPE, SEE NOTE BELOW.

LIMITED SCOPE INCLUDES WALL PANEL, WALL BASE, ELECTRICAL DEVICE COVER PLATES & REPAIR AND PREP EXISTING CONSTRUCTION AS REQUIRED PRIOR TO PAINTING FOR "LIKE NEW" CONDITION. REPAIR/REPLACE WALL BASE ELECTRICAL DEVICE COVER PLATES AS REQUIRED. REPLACE DAMAGED OFFERSERS AND GRILLS TO MATCH ADJACENT SPECIFICATION, AND CLEAN ALL DIFFUSERS AND GRILLS TO REMAIN. THESE ITEMS MUST BE VISIBLY INSPECTED BY THE GC TO DETERMINE SCOPE AND PRICE FOR THE CLIENT AT THE TIME OF BID. THESE ITEMS ARE NOT SPECIFICALLY INDICATED IN THIS SET OF CONSTRUCTION DOCUMENTS.

**SCOPE OF WORK LEGEND**

NOTE: THESE DESIGNATIONS ARE SPECIFIC TO EACH DRAWING SHEET. GC SHALL REVIEW SCOPE INDICATED ON EVERY SHEET.

- HATCH REPRESENTS AREAS OUT OF PROJECT SCOPE, NO WORK SHALL BE DONE IN THESE AREAS, U.N.O.
- IN-SCOPE WORK IS SPECIFICALLY DETAILED IN THE CONSTRUCTION DOCUMENTS.
- HATCH REPRESENTS AREAS OF LIMITED SCOPE, SEE NOTE BELOW.

LIMITED SCOPE INCLUDES WALL PANEL, WALL BASE, ELECTRICAL DEVICE COVER PLATES & REPAIR AND PREP EXISTING CONSTRUCTION AS REQUIRED PRIOR TO PAINTING FOR "LIKE NEW" CONDITION. REPAIR/REPLACE WALL BASE ELECTRICAL DEVICE COVER PLATES AS REQUIRED. REPLACE DAMAGED OFFERSERS AND GRILLS TO MATCH ADJACENT SPECIFICATION, AND CLEAN ALL DIFFUSERS AND GRILLS TO REMAIN. THESE ITEMS MUST BE VISIBLY INSPECTED BY THE GC TO DETERMINE SCOPE AND PRICE FOR THE CLIENT AT THE TIME OF BID. THESE ITEMS ARE NOT SPECIFICALLY INDICATED IN THIS SET OF CONSTRUCTION DOCUMENTS.

**PARTITION SYMBOL LEGEND**

W04 10'-0" = PARTITION TYPE 10'-0" ELEVATION TO TOP OF GYP FINISH

W04 10'-0" = SOUND BATT INSULATION WHERE INDICATED

**PARTITION LEGEND**

- 1-HOUR FIRE BARRIER
- 2-HOUR FIRE BARRIER
- 3-HOUR FIRE BARRIER
- EXISTING PARTITION
- PROPOSED PARTITION

**FIRE EQUIPMENT LEGEND**

ALL FIRE EXTINGUISHERS ARE TO MEET OR EXCEED NFPA 10 CODE STANDARDS.

- FE = SURFACE MOUNTED FIRE EXTINGUISHER
- REC = RECESSED OR SEMI-RECESSED FIRE EXTINGUISHER CABINET RECESSED IN STUD WALL 1/4" DEEPER
- FAP = FIRE ALARM CONTROL PANEL
- FAP = FIRE ALARM ANNUNCIATOR PANEL

**GRIDLINE TYPE LEGEND**

- NEW GRIDLINE
- EXISTING GRIDLINE
- F.O. MASONRY GRIDLINE
- Nx "N" - NEW WORK SCOPE
- Ex "E" - EXISTING CONSTRUCTION

**ysm DESIGN**  
 5574 AUTUMN DRIVE, SUITE 201, ATLANTA, GA 30318  
 404-249-4555  
 404-355-6394  
 www.ysm-design.com



Signed & Sealed: 31 AUG 2018  
 Copyright © 2018 YSM Design, P.C.

All reports, plans, specifications, computer files, hard data, notes and other documents and information prepared by YSM Design, P.C. are the property of YSM Design, P.C. and shall remain confidential. No part of this document may be reproduced or transmitted in any form or by any means, electronic, mechanical, photocopying, recording, or by any information storage and retrieval system, without the prior written permission of YSM Design, P.C. If you are not the intended recipient, please do not disseminate or act on the information contained herein.

| Rev | Date | Comments |
|-----|------|----------|
|     |      |          |

**BID SET**

Every Contractor or Subcontractor, by submitting a bid for this project, certifies that they have reviewed all aspects of this project and have included all work required to provide a complete project that meets all building codes.

Requests or discrepancies are based on the information provided in the bid set. The Contractor is responsible for providing a list of the most current documents, specifications to bidders. Responsibility Chart, answers to RFI, etc. go to project website. Note this address will be provided to bidders with invitation to bid.

For more information about this bid, including a list of the most current documents, specifications to bidders, Responsibility Chart, answers to RFI, etc. go to project website. Note this address will be provided to bidders with invitation to bid.

Use the responsibility of ALL bidders to become familiar with this bid and the additional information that is contained therein. If you do not have access to the internet you MUST contact your General Contractor for this information. NO CHANGE ORDERS will be accepted for bid reviewing this information.

No consideration will be given for Change Order Requests based on any of the following:

- Items requiring clarification but not clearly indicated as an exception on the bid set.
- Items requiring clarification but not submitted to Architect as a request for information during bidding.
- Items deemed to be industry standard for a particular system or assembly.
- Items that can reasonably be inferred or assumed from contract documents.

**PRO BUILDING SYSTEMS**  
 DESIGN BUILD CONTRACTORS

Client:  
**JIM ELLIS CADILLAC**  
 5880 PEACHTREE BLVD  
 ATLANTA, GA 30341

Project:  
**JIM ELLIS CADILLAC**  
 5880 PEACHTREE BLVD  
 ATLANTA, GA 30341

Project Number: 18020  
 Drawn By: ES  
 Checked By: AEA  
 Approved By: YSM

Sheet Title:  
**FIRST LEVEL - FLOOR PLAN**

Sheet Number:  
**A131**