

D:\sales\12018\JIM ELLIS CADILLAC_eplan\12018 3000.dwg
 8/31/2018 3:07 PM

Order Plans

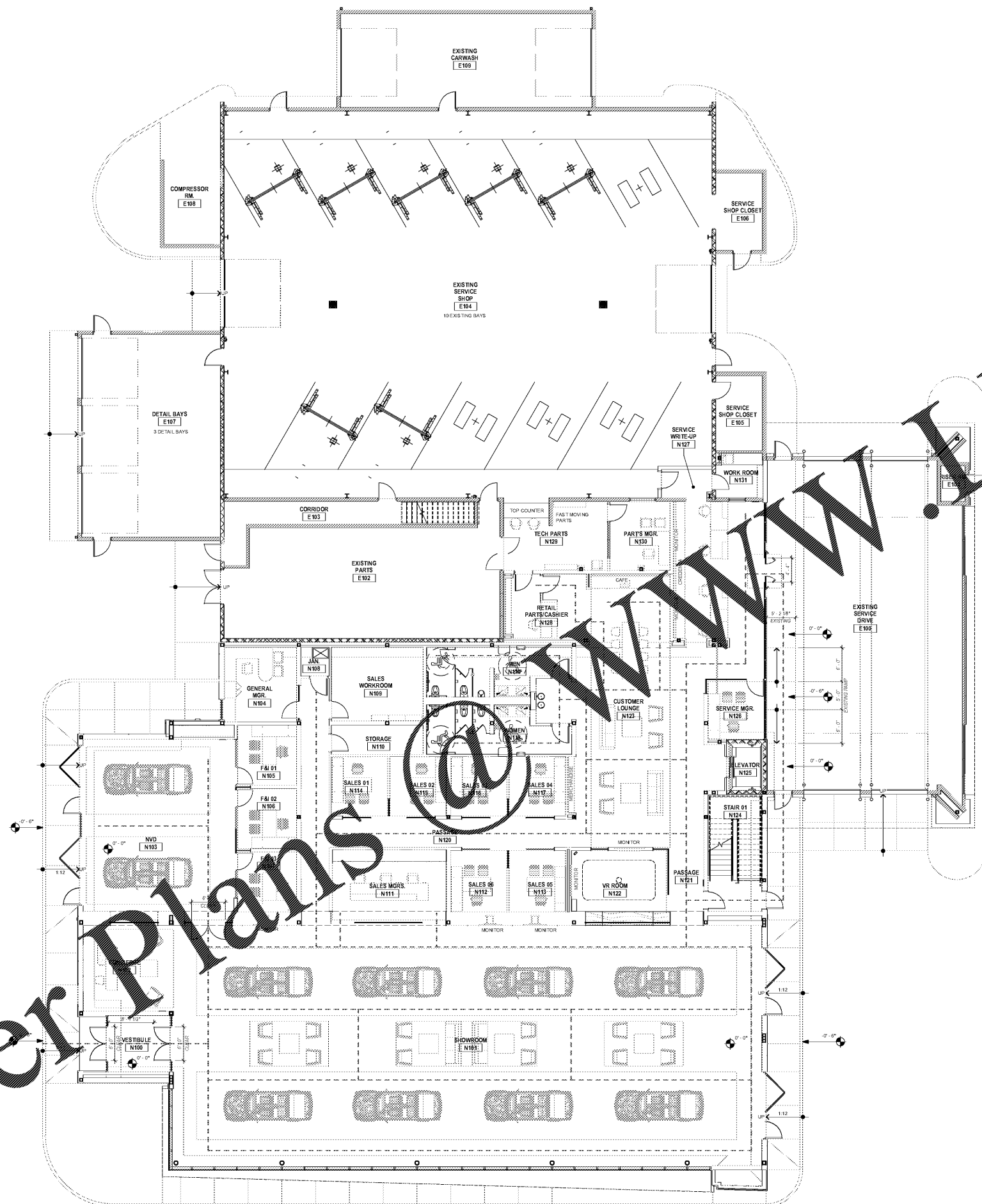

ACCESSIBILITY PLAN NOTES

- SEE SHEET A001 FOR RESTROOM ELEVATIONS DETAILING TOILET ACCESSORY INSTALLATION
- SEE SHEET A001 FOR LAVATORY MILLWORK DETAILS
- SEE SHEETS A001 AND A002 FOR STAIR, RAMP, AND RAILING DETAILS
- SEE SHEETS A001 AND A002 FOR STAIR, RAMP, AND RAILING DETAILS
- SEE ELEVATOR SHOP DRAWINGS FOR ELEVATOR DETAILS
- ALL TRANSITIONS BETWEEN FLOOR FINISHES WILL BE MADE LEVEL BY USING CEMENT LEVELING COMPOUND OR CARPET PADDING. ALL TRANSITIONS FROM A FLOOR FINISH TO CHOOSE FLOOR SLAB WILL BE MADE USING THE APPROPRIATE ACCESSIBLE METAL TRANSITION STRIP
- MAXIMUM CROSS SLOPE AT ACCESSIBLE PATH SHALL NOT EXCEED 1:48
- MAXIMUM RUN SLOPE AT ACCESSIBLE PATH SHALL NOT EXCEED 1:20

ACCESSIBILITY NOTES (ANSI A117.1:2009)

- Signage using the international symbol of accessibility shall be placed on the door(s) of the accessible restroom facilities.
- Water closet height shall be 17 to 19 inches, measured from the floor to the top of the toilet seat and shall be centered 16-18" from wall finish on grab bar side. Flush controls shall be 44" max above finished floor on accessible side. Ambulatory stall toilets water closets shall be centered 17" from the partition face.
- Where urinals are provided, at least one stall shall be well hung w/ an elongated rim at a maximum of 17 inches from the floor to the rim, and shall project 1-4" from the rear wall to the rim. A clear floor space of 30 inches by 48 inches shall be provided in front of the accessible urinal. Flush controls shall be 44" max above finished floor.
- Lavatories shall be mounted with a minimum clearance of 29 inches from the floor to the bottom of the apron, and a maximum of 34" to top surface. Plumbing shall be arranged so that the knee and toe clearance meet applicable disability standards. All plumbing under the lavatories shall be insulated, or concealed with a millwork enclosure that is not hot, sharp, or abrasive surfaces can cause injuries. Automatic, lever-operated devices are required on all lavatory faucets. Self-closing devices are permitted, provided the faucet remains operating for at least ten (10) seconds.
- Mirrors shall be mounted with the bottom edge no more than 40 inches from the floor and must be placed at a minimum of 4" high where shared with an ambulatory person. Tilted mirrors shall not be used where they create a glare on the face.
- Doors to the accessible toilet shall not swing into the clear width space required by any fixture.
- Grab bars shall be provided at toilet stalls and rooms. These bars shall be mounted 33 to 36 inches off the floor. A bar behind the toilet shall be 36 inches long, and the bar on the side of the toilet shall be 48 inches long. Other bars may be required by local authorities having jurisdiction.
- Where a drinking fountain is provided, there shall be a drinking fountain that is accessible to individuals with wheelchairs, and one accessible to those who have difficulty bending or stooping. This shall be accommodated by the use of a "N-40" fountain or an inverted "J" spout with a paper cup dispenser anchored to the wall. This fixture shall be mounted a minimum of 34 inches above the finish floor or ground.
- Force to open: All doors with self-closers shall conform to all applicable codes. Door closing force:
 Interior hinged doors - 5 lbs
 Sliding or folding doors - 5 lbs
 Fire doors shall have the minimum opening force allowable by NFPA-80. Egress doors shall meet applicable code requirements. All doors with self closers shall have a minimum sweep period of 5 seconds from 90 degrees open to 12 degrees open, to leading edge of door. (Per ICC/ANSI A117.1).
- Audio/Visual signal appliances complying with the requirements of ANSI A117.1 and NFPA 72 shall be provided.
- The elevation of the floor surfaces on both sides of a door opening shall not vary by more than 1/2 inch. The elevation shall be maintained for a distance at least equal to the width of the widest leaf of the doors. (NFPA Life Safety Code)
- Doors hardware: handles, pulls, latches, locks, and other operating devices on accessible doors shall have a shape that is easy to grasp with one hand and does not require tight grasping, tight pinching, or twisting of the wrist to operate. Lever-operated mechanisms, push-type mechanisms, and U-shaped handles are acceptable designs. Handles with detectable warning texture shall be used at all electrical and mechanical rooms and stairwells.

ysm DESIGN
 1320 Ellsworth Industrial Blvd
 Suite A-100
 Atlanta GA 30318
 404-249-4555
 404-355-6390
 www.ysm-design.com

PRO BUILDING SYSTEMS
 DESIGN BUILD CONTRACTORS

Signed & Sealed: 31 AUG 2018
 Copyright © 2018 YSM Design, P.C.
 All rights reserved. Reproduction, computer file, text data, notes and other documents and information contained by YSM Design, P.C. shall remain the property of YSM Design, P.C. and shall remain confidential. This drawing is not to be reproduced in whole or in part without written permission of YSM Design, P.C. or its authorized representative. Seals are checked and only valid on the original drawing.

Rev	Date	Comments

BID SET
 Every Contractor or Subcontractor, by submitting a bid for this project, certifies that they have reviewed all aspects of this project and have included all work required to provide a complete project that meets all building codes.
 If questions or discrepancies are found between trades, bidders should be submitted by the building General Contractor as a Request for Information to the Bidder, in Atlanta. These clarifications will be issued to all Bidders in Atlanta. No consideration will be given after the bid date for issues that could clearly have been assessed during the bidding period.
 Information to all Bidders:
 For more information about this bid, including a list of the most current documents, instructions to bidders, Responsibility Chart, answers to RFI, etc., go to project website. Note this address will be provided to bidders with invitation to bid.
 It is the responsibility of ALL Bidders to become familiar with this site and the additional information that is contained therein. If you do not have access to the internet you MUST contact your General Contractor for this information. NO CHANGE ORDERS will be accepted for not reviewing this information.
 No consideration will be given for Change Order Requests based on any of the following:
 1. Items requiring clarification but not clearly indicated as an exception on the bid.
 2. Items requiring clarification but not submitted to Architect as a request for information during bidding.
 3. Items deemed to be industry standard for a particular system or assembly.
 4. Items that can reasonably be inferred or assumed from contract documents.

Client:
JIM ELLIS CADILLAC
 5880 PEACHTREE BLVD
 ATLANTA, GA 30341

Project:
JIM ELLIS CADILLAC
 5880 PEACHTREE BLVD
 ATLANTA, GA 30341

Project Number: 18020
 Drawn By: ES
 Checked By: AEA
 Approved By: YSM

Sheet Title:
ADA

Sheet Number:
A004