

LEGEND

SYMBOL	DESCRIPTION	HEIGHT
—	HOME RUN	
—	HARD WIRED CIRCUITING	
—	CONDUIT RISE/DROP	
—	PANEL BOARD	TOP @ 6'-6"
—	TRANSFORMER	FLOOR
—	JUNCTION BOX (JBOX)	
—	DUPLEX RECEPTACLE, WHITE, 5-20R —: HUBBELL #HBL532W USB: USB - HUBBELL #USB20X2W WP: WITH WEATHER PROOF COVER SW: SWITCHED RECEPTACLE CONTROLLED BY EMS, PROVIDE LABEL STATING 'SWITCHED BY EMS' BLK: PROVIDE BLACK OUTLET & COVER PLATE	+18"
—	DUPLEX GFCI RECEPTACLE, WHITE, 5-20R —: HUBBELL #GFR532WTR	+18"
—	QUADPLEX RECEPTACLE —: (2) DUPLEX RECEPTACLES SW: DUAL CIRCUIT RECEPTACLE WITH ONE DUPLEX SWITCHED	+18"
—	MANUAL TOGGLE SWITCH, 277/120V, WHITE —: HUBBELL #1221W M: MOTOR - HUBBELL #HBL7832D	+48"
—	LOW VOLTAGE WIRING, #14 AWG UNO	
—	BELL: 24V, BRASS, 8W —: EDWARDS #432-G5	9'-0" AFF 12" B50
—	PUSHBUTTON: 24V, N/O, 6W —: EDWARDS #1784C-8 M: MULLION - EDWARDS #620	
—	DOOR BUZZER: 24V, 6W, LOUVERED COVER PLATE —: EDWARDS #1065-G5	9'-0" AFF 12" BFC
—	LV TRANSFORMER: 120/24VAC —: 45VA - EDWARDS #599	9'-0" AFF 6" AFC

SYMBOL	DESCRIPTION	HEIGHT
—	TEMPERATURE SENSOR: PROVIDE JBOX WITH 1/2" CONDUIT TO JOIST SPACE OR 6" AFC & 18 GA/2C SHIELDED CABLE TO RTU, REUSE EXISTING WHERE POSSIBLE.	+72"
—	FIRE ALARM AUDIO - VISUAL DEVICE	
—	CO2 SENSOR: PROVIDE JBOX WITH 1/2" CONDUIT TO JOIST SPACE OR 6" AFC.	+72"
—	DATA PORT: PROVIDE JBOX & 3/4" EMT WITH PULL WIRE TO 12" AFC OR INTO JOISTSPACE	+18"
—	CASEWORK PORT: PROVIDE JBOX IN CASEWORK	
—	TELEVISION OUTLET: PROVIDE JBOX & 3/4" EMT WITH PULL WIRE TO 12" AFC OR INTO JOISTSPACE	
—	WIRELESS ACCESS POINT: PROVIDE STEM MOUNTED JBOX FROM JOIST WITH 3/4" CONDUIT, SWIVEL MOUNT & PULL WIRE TO 12" AFC OR INTO JOISTSPACE	+13'-6"
—	PLUG & PLAY BOX WITH (2) STANDARD POWER CONNECTORS	101
—	SWITCHED PLUG & PLAY BOX, SWITCHED BY EMPLOYEE EMPLOYEE LEVEL.	4/E401
—	PLUG & PLAY BOX WITH (2) STANDARD POWER CONNECTORS CONNECTED TO SEPARATE 208V SINGLE PHASE CIRCUIT	4/E401
—	IN-RACK LIGHTING PLUG & PLAY BOX WITH (2) POWER CONNECTORS, SWITCHED BY EMS ON CUSTOMER LEVEL.	4/E401
—	FLOOR BOX, FLUSH, 18 GA SHIELDED LV CABLE TO NICKEL COATED FLOOR, LEAVE RECEPTACLES, DATA OUTLET, A/V CONNECTIONS, PROVIDE ACCESSORIES AS REQUIRED FOR COMPLETE INSTALLATION. A: 4-GANG BOX WITH 4 DUPLEX RECEPTACLES, 4 CAT6 JACKS & 1 GROUND FOR A/V CONNECTORS BY OWNER, BOX ASS-OG-4-COVER 'EB45CTNK'. GANG BOX WITH 4 DUPLEX RECEPTACLES & 8 CAT6 JACKS, BOX 'EB85-OG' & COVER 'EBF610CTNK'. GANG BOX WITH 5 DUPLEX RECEPTACLES & 10 CAT6 JACKS, BOX 'EB85-OG' & COVER 'EBF610CTNK'.	

ALTERNATE BID #1 - CO-OP MINI-SPLITS FOR CONFERENCE ROOMS
ALTERNATE BID #2 - CO-OP MINI-SPLITS FOR OFFICES
PROVIDE 120V TO MINI-SPLIT CONDENSING UNITS ON ROOF, WITH LOCAL DISCONNECT SWITCHES & VENT OUTLET
PROVIDE LV POWER FROM CONDENSING UNITS TO WALL MOUNTED INDOOR UNITS.
PROVIDE OUTLETS NEAR INDOOR UNITS FOR CONDENSATE PUMPS. PROVIDE J-BOXES FOR THE MOSTATS AT 48" AFF. CONDUITS STUBBED ABOVE CEILING.

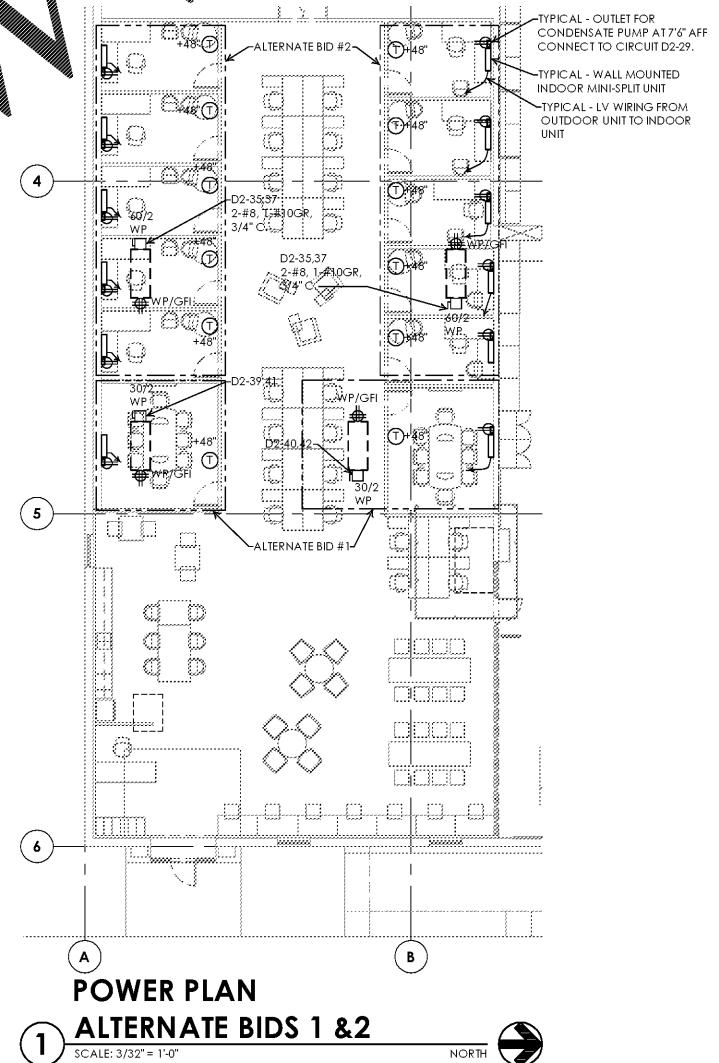

**POWER PLAN
ALTERNATE BIDS 1 & 2**

SCALE: 3/32" = 1'-0" NORTH

GENERAL NOTES

- CONTENT OF DRAWINGS REFLECTS WORK BY MULTIPLE PARTIES. SEE "RESPONSIBILITY SCHEDULE", SHEET (G100) "COVER SHEET" FOR COORDINATION, DIVISION OF LABOR & REQUIRED VENDORS.
- ALL NOTES, GENERAL NOTES, KEYNOTES & LEGEND ENTRIES ARE SHEET SPECIFIC AND DON'T APPLY TO OTHER SHEETS, UNLESS NOTED OTHERWISE.
- NOT ALL SYMBOLS IN LEGEND ARE USED. "-" IN LEGEND INDICATES DEFAULT DEVICE TYPE. LEGEND "NOTES" COLUMN LIST DEFAULT MOUNTING HEIGHT TO CENTER, INSTALLATION TYPE OR LOCATION OF INSTALLATION INFORMATION.
- BRANCH CIRCUITS SHALL BE (2) #12, #12 GR IN 1/2" CONDUIT, UNLESS NOTED OTHERWISE. USE (2) #10, #10 GR IN 1/2" CONDUIT FOR 120V CIRCUITS OVER 125' IN LENGTH OR 277V CIRCUITS OVER 250' IN LENGTH FOR VOLTAGE DROP.
- ADJACENT RECEPTACLES MAY BE COMBINED INTO MULTI-GANG BOXES.

POWER NOTES

- RELOCATE EXISTING FIRE ALARM DEVICES & EQUIPMENT AS REQUIRED DUE TO ALTERATIONS. COORDINATE REQUIREMENTS WITH OWNER & LOCAL AUTHORITIES. PROTECT FROM DAMAGE DURING CONSTRUCTION.
- EXISTING HVAC EQUIPMENT IS TO REMAIN UNLESS NOTED OTHERWISE.
- EXISTING RTU SENSORS & DEVICES ARE TO REMAIN UNLESS NOTED OTHERWISE. VERIFY IN FIELD. PROTECT FROM DAMAGE DURING CONSTRUCTION.
- EXISTING NOVAR EMS CONTROLS & DEVICES ARE TO REMAIN UNLESS NOTED OTHERWISE. PROTECT FROM DAMAGE DURING CONSTRUCTION.
- EXISTING SECURITY, CCTV DEVICES & EQUIPMENT ARE TO REMAIN UNLESS NOTED OTHERWISE. PROTECT FROM DAMAGE DURING CONSTRUCTION.

KEYNOTES

- ◇ AUTOMATIC DOOR: PROVIDE JBOX ABOVE CEILING WITH CIRCUIT FOR AUTOMATIC DOOR POWER. COORDINATE WITH VENDOR.
- ◇ SAW CUT FLOOR FOR COUNTER POWER & DATA. PROVIDE (2) 3/4" CONDUITS, ONE FOR POWER, ONE FOR DATA, PARTITION & SAW CUT IN FLOOR TO COUNTER. PROVIDE BUSHINGS & PULL WIRE FOR DATA CONDUIT. TERMINATE POWER CONDUIT IN FLOOR MOUNTED JBOX, UNO. VERIFY STUB UP LOCATION WITH CASEWORK CONSTRUCTION & OWNER.
- ◇ PROVIDE FLUSH MOUNTED JBOX AT DOOR FOR CARD ACCESS. PROVIDE CONDUIT WITH PULL WIRE TO JOIST SPACE. VERIFY LOCATION WITH OWNER. COORDINATE WITH VENDOR. THE EGRESS / ACCESS CONTROL CARD READER SYSTEM'S DESIGN AND OPERATION SHALL CONFORM TO CFC 1010.1.9.8 AND 1010.1.9.9.
- ◇ PROVIDE NEW FLOOR BOX, FLUSH IN FLOOR WHERE SHOWN. PROVIDE ALL ACCESSORIES FOR COMPLETE INSTALLATION. INSTALL FLOORING IN COVER LEAVE OUT. PROVIDE 3/4" CONDUIT FOR POWER ROUTED FROM BOX TO PANEL. PROVIDE 1-1/4" (2" FOR TYPE 'C') CONDUIT FOR DATA FROM BOX TO WALL INDICATED NEAR PANEL. PROVIDE DIVIDERS TO SEPARATE POWER & DATA.
- ◇ PROVIDE NEW FLOOR BOX, FLUSH IN FLOOR WHERE SHOWN. PROVIDE ALL ACCESSORIES FOR COMPLETE INSTALLATION. INSTALL FLOORING IN COVER LEAVE OUT. PROVIDE (3) 3/4" CONDUITS FOR POWER, DATA & A/V FROM BOX TO TV. PROVIDE DIVIDERS TO SEPARATE POWER, DATA & A/V.
- ◇ SUSPENDED TV'S: PROVIDE RECEPTACLES MOUNTED TO BACK OF TV MOUNTING BRACKET. ROUTE POWER THRU BRACKET SUSPENSION COLUMNS. VERIFY AVAILABLE CIRCUIT NUMBERS.
- ◇ UNDERSLAB CONDUITS: ROUTE THROUGH TRENCH AREAS SHOWN.
- ◇ PROVIDE DPDT TOGGLE SWITCH AT 48" WITH 2 CONDUCTOR / 18 GA SHIELDED LV CABLE TO TEMPERATURE SENSOR IN CONFERENCE ROOM & TEMPERATURE SENSOR IN OPEN AREA. WIRE OUTPUT FROM SWITCH (2C/18GA SHIELDED) TO DESIGNATED RTU. CONNECT SWITCHES SO THAT UP POSITION CONNECTS THE RTU TO THE SENSOR IN THE CONFERENCE ROOM. PROVIDE "OCCUPIED" & "UNOCCUPIED" LABELS. COORDINATE WITH ENTIC.
- ◇ FIRE ALARM STROBE / HORN TO REMAIN. VERIFY LOCATIONS OF FIRE ALARM DEVICES & RELOCATE IF NECESSARY. PROTECT DURING CONSTRUCTION.

**ARCHITECTURAL
DESIGN GUILD**

2100 Sutter Blvd.
St. Louis, MO 63143
www.adg-stl.com
P: 314.644.1234
F: 314.644.4373

C.O.F. # 3 2 7 8 6
EXP. 2 / 2 8 / 2 0 1 9

ALL ARCHITECTURAL AND ENGINEERING DRAWINGS ARE UNLESS OTHERWISE SPECIFIED TO BE MADE WITHOUT PRIOR WRITTEN CONSENT OF THE ARCHITECT. ALL COMMON LAW RIGHTS OF COPYRIGHT AND OTHERWISE ARE HEREBY PRESERVES BY ARCHITECT.

Office DEPOT
OfficeMax

6600 NORTH MILITARY TRAIL
BOCA RATON, FL 33496

PHONE: (561) 438-6299
FAX: (561) 438-7237

Office DEPOT
STORE #0409
BOCA RATON, FL

4901 N. FEDERAL HIGHWAY
BOCA RATON, FL 33431

ISSUE DATE: 11/09/2018
STORE NUMBER: #0409
LEASABLE AREA: 29,701 S.F.
GROSS FLOOR AREA: 28,752 S.F.
JOB NUMBER: 2018.012000

ISSUE	ISSUED FOR BID	DATE
		11/09/18

JOHN M. BRUNS
LICENSE
No. 54430
STATE OF FLORIDA
PROFESSIONAL ENGINEER

JOHN M. BRUNS
#54430 | EXP. 02/28/2019

POWER PLAN

DRAWN: JEC
CHECKED: JMB

E102