

GENERAL NOTES

- A. ALL INTERIOR SIGNAGE AND GRAPHICS SUPPLIED AND INSTALLED BY OFFICE DEPOT.
- B. REFER TO MECHANICAL AND ELECTRICAL DRAWINGS FOR ADDITIONAL INFORMATION.
- C. REFER TO SHEET A401 FOR MATERIAL SCHEDULE.
- D. REFER TO SHEET A401 ROOM FINISH SCHEDULE FOR CEILING HEIGHTS.
- E. EXISTING LIGHT FIXTURES TO REMAIN UNLESS NOTED OTHERWISE. REFER TO ELECTRICAL SHEETS FOR MORE INFORMATION.

REFLECTED CEILING KEY NOTES

- ◇ DASHED LINE INDICATES FLOOR FIXTURE BELOW, TYP.
- ◇ PAINT CEILING, STRUCTURE AND CONDUIT - REFER TO FINISH SCHEDULE DO NOT PAINT FIRE ALARM DEVICE, FIRE SPRINKLER, DIRECT FEED LIGHTS, OR LIGHT FIXTURES.
- ◇ RELOCATED LIGHT FIXTURE.
- ◇ REPLACE DAMAGED CEILING TILES TO MATCH EXISTING.



**ARCHITECTURAL
DESIGN GUILD**

2000 Sutter Blvd.
St. Louis, MO 63143
www.adg-stl.com
P: 314.644.1234
F: 314.644.4373

ALL ARCHITECTURAL AND ENGINEERING DRAWINGS ARE AN ORIGINAL AND DESIGNER'S NAME HERE MADE WITHOUT PRIOR WRITTEN CONSENT OF THE ARCHITECT. ALL COMMON LAW RIGHTS OF COPYRIGHT AND OTHERWISE ARE HEREBY SPECIFICALLY RESERVED.

OWNER:

**Office DEPOT
OfficeMax**

6600 NORTH MILITARY TRAIL
BOCA RATON, FL 33496

PHONE: (561) 438-6299
FAX: (561) 438-7237

PROJECT:

Office DEPOT
STORE #0409
BOCA RATON, FL

4901 N. FEDERAL HIGHWAY
BOCA RATON, FL 33431

ISSUE DATE: 11/09/2018
STORE NUMBER: #0409
LEASABLE AREA: 29,701 S.F.
GROSS FLOOR AREA: 28,752 S.F.
JOB NUMBER: 2018.012000

ISSUE	ISSUED FOR RCD	11/09/18

SEAL



BARRY J. GREENBERG
#AR0009300 | EXP. 02/28/2019

SHEET

**REFLECTED CEILING
PLAN**

DRAWN: SAR
CHECKED: MBK

A103

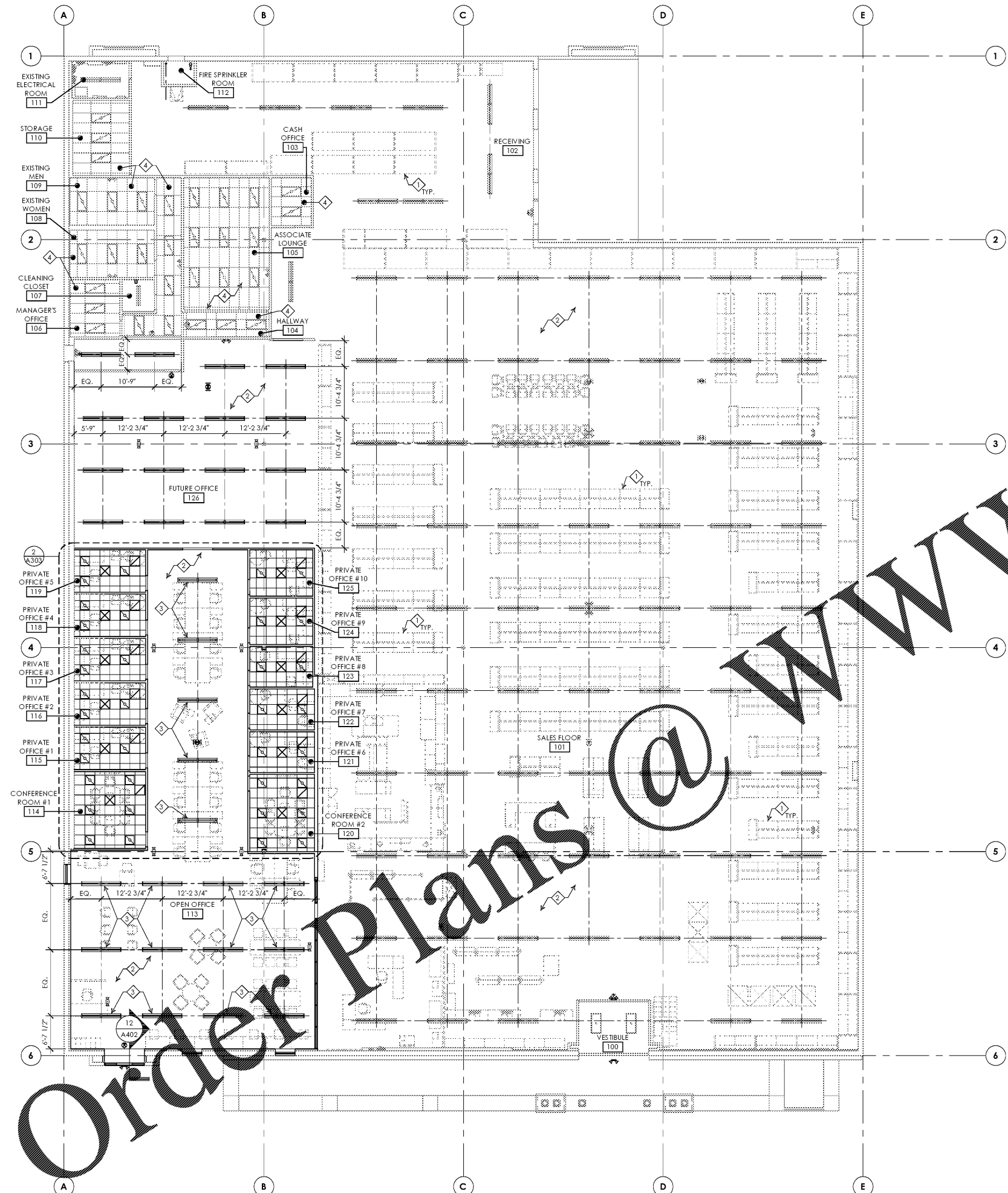

Order Plans @

1 REFLECTED CEILING PLAN
SCALE: 3/32" = 1'-0"



FILE: 17-00120-001-001-ARCHITECTURAL-REFLECTED CEILING PLAN (REVISED).DWG
 DATE: 11/09/18
 TIME: 04:11 PM
 USER: BARRY.J.GREENBERG