

GENERAL TRAFFIC CONTROL NOTES:

1. ALL TRAFFIC CONTROL DEVICES SHALL BE MADE AND ERECTED IN ACCORDANCE WITH THE DETAILS SHOWN ON THE PLANS; THE MUTCD, 2009 EDITION; THE GEORGIA STANDARD SPECIFICATIONS, LATEST EDITION; AND/OR SPECIAL PROVISIONS (SEE SECTION 150).
2. ALL TRAFFIC CONTROL DEVICES SHALL BE AS SHOWN, OR AS DIRECTED BY THE ENGINEER. ADDITIONAL DEVICES MAY BE REQUIRED AS DIRECTED BY THE ENGINEER.
3. ALL PORTABLE MESSAGE SIGNS SHALL BE MOUNTED A MINIMUM OF 4' ABOVE THE LEVEL OF PAVEMENT EDGE FOR DIRECTIONAL TRAFFIC OF TWO (2) LANES OR LESS AND A MINIMUM OF 7 FEET FOR DIRECTIONAL OF THREE (3) OR MORE LANES. ALL PORTABLE SIGNS AND SIGN MOUNTING DEVICES USED IN THE WORK SHALL BE NCHRP 350 COMPLIANT. PORTABLE SIGNS MAY BE USED WHEN THE DURATION OF THE WORK IS LESS THAN 3 DAYS.
4. WHEN THE CONSTRUCTION AREA HAS ENTRANCE/EXIT RAMP OR INTERSECTIONS, WORK WILL BE PERFORMED IN SUCH A MANNER TO PERMIT TRAFFIC TO OPERATE WITH THE LEAST AMOUNT OF INCONVENIENCE AS POSSIBLE. ADDITIONAL CHANNELIZATION AND SIGNING SHALL BE INSTALLED, AS REQUIRED, TO ALLOW TRAFFIC TO REMAIN AS OPERATIONAL AS POSSIBLE. WHEN ENTRANCE RAMP/INTERSECTIONS ARE INOPERABLE, FLAGGERS WILL BE UTILIZED TO CONTROL AND PROHIBIT MOVEMENT INTO THE PROJECT AT THAT POINT UNTIL CONSTRUCTION HAS CLEARED THE RESTRICTION SUFFICIENT TO RETURN TO OPERATIONAL STATUS.
5. ANY CHANNELIZING DEVICES USED SHALL BE FROM THE GDOT QUALIFIED PRODUCTS LIST.
6. FOR NIGHT TIME OPERATIONS, DRUMS SHALL HAVE, FOR THE LENGTH OF THE TAPER ONLY, A SIX (6) INCH ORANGE REFLECTIZED TOP STRIPE ON EACH END. IN THE TAPER AS REQUIRED IN SECTION 150, SPACING OF DEVICES SHALL BE AS SHOWN. DURING DAYLIGHT HOURS, CONES (24" MIN.) MAY BE USED IN ADVANCE OF AND THROUGHOUT WORK AREA.
7. SIGN LOCATIONS ARE APPROXIMATE AND MAY BE ADJUSTED TO MEET FIELD CONDITIONS BUT MUST BE WITHIN THE LIMITATION SET FORTH IN THE MUTCD.
8. A PORTABLE SELF-SUSTAINED SEQUENTIAL OR FLASHING ARROW SIGN SHALL BE USED AT THE BEGINNING OF EACH TAPER CLOSURE ON MULTI-LANE HIGHWAYS. THE PANELS SHALL MEET THE MUTCD REQUIREMENTS FOR A TYPE C BOARD, INCLUDING BEING A MINIMUM SIZE OF 48" HIGH BY 58" WIDE WITH AT LEAST 15 LAMPS USED FOR THE ARROW AND HAVE A MINIMUM VISIBILITY OF 1 MILE.
9. PROJECT SIGNS W20-1 FOR THIS PROJECT SHALL BE COORDINATED WITH ADJACENT CONSTRUCTION PROJECTS. ONLY ONE SET OF SIGNS IS REQUIRED IN EACH DIRECTION FOR THE TOTAL LENGTH OF ALL PROJECTS AT THE BEGINNING OF THE FIRST PROJECT AND AT THE END OF THE LAST PROJECT. ADVANCE CONSTRUCTION SIGNS ARE NOT REQUIRED ON INTERMEDIATE PROJECTS, UNLESS CONSTRUCTION ON THE ADJACENT PROJECTS IS COMPLETED BY THE HAND, THEN PROJECT CONSTRUCTION SIGNS WILL BE ADDED AS NECESSARY.
10. ALL CROSSROADS, SIDEROADS, RAMPS OR OTHER ENTRANCES TO MAINLINE CONSTRUCTION SHALL REQUIRE W20-1 SIGNS LOCATED AS SHOWN IN THE PLANS, OR AS DIRECTED BY THE ENGINEER.
11. MARKINGS AND/OR SIGNS IN CONFLICT WITH INTERIM TRAFFIC CONTROL SHALL BE REMOVED, REPAIRED OR COVERED; APPLICABLE EXISTING AND INTERIM MARKINGS AND/OR SIGNING SHALL BE MAINTAINED PER GDOT SPECIFICATION SECTION 150.
12. TEMPORARY BARRIERS SHALL MEET THE REQUIREMENTS PER GDOT SPECIFICATION SECTION 622.
13. ANY CHANNELIZING DEVICES (DRUMS OR BARRICADES) IN CONFLICT WITH TEMPORARY BARRIERS SHALL BE OMITTED.
14. CONTRACTOR SHALL PROVIDE THE NECESSARY TRAFFIC CONTROL DURING THE TIE-IN OPERATION.
15. THE TRAFFIC CONTROL DEVICES SHOWN FOR ANY STAGE OF CONSTRUCTION SHALL REMAIN IN PLACE AND BE UTILIZED SO LONG AS NECESSARY FOR THE FOLLOWING STAGES AND SHALL BE REMOVED IMMEDIATELY WHEN NO LONGER REQUIRED. THE DEVICES MAY OR MAY NOT BE SHOWN ON THE PLANS FOR THESE FOLLOWING STAGES; REFER TO THE PLAN SHEET FOR THE FINAL STAGE FOR THESE TRAFFIC CONTROLS.
EXISTING GUIDE SIGNS SHALL REMAIN IN PLACE SO LONG AS THEY DO NOT CONFLICT WITH THE CONSTRUCTION OF THIS PROJECT. WHEN IN CONFLICT, THEY SHALL BE RELOCATED ON TEMPORARY POSTS AT THE LOCATION AS DIRECTED BY THE ENGINEER. ANY DISTANCE SHOWN ON THE SIGN SHALL BE ADJUSTED ACCORDINGLY. IF THE SIGNS CANNOT BE RELOCATED, THEN THE SIGNS SHALL BE REMOVED AND STORED AT A PLACE DESIGNATED BY THE ENGINEER. IF NEITHER OF THE ABOVE CAN BE DONE, THEN THE CONTRACTOR SHALL PROVIDE INTERIM GUIDE SIGNS AS COVERED IN GDOT SPECIFICATION SECTION 150.
17. THE CONTRACTOR SHALL INSPECT THE WORK ZONE TRAFFIC CONTROL DAILY FOR DEFICIENCIES, INCLUDING THE PEDESTRIAN ROUTES. THE INDIVIDUAL PERFORMING THE INSPECTION SHALL HAVE APPROPRIATE TRAINING IN ACCORDANCE WITH PART VI OF THE 2009 MUTCD. ANY DEFICIENCY SHALL BE CORRECTED WITHIN A TWENTY-FOUR (24) HOUR PERIOD.

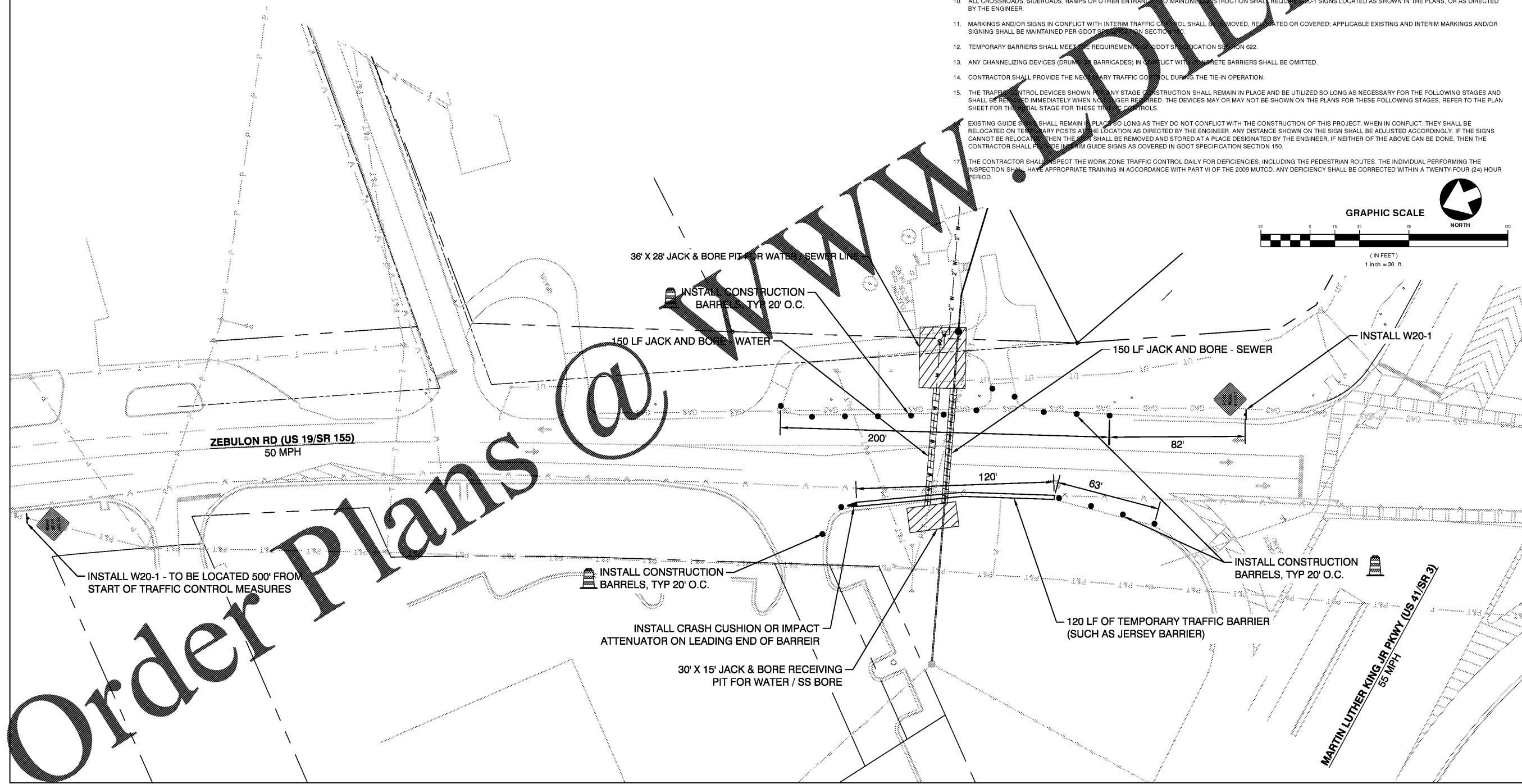
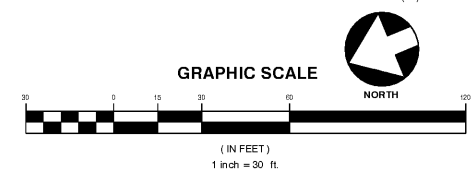

Order Plans @

NO	REVISIONS	DATE
9	REVISED PER SPALDING CO COMMENTS	10/24/2018
8	REVISED PER SPALDING CO COMMENTS	09/16/2018
7	REVISED PER SPALDING CO COMMENTS	07/06/2018
6	REVISED SET DRAINAGE IN RAMP PER GDOT COMMENTS	07/06/2018
5	REVISED SET PER SPALDING COUNTY PLAN REVIEW	12/07/17
4	REVISED SET PER SPALDING COUNTY PLAN REVIEW	12/07/17
3	REVISED SET PER RT INTERNAL REVIEW / SPALDING COUNTY PLAN REVIEW	10/20/17
2	REVISED SET PER RT INTERNAL REVIEW / SPALDING COUNTY PLAN REVIEW	10/20/17
1	REVISED SET PER RT INTERNAL REVIEW / SPALDING COUNTY PLAN REVIEW	09/15/2017

A&R Engineering, Inc.
 2160 Kingston Court, Suite O
 Marietta, GA 30067
 (770) 940-9255
 www.aandrline.com

THESE PLANS ARE SUBJECT TO FEDERAL COPYRIGHT LAWS. ANY USE OF SAME WITHOUT THE EXPRESSED WRITTEN PERMISSION OF RACETRAC PETROLEUM, INC. IS PROHIBITED.

RaceTrac
 RACETRAC PETROLEUM, INC.
 200 GALLERIA PKWY, S.E.
 SUITE 900 ATLANTA, GA 30339
 (770) 431-7600

Water/Sewer Bore Traffic Control	
RACETRAC MARKET	
RaceTrac Griffin 1636 US Hwy 41 Spalding County	
DATE	7-24-17
DRAWN-BY	JDE
CHECK-BY	AKA
DRAWING NAME 16-136	
C-1.6	REV 9
SHEET NO.	REVISION