

ISSUE/REVISION RECORD

DATE	DESCRIPTION
2018.08.22	PERMIT ISSUE

PLAN MODIFICATION NOTICE

SPB NO.	DATE

PROFESSIONAL SEAL



GENERAL NOTES

- ALL DIMENSIONS ARE TO FACE OF FINISH UNLESS NOTED OTHERWISE.
- REFER TO SHEET A500 FOR INTERIOR FINISH LEGEND.
- REFER TO ELECTRICAL SHEETS FOR LIGHTING FIXTURE SCHEDULE.
- REFER TO MECHANICAL SHEETS FOR DIFFUSER SCHEDULE.
- REFER TO WALL SECTIONS FOR SOFFIT CONSTRUCTION. ALL SOFFITS SHALL BE CONSTRUCTED OF ARMSTRONG DRYWALL CEILING GRIDS UNLESS OTHERWISE INDICATED.

SHEET KEYNOTES

- ACM PANEL REVEAL LINE
- METAL AWNING
- 12X12 ACCESS PANEL WITH POWDER COAT TO MATCH SOFFIT
- OVERFLOW SCUPPER
- RAISED CEILING AREA FOR WATER HEAD
- LIGHT MOUNTED TO OVERHEAD DOOR HEAD
- REFER TO ISOMETRIC DETAIL 4/A152
- REFER TO ISOMETRIC DETAIL 5/A152
- ALUMINUM WATER EDGE OF AWNING TO MATCH FACE OF BRICK

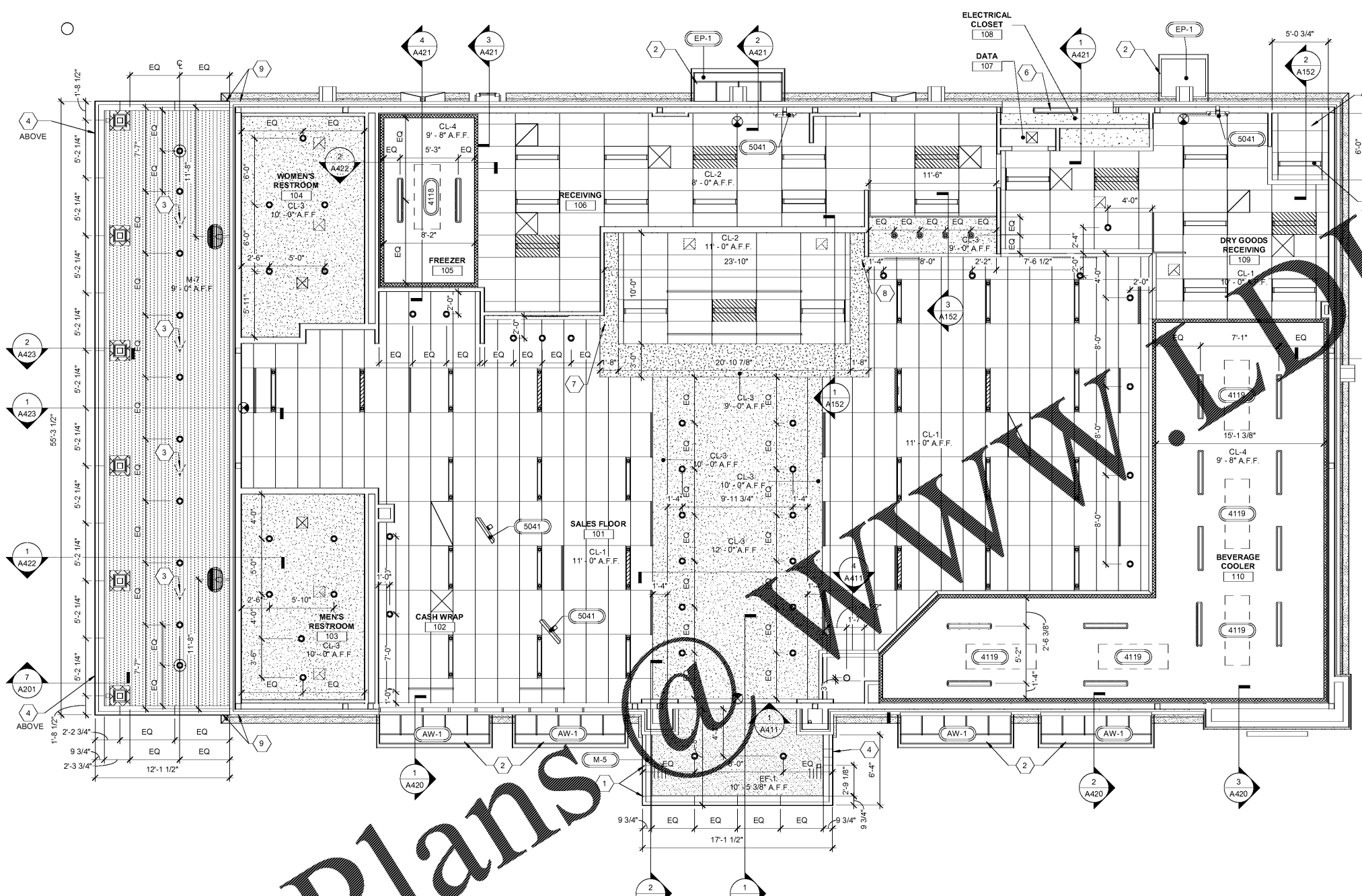

1 REFLECTED CEILING PLAN - MAIN
 3/16" = 1'-0"

Order Plans

WWW.ArchLine.com