

1 PUMP ISLAND DETAIL N.T.S.
SD2

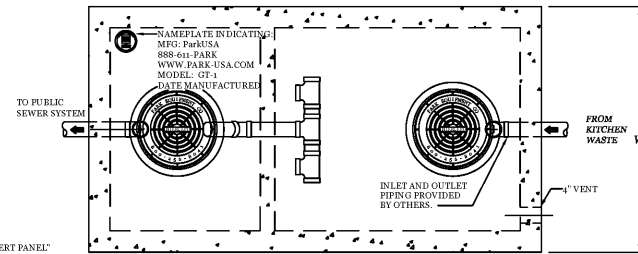

PLAN VIEW

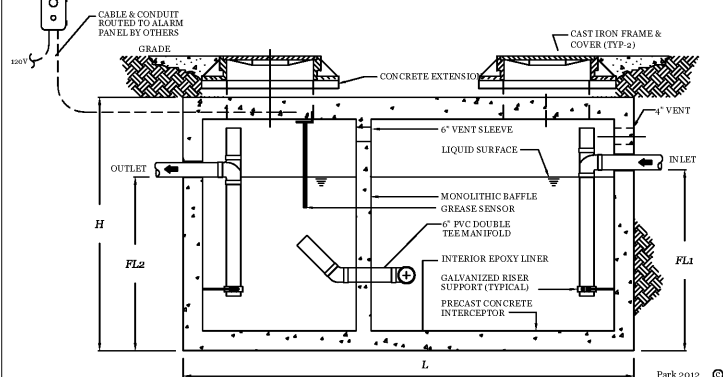

ELEVATION

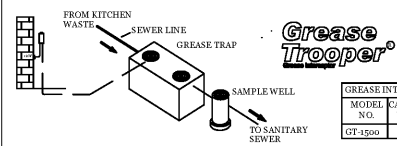

Grease Trooper

MODEL NO.	CAPACITY (GALLONS)	LENGTH (FT)	WIDTH (FT)	HEIGHT (FT)	INLET (IN)	OUTLET (IN)
GT 1500	1,500	3.50	16.00	9'-2"	7'-8"	5'-0"

OTHER SIZES ARE AVAILABLE. CONTACT US FOR MORE INFORMATION.

Engineering Data

The grease interceptors are hydraulically engineered to conform to applicable plumbing codes and requirements of local, state and federal authorities. Shop drawings and complete technical & hydraulic information are available upon request. Consult with Park Engineering for exact excavation conditions & shipping information.



GREASE INTERCEPTOR SERIES GT
1,500 GALLON CAPACITY

SCALE	NONE	DWG. NO.	GT-1	REV.	A
DATE	2012				

GREASE TRAP
1,500 GALLON CAPACITY
& SAMPLE WELL DETAILS
"OR APPROVED EQUAL"

4 N.T.S.
SD2 1. ENGINEER OF RECORD APPROVAL REQUIRED FOR "APPROVED EQUAL"

STORE SIDE

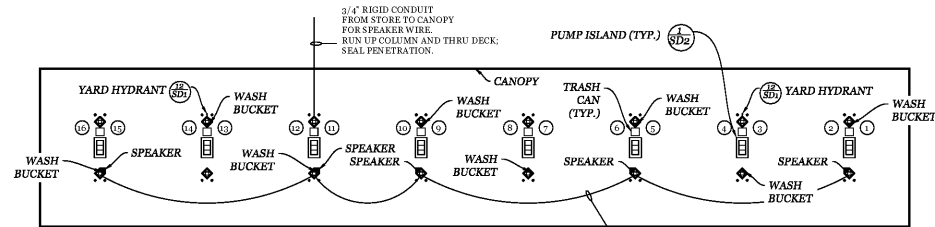

STREET SIDE

CANOPY ACCESSORY LAYOUT DETAIL

2 N.T.S.
SD2 1. SINGLE ROW OF EIGHT (8) MPD'S.
2. REFER TO CANOPY PLANS FOR CANOPY DIMENSIONS AND COLUMN LOCATIONS.

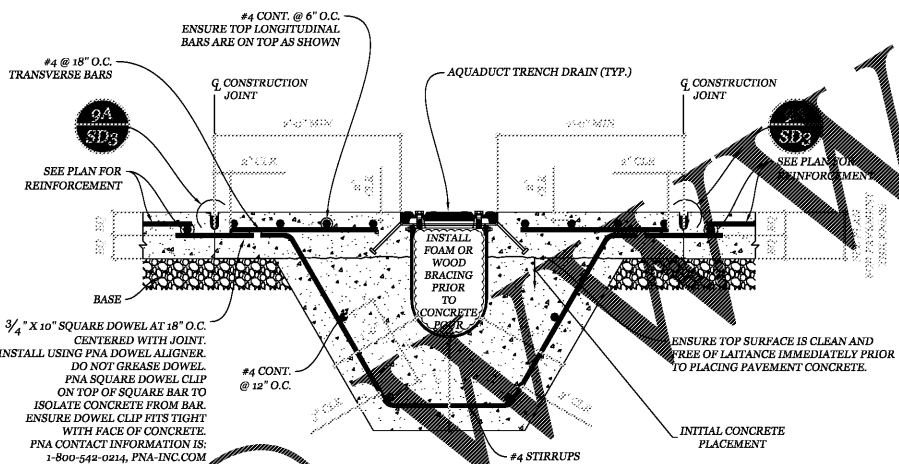

5 TYP. CONCRETE DETAIL @ CANOPY AQUADUCT TRENCH DRAIN N.T.S.

SD2 1. G.C. MUST READ INSTALLATION INSTRUCTIONS PRIOR TO INSTALLATION OF AQUADUCT TRENCH DRAIN.
2. REFER TO DETAIL FOR BRACING RECOMMENDATIONS.
3. EACH TRENCH DRAIN IS INDIVIDUALLY INSURED AND SIZED BY AQUADUCT, INC. (REFER TO DESIGN SPECS FOR EXACT SIZING).
4. SOME PROJECTS MAY HAVE MULTIPLE TRENCH DRAINS ON SITE. (REFER TO "GRADING PLAN" FOR EXACT LOCATIONS).

NOTES

- LIGHT POLES SHALL MEET 93 MPH WIND (Vasd); 120 MPH (Vult). ALL REINFORCING STEEL SHALL BE NEW DOMESTIC DEFORMED BILLET STEEL CONFORMING TO ASTM A-615 GRADE 60.
- CONCRETE SHALL HAVE A 28 DAY COMPRESSIVE STRENGTH (FC) OF 3,500 PSI FOR ALL LIGHT POLE FOOTINGS.
- CONCRETE ABOVE FINISH GRADE TO BE SMOOTH WITH RUBBED FINISH.
- CONCRETE LIGHT POLE BASES TO BE PAINTED TO MATCH BOLLARD.

WIND DESIGN CRITERIA BASED ON THE FOLLOWING:

- ASCE 7-10
- Vult=120 MPH WITH EXPOSURE C RISK CATEGORY II
- Vasd=93 MPH
- IMPORTANCE FACTOR I = 1.0
- DESIGN WIND PRESSURE = 36.5 PSF

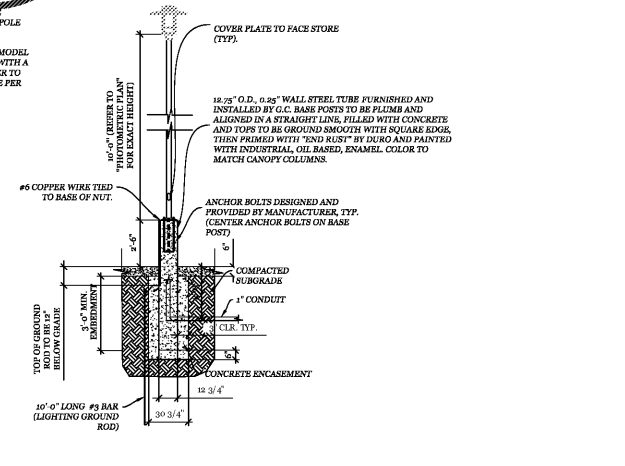

7 TYP. DECORATIVE LIGHTING SECTION 120 MPH WIND (Vult) N.T.S.

SD2 1. LIGHT POLES SHALL MEET 93 MPH WIND (Vasd); 120 MPH (Vult). ALL REINFORCING STEEL SHALL BE NEW DOMESTIC DEFORMED BILLET STEEL CONFORMING TO ASTM A-615 GRADE 60.

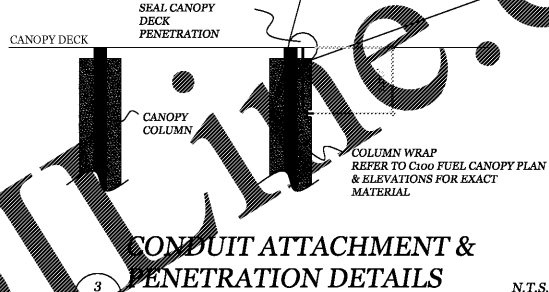

3 CANOPY AQUADUCT TRENCH DRAIN BRACING LAYOUT DETAILS N.T.S.

SD2 1. OVER 36" ADD AN ADDITIONAL LEVEL OF BRACING FOR EACH ADDITIONAL 12" OF DEPTH.

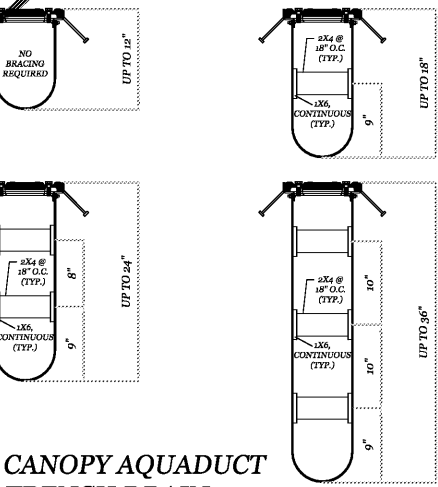

6 CANOPY AQUADUCT TRENCH DRAIN BRACING LAYOUT DETAILS N.T.S.

SD2 1. OVER 36" ADD AN ADDITIONAL LEVEL OF BRACING FOR EACH ADDITIONAL 12" OF DEPTH.

NOTES

- LIGHT POLES TO BE SPALDING, PROVIDED BY RACETRAC AND TO BE INSTALLED BY GENERAL CONTRACTOR. SEE SITE PLAN FOR POLE LOCATIONS.
- LIGHT FIXTURES TO BE "EDGE" HIGH OUTPUT AREA LUMINAIRE WITH A MAXIMUM EFFECTIVE PROJECTED AREA OF 4.0 S.F. (REFER TO "DIMENSIONAL PLAN" FOR DETAILS). ONE LIGHT FIXTURE PER POLE.
- WIND DESIGN CRITERIA BASED ON THE FOLLOWING:
 - ASCE 7-10
 - Vult=120 MPH WITH EXPOSURE C RISK CATEGORY II
 - Vasd=93 MPH
 - IMPORTANCE FACTOR I = 1.0
 - DESIGN WIND PRESSURE = 36.5 PSF

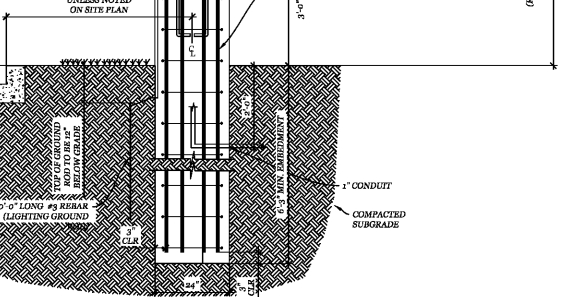

8 TYP. SITE LIGHTING SECTION 120 MPH WIND (Vult) N.T.S.

SD2 1. LIGHT POLES SHALL MEET 93 MPH WIND (Vasd); 120 MPH (Vult). ALL REINFORCING STEEL SHALL BE NEW DOMESTIC DEFORMED BILLET STEEL CONFORMING TO ASTM A-615 GRADE 60.

NO.	REVISIONS	DATE
9	REVISED PER SPALDING CO COMMENTS	10/24/2018
8	REVISED PER SPALDING CO. (CITY OF GRIFFIN / RT INTER)	09/16/2018
7	REVISED PER DECK DROP OF 4"	07/06/2018
6	REVISED SET DRAINAGE IN RM PER GOOD COMMENTS	07/06/2018
5	REVISED SET PER SPALDING COUNTY PLAN REVIEW	12/12/2017
4	REVISED SET PER RT INTERNAL REVIEW / SPALDING COUNTY PLAN REVIEW	12/12/2017
3	REVISED SET PER RT INTERNAL REVIEW / SPALDING COUNTY PLAN REVIEW	12/12/2017
2	REVISED SET PER RT INTERNAL REVIEW / SPALDING COUNTY PLAN REVIEW	12/12/2017
1	REVISED SET PER RT INTERNAL REVIEW / SPALDING COUNTY PLAN REVIEW	09/15/2017



A&R Engineering, Inc.
2100 Kingston Court, Suite O
Marietta, GA 30067
(770) 980-8255
www.aandring.com

THESE PLANS ARE SUBJECT TO FEDERAL COPYRIGHT LAWS. ANY USE OF SAME WITHOUT THE EXPRESSED WRITTEN PERMISSION OF RACETRAC PETROLEUM, INC. IS PROHIBITED.

Racetrac
RACETRAC PETROLEUM, INC.
200 GALLERIA PKWY, S.E.
SUITE 900 ATLANTA, GA 30339
(770) 431-7600

RT Standard Details
RACETRAC MARKET
RaceTrac Griffin
1638 US Hwy 41
Spalding County

DATE	7-24-17
DRAWN-BY	JDE
CHECK-BY	AKA
DRAWING NAME	16-136

SD2	REV 9
SHEET NO.	REVISION