

NOTE

- Hole to be twice the size of the rootball.
- Do not heavily prune the tree at planting. Prune only crossover limbs and broken or dead branches; Do not remove the terminal buds of branches that extend to the edge of the crown.
- Each tree must be planted such that the trunk flare is visible at the top of the root ball. Trees where the trunk flare is not visible shall be rejected. Do not cover the top of the rootball with soil or mulch.

1 TREE PLANTING & STAKING
SCALE: NTS

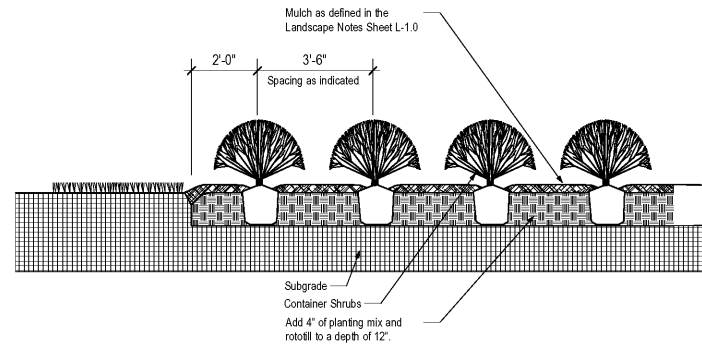

2 SHRUB BED PLANTING DETAIL
SCALE: NTS

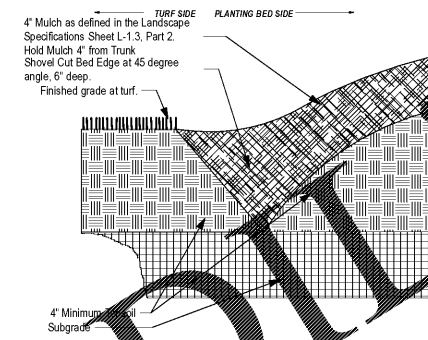

3 V TRENCH BED EDGING
SCALE: NTS

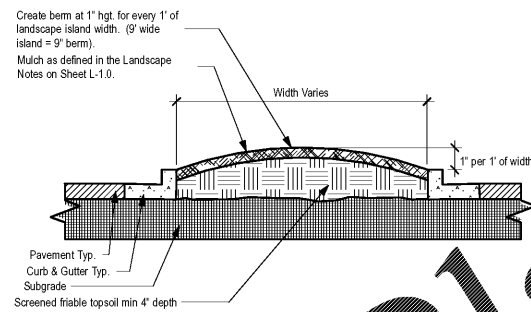

4 PARKING ISLAND DETAIL
SCALE: NTS

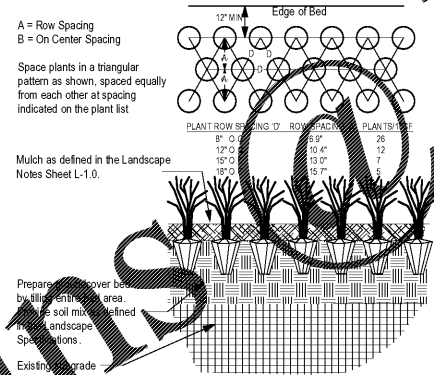

5 GROUNDCOVER PLANTING DETAIL
SCALE: NTS

- Contractor responsible for locating and protecting all underground utilities prior to digging.
- Contractor responsible for protecting existing trees from damage during construction as shown on plans.
- General Contractor to install 6" minimum depth of clean, friable topsoil at all planting beds and 2" minimum depth at lawn areas prior to fine grading. See Topsoil specification Sheet L-1.3.
- All shrub beds (existing and new) to be mulched with a 4 inch minimum layer of hardwood mulch (brown) as defined in the landscape specifications on Sheet L-1.3.
- All annual and perennial beds to be tilled to a minimum depth of 18 inches and amended with 4 inches of organic material. Mulch planted annual and perennial beds with 2 inch depth of mini nuggets. RaceTrac will reject all others.
- Existing grass in proposed planting areas to be killed and removed and area to be hand raked to remove all rocks and debris larger than 1 inch in diameter prior to planting shrubs or laying sod. Landscape Contractor to provide fine grading. See grading specification Sheet L-1.3.
- Any existing grass disturbed during construction to be fully removed, regraded and replaced. All tire marks and indentions to be repaired. No exceptions.
- Landscape Contractor to coordinate with Landscape Architect (L.A.) to have L.A. select (tag) and photograph all plant material prior to shipment of material to site. Photographs to be submitted to L.A. and RaceTrac Project Manager for approval or rejection. Photographs shall show scale and container size of plant material. All trees to be photographed individually or hand-selected by L.A. Shrubs and other plants to be photographed in grouping with one photograph of single plant submitted also, see submittal specification on Sheet L-1.3.
- Soil to be tested to determine fertilizer and lime requirements and distributed prior to laying sod as directed by L.A. Provide results to L.A. and RaceTrac Project Manager.
- Sod to be delivered fresh (Cut less than 24 hours prior to arriving on site), laid immediately, rolled, and watered thoroughly immediately after planting. Edge of sod adjacent to mulch beds to be shovel cut as detailed on Sheet L-1.2. All sod to be delivered in largest rolls available. There shall be no gaps between sod joints.
- All changes to design or plant substitutions are to be authorized in writing by the Landscape Architect and RaceTrac Construction Project Manager.
- Planting Mix to be provided as specified in the landscape specifications Sheet L-1.3.
- All landscaping shall be installed in conformance with ANSI Z60.1 the "American Standard for Nursery Stock" and the accepted standards of the American Association of Nurserymen.
- The Landscape Contractor shall guarantee all plants installed for one full year from date of acceptance by the RaceTrac. All plants shall be alive and at a vigorous rate of growth at the end of the guarantee period. The Landscape Contractor shall not be responsible for acts of God or vandalism.
- Any plant that is determined dead, in an unhealthy or unsightly condition, lost its shape due to dead branches or other symptoms of poor, non-vigorous growth, as determined by the Landscape Architect, shall be replaced by the Landscape Contractor at no cost to RaceTrac.
- General Contractor to mound all parking islands 6" - 10" with clean screened topsoil.
- Prior to installation, the Landscape Contractor shall inspect the subgrade, general site conditions, verify elevations, utility locations, irrigation, approve topsoil provided by General Contractor and observe the site conditions under which the work is to be done. Notify General Contractor of any unsatisfactory conditions, and work shall not proceed until such conditions have been corrected and are acceptable to the Landscape Architect, Landscape Contractor and RaceTrac Construction Manager.
- Stake all evergreen and deciduous trees.
- Remove all stakes and guying from all trees after one year from planting.
- Water all plant material that are newly planted thoroughly twice in first 24 hours and apply mulch immediately.
- Site to be 100% irrigated in all planting beds and grass area by an automatic underground irrigation system. See Irrigation Plan Sheets L-2.1, L-2.2, L-2.3.
- All tree protection devices to be installed by General Contractor prior to the start of land disturbance, and maintained until final landscaping.
- All tree protection areas to be protected from sedimentation.
- All tree protection fencing to be inspected daily, and repaired or replaced as needed or as instructed by L.A.
- No parking, walking, storage or other construction activities shall occur within tree protection areas.
- Landscape Contractor shall provide a 1 year maintenance period under separate contract following acceptance by the Landscape Architect and RaceTrac Construction Manager. Maintenance contract to be assigned through RaceTrac Maintenance Department.



RaceTrac Market #1242

Hwy 19 & Hwy 41
Griffin, GA
Spalding Co.

date:	8.2.17
scale:	NTS
drawn by:	LSG
checked by:	SLM
job number:	2017069



issued

1	
2	
3	
4	
5	8.22.18 Client Comments
6	10.2.18 Client Comments
7	
8	
9	
10	
11	
12	
13	
14	
15	
16	
17	

sheet title

**Landscape
Details**

sheet number

L-1.2

Order Plans

WWW.LANDLINE.COM