

LET

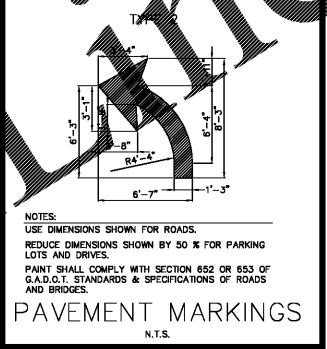

NO	REVISIONS	DATE
9	REVISED PER SPALDING CO COMMENTS	10/24/2018
8	REVISED PER SPALDING CO COMMENTS	09/16/2018
7	REVISED PER SPALDING CO COMMENTS	07/06/2018
6	REVISED PER SPALDING CO COMMENTS	07/06/2018
5	REVISED PER SPALDING CO COMMENTS	07/06/2018
4	REVISED PER SPALDING CO COMMENTS	07/06/2018
3	REVISED PER SPALDING CO COMMENTS	07/06/2018
2	REVISED PER SPALDING CO COMMENTS	07/06/2018
1	REVISED PER SPALDING CO COMMENTS	09/15/2017

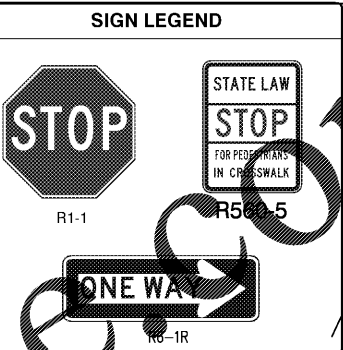
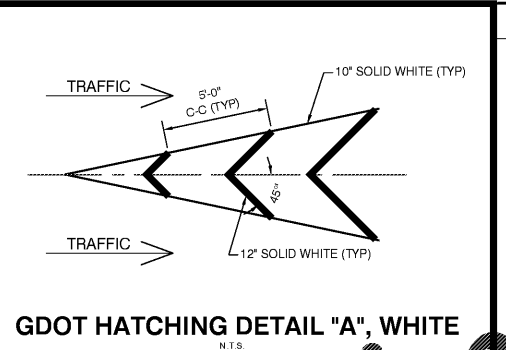
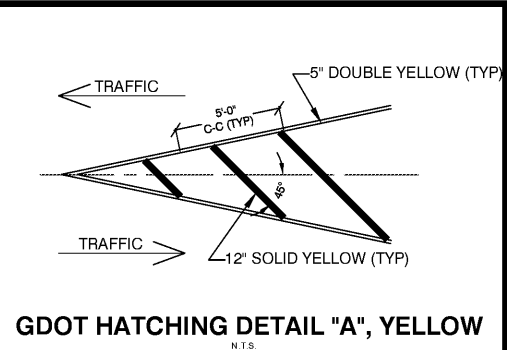
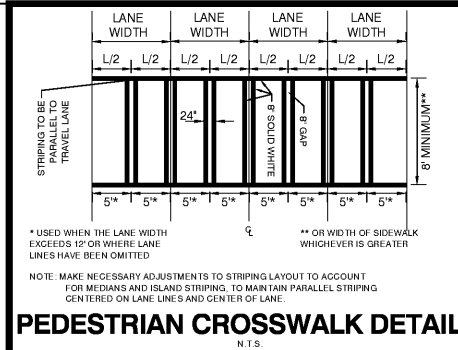
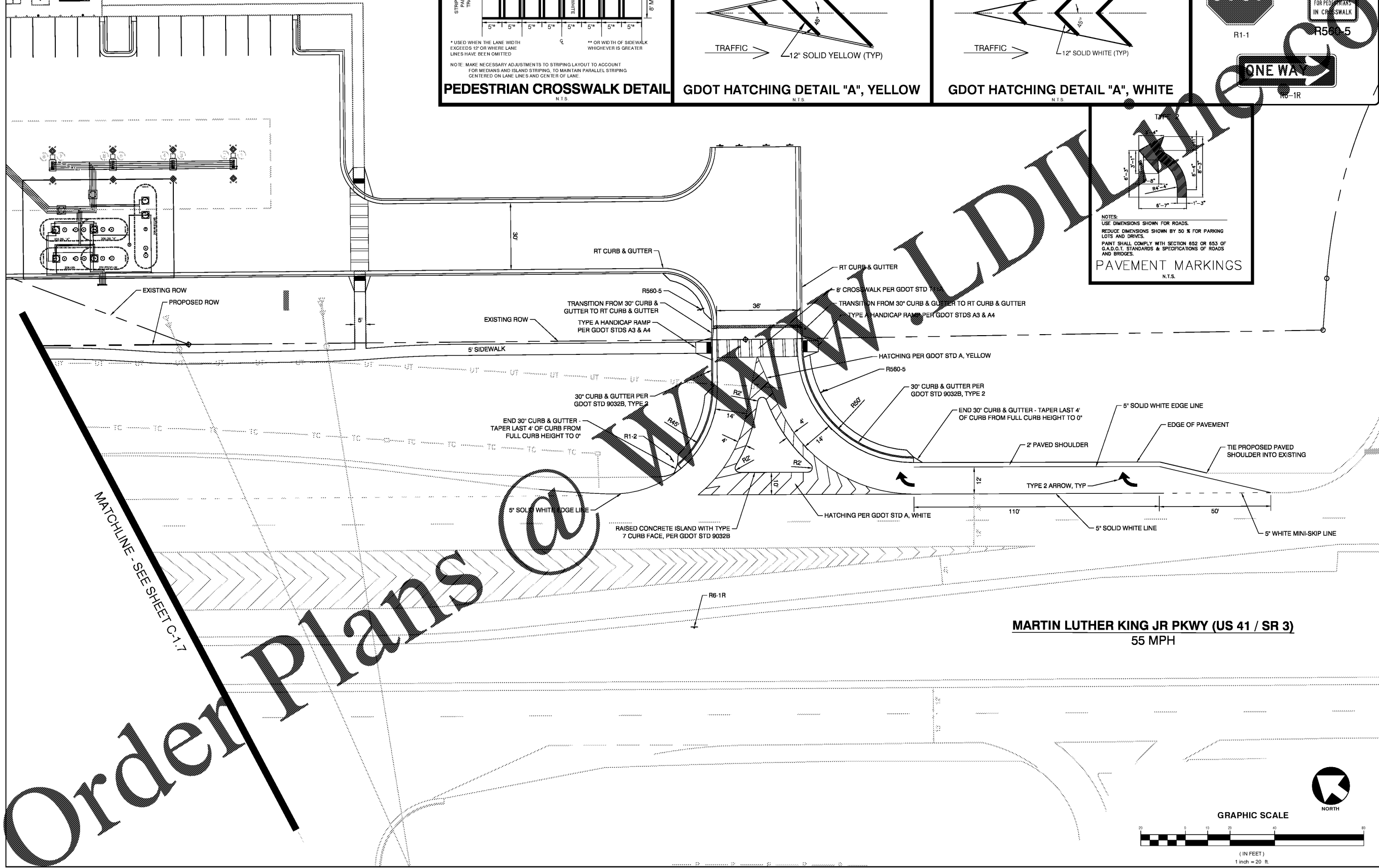

A&R Engineering, Inc.
2160 Kingston Court, Suite O
Marietta, GA 30067
(770) 990-9255
www.aarinc.com

THESE PLANS ARE SUBJECT TO FEDERAL COPYRIGHT LAWS. ANY USE OF SAME WITHOUT THE EXPRESSED WRITTEN PERMISSION OF RACETRAC PETROLEUM, INC. IS PROHIBITED.

Racetrac
RACETRAC PETROLEUM, INC.
200 GALLERIA PKWY, S.E.
SUITE 900 ATLANTA, GA 30339
(770) 431-7600

Drwy Design-MLK
RACETRAC MARKET
RaceTrac Griffin
1638 US Hwy 41
Spalding County

DATE	7-24-17
DRAWN-BY	JDE
CHECK-BY	AKA
DRAWING NAME	16-136
C-1.8	REV 9
SHEET NO.	REVISION

Order Plans @

MATCHLINE - SEE SHEET C-1.7

MARTIN LUTHER KING JR PKWY (US 41 / SR 3)
55 MPH

