

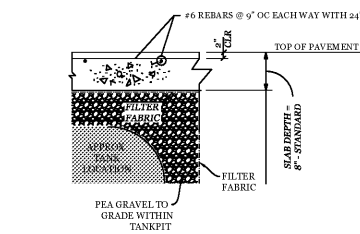

Know what's below. Call before you dig.

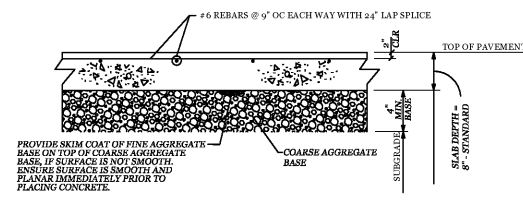

TYPICAL TANK PAD PAVEMENT SECTION



TYPICAL DUMPSTER PAVEMENT SECTION

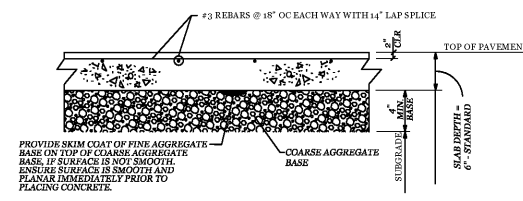

TYPICAL PAVEMENT SECTION

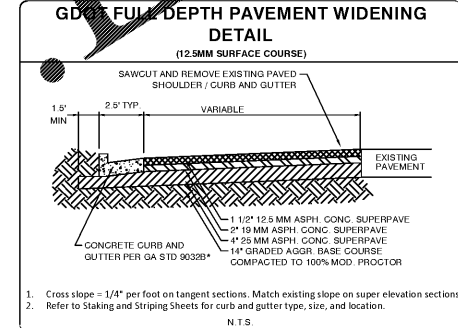
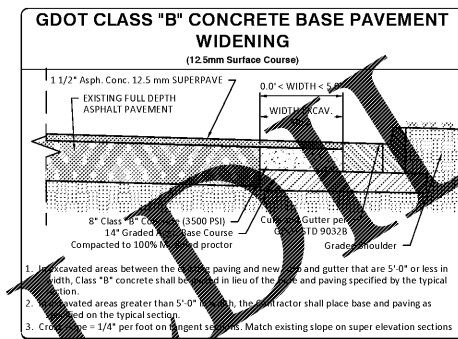

LEGEND

- GDOT FULL DEPTH PAVING - 21.5"
- 8" THICK CONCRETE PAVING
- 8" THICK CONCRETE CURB PAVING
- 6" THICK CONCRETE PAVING
- MILL & INLAY 1 1/2" PAVEMENT (MATCH GRADE ASPECT)
- 4" THICK CONCRETE SIDEWALK
- SHED CURB
- CATCH CURB
- PROPOSED ELEMENTS
- EXISTING ELEMENTS
- WATER LINE
- OVERHEAD ELECTRICAL LINE
- UNDERGROUND ELECTRICAL LINE
- TELEPHONE LINE
- GAS LINE
- SANITARY SEWER LINE
- DETAIL REFERENCE
- ELECTRICAL TRANSFORMER PAD
- POWER POLE

PAVING PLAN NOTES:

- STANDARD DUTY PAVEMENT AREAS SHALL BE PORTLAND CEMENT CONCRETE. DETAILS OF THIS STANDARD DUTY CONCRETE PAVEMENT ARE PROVIDED ON DETAIL SHEETS.
 - NOTIFY OWNER 3 DAYS PRIOR TO POUR OF INITIAL SECTION OF DRIVEWAY PAVING. RACETRAC REPRESENTATIVE TO APPROVE INITIAL POUR.
 - TESTING OF MATERIALS REQUIRED FOR THE CONSTRUCTION OF THE PAVING IMPROVEMENTS SHALL BE PERFORMED BY AN AGENCY, APPROVED BY THE OWNER, FOR THE TESTING MATERIALS. IT SHALL BE THE CONTRACTOR'S RESPONSIBILITY TO ENSURE, BY THE STANDARD TESTING PROCEDURES, THAT THE WORK CONSTRUCTED MEETS THE REQUIREMENTS OF THE PROJECT SPECIFICATIONS.
 - ALL SIGNS, PAVEMENT MARKINGS, AND OTHER TRAFFIC CONTROL DEVICES SHALL CONFORM TO THE "MANUAL ON UNIFORM TRAFFIC CONTROL DEVICES" LATEST EDITION, ALONG WITH ANY LOCAL AND/OR STATE REQUIREMENTS.
 - TRAFFIC CONTROL SHALL BE IN ACCORDANCE WITH THE STATE DOT STANDARD SPECIFICATIONS FOR ROADS AND BRIDGES. CONTRACTOR SHALL REVIEW ALL TRAFFIC CONTROL DEVICES WITH DOT PRIOR TO INSTALLATION.
 - CONTRACTOR SHALL FURNISH AND INSTALL ALL PAVEMENT MARKINGS FOR PARKING STALLS, HANDICAPPED PARKING SYMBOLS, AND MISCELLANEOUS STRIPING WITHIN PARKING LOT AND AROUND BUILDING.
 - SEE IRRIGATION PLAN AND MEP PLANS PRIOR TO PAVING FOR LOCATION OF PROPOSED SLAVES AND CONDUITS. EXTRA CONDUIT SHALL BE PLACED UNDER DRIVEWAYS FOR FUTURE USE.
 - ALL HANDICAPPED PARKING, STRIPING, AND PAVEMENT MARKINGS SHALL CONFORM TO THE AMERICANS WITH DISABILITIES ACT OF 1990 AND THE 2010 ADA STANDARDS FOR ACCESSIBLE DESIGN.
 - CONTRACTOR SHALL INSTALL CONSTRUCTION/EXPANSION JOINTS AT THE END OF A DAYS POUR AT ALL RADII POINTS, OR MAXIMUM 90' O.C. SPACING. CONTROL JOINTS SHALL BE PLACED AT MAXIMUM 35' IN BOTH DIRECTIONS.
 - CONTRACTOR TO SUBMIT A JOINTING PLAN TO THE CONSTRUCTION MANAGER PRIOR TO THE BEGINNING OF ANY PAVING WORK.
 - PAVING CONTRACTOR TO COORDINATE WITH BUILDING CONTRACTOR ON THE CONSTRUCTION AND PAVING NEAR THE SCREENING WALLS AND THE DUMPSTER PADS.
 - ALL DISCREPANCIES FOUND BY CONTRACTOR RELATED TO UNDERGROUND UTILITIES OR OTHER APPURTENANCES SHALL BE RESOLVED TO THE SATISFACTION OF OWNER AND ENGINEER PRIOR TO PLACEMENT OF ANY PAVING. CONTRACTOR TO ENSURE POSITIVE DRAINAGE FROM THE PROPOSED BUILDINGS AND NO PONDING IN SUBGRADE OF AREAS TO BE PAVED, AND NOTIFY OWNER AND ENGINEER IF ANY DISCREPANCIES ARE FOUND PRIOR TO INSTALLATION OF ANY PAVING.
 - EXISTING MANHOLE TOPS, VALVE BOXES, ETC. ARE TO BE ADJUSTED AS REQUIRED TO MATCH PROPOSED GRADES. IF NECESSARY, RE-ADJUSTMENTS SHALL BE PERFORMED UPON COMPLETION OF PAVING AND FINISH GRADING TO ENSURE A SMOOTH TRANSITION.
 - ALL JOINTS SHALL EXTEND THROUGH THE CURB.
 - CONSTRUCTION SHALL BE DONE IN ACCORDANCE WITH THE RECOMMENDATIONS OF THE GEOTECHNICAL REPORT.
 - ALL PAVEMENT TO BE SLOPED FOR POSITIVE DRAINAGE.
- NOTE:
- ANY EXISTING STRIPING ERADICATED BY MILL & INLAY SHALL BE REPLACED WITH NEW STRIPING.
 - ALL RPMS REMOVED BY MILL & INLAY SHALL BE REPLACED
 - RPMS SHALL BE INSTALLED ALONG ALL NEW TURN LANES.
 - SPALDING COUNTY IS NOT RESPONSIBLE FOR MAINTENANCE OF DRIVEWAY WITHIN R/W

GRAPHIC SCALE
1 inch = 40 ft.

NORTH

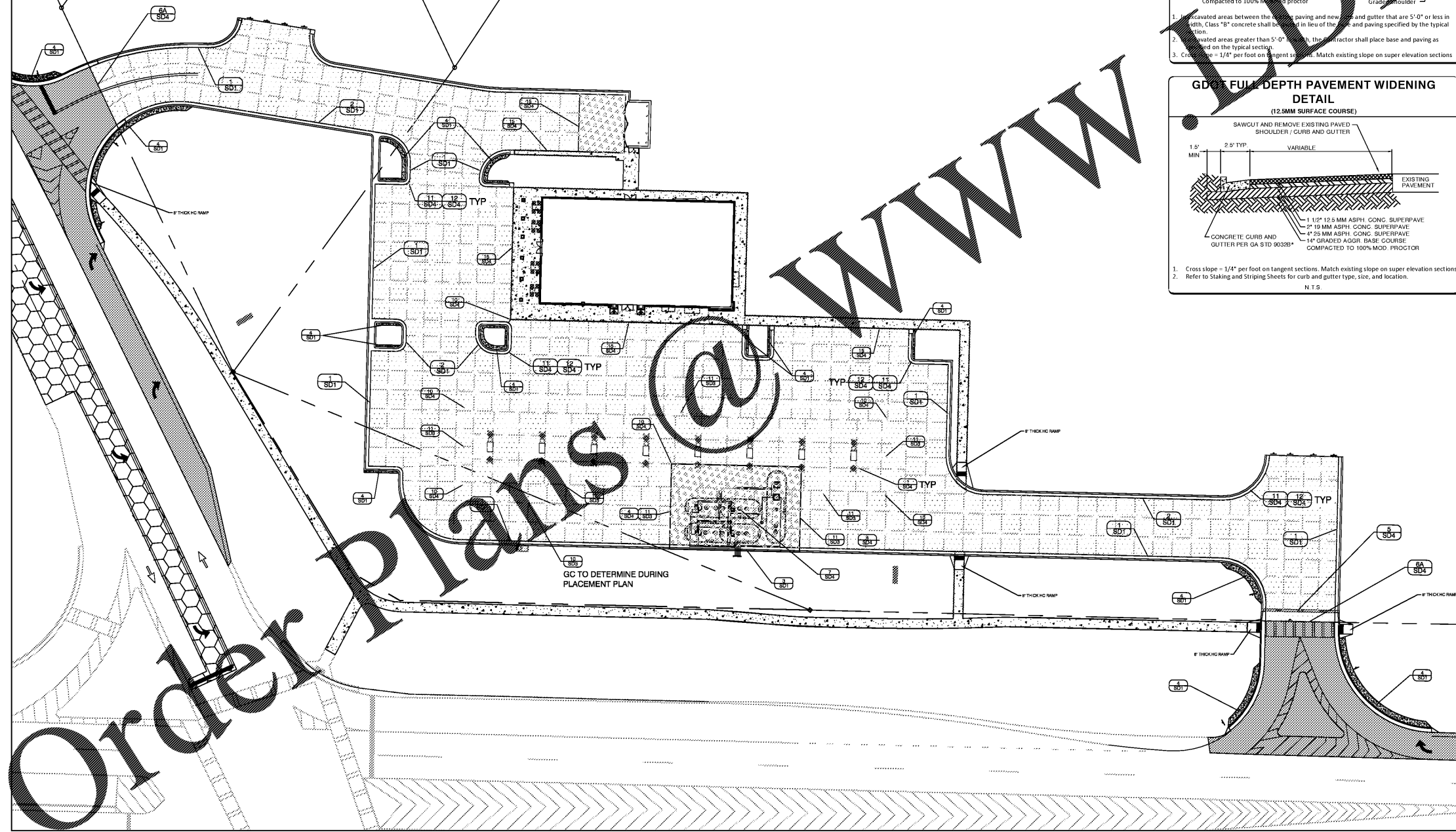

Order Plans @

WWW

www.orderplans.com

NO.	REVISIONS	DATE
1	REVISED SET PER RT INTERNAL REVIEW / SPALDING COUNTY PLAN REVIEW	09/15/2017
2	REVISED SET PER RT INTERNAL REVIEW / SPALDING COUNTY PLAN REVIEW	12/20/2017
3	REVISED SET PER RT INTERNAL REVIEW / SPALDING COUNTY PLAN REVIEW	12/20/2017
4	REVISED SET PER SPALDING COUNTY PLAN REVIEW	12/20/2017
5	REVISED SET PER SPALDING COUNTY PLAN REVIEW	12/20/2017
6	REVISED SET PER RT INTERNAL REVIEW / SPALDING COUNTY PLAN REVIEW	07/06/2018
7	REVISED PER SPALDING CO. CITY OF GRIFFIN / RT INTERNAL REVIEW	09/16/2018
8	REVISED PER SPALDING CO. COMMENTS	10/24/2018



A&R Engineering, Inc.
2100 Kingston Court, Suite O
Marietta, GA 30067
(770) 990-9255
www.aaring.com

Racetrac
RACETRAC PETROLEUM, INC.
200 GALLERIA PKWY, S.E.
SUITE 900 ATLANTA, GA 30339
(770) 431-7600

Site Paving Plan	
RACETRAC MARKET	
RaceTrac Griffin 1638 US Hwy 41 Spalding County	
DATE	7-24-17
DRAWN BY	JDE
CHECK BY	AKA
DRAWING NAME	16-136
C-1.2	REV 9
SHEET NO.	REVISION