

Know what's below.
Call before you dig.

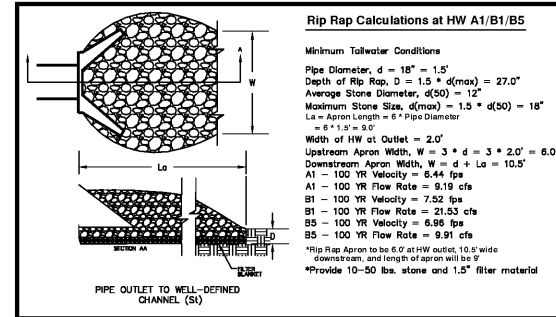
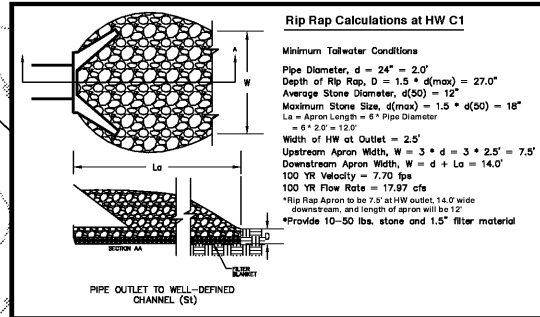

24 Hour Contact:
PRESTON SCOTT
470-559-2582

"I CERTIFY UNDER PENALTY OF LAW THAT THIS PLAN WAS PREPARED AFTER A SITE VISIT TO THE LOCATIONS DESCRIBED HEREIN BY MYSELF OR MY AUTHORIZED AGENT, UNDER MY SUPERVISION."

Abdul K. Amer 09/28/18
DATE

P.E. # 27518
E&SCP ID# 10456 EXP: 09-01-2021

PHASE 3 DISTURBED AREA
4.91 AC

GEORGIA SOIL AND WATER CONSERVATION COMMISSION NOTES

EROSION CONTROL MEASURES WILL BE MAINTAINED AT ALL TIMES. IF FULL IMPLEMENTATION OF THE APPROVED MEASURES DOES NOT OCCUR FOR EFFECTIVE CONTROL OF EROSION AND SEDIMENT CONTROL MEASURES WILL BE INSTALLED TO CONTROL EROSION AND SEDIMENT SOURCE.

THE EROSION AND SEDIMENT CONTROL MEASURES WILL BE CHECKED DAILY AND ANY DEFICIENCIES NOTED WILL BE CORRECTED BY THE END OF EACH DAY. ADDITIONAL EROSION AND SEDIMENT CONTROL MEASURES WILL BE INSTALLED IF DEEMED NECESSARY AFTER ON-SITE INSPECTION BY THE ISSUING AUTHORITY.

ANY DISTURBED AREA LEFT EXPOSED FOR A PERIOD GREATER THAN 14 DAYS SHALL BE STABILIZED WITH MULCH OR TEMPORARY SEEDING.

NOTE: GDOT APPROVED MATTING BLANKETS (Ss) SHALL BE USED ON ALL SLOPES 3:1 OR STEEPER.

PHASE III CONSTRUCTION SEQUENCING NOTES

- CONTRACTOR SHALL ENSURE ADEQUATE INLET PROTECTION ON ALL INLETS AT ALL TIMES.
- AFTER COMPLETION OF CONSTRUCTION, CONTRACTOR SHALL PERFORM FINAL STABILIZATION.
- AFTER FINAL STABILIZATION CONTRACTOR SHALL REMOVE ANY SEDIMENT THAT MAY HAVE ACCUMULATED IN UNDERGROUND PIPING.
- AFTER FINAL STABILIZATION, CONTRACTOR SHALL REMOVE ALL TEMPORARY EROSION CONTROL DEVICES AND CONTACT DEVELOPER'S CONSTRUCTION MANAGER TO FILE NOT FOR THE CONSTRUCTION.

ES&PC LEGEND		
VEGETATIVE PRACTICES		
CODE	PRACTICE	DESCRIPTION
Ds1	DISTURBED AREA STABILIZATION (MULCHING ONLY)	Establishing temporary protection for disturbed areas where seedlings are a possibility. Mulching and seeding to stabilize erosion eroding cover.
Ds2	DISTURBED AREA STABILIZATION (TEMP SEEDING)	Establishing a temporary vegetative cover over disturbed areas.
Ds3	DISTURBED AREA STABILIZATION (PERM SEEDING)	Establishing a permanent vegetative cover over disturbed areas.
Ds4	DISTURBED AREA STABILIZATION (SEEDING)	A permanent vegetative cover using sods on highly erodible or critically eroded lands.
Ds5	DUST CONTROL ON DISTURBED AREAS	Controlling surface and air movement of dust on construction site, roadways and similar sites.
FI-Co	FLOCCULANTS AND COAGULANTS	Substance formulated to assist in the solids/liquid separation of suspended particles in solution.
Ss	SLOPE STABILIZATION	A protective covering used to prevent erosion and establish temporary or permanent vegetation on steep slopes, shore lines, or channels.
Tac	TACKIFIER	Substance formulated to assist with stabilization of soil, seed, compost, straw, hay, or mulch.
STRUCTURAL PRACTICES		
CODE	PRACTICE	DESCRIPTION
Cd	CHECKDAM	A small temporary barrier or dam constructed across a swale, drainage ditch or area of concentrated flow.
Cs	CHANNEL STABILIZATION	Improving, constructing or stabilizing an open channel, existing stream, or ditch.
Co	CONSTRUCTION EXIT	A crushed stone pad located at the construction site exit to provide a place for removing mud from tires thereby protecting public streets.
Di	DIVERSION	An earth channel or dike located above, below, or across a slope to direct runoff. This may be a temporary or permanent structure.
Dn-1	TEMPORARY DOWNDRAIN STRUCTURE	A flexible conduit of heavy-duty fabric or other material designed to safely conduct surface runoff down a slope. This is temporary and inexpensive.
Dn-2	PERMANENT DOWNDRAIN STRUCTURE	A paved chute, pipe, sectional conduit or similar material designed to safely conduct surface runoff down a slope.
Fr	FILTER RING	A temporary stone barrier constructed at storm drain inlets and pond outlets.
Lv	LEVEL SPREADER	A structure to convert concentrated flow of water into less erosive sheet flow. This should be constructed only on undisturbed soils.
Rd	ROCK FILTER DAM	A permanent or temporary stone filter dam installed across small streams or drainageways.
Re	RETAINING WALL	A wall installed to stabilize cut and fill slopes where maximum permissible slopes are not obtainable.
Rt	RETRO FITTING	A device or structure placed in front of a permanent stormwater detention pond outlet structure to serve as a temporary sediment filter.
Sd1	SEDIMENT BARRIER	A barrier to prevent sediment from leaving the construction site. It may be sandbags, hay/straw bales, brush, logs/poles, gravel, or a silt fence.
Sd2	INLET SEDIMENT TRAP	An impounding area created by excavating around a storm drain drop inlet. The excavated area will be filled and stabilized on completion of construction activities.
Sd3	TEMPORARY SEDIMENT BASIN	A basin created by excavation or a dam across a roadway. The surface water runoff is temporarily stored allowing the bulk of the sediment to drop out.
Sd4	TEMPORARY SEDIMENT TRAP	A small temporary pond that drains a disturbed area so that sediment can settle out. Distinguishing features from a temporary sediment trap from a temporary sediment basin is the lack of a pipe or riser.
Sk	FLOATING SURFACE SKIMMER	A buoyant device that releases/retains water from the surface of sediment ponds, traps, or basins at a controlled rate of flow.
St	STORMDRAIN OUTLET PROTECTION	A paved or short section of riprap channel at the outlet of a storm drain system preventing erosion from the concentrated runoff.
Su	SURFACE ROUGHENING	A rough soil surface with horizontal depressions on a contour or slopes left in a roughened condition after grading.
Tr	TREE PROTECTION	To protect desirable trees from injury during construction activity.

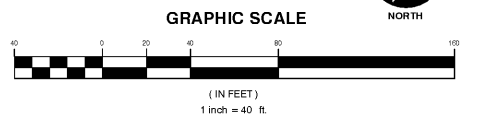
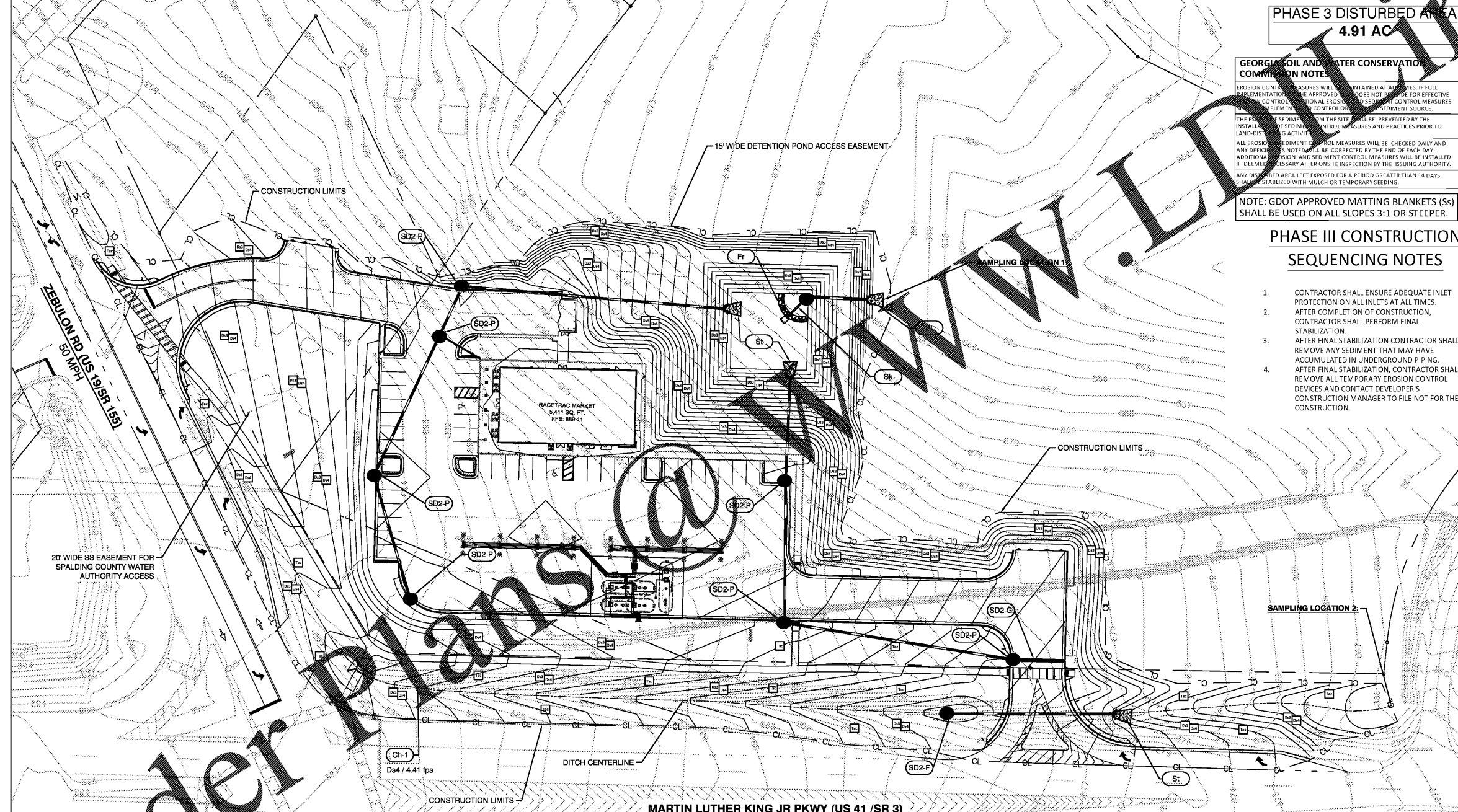

10/24/2018	REVISIONS	DATE
09/16/2018	1	09/16/2018
07/06/2018	2	07/06/2018
07/06/2018	3	07/06/2018
12/01/2017	4	12/01/2017
02/07/2017	5	02/07/2017
09/25/2017	6	09/25/2017
	7	
	8	
	9	

ES&PC Phase 3
RACETRAC MARKET

RaceTrac Griffin
1638 US Hwy 41
Spalding County

DATE: 7-24-17
DRAWN BY: JDE
CHECK BY: AKA
DRAWING NAME: 16-136
ES-3.0 REV 9
SHEET NO. REVISION

Order Plans @ WWW.A&REngineering.com

