

Know what's below.
Call before you dig.

24 Hour Contact:
PRESTON SCOTT
470-559-2582

"I CERTIFY UNDER PENALTY OF LAW THAT THIS PLAN WAS PREPARED AFTER A SITE VISIT TO THE LOCATIONS DESCRIBED HEREIN BY MYSELF OR MY AUTHORIZED AGENT, UNDER MY SUPERVISION."
Abdul K. Amer 09/28/18
DATE
Abdul K. Amer
P.E. # 27518
ES&PC ID# 10456 EXP: 09-01-2021

PHASE 1, DISTURBED AREA
1.4 AC

GEORGIA SOIL AND WATER CONSERVATION COMMISSION NOTES
CONSTRUCTION MEASURES WILL BE MAINTAINED AT ALL TIMES. IF FULL EROSION CONTROL IS NOT MAINTAINED, THE CONTRACTOR SHALL PROVIDE FOR EFFECTIVE EROSION CONTROL MEASURES TO PREVENT EROSION. THE CONTRACTOR SHALL MAINTAIN CONTROL OF THE SEDIMENT SOURCE. THE EROSION CONTROL MEASURES SHALL BE INSTALLED PRIOR TO ANY DISTURBANCE OF THE SITE. THE CONTRACTOR SHALL BE RESPONSIBLE FOR THE INSTALLATION AND MAINTENANCE OF EROSION CONTROL MEASURES AND PRACTICES PRIOR TO ANY DISTURBANCE OF THE SITE. ALL EROSION CONTROL MEASURES WILL BE CHECKED DAILY AND ANY DEFICIENCIES NOTED WILL BE CORRECTED BY THE END OF EACH DAY. ADDITIONAL EROSION AND SEDIMENT CONTROL MEASURES WILL BE INSTALLED AS NECESSARY AFTER ON-SITE INSPECTION BY THE ISSUING AUTHORITY. THE DISTURBED AREA LEFT EXPOSED FOR A PERIOD GREATER THAN 14 DAYS SHALL BE STABILIZED WITH MULCH OR TEMPORARY SEEDING.

NOTE: GDOT APPROVED MATTING BLANKETS (Ss) SHALL BE USED ON ALL SLOPES 3:1 OR STEEPER.

PHASE I CONSTRUCTION SEQUENCING NOTES

- CONTRACTOR SHALL OBTAIN A LDP PERMIT AND DEMOLITION PERMIT, AND SHALL FILE NOI WITH GA DEP (NOTE: NOI MUST BE FILED 14 DAYS PRIOR TO COMMENCEMENT OF LAND DISTURBING ACTIVITIES).
- CONTRACTOR SHALL INSTALL SILT FENCE, INLET PROTECTION, AND CONSTRUCTION EXIT.
- CONTRACTOR SHALL PROTECT INLETS AT ALL TIMES TO PREVENT SEDIMENT FROM ENTERING SYSTEM. CONTRACTOR SHALL INSTALL STORM PIPE UP DISCHARGING DETENTION POND/SKIMMER (ONLY DEMOLISH AREAS NECESSARY FOR PIPE CONSTRUCTION).
- CONTRACTOR TO INSTALL DETENTION POND/SKIMMER AND DIVERSION DITCHES. (ONLY CLEAR AREA NECESSARY FOR BMP CONSTRUCTION & SKIMMER)
- CONTRACTOR SHALL CONTACT A&R ENGINEERING, INC. WITHIN 48 HOURS OF THE COMPLETION OF THE SHOWN EROSION CONTROL MEASURES TO SCHEDULE A&R'S "7-DAY INSPECTION" PER THE STATE'S GENERAL STORM WATER PERMIT.
- THE DESIGN PROFESSIONAL WHO PREPARED THE ES&PC PLAN IS TO INSPECT THE INSTALLATION OF THE INITIAL SEDIMENT STORAGE REQUIREMENTS AND PERIMETER CONTROL BMPS WITHIN 7 DAYS AFTER INSTALLATION. IF BMP'S SHOWN ARE NOT ADEQUATE TO CONTAIN SEDIMENTATION ON-SITE, CONTRACTOR SHALL PROVIDE ADDITIONAL MEASURES TO CONTROL SEDIMENT. IF DETENTION POND, STORM OUTLET PROTECTIONS, OR ANY OTHER STRUCTURAL MEASURES MUST BE RESIZED OR REDESIGNED, CONTRACTOR SHALL CONTACT A&R ENGINEERING, INC. TO PROVIDE ADDITIONAL DIRECTION. NO ALTERNATIVE BMP'S TO BE USED ON-SITE.

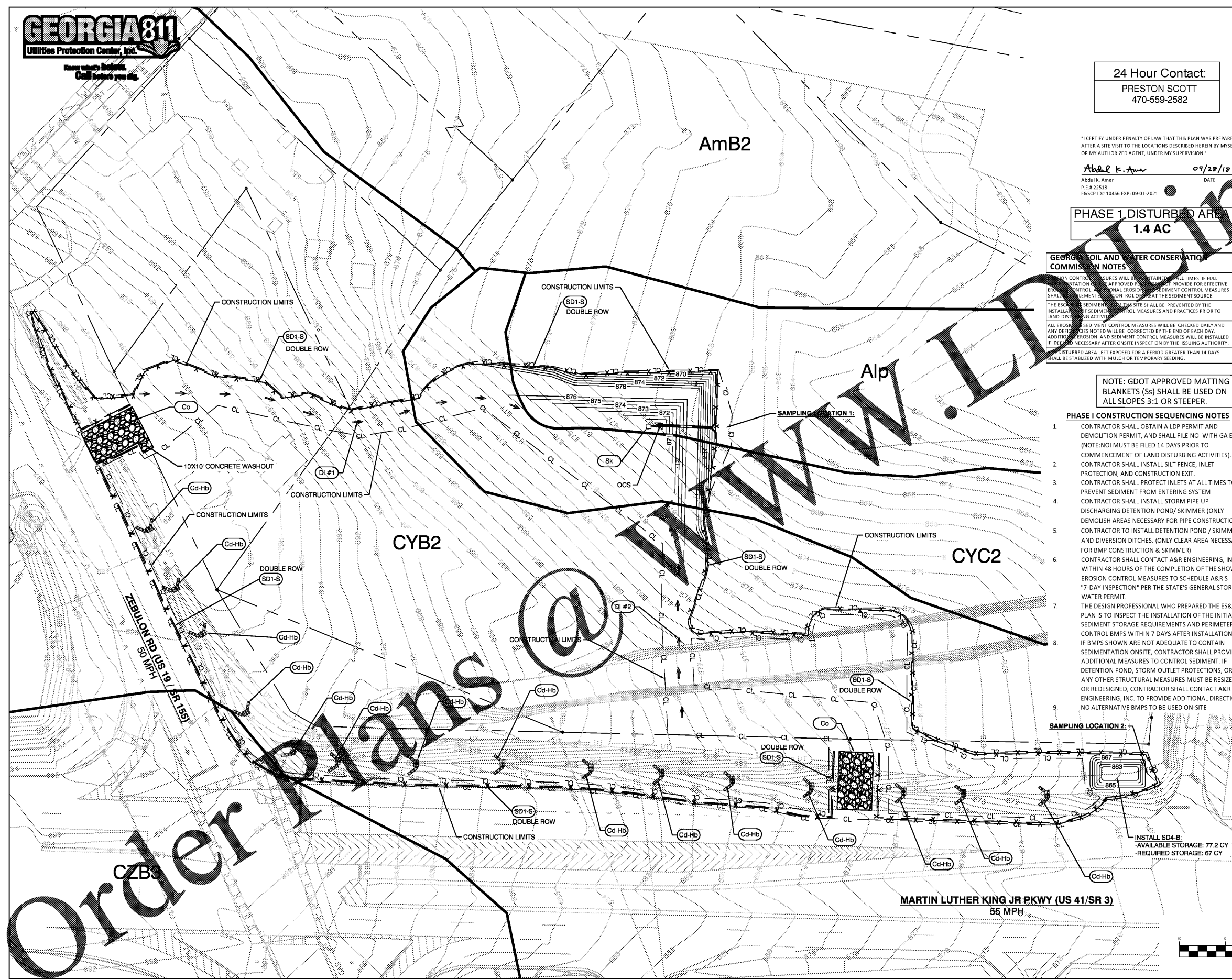

ES&PC LEGEND

VEGETATIVE PRACTICES

CODE	PRACTICE	DESCRIPTION
Ds1	DISTURBED AREA STABILIZATION (MULCHING ONLY)	For disturbed areas, protection for disturbed areas. Seedings may not have a sufficient season to provide an eroding cover.
Ds2	DISTURBED AREA STABILIZATION (TEMP SEEDING)	Establishing a temporary vegetative cover using seedings on disturbed areas.
Ds4	DISTURBED AREA STABILIZATION (PERM SEEDING)	Establishing a permanent vegetative cover using seeds on highly erodible or critically eroded lands.
Du	DUST CONTROL ON DISTURBED AREAS	Controlling surface and air movement of dust on construction site, roadways and similar sites.
Fl-Co	FLOCCULANTS AND COAGULANTS	Substance formulated to assist in the solids/liquid separation of suspended particles in solution.
Ss	SLOPE STABILIZATION	A protective covering used to prevent erosion and establish temporary or permanent vegetation on steep slopes, shore lines, or channels.
Tac	TACKIFIER	Substance formulated to assist with stabilization of soil, seed, compost, straw, hay, or mulch.

STRUCTURAL PRACTICES

CODE	PRACTICE	DESCRIPTION
Cd	CHECKDAM	A small temporary barrier or dam constructed across a swale, drainage ditch or area of concentrated flow.
Cs	CHANNEL STABILIZATION	Improving, constructing or stabilizing an open channel, existing stream, or ditch.
Co	CONSTRUCTION EXIT	A crushed stone pad located at the construction site exit to provide a place for removing mud from tires thereby protecting public streets.
Di	DIVERSION	An earth channel or dike located above, below, or across a slope to divert runoff. This may be a temporary or permanent structure.
Dn-1	TEMPORARY DOWNDRAIN STRUCTURE	A flexible conduit of heavy duty fabric or other material designed to safely conduct surface runoff down a slope. This is temporary and inexpensive.
Dn-2	PERMANENT DOWNDRAIN STRUCTURE	A paved chute, pipe, section or similar material designed to safely conduct surface runoff down a slope.
Fr	FILTER RING	A temporary stone barrier constructed at a storm drain inlets and pond outlets.
Lv	LEVEL SPREADER	A structure to convert concentrated flow of water into less erosive sheet flow. This should be constructed only on undisturbed soils.
Rd	ROCK FILTER DAM	A permanent or temporary stone filter dam installed across small streams or drainageways.
Re	RETAINING WALL	A wall installed to stabilize cut and fill slopes where maximum permissible slopes are not obtainable.
Rt	RETRO FITTING	A device or structure placed in front of a permanent stormwater detention pond outlet structure to serve as a temporary sediment filter.
Sd1	SEDIMENT BARRIER	A barrier to prevent sediment from leaving the construction site. It may be sandbags, hay/straw bales, brush, logs/poles, gravel, or a silt fence.
Sd2	INLET SEDIMENT TRAP	An impounding area created by excavating around a storm drain drop inlet. The excavated area will be filled and stabilized on completion of construction activities.
Sd3	TEMPORARY SEDIMENT BASIN	A basin created by excavation or a dam across a waterway. The surface water runoff is temporarily stored allowing the bulk of the sediment to drop out.
Sd4	TEMPORARY SEDIMENT TRAP	A small temporary pond that drains a disturbed area so that sediment can settle out. Distinguishing features from a temporary sediment trap from a temporary sediment basin is the lack of a pipe or riser.
Sk	FLOATING SURFACE SKIMMER	A buoyant device that releases/draws water from the surface of sediment ponds, traps, or basins at a controlled rate of flow.
St	STORMDRAIN OUTLET PROTECTION	A paved or short section of riprap channel at the outlet of a storm drain system preventing erosion from the concentrated runoff.
Su	SURFACE ROUGHENING	A rough soil surface with horizontal depressions on a contour or slopes left in a roughened condition after grading.
Tr	TREE PROTECTION	To protect desirable trees from injury during construction activity.

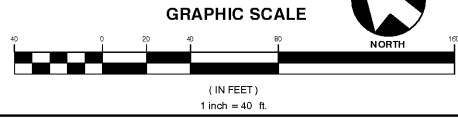

Order Plans

10/24/2018	REVISIONS	DATE
09/16/2018	1	DATE
07/06/2018	2	DATE
07/06/2018	3	DATE
12/12/2017	4	DATE
12/12/2017	5	DATE
12/12/2017	6	DATE
12/12/2017	7	DATE
09/15/2017	8	DATE

9. REVISED PER SPALDING CO COMMENTS
10. REVISED PER SPALDING CO COMMENTS
11. REVISED PER SPALDING CO COMMENTS
12. REVISED PER SPALDING CO COMMENTS
13. REVISED PER SPALDING CO COMMENTS
14. REVISED PER SPALDING CO COMMENTS
15. REVISED PER SPALDING CO COMMENTS
16. REVISED PER SPALDING CO COMMENTS
17. REVISED PER SPALDING CO COMMENTS
18. REVISED PER SPALDING CO COMMENTS
19. REVISED PER SPALDING CO COMMENTS
20. REVISED PER SPALDING CO COMMENTS

ES&PC Phase 1
RACETRAC MARKET
RaceTrac Griffin
1638 US Hwy 41
Spalding County

Racetrac
RACETRAC PETROLEUM, INC.
200 GALLERIA PKWY, S.E.
SUITE 900 ATLANTA, GA 30339
(770) 431-7600

DATE: 7-24-17
DRAWN-BY: JDE
CHECK-BY: AKA
DRAWING NAME: 16-136
SHEET NO.: ES-1.0
REVISION: REV 9