

Drawing name: L:\005031 - RaceTrac - Cartersville (E Main Street)_GAC\ADD\CONSTR\005031_08 - PROFILES.dwg GAS PROFILE Sep 06, 2018 8:01am by: michael.tothaker

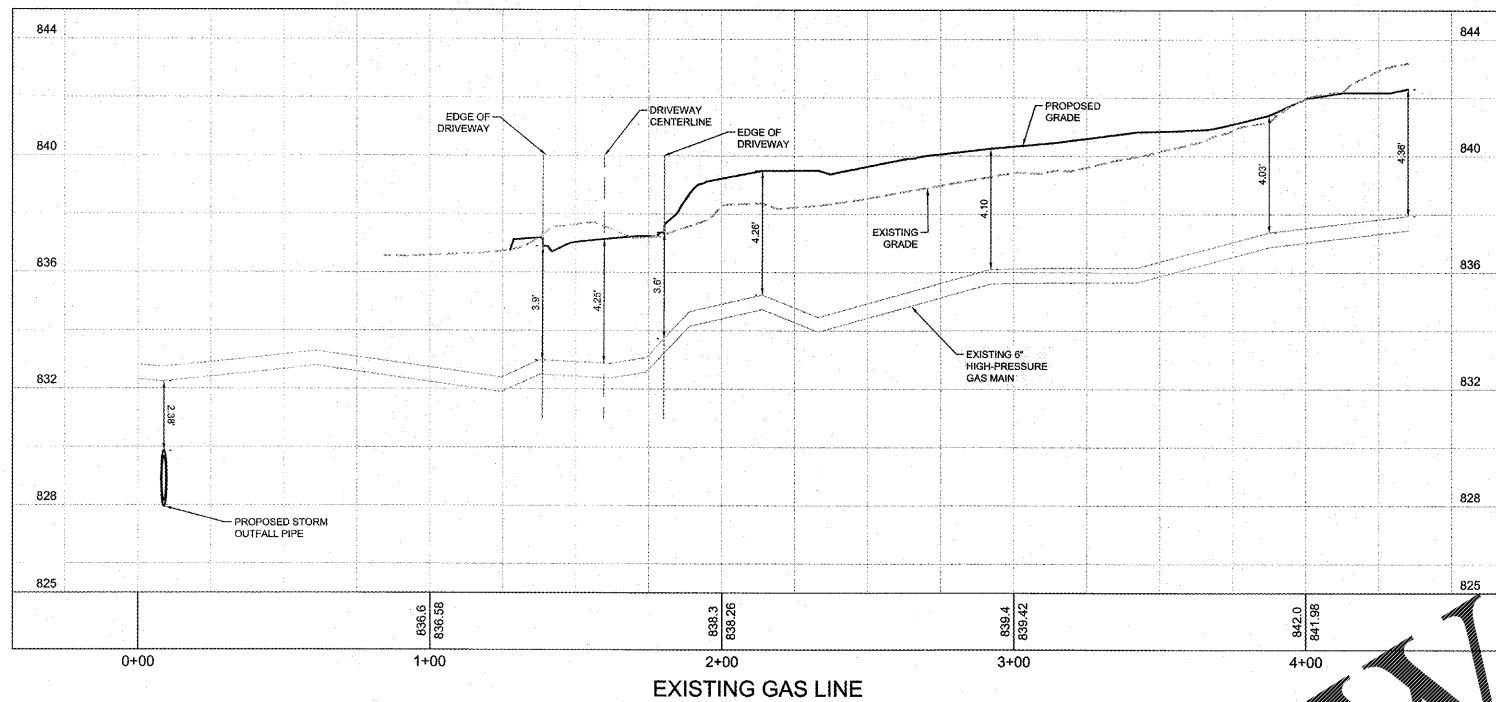

GAS PROFILE IS SHOWN FOR INFORMATIONAL PURPOSES ONLY. PROFILE IS BASED ON POTHOLE LOCATIONS AND DEPTH PROVIDED BY RHD UTILITY LOCATING SERVICE.

Order Plans @ www.LDILine.com

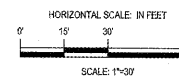

NO.	REVISIONS	BY	DATE
3	CITY COMMENTS	TAA	9/05/18
2	CITY COMMENTS	TAA	8/08/18
1	CITY COMMENTS	TAA	5/31/18

PREPARED IN THE OFFICE OF:
LDICRAW
ENGINEERING
© 2018 LDICRAW ENGINEERING, INC.
1000 W. STATE A
DULUTH, GEORGIA 30098
PHONE: 878-548-8100 FAX: 770-441-0288
WWW.LDICRAWENGINEERING.COM
MEMPHIS, TN

FOR INFORMATIONAL PURPOSES ONLY

THESE PLANS ARE SUBJECT TO FEDERAL COPYRIGHT LAWS. ANY USE OF SAME WITHOUT THE EXPRESS WRITTEN PERMISSION OF RACETRAC PETROLEUM, INC. IS PROHIBITED.

RaceTrac
RACETRAC PETROLEUM, INC.
200 GALLERIA PKWY, SUITE 900
ATLANTA, GA 30339
(770) 431-7600

EXISTING GAS PROFILE	
RACETRAC MARKET	1328 E. MAIN STREET
SITE	CARTERSVILLE, BARTOW COUNTY, GEORGIA LAND LOT 390, 4TH DISTRICT, 3RD SECTION, PARCEL C096-0390-001
SCALE	1" = 30'
DRAWN	MAT
DATE	03/28/2018
JOB NO.	005031

C-4.3	REV.
SHEET NO.	REV.