

24 HOUR CONTACT:  
MR. MARK MCGINNIS - 678.773.7063  
RACETRAC PETROLEUM, INC.  
CONTACT RACETRAC PETROLEUM, INC.  
PROJECT MANAGER PRIOR TO ANY  
REVISIONS TO THE PLAN SUPPLIED BY  
RACETRAC PETROLEUM, INC.

LEGEND	
	PROPOSED 4" THICK CONCRETE SIDEWALK
	PROPOSED 8" THICK CONCRETE PAVING WITH #3 REBAR @ 18" OC EACH WAY WITH 14" LAP SPLICE. (SEE DETAIL THIS SHEET)
	PROPOSED 8" THICK CONCRETE PAVING FOR DUMPSTER & TANK PAVEMENT WITH #6 REBAR @ 9" OC EACH WAY WITH 24" LAP SPLICE. (SEE DETAIL THIS SHEET)
	PROPOSED 8" THICK CONCRETE CURB BACKING (SEE DETAIL 3, SHEET SD1)
	ASPHALT PAVING / DOT PAVING SPEC / COUNTY PAVING SPEC
	ARCHITECTURAL STAMPED CONCRETE (REFER TO ARCHITECTURAL PLANS)
	CATCH CURB (SEE DETAIL 1, SHEET SD1)
	SHED CURB (SEE DETAIL 2, SHEET SD1)

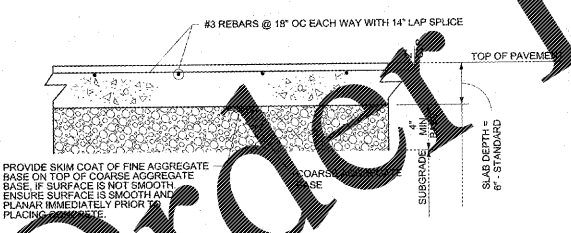

NOTE: PAVEMENT SPECS AND DETAILS ARE PROVIDED BY RACETRAC PETROLEUM AND HAVE NOT BEEN DESIGNED BY THE ENGINEER OF RECORD.

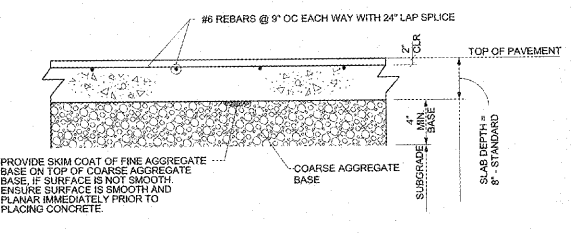
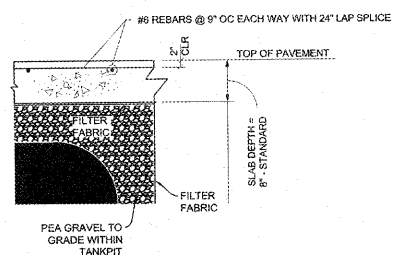
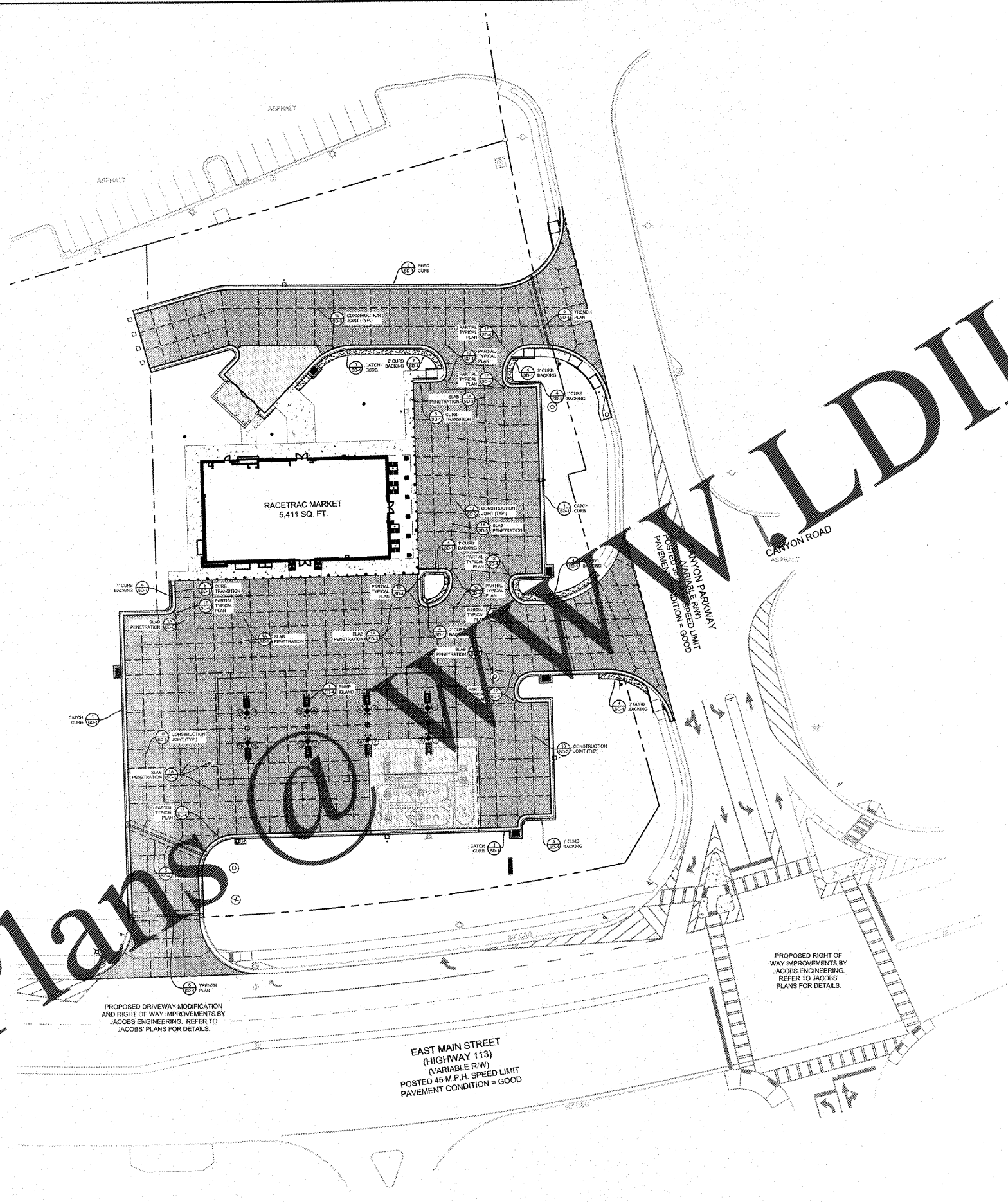

VICINITY MAP (N.T.S.)

LEGEND

- INDICATES EXISTING ELEVATIONS
- PROPOSED FINISHED GRADES
- SPRINKLER FINISHED GRADE
- INDICATES TOP OF STRUCTURE
- INDICATES FLOW LINE ELEVATION
- WATER LINE TO EXISTING SERVICE OR WELL
- WATER LINE FOR IRRIGATION
- 4" SANITARY SEWER LINE TO EXISTING SANITARY SEWER MANHOLE OR SEPTIC TANK
- BURIED ELECTRICAL SERVICE FROM NEAREST EXISTING UTILITY POLE
- TELEPHONE SERVICE FROM NEAREST TELEPHONE POLE RUN UNDERGROUND IN CONDUIT
- CONCRETE CURB (SEE SHEET SD-1)
- DISPENSER NUMBER
- DISPENSER PRODUCT I.D.
- PROPOSED PUBLIC TELEPHONE (SEE SHEET SD-1)
- WEATHERPROOF ELECTRICAL OUTLET
- EMERGENCY SHUT OFF SWITCH
- AREA LIGHT LOCATION (SEE SHEET SD-4 FOR DETAILS)
- STREET LIGHT LOCATION (SEE SHEET SD-4 FOR DETAILS)
- SPIDER LIGHTS (WHERE APPLICABLE)
- REVISION INDICATOR
- HIGH POINT
- INDICATES PROPOSED 6" CONCRETE AREA
- PROPOSED AIR/WATER STAND. (SEE SHEET SD-1)
- B.P. BUMPER POST (SEE SHEET SD-1)
- T.O.I. ELEVATION AT TOP OF ISLAND
- EXISTING ELEMENTS
- PROPOSED ELEMENTS
- P.P. POWER POLE
- M.H. MANHOLE
- S.S. SANITARY SEWER
- S.P.M.H. SUBMERGED PUMP MANHOLE
- D.I. DROP INLET
- TPF TREE PROTECTION FENCE
- LOD LIMITS OF DISTURBANCE
- T.W. TOP OF WALL
- B.W. BOTTOM OF WALL
- H.F. HIGH FRONT
- P.B. PIPE BEND

**PAVING PLAN NOTES:**

ALL SIGNS, PAVEMENT MARKINGS, AND OTHER TRAFFIC CONTROL DEVICES SHALL CONFORM TO THE "MANUAL ON UNIFORM TRAFFIC CONTROL DEVICES" LATEST EDITION.

TRAFFIC CONTROL SHALL BE IN ACCORDANCE WITH THE STATE DOT STANDARD SPECIFICATIONS FOR ROADS AND BRIDGES. CONTRACTOR SHALL REVIEW ALL TRAFFIC CONTROL DEVICES WITH DOT PRIOR TO INSTALLATION.

CONTRACTOR SHALL FURNISH AND INSTALL ALL PAVEMENT MARKINGS FOR PARKING STALLS, HANDICAPPED PARKING SYMBOLS, AND MISCELLANEOUS STRIPING WITHIN PARKING LOT AND AROUND BUILDING.

ALL HANDICAP RAMPING, STRIPING, AND PAVEMENT MARKINGS SHALL CONFORM TO THE AMERICANS WITH DISABILITIES ACT OF 1990.

CONTRACTOR TO SUBMIT A JOINTING PLAN TO THE CONSTRUCTION MANAGER PRIOR TO THE BEGINNING OF ANY PAVING WORK.

PAVING CONTRACTOR TO COORDINATE WITH BUILDING CONTRACTOR ON THE CONSTRUCTION AND PAVING NEAR THE SCREENING WALLS AND THE DUMPSTER PADS.

ALL DISCREPANCIES FOUND BY CONTRACTOR RELATED TO UNDERGROUND UTILITIES OR OTHER AFFERTANCES SHALL BE RESOLVED TO THE SATISFACTION OF OWNER AND ENGINEER PRIOR TO PLACEMENT OF ANY PAVING. CONTRACTOR TO ENSURE POSITIVE DRAINAGE FROM THE PROPOSED BUILDINGS AND NO PAVING IN SUBGRADE OF AREAS TO BE PAVED, AND NOTIFY OWNER AND ENGINEER IF ANY DISCREPANCIES ARE FOUND PRIOR TO INSTALLATION OF ANY PAVING.

EXISTING MANHOLE TOPS, VALVE BOXES, ETC. ARE TO BE ADJUSTED AS REQUIRED TO MATCH PROPOSED GRADES. IF NECESSARY, RE-ADJUSTMENTS SHALL BE PERFORMED UPON COMPLETION OF PAVING AND FINE GRADING TO ENSURE A SMOOTH TRANSITION.

ALL PAVEMENT TO BE SLOPED FOR POSITIVE DRAINAGE.

TAA	DATE	BY
TAA 10/26/18		
TAA 10/16/18		
TAA 9/24/18		
TAA 9/18/18		
TAA 9/05/18		
TAA 8/08/18		

NO.	REVISIONS
7	RACETRAC & CITY COMMENTS
6	STRIPING UPDATE & CITY COMMENTS
5	CARTERSVILLE ELECTRIC COMMENTS
4	CITY COMMENTS
3	CITY COMMENTS
2	CITY COMMENTS

PREPARED IN THE OFFICE OF:	
	LECRAW ENGINEERING
200 GALLERIA PKWY, SUITE 900 ATLANTA, GEORGIA 30339 PHONE: 678.548.1500 FAX: 770.441.0298 WWW.LECRAWENGINEERING.COM	

PROFESSIONAL SEAL	
	MARK S. LECRAW
NO. 30339 10/24/18 REGISTERED PROFESSIONAL ENGINEER CIVIL ENGINEERING	

THESE PLANS ARE SUBJECT TO FEDERAL COPYRIGHT LAWS. ANY USE OF SAME WITHOUT THE PERMISSION OF RACETRAC PETROLEUM, INC. IS PROHIBITED.	
	RACETRAC PETROLEUM, INC.
1328 E. MAIN STREET CARTERSVILLE, BARTOW COUNTY, GEORGIA LAND LOT 390, 3RD DISTRICT, 3RD SECTION, PARCEL C082-0380-021 ATLANTA, GA 30339 (770) 431-7800	

PAVING PLAN	
RACETRAC MARKET	
1328 E. MAIN STREET	
CARTERSVILLE, BARTOW COUNTY, GEORGIA	
LAND LOT 390, 3RD DISTRICT, 3RD SECTION, PARCEL C082-0380-021	
SITE	
SCALE	1" = 30'
DRAWN	
DATE	03/28/2018
JOB NO.	095031
SHEET NO.	C-1.2
REV.	

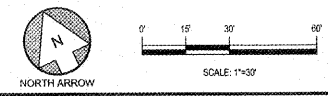

Drawing name: L:\065031 - RaceTrac - Cartersville (E Main Street)\_GACADD\CONSTR\0098031 - 05 - SITE.dwg PAVING PLAN Oct 26, 2018 2:30pm by: ltrd.anderson