

1 2 3 4 5 6

E  
D  
C  
B  
A

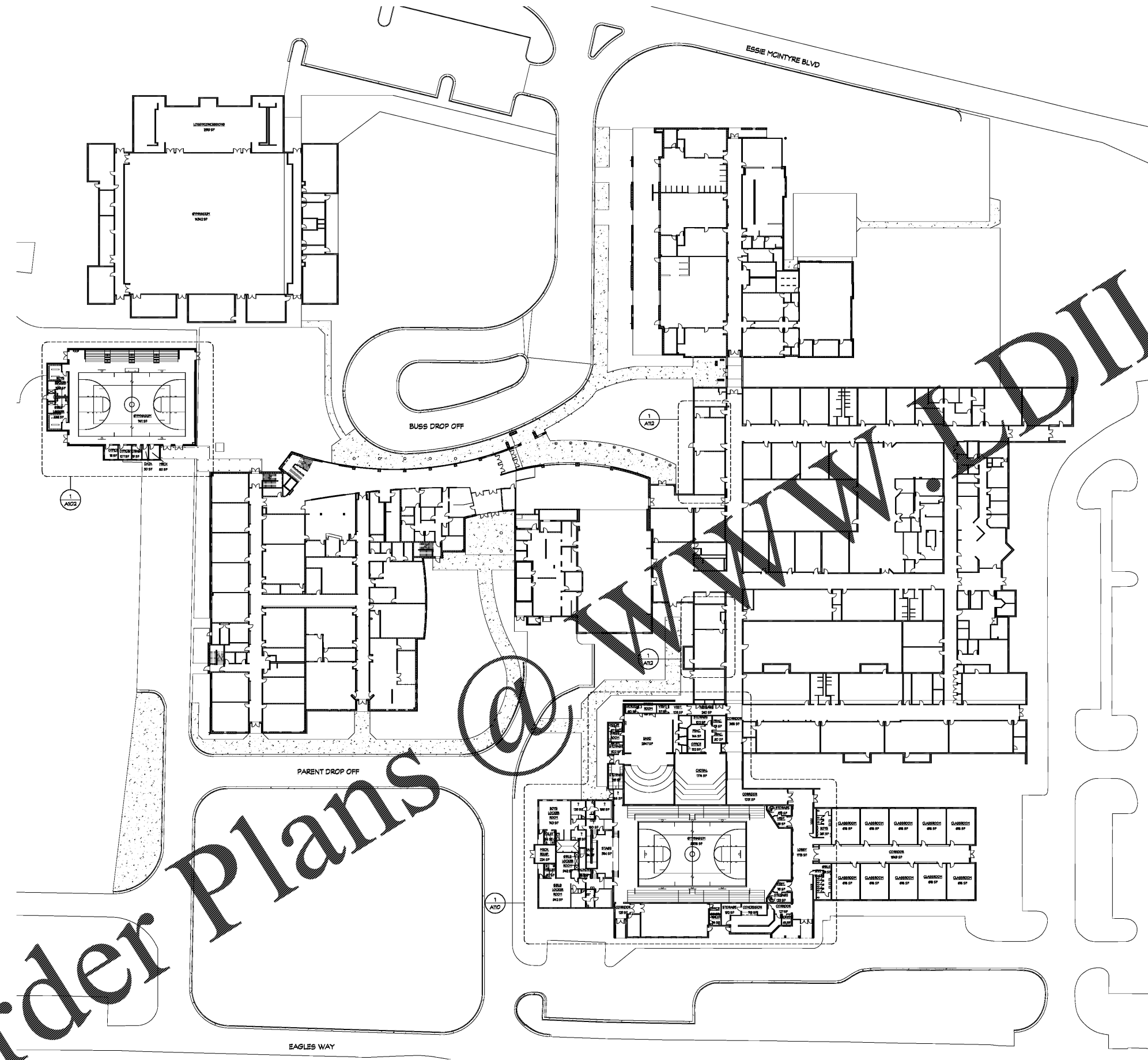

**SQUARE FOOTAGE REQUIREMENTS**

	MIN.	ACTUAL
EXISTING CAFETERIA	3,048 SF	5,453 SF
EXISTING KITCHEN & SUPPORT SPACES	2,400 SF	3,558 SF
EXISTING MEDIA CENTER & SUPPORT SPACES	3,675 SF	4,443 SF

FORMULA FOR CAFETERIA:  
MIDDLE & HIGH SCHOOL = TOTAL FTE/3.809  
(FTE x 3.809)  
800 x 3.809 = 3047.2

MIN SQUARE FOOTAGE BASED ON GA DEPARTMENT OF EDUCATION SQUARE FOOTAGE REQUIREMENTS FOR EDUCATION FACILITIES.

**dickinson**  
ARCHITECTS  
Architecture | Interior Design | Planning  
771 Broad Street, Suite 200  
Atlanta, Georgia 30308  
404.222.7488  
info@dickinsonarchitects.com  
www.dickinsonarchitects.com

Member of the  
American Institute of  
Architects

THIS DRAWING IS THE PROPERTY OF DICKINSON ARCHITECTS, P.C. AND IS NOT TO BE REPRODUCED OR COPIED IN WHOLE OR IN PART OR USED FOR ANY PURPOSE WITHOUT THE EXPRESS WRITTEN CONSENT OF DICKINSON ARCHITECTS, P.C. ANY UNAUTHORIZED REPRODUCTION OF THIS DRAWING IS PROHIBITED. © 2018 DICKINSON ARCHITECTS, P.C.

PROJECT TITLE:  
**MURPHEY  
MIDDLE  
SCHOOL P.E.  
BUILDING  
PROJECT #  
B-17-005-3756.1**

REVISIONS

REV #	DATE	APPROV BY	REVISION
	08/15/18	NDII	STATE PRELIM.
	11/02/18	NDII	STATE FINAL
	11/20/18	NDII	ISSUE FOR BID

**MURPHEY P.E. BUILDING  
PROJECT DATA**

FTE: 650 STUDENTS

TOTAL SQUARE FOOTAGE:

FLOOR AREA OF NEW CONSTRUCTION, INCLUDED OUTSIDE WALLS AT FULL VALUE	9,294 SF
FLOOR AREA OF COVERED BUT NOT ENCLOSED AREAS AT HALF VALUE	462 SF
<b>TOTAL:</b>	<b>9,756 SF</b>

INSTRUCTIONAL UNITS: 1

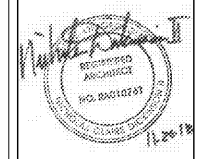

DA PROJECT NUMBER & NAME:  
1707.1

DRAWING TITLE:  
**COMPOSITE  
FLOOR PLAN**

DRAWING NO:  
**A101**

Order Plans

1 COMPOSITE FLOOR PLAN  
SCALE: 1/32" = 1'-0"

