

THIS DRAWING IS THE PROPERTY OF DICKINSON ARCHITECTS, P.C. AND IS NOT TO BE REPRODUCED OR COPIED IN WHOLE OR IN PART WITHOUT THE WRITTEN PERMISSION OF DICKINSON ARCHITECTS, P.C. FOR ANY OTHER PROJECT OR PURPOSE. ANY UNAUTHORIZED REPRODUCTION OR USE OF THIS DRAWING IS PROHIBITED. © 2018 DICKINSON ARCHITECTS, P.C.

PROJECT TITLE:
MURPHEY MIDDLE SCHOOL P.E. BUILDING
PROJECT #
B-17-005-3756.1

REV #	DATE	APPROV BY	REVISION
08/15/18	NDII	STATE	PRELIM.
11/02/18	NDII	STATE	FINAL
11/20/18	NDII	ISSUE	FOR BID

WALL LEGEND

EXISTING WALL 

CMU WALL 

WALL TYPES, SEE DWG A601 

MURPHEY P.E. BUILDING PROJECT DATA

FTE: 650 STUDENTS

TOTAL SQUARE FOOTAGE:

FLOOR AREA OF NEW CONSTRUCTION, INCLUDED OUTSIDE WALLS AT FULL VALUE	9,294 SF
FLOOR AREA OF COVERED BUT NOT ENCLOSED AREAS AT HALF VALUE	462 SF
TOTAL:	9,756 SF

INSTRUCTIONAL UNITS: 1

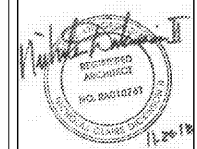

DA PROJECT NUMBER & NAME:
1707.1

DRAWING TITLE:
FLOOR PLAN

DRAWING NO:
A102

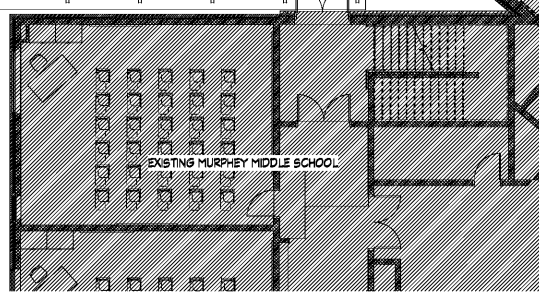
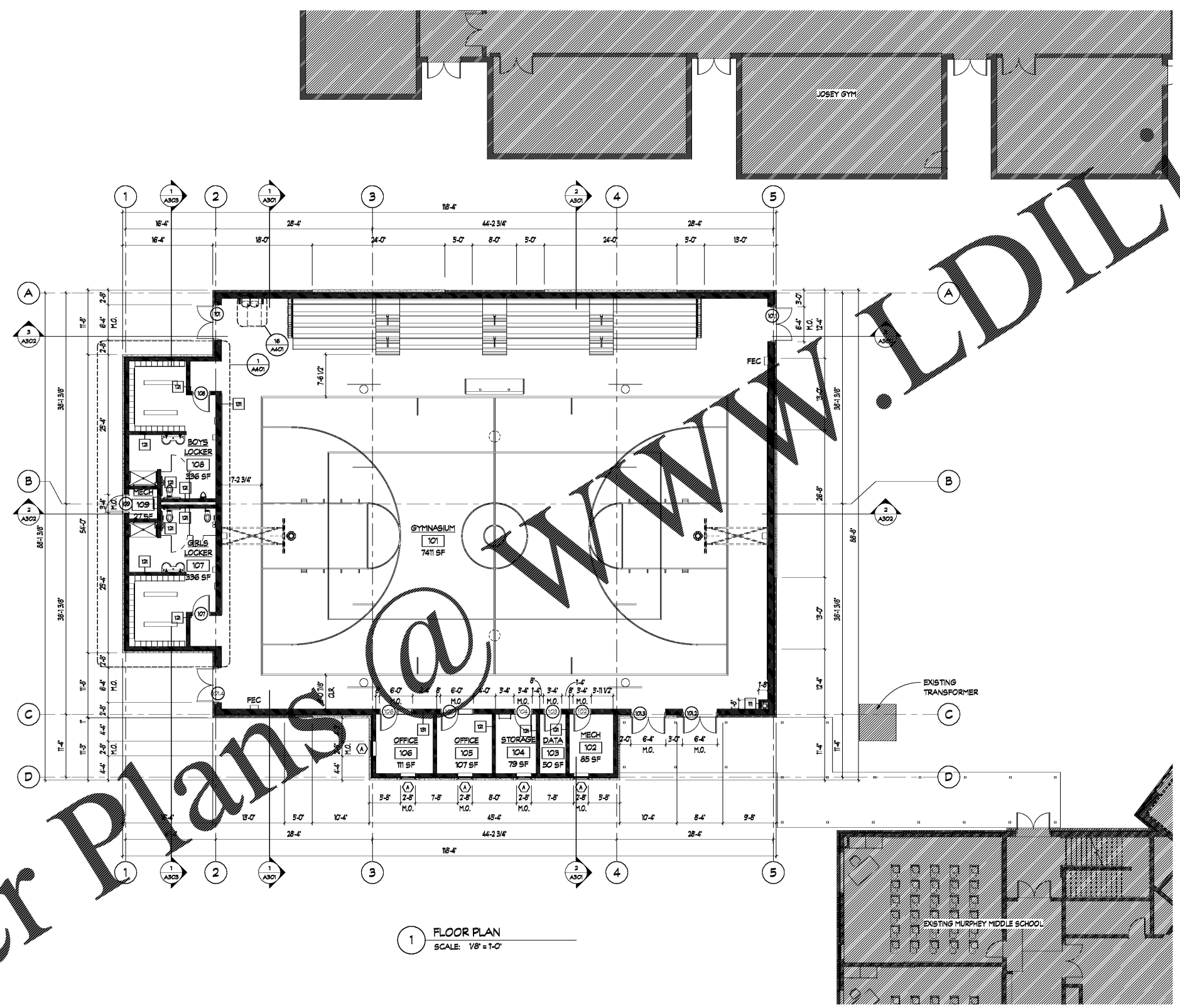

1 FLOOR PLAN
SCALE: 1/8" = 1'-0"

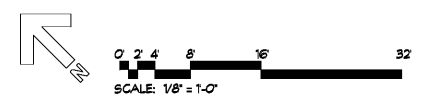

Order Plans @ www.LDILine.com