

**CIVIL:**  
 Choctaw Engineering, Inc.  
 112 Truxton Avenue  
 Fort Walton Beach, FL 32547  
 Phone: (850) 862-6211  
 Fax: (850) 863-8059  
 Email: msiner@choctaweng.com

**STRUCTURAL:**  
 Whisnani Engineering Services, LLC  
 122 Nut Tree Court  
 Lexington, SC 29074  
 Phone: (803) 957-4008  
 Email: bill@weslex.com

**MEP:**  
 Allied Consulting Engineers  
 2905-D Queen City Drive  
 Charlotte, NC 28208  
 Phone: (704) 399-3943  
 Email: dbelk@allied-engineers.com

REVISIONS		
No.	Date	Description

Information contained on this drawing and in all digital files associated is authorized for use on the project named herein only and is the property of MISHRA ARCHITECTURE PLLC and may not be reproduced in any manner without express written or verbal permission from authorized individuals. Original drawing is 24"x36" and scales are as indicated. © 2008 MISHRA ARCHITECTURE PLLC



**KEY PLAN**

VTM Hotels, LLC

Home2Suites

2630 Wilde Lake Blvd.  
 Pensacola, FL 32526

Drawing Title  
**Room Layouts Public Areas**

Phase  
**Construction Documents**

Project No.	17-101	Sheet No.	A503
Prepared by	Author	Checked by	Checker
Date	Aug 06, 2018	Review	

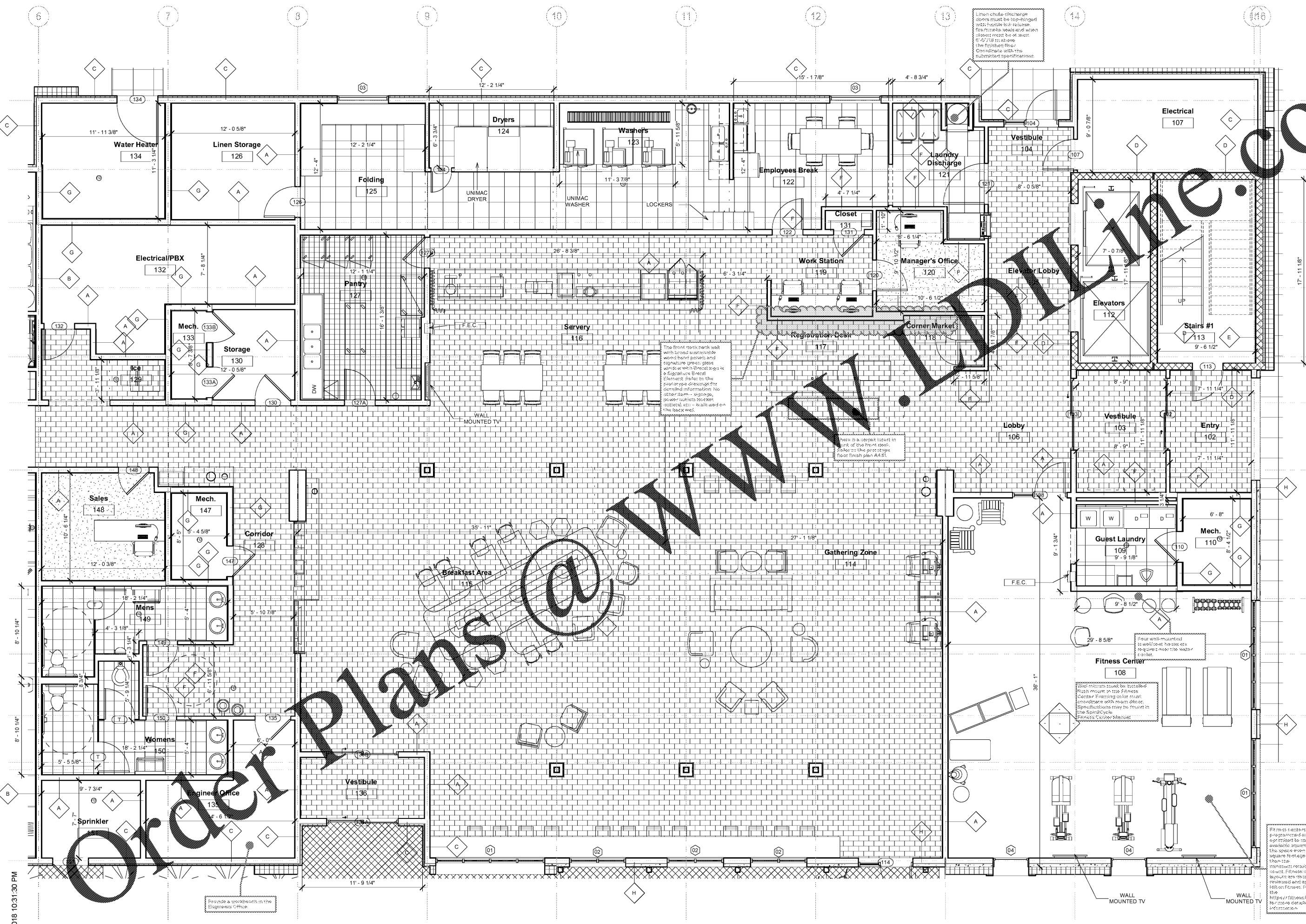

① Level 1 - Public Area  
 1/4" = 1'-0"

8/8/2018 10:31:30 PM