

**CIVIL:**  
 Choctaw Engineering, Inc.  
 112 Truxton Avenue  
 Fort Walton Beach, FL 32547  
 Phone: (850) 862-6211  
 Fax: (850) 863-8059  
 Email: msinen@choctaweng.com

**STRUCTURAL:**  
 Whisnani Engineering Services, LLC  
 122 Nut Tree Court  
 Lexington, SC 29074  
 Phone: (803) 957-4008  
 Email: bill@weslex.com

**MEP:**  
 Allied Consulting Engineers  
 2905-D Queen City Drive  
 Charlotte, NC 28208  
 Phone: (704) 399-3943  
 Email: dbelk@allied-engineers.com

REVISIONS		
No.	Date	Description

Information contained on this drawing and in all digital files associated is authorized for use on the project named herein only and is the property of MISHRA ARCHITECTURE PLLC and may not be reproduced in any manner without express written or verbal permission from authorized individuals. Original drawing is 24"x36" and scales are as indicated. © 2008 MISHRA ARCHITECTURE PLLC

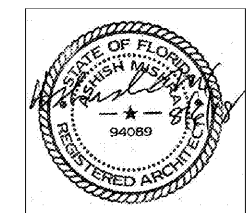

**KEY PLAN**

VTM Hotels, LLC

Home2Suites

2630 Wilde Lake Blvd.  
 Pensacola, FL 32526

Drawing Title  
 2nd Floor Reflected Ceiling Plan

Phase  
 Construction Documents

Project No. 17-101  
 Prepared by Author  
 Checked by Checker  
 Date Aug 06, 2018

Sheet No.  
 A202

Review

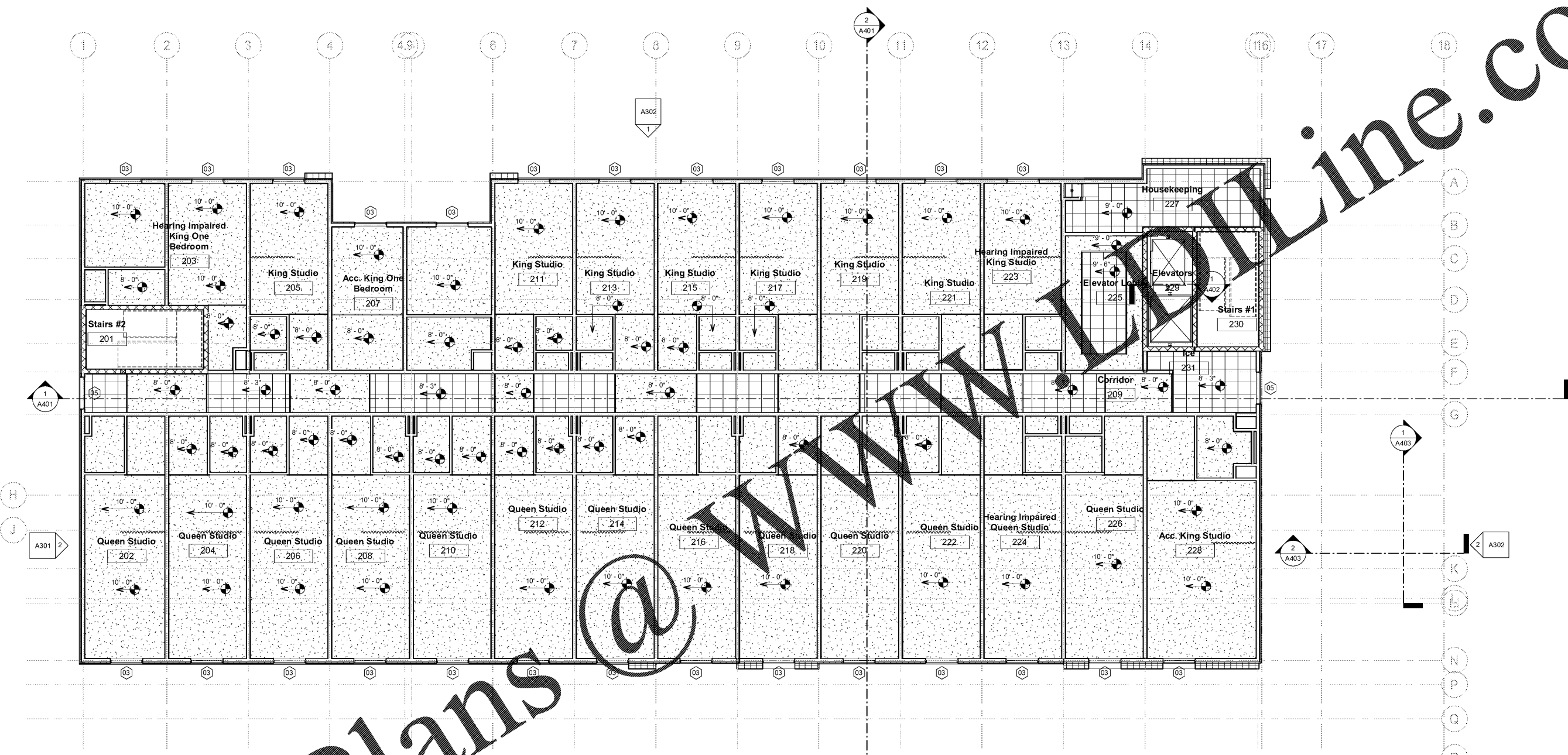

RCP LEGEND	
	GYPSUM BOARD
	2' x 2' ACT CEILING
	T&G WOOD CEILING STAINED

**REFLECTED CEILING PLAN FINISH LEGEND**

1. ALL ACOUSTICAL TILE CEILINGS AND GUEST AREAS TO HAVE A 9/16" GRID. A SMOOTH, ARCHITECTURAL QUALITY CEILING TILE WITH A DROPPED TEGULAR EDGE IS REQUIRED IN THE ACOUSTICAL CEILING AREAS.
2. ALL DRY WALL CEILING AND BULKHEADS IN GUEST AREA MUST HAVE A SMOOTH PAINTED FINISH. NO TEXTURED FINISHES SHALL BE USED IN GUEST AREAS, WITH THE EXCEPTION OF THE STUDIO/SUITE BEDROOM AND LIVING AREAS. AN ORANGE PEEL, LIGHT TEXTURE IS ALLOWED IN THESE AREAS.
3. A.C.T. II REFERS TO MOISTURE RESISTANT ACOUSTICAL CEILING TILES

1 Level 2 RCP  
 1/8" = 1'-0"

Order Plans