

Order Plans @

WWW.LDILLINE.COM

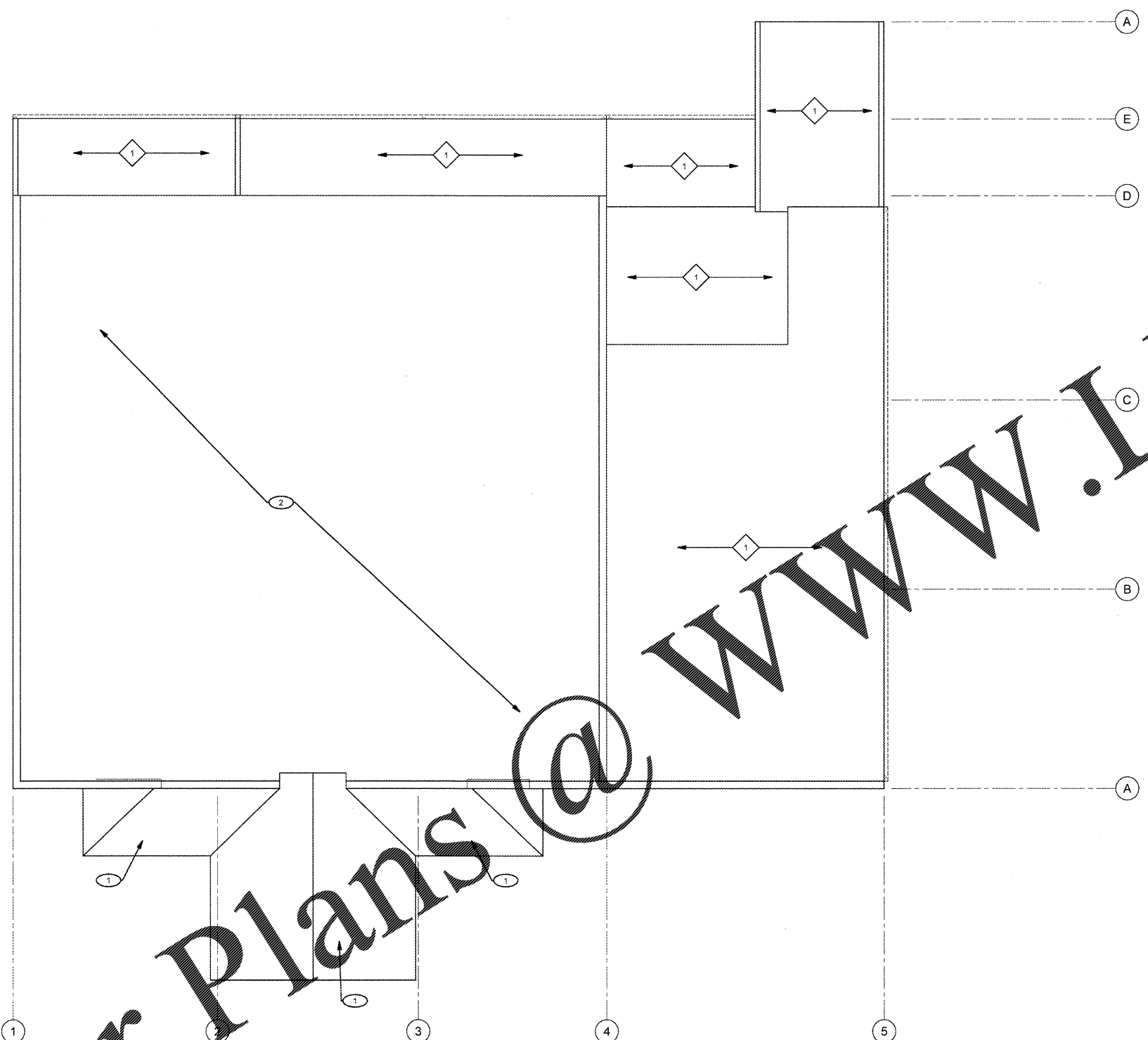

**1** DEMOLITION ROOF PLAN  
**D1.2** SCALE: 1/8" = 1'-0"



**GENERAL DEMOLITION NOTES:**

1. REFER TO ARCHITECTURAL GENERAL SPECIFICATIONS FOR ADDITIONAL INFORMATION.
2. REMOVE ALL EXISTING SITE CONSTRUCTION AND DELETERIOUS MATERIALS UNLESS OTHERWISE NOTED.
3. SEE M.E.P. AND STRUCTURAL DRAWINGS FOR ADDITIONAL DEMOLITION SCOPE AND REQUIREMENTS.
4. SEE ROOF PLAN ON SHEET A1.1 FOR ALL REMODEL / NEW WORK AND SEE ELECTRICAL, STRUCTURAL, MECHANICAL AND PLUMBING DRAWINGS FOR ADDITIONAL INFORMATION.
5. PROTECT EXISTING ROOF MEMBRANE FROM DAMAGE DURING DEMOLITION AND NEW CONSTRUCTION OPERATIONS. IF DAMAGE OCCURS, REPORT TO FIELD REP. THEN MAKE ALL REPAIRS NECESSARY TO PROVIDE A WEATHER TIGHT CONDITION IN SUCH A MANNER AS TO NOT VOID ANY/ ALL WARRANTIES IN EFFECT.
6. REFER TO PLUMBING, STRUCTURAL, MECHANICAL AND ELECTRICAL DRAWINGS FOR ADDITIONAL ROOF PENETRATIONS REQUIRING ROOF FLASHING WORK. ALL ROOF PENETRATIONS FOR MINOR ROOF VENTS AND SIMILAR ITEMS MAY NOT BE INDICATED ON THIS ROOF PLAN. HOWEVER, ALL ROOF FLASHING WORK SHALL BE PROVIDED BY THE ROOFING SUBCONTRACTOR SO AS TO OBTAIN OR MAINTAIN NEW (OR EXISTING) FLASHING WARRANTIES.

**EXISTING TO REMAIN KEYNOTES**

1. ROOF TO REMAIN.

**DEMOLITION KEYNOTES**

1. REMOVE CANOPY AND ALL RELATED MATERIALS. PATCH AS REQUIRED.
2. REMOVE ROOFING UP TO EDGE OF ROOFING. KEEP ROOF FOR NEW ROOF. SEE ROOFING PLAN A1.4.

**CASCO + R5**  
 12 Sumner Drive, Suite 100,  
 St. Louis, MO 63143  
 314.821.1100

REVISIONS:

**O'Reilly AUTO PARTS**  
 CORPORATE OFFICES  
 233 SOUTH PATTERSON  
 SPRINGFIELD, MISSOURI 65802  
 417-862-2674 PHONE

PROJECT:  
**RE-MODEL O'REILLY AUTO PARTS STORE**  
**103 E. GORDON AVE.**  
**GORDONSVILLE, VA 22942**  
**DEMOLITION ROOF PLAN**

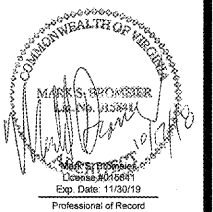

DRAWN: RLJ  
 CHECKED: MGC  
 DATE: 10-17-2018  
 JOB NO.: 118168 (GDV)  
 SHEET:

**D1.2**

COPYRIGHT 2018 - DESIGNS, DRAWINGS AND SPECIFICATIONS ARE INSTRUMENTS OF SERVICE AND ARE THE PROPERTY OF THE DESIGN PROFESSIONAL. REPRODUCTION PROHIBITED WITHOUT THE EXPRESSED WRITTEN CONSENT OF THE DESIGN PROFESSIONAL.