

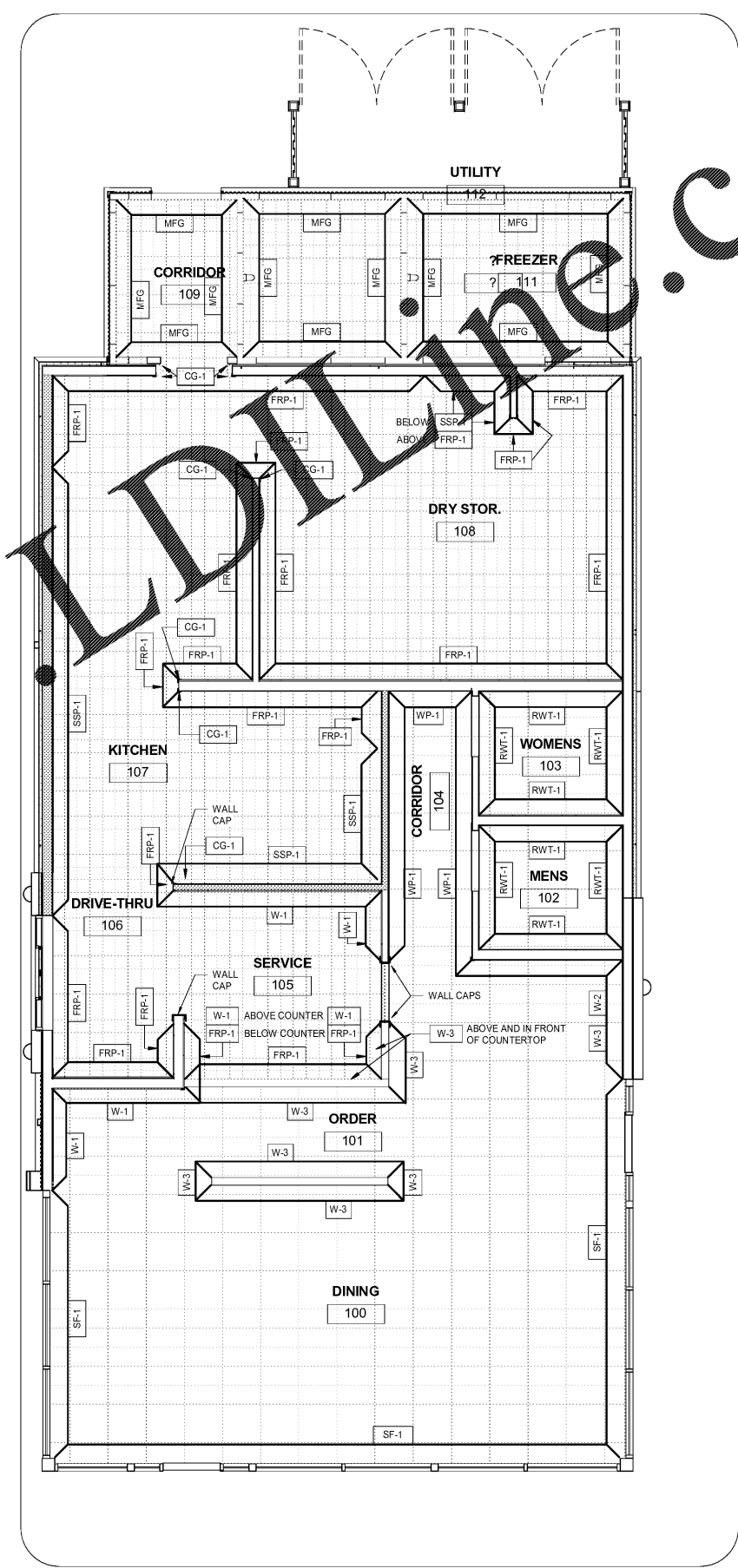

| FINISH SCHEDULE | | | | | | |
|-----------------|------------|-------|-------|---------------|---------|----------------|
| NUMBER | ROOM | FLOOR | BASE | WALL | CEILING | Area |
| 100 | DINING | PT-1 | PTB-1 | SEE PLAN | DAG-1 | 600 SF |
| 101 | ORDER | PT-1 | PTB-1 | SEE PLAN | DAG-1 | 85 SF |
| 102 | MENS | PT-1 | PTB-1 | SEE PLAN | RCP-1 | 49 SF |
| 103 | WOMENS | PT-1 | PTB-1 | SEE PLAN | RCP-1 | 49 SF |
| 104 | CORRIDOR | PT-1 | PTB-1 | SEE PLAN | WP-1 | 61 SF |
| 105 | SERVICE | QT-1 | QTB-1 | SEE PLAN | KAG-1 | 171 SF |
| 106 | DRIVE-THRU | QT-1 | QTB-1 | FRP-1 | KAG-1 | Redundant Room |
| 107 | KITCHEN | QT-1 | QTB-1 | FRP-1 / SSP-1 | KAG-1 | 348 SF |
| 108 | DRY STOR. | QT-1 | QTB-1 | FRP-1 | KAG-1 | 236 SF |
| 109 | CORRIDOR | QT-1 | QTB-1 | MFG | MFG | 89 SF |
| 110 | COOLER | QT-1 | QTB-1 | MFG | MFG | 78 SF |
| 111 | FREEZER | QT-1 | QTB-1 | MFG | MFG | 104 SF |
| 112 | UTILITY | CONC | - | - | - | 47 SF |

| INTERIOR FINISH LEGEND | | |
|--|---|--|
| <p>FLOORING</p> <p>PT-1 PORCELAIN TILE: DAL-TILE: GLAZED PORCELAIN TILE. STYLE: BB12 BAY BRIDGE. COLOR: TREBLE. SIZE: 12" X 24". GROUT: DAL-TILE CUSTOM PRODUCT SANDED GROUT #60 CHARCOAL WITH 1/8" JOINTS LATEX MODIFIED</p> <p>PTB-1 PORCELAIN TILE BASE: DAL-TILE: GLAZED PORCELAIN TILE. STYLE: BB12-S3609TB1P. COLOR: TREBLE. SIZE: 6" X 12". GROUT: DAL-TILE CUSTOM PRODUCT SANDED GROUT #60 CHARCOAL WITH 1/8" JOINTS LATEX MODIFIED</p> <p>QT-1 QUARRY TILE: DAL-TILE: QUARRY TILE. STYLE: QUARRY TEXTURES ABRASIVE. COLOR: 0T01 DIABLO RED. SIZE: 6" X 6". GROUT: DAL-TILE CUSTOM PRODUCT EPOXY CEG-LITE #60 CHARCOAL WITH 3/8" JOINTS</p> <p>QTB-1 QUARRY TILE BASE: DAL-TILE: QUARRY TILE. STYLE: QUARRY TEXTURES Q3665. COLOR: 0T01 DIABLO RED. SIZE: 6" X 6". GROUT: DAL-TILE CUSTOM PRODUCT EPOXY CEG-LITE #60 CHARCOAL WITH 3/8" JOINTS</p> <p>CEILING</p> <p>RCP-1 CEILING: SHERWIN WILLIAMS. PAINT. STYLE: PROMAR 200 ZERO VOC. COLOR: P199 BRILLIANT WHITE. FINISH: SEMI-GLOSS APPLIED WITH 3/4" NAP ROLLER</p> <p>G-1 CEILING TILE: USG INTERIORS. ACQUAFLEX TILE. STYLE: QUARRY. COLOR: WHITE. SIZE: 24" X 24" X 5/8". FINISH: REVERSE EDGE</p> <p>CEILING GRID: USG INTERIORS. EXPOSED GRID. STYLE: 1516. COLOR: WHITE. SIZE: 15/16"</p> <p>KAG-1 CEILING TILE: USG INTERIORS. GYPSUM LAY-IN PANELS. STYLE: VINYL FACED SHEETROCK CLIMAPLUS. COLOR: FLAT WHITE 050. SIZE: 24" X 48" X 1/2"</p> <p>CEILING GRID: USG INTERIORS. DOUBLE-WEB HOT DIPPED GALVANIZED STEEL. STYLE: DOWN ENVIRONMENTAL. COLOR: 2XLA - WHITE. SIZE: 15/16"</p> | <p>WALLS</p> <p>SF-1 STOREFRONT: YKK AP: ALUMINUM STOREFRONT. STYLE: MODEL 200. COLOR: YSIN CLEAR. FINISH: CLEAR ANODIZED PLUS</p> <p>W-1 WALL COVERING: FORMICA. LAMINATED WALL PANELS. STYLE: FORMICA 7737-58. COLOR: NATURAL CHERRY. FINISH: HORIZONTAL GRAIN PANEL. EDGE/TRIM PIECES ARE BRUSHED ALUMINUM FINISH</p> <p>W-2 WALL COVERING: SHERWIN WILLIAMS. PAINT. STYLE: DURATION HOME INTERIOR. COLOR: SW6868 REAL RED. FINISH: SEMI-GLOSS APPLIED WITH 3/4" NAP ROLLER</p> <p>W-3 WALL COVERING: MBL: PDB CORRUGATED GALVANIZED SIDING. STYLE: SIGNATURE-300. COLOR: SLATE GRAY. FINISH: FACTORY FINISH</p> <p>W-4 WALL COVERING: SHERWIN WILLIAMS. PAINT. STYLE: PROMAR 200 ZERO VOC. COLOR: P199 BRILLIANT WHITE. FINISH: SEMI-GLOSS APPLIED WITH 3/4" NAP ROLLER</p> <p>WP-1 WALL COVERING: WALLPAPER. STYLE: SPECIAL GRAPHICS. COLOR: SPECIAL GRAPHICS</p> <p>RWT-1 WALL TILE: DAL-TILE: PORCELAIN TILE. STYLE: EGYPTIAN BEIGE. COLOR: CSS0. SIZE: 12" X 12". GROUT: DAL-TILE CUSTOM PRODUCT POLYBLEND SANDED #60 CHARCOAL</p> <p>RAT-1 WALL TILE: DAL-TILE: GLASS TILE. STYLE: ISIS GLASS TILE. COLOR: BRICK DUST. SIZE: 1" X 1". GROUT: DAL-TILE CUSTOM PRODUCT POLYBLEND SANDED #60 CHARCOAL</p> <p>FRP-1 WALL COVERING: MARLITE. FRP. COLOR: P199 BRILLIANT WHITE. FINISH: PEBBLED FINISH</p> <p>SSP-1 WALL COVERING: 22 G. STAINLESS STEEL WALL PANEL. ABOVE WITH CONSTRUCTION ADHESIVE</p> <p>CG-1 CORNER GUARDS: STAINLESS STEEL FINISH</p> <p>DOORS</p> <p>D-1 DOOR FRAME: REFER TO DOOR SCHEDULE. MARLITE. PREHUNG. STYLE: 500 SERIES. COLOR: ALUMINUM. FINISH: SATIN FINISH</p> <p>DOOR: REFER TO DOOR SCHEDULE. FORMICA. LAMINATE. STYLE: SPECTRUM RED 845-58. COLOR: SPECTRUM RED. FINISH: GLOSS</p> <p>DOOR HARDWARE: REFER TO DOOR SCHEDULE. FINISH TO BE SATIN NICKEL</p> <p>KD-1 KITCHEN GATE: REFER TO DOOR SCHEDULE. ELIASON. COLOR: P-11 PLUS GRAY</p> | <p>ACCESSORIES</p> <p>SS-1 COUNTERTOP: STARON. SOLID SURFACE. COLOR: ASPEN PEPPER AP640. FINISH: EASE EDGES</p> <p>TT-1 COUNTERTOP: WILSON ART. LAMINATE. STYLE: CALCUTTA MARBLE. COLOR: 4000</p> <p>EDGES: SERIES S900. J.O.E.D. STYLE: SHERWIN WILLIAMS. COLOR: ALUMINUM</p> <p>BASE: SHERWIN WILLIAMS. PAINT. STYLE: CHROME. COLOR: 0008-50. COLOR: SILVER. FINISH: WITH 1/4" ADJUSTABLE LEVELERS</p> <p>CHAIR FRAME: PLYWOOD. CHAIR FRAME. COLOR: SILVER</p> <p>CHAIR SEAT: WILSON. VINYL CHAIR SEAT. STYLE: SCOUT. COLOR: RED SC053 FIRE</p> <p>BB-1 BOOTH FRAME: FULLERTON</p> <p>VINYL BACK PAD: STINSON. VINYL PAD. STYLE: SCOUT. COLOR: RED SC053 FIRE</p> <p>FIBERGLASS SEAT: OBSIDIAN. FIBERGLASS SEAT. COLOR: BLACK</p> <p>LEGS: 6" ADJUSTABLE STAINLESS STEEL</p> <p>TC-1 TRASH CONTAINER: NORWOOD STRT-DT</p> <p>TOP: STARON. SOLID SURFACE. STYLE: SAMSUNG TEMPEST FR148. COLOR: RADIANCE (SHIMMER). FINISH: TRASH OPENING OVAL CUT</p> <p>FRONT AND SIDES: FORMICA. LAMINATE. STYLE: FORMICA 7737-58. COLOR: NATURAL CHERRY</p> <p>EDGES: OUTWATER. T-MOLD. COLOR: SILVER</p> <p>FRAME: SHERWIN WILLIAMS. PAINT. COLOR: BLACK</p> <p>LTG-1 LIGHTING: ELK. GLASS LED. STYLE: ELK502-1FR-LED 13.5 WATT 800 LUMENS. COLOR: RED / SATIN NICKEL. SIZE: 5" W X 12" H. FINISH: 6-8" FROM FINISH FLOOR TO BOTTOM OF PENDANT</p> <p>OTHER ABBREVIATIONS</p> <p>CONC CONCRETE</p> <p>MFG MANUFACTURER</p> <p>ALL INTERIOR FINISHES MUST MEET THE REQUIREMENTS OF TABLE 903.9 OF THE IBC. INTERIOR WALLS AND CEILING FINISHES SHALL BE INSTALLED IN ACCORDANCE WITH THE CURRENT APPLICABLE CODES.</p> |



Order Plans

#KNX004
KNOXVILLE, TN



2815 NORTH BROADWAY NE
KNOXVILLE, TENNESSEE 37917
KNOX COUNTY, TENNESSEE

| Revisions | | |
|-----------|------|-------------|
| # | Date | Description |
| | | |

Project Number: 18001
Issued for: CONSTRUCTION
Issue Date: 02/15/18

DRAWING TITLE
**FINISH PLAN,
SCHEDULE AND
DETAILS**

SHEET NUMBER
A751

1 FINISH FLOOR PLAN
SCALE: 1/4" = 1'-0"