

GENERAL NOTES

- USE APPROPRIATE TRANSITION STRIP AT ALL CHANGES IN FLOOR LEVEL, TYP. - SUBMIT SAMPLES TO DESIGNER FOR APPROVAL.
- REFER TO FINISH SCHEDULE FOR FLOORING ASSIGNMENTS IN AREAS NOT SPECIFIED ON FLOOR PATTERN PLANS.
- SEE 2/A611 FOR TYPICAL FLOOR TILE LAYOUT AT FLOOR DRAINS - SEE FINISH SCHEDULE FOR MORE INFO.

FLOOR PATTERN LEGEND

CARPET	PORCELAIN TILE	LUXURY VINYL TILE
CPT-1 TANDUS CENTIVA - COLORMAP 11130 COLOR: SPACE X 42810 SIZE: 24"x24"	PT-1 DAL TILE - VOLUME 1.0 COLOR: AMPLIFY BLACK VL70 SIZE: 6"x6"	LVT-1 CENTIVA - MODERN STONE CMS 0616-QU COLOR: COSTA SIZE: 18"x18"
CPT-2 BENTLEY MILLS - TRESPASS 8TE200AARK COLOR: SUNKEN CITY 886300 SIZE: 18"x36"	PT-2 DAL TILE - VOLUME 1.0 COLOR: AMPLIFY BLACK VL70 SIZE: 12"x12"	LVT-2 CENTIVA - MODERN STONE CMS 0620-QU COLOR: NIKO SIZE: 18"x18"
CPT-3 BENTLEY MILLS - BURNISH 4BR180220K COLOR: MONO LAKE 402923 SIZE: 24"x24"	PT-4 DAL TILE - PORT COLOR: ASH GREY SIZE: 24"x24"	LVT-3 CENTIVA - MODERN STONE CMS 0620-QU COLOR: NIKO SIZE: 18"x18"
CPT-4 TANDUS CENTIVA - 2NDPOWER 0407 COLOR: BALI BLUE 17616 SIZE: 24"x24"	PT-5 DAL TILE - FABRIC ART STYLE: MODERN/NEAR COLOR: DARK GRAY ML64 SIZE: 12"x24"	LVT-4 CENTIVA - MODERN STONE CMS 0620-QU COLOR: NIKO SIZE: 18"x18"
CPT-5 SHAW CONTRACT - GLITCH 5T12 COLOR: INTERRUPT 26505 SIZE: 9'x36"	PT-6 DAL TILE - FABRIC ART STYLE: MODERN/NEAR COLOR: LIGHT STEEL PRISM MK73 SIZE: 12"x24"	LVT-5 SHANNON SPECIALTY FLOORS - TUFSTUF STYLE & COLOR: GLAMOROUS TA20327 - JET SET SIZE: 18"x18"
CPT-6 SHAW CONTRACT - COLOR FLOORS 5T112 COLOR: INTERRUPT 26505 SIZE: 9'x36"		LVT-6 CENTIVA - SUBSTRATE CSU 0953-QU COLOR: ECHO SIZE: 18"x18"
CPT-7 SHAW CONTRACT - COLOR FLOORS 5T112 COLOR: INTERRUPT 26505 SIZE: 9'x36"		LVT-7 SHANNON SPECIALTY FLOORS - TUFSTUF STYLE & COLOR: GLAMOROUS TA20327 - JET SET SIZE: 18"x18"
CPT-8 SHAW CONTRACT - COLOR FLOORS 5T112 COLOR: INTERRUPT 26505 SIZE: 9'x36"		LVT-8 CENTIVA - CUSTOM COLOR BEAM XLS1249 QU-PCBE10011 COLOR: PEACOCK SIZE: 9'x36"
CPT-9 SHAW CONTRACT - COLOR FLOORS 5T112 COLOR: INTERRUPT 26505 SIZE: 9'x36"		LVT-9 CENTIVA - CUSTOM COLOR BEAM XLS1249 QU-PCBE10011 COLOR: NEW GREEN SIZE: 9'x36"
CPT-10 MAINTON COMMERCIAL - FORCE COLOR: SLIDE 34368 SIZE: 18"x36"		LVT-10 MOHANK INDUSTRIES - SOLID STATEMENTS C0081 COLOR: DATA 979 SIZE: 24"x24"
		LVT-11 CENTIVA - BROADCLOTH CBC 0991-P COLOR: ALLUM SIZE: 36"x36"
		LVT-12 CENTIVA - CUSTOM 1'S & 1'S - XLS1242 QU-PCDL10012 COLOR: BLUE/GREEN/WHITE SIZE: 18"x18"

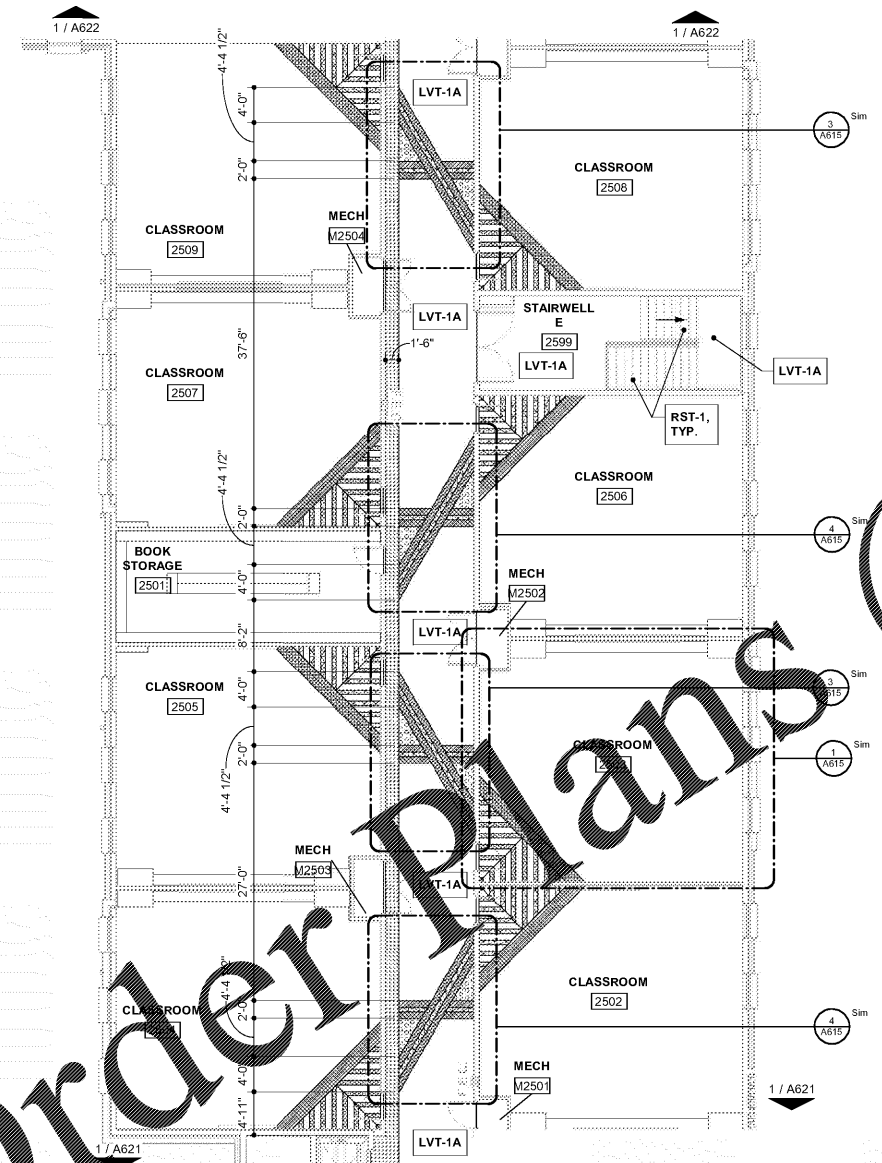

↑
② ENLARGED SECOND FLOOR PATTERN PLAN - AREA E
1/8" = 1'-0"

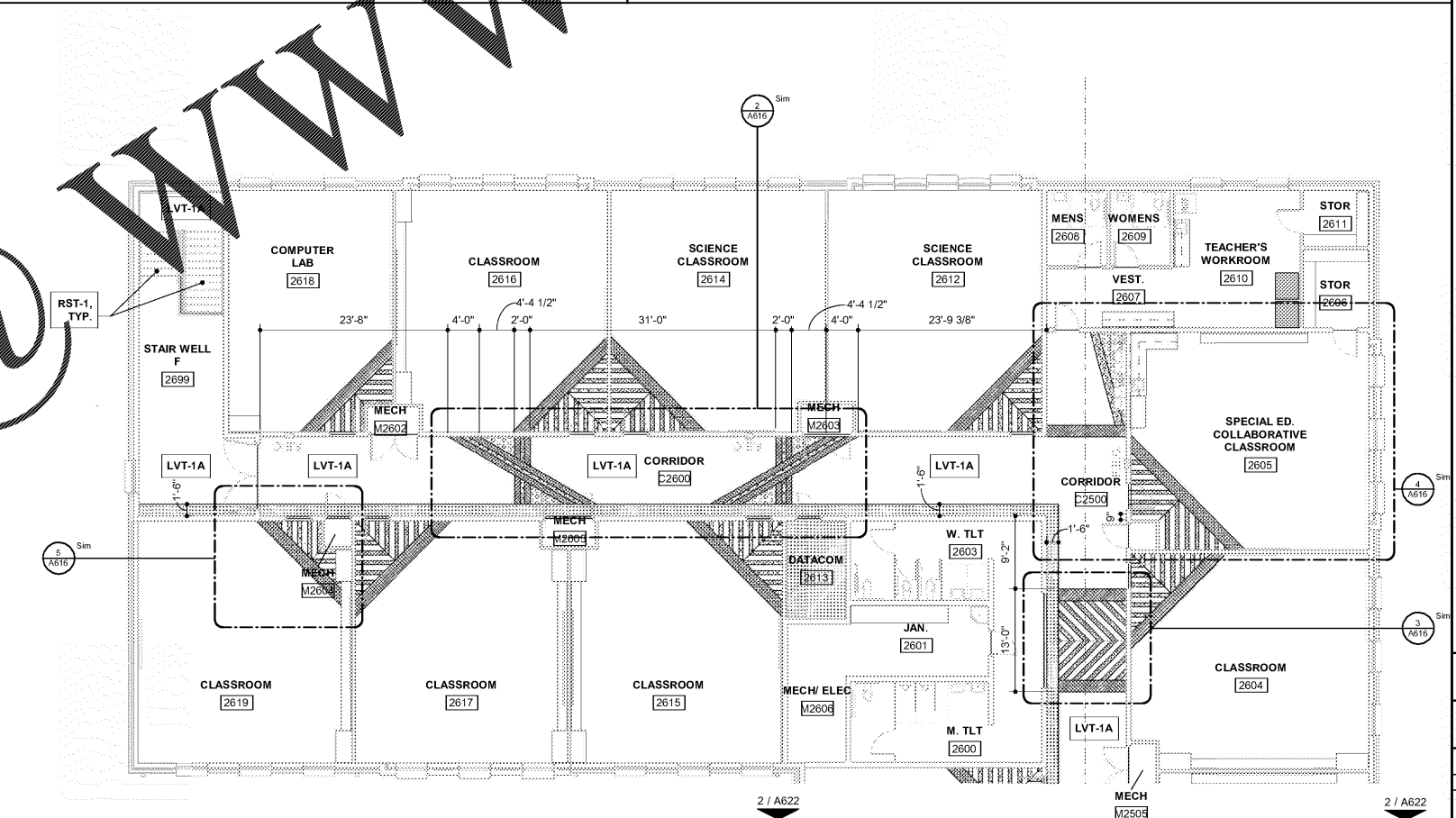

↑
① ENLARGED SECOND FLOOR PATTERN PLAN - AREA F
1/8" = 1'-0"

NORTHPORT SCHOOL
 TUSCALOOSA COUNTY BOARD OF EDUCATION
 NORTHPORT, ALABAMA

CONSTRUCTION DOCUMENTS

DATE: 11-16-18
PROJ NO: 17-072

REVISIONS

#	DESC	DATE

ENLARGED SECOND FLOOR PATTERN PLAN - AREA E&F

A622



Copyright Ward Scott Architecture, Inc. All Rights Reserved
 11/19/2018 2:07:56 PM
 C:\Users\cbkerr\Documents\Revit\LOCAL17-072_Northport Middle School_A18_CENTRAL_cbkerr.rvt

Order Plans @ www.ward-scott.com