

MINIMUM REQUIRED VISIBILITY STANDARD FOR MAKING PRINTS & COPIES

0%
17%
34%
51%
68%
85%
100%

WHITAKER ROAD (60' PUBLIC R/W)

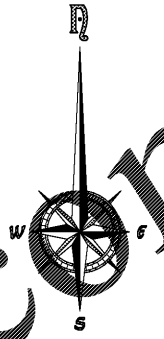
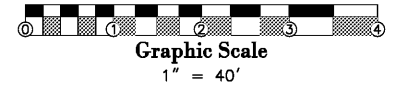

- LEGEND:**
- [Symbol] = PROPOSED BUILDINGS
 - [Symbol] = PROPOSED EDGE OF PAVEMENT
 - [Symbol] = PROPOSED CONCRETE
 - L1 0:1 = REFERENCE TO LINE & CURVE TABLES
 - STA X = REFERENCE TO COORDINATE TABLES
 - [Symbol] = PROPOSED CENTERLINES
 - [Symbol] = EASEMENTS
 - [Symbol] = BUFFERS
 - [Symbol] = CROSS ACCESS EASEMENTS
 - [Symbol] = NUMBER OF PARKING SPACES
 - [Symbol] = MEDIUM DUTY PAVEMENT
 - [Symbol] = LIGHT POLE
 - [Symbol] = BUILDING SETBACK LINE
 - [Symbol] = PRESERVE BOUNDARY
 - [Symbol] = NATURAL PRESERVE AREA

SIGN LEGEND:

- 1 [STOP SIGN] 30" STOP (R1-1)
- 2 [HANDICAP SIGN] HANDI-CAP SIGN (FTP 25)

PARKING SUMMARY:

REQUIRED PARKING	
NUMBER OF BEDS	= 96
MEMORY CARE HOME	= 2/5 BEDS
TOTAL SPACES REQUIRED	= 39
EMPLOYEES	= 19
TOTAL SPACES PROVIDED	= 58 SPACES
HANDICAP SPACES REQUIRED	= 3
HANDICAP SPACES PROVIDED	= 4

KEY NOTES:

- 1 STOP SIGN: SEE SIGN LEGEND
- 2 HANDI-CAP SIGN: SEE SIGN LEGEND
- 3 CONCRETE DUMPSTER PAD: REFER TO DETAIL
- 4 CONCRETE CURB: REFER TO DETAIL, TYPE "D" CURB
- 5 ASPHALT PAVEMENT: REFER TO DETAIL
- 6 HANDICAP PARKING SYMBOL: REFER TO DETAIL
- 7 HANDICAP ACCESS UNLOADING ZONE: SLOPE 2% MAX. EACH WAY AND STRIP ADA COMPLIANT.
- 8 REFUSE ENCLOSURE: REFER TO DETAIL
- 9 CONCRETE WHEEL STOP: TO SIT LEVEL WITH PAVING. REFER TO DETAIL, (16 TOTAL)
- 10 STRIPING: PROVIDE 4" WIDE PARKING LOT STRIPING AS SHOWN. USE HIGHWAY MARKING PAINT - WHITE (2 COATS).
- 11 DIRECTIONAL ARROW/STRIPING: PER FDOT INDEX.
- 12 CONCRETE SIDEWALK: INSTALL CONCRETE SIDEWALK PER FDOT INDEX 310; CONTRACTOR TO CONNECT TO EXISTING SIDEWALK.
- 13 CROSSWALK PAVEMENT MARKING: (SEE FDOT INDEX 17346) SLOPE 2% MAX. EACH WAY AND STRIP ADA COMPLIANT.
- 14 PRIVACY FENCE: REFER TO ARCHITECTURAL PLAN DETAILS
- 15 STOP BAR: 24" WIDE THERMOPLASTIC

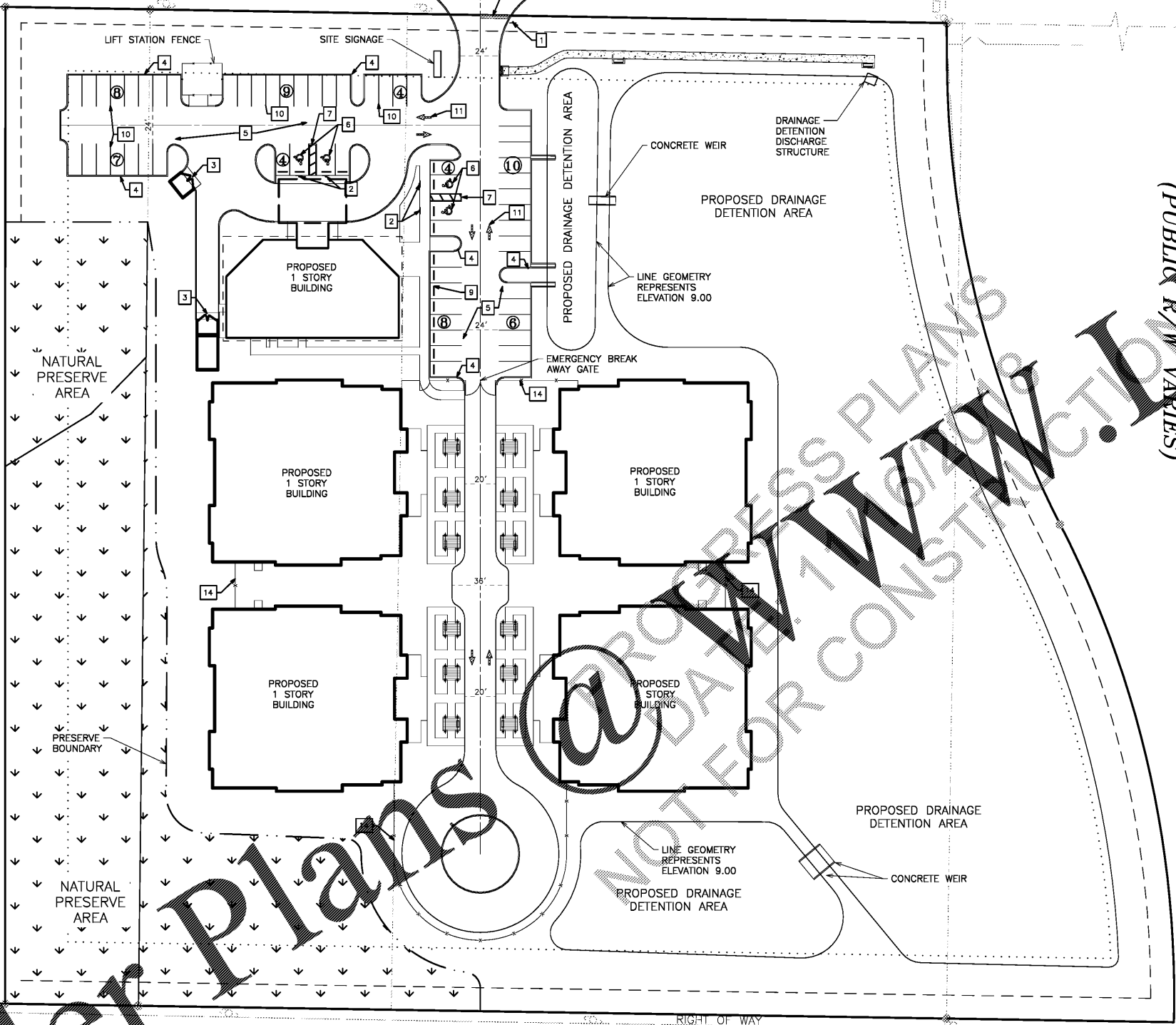

ROYAL WOOD BLVD (60' R/W)

**MEMORY CARE COTTAGES
WHITAKER ROAD
COLLIER COUNTY, FLORIDA**

SCALE: 1" = 40'	DATE: 12.15.2017	DATE:
CHECKED: [Signature]	DATE:	DATE:
DRAWN: [Signature]	DATE:	DATE:
FIELD BOOK: N/A	DATE:	DATE:
PAGE: #/	DATE:	DATE:
DATUM: N/A	DATE:	DATE:
FILE NO.: 403.01.000	DATE:	DATE:
JOB NO.: 403.01	DATE:	DATE:
SHEET: C-05 OF 21	DATE:	DATE:

Pigeon - Roberts & Associates, LLC
925 S.E. 17th Street
Ocala, Florida 34471
(352) 861-7788 voice
(352) 861-7708 fax

**CIVIL ENGINEERS • PLANNERS
SURVEYORS & MAPPERS**

CERTIFICATES OF AUTHORIZATION
ENGINEERING NO. 26357 • SURVEYING & MAPPING LB NO. 7461

File No.
403.01.000

Job No.
403.01

C-05 of 21

PLOTTED: 9/26/2018

Plotted: 9/26/2018 12:35:27 PM - Stephen Caron