

GENERAL NOTES

REFER TO G110 AND G120 FOR PROJECT SPECIFICATIONS AND NOTES

- WHERE ANY PART OF THE EXISTING BUILDING IS CALLED FOR TO BE REMOVED OR NEW CONSTRUCTION IS PERFORMED, THE REMAINING FLOOR, BASE WALLS, AND CEILING SHALL BE PATCHED AND REPAIRED TO CONFORM WITH THE REST OF THE SPACE.
- THE CONTRACTOR IS SOLELY RESPONSIBLE FOR PROVIDING ALL SAFETY MEASURES REQUIRED TO PROTECT THE GENERAL PUBLIC FROM DEMOLITION AND CONSTRUCTION WORK FOR THE DURATION OF THE PROJECT.
- CONTRACTOR SHALL VERIFY DIMENSIONS OF ALL EXISTING CONDITIONS PRIOR TO CONSTRUCTION OR FABRICATION.
- ALIGNING FINISHES OF MATERIAL SHALL TAKE PRECEDENCE OVER DIMENSIONS.
- INTERIOR DOORS SHALL BE INSTALLED 4" FROM HINGE SIDE OF FRAME TO PERPENDICULAR WALL, UNLESS NOTED OTHERWISE.

SHEET SPECIFIC NOTES

NOTE: CONTRACTOR SHALL CONFIRM WITH OWNER ITEMS TO BE REUSED. ALL ITEMS TO BE REMOVED SHALL BE REMOVED AND DISPOSED OF BY THE CONTRACTOR OR STORED AND REUSED BY THE CONTRACTOR PER OWNER'S DIRECTION.

- COORDINATE ALL DEMOLITION WITH OTHER TRADES. REFER TO ENGINEER DRAWINGS FOR FURTHER REQUIREMENTS AND SCOPE OF WORK.
- DURING DEMOLITION, DAMAGE TO WORK NOTED TO THE OWNER. EXTREME CARE SHALL BE TAKEN TO NOT DAMAGE OR DISTURB WORK THAT IS TO REMAIN IN PLACE.
- ANY ELECTRICAL OUTLETS, WIRING, CONDUIT, FIXTURES, DEVICES, PHONE JACKS AND DATA OUTLETS (AND ITEMS OF SIMILAR NATURE) ENCOUNTERED IN EXISTING WORK TO BE DEMOLISHED SHALL BE REMOVED AND DISPOSED OF BY THE CONTRACTOR. REMOVE ELECTRICAL CONDUIT AND FEEDERS BACK TO THE PANEL. CONFIRM ITEMS TO BE SALVAGED FOR REUSE BY THE OWNER.
- ANY PREVIOUSLY ABANDONED WORK ENCOUNTERED IN EXISTING WORK TO BE DEMOLISHED SHALL BE REMOVED AND DISPOSED OF BY THE CONTRACTOR.
- ANY EXISTING MECHANICAL OR ELECTRICAL DEVICES, OR EQUIPMENT AFFECTED BY ANY RENOVATION AND NOT CALLED FOR TO BE REMOVED OR DISCONNECTED, SHALL BE RESTORED AND LEFT IN FULL OPERATING CONDITION.
- THE CONTRACTOR IS RESPONSIBLE FOR THE REMOVAL AND DISPOSAL OF ALL CONSTRUCTION WASTE AND DEBRIS.
- ALL EXISTING FIRE EXTINGUISHERS, IF ANY, SHALL BE REUSED. THE CONTRACTOR SHALL HAVE ALL EXISTING FIRE EXTINGUISHERS INSPECTED AND RECHARGED IF NECESSARY. REFER TO LIFE SAFETY FLOOR PLAN FOR NEW AND EXISTING LOCATIONS.
- REMOVE AND RELOCATE ANY AND ALL WALL MOUNTED ITEMS IN EXISTING SPACES THAT ARE BEING RECONFIGURED.
- ALL DEMOLITION WORK SHALL COMPLY WITH THE REQUIREMENTS OF THE 2013 EDITION OF NFPA 241, STANDARD FOR SAFEGUARDING CONSTRUCTION, ALTERATION, AND DEMOLITION OPERATIONS.
- REFER TO ALL PLANS FOR WORK TO BE BELOW EXISTING CONCRETE SLAB. CUT SLAB AS REQUIRED FOR ALL NEW ITEMS.
- REFER TO NEW PLANS FOR ALL EXISTING AREAS TO RECEIVE NEW WORK. PREPARE EXISTING AREAS TO RECEIVE NEW WORK.
- TEMPORARILY SUPPORT ANY EXISTING LIGHT FIXTURES AND MECHANICAL FIXTURES TO REMAIN IN ALL AREAS RECEIVING NEW CEILING GRID.

ARCHITECT

**cas architecture**

183 N. PERRY  
LAWRENCEVILLE, GA 30046  
WWW.CASARCH.COM

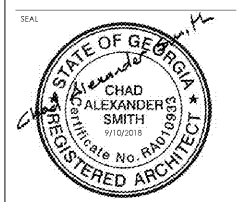

IF SEALED, DO NOT COPY

PROJECT

RENOVATIONS TO THE

**Georgia Department of Community Supervision**

595 Old Norcross Road  
Lawrenceville, Georgia 30045

COPYRIGHT © 2018 CAS ARCHITECTURE, P.C. ALL RIGHTS RESERVED. THIS DOCUMENT AND ANY REPRODUCTIONS, IN WHOLE OR IN PART, ARE INSTRUMENTS OF SERVICE AND ARE THE SOLE PROPERTY AND COPYRIGHT OF CAS ARCHITECTURE, P.C. AND MAY NOT BE REPRODUCED, PUBLISHED, USED OR CONVEYED IN ANY MANNER WITHOUT WRITTEN PERMISSION FROM CAS ARCHITECTURE, P.C. THESE DOCUMENTS HAVE BEEN PREPARED SPECIFICALLY FOR THIS PROJECT. THEY ARE NOT SUITABLE FOR USE ON OTHER PROJECTS OR IN OTHER LOCATIONS.

THIS DOCUMENT WAS CREATED ELECTRONICALLY. THIS MEDIA SHOULD NOT BE CONSIDERED A CERTIFIED DOCUMENT UNLESS IT HAS BEEN PROPERLY SEALED AND ORIGINALLY SIGNED BY A REGISTERED ARCHITECT OF CAS ARCHITECTURE, P.C.

THESE PLANS ARE COMPPLEMENTARY. THEREFORE THE CONTRACTOR SHALL SHEET THE ARCHITECTURAL, STRUCTURAL, MECHANICAL, PLUMBING, AND ELECTRICAL PLANS AND SPECIFICATIONS. WHAT IS REQUIRED BY ANY ONE SHALL BE BINDING AS REQUIRED BY ALL. THE INTENTION OF THE DOCUMENTS IS TO INCLUDE ALL LABOR, MATERIALS, EQUIPMENT AND OTHER ITEMS NECESSARY FOR THE PROPER EXECUTION AND COMPLETION OF THE WORK. THE CONTRACTOR SHALL BE RESPONSIBLE FOR THE COORDINATION OF THE WORK OF ALL TRADES.

NO.	DATE	ISSUANCE/REVISIONS
1	8/24/2018	FOR CONSTRUCTION

SHEET TITLE  
EXISTING/DEMOLITION REFLECTED  
CEILING PLAN

SHEET NUMBER

**A310**

PROJECT	DATE	DRAWN
18104	8/24/2018	KMH
FILE		

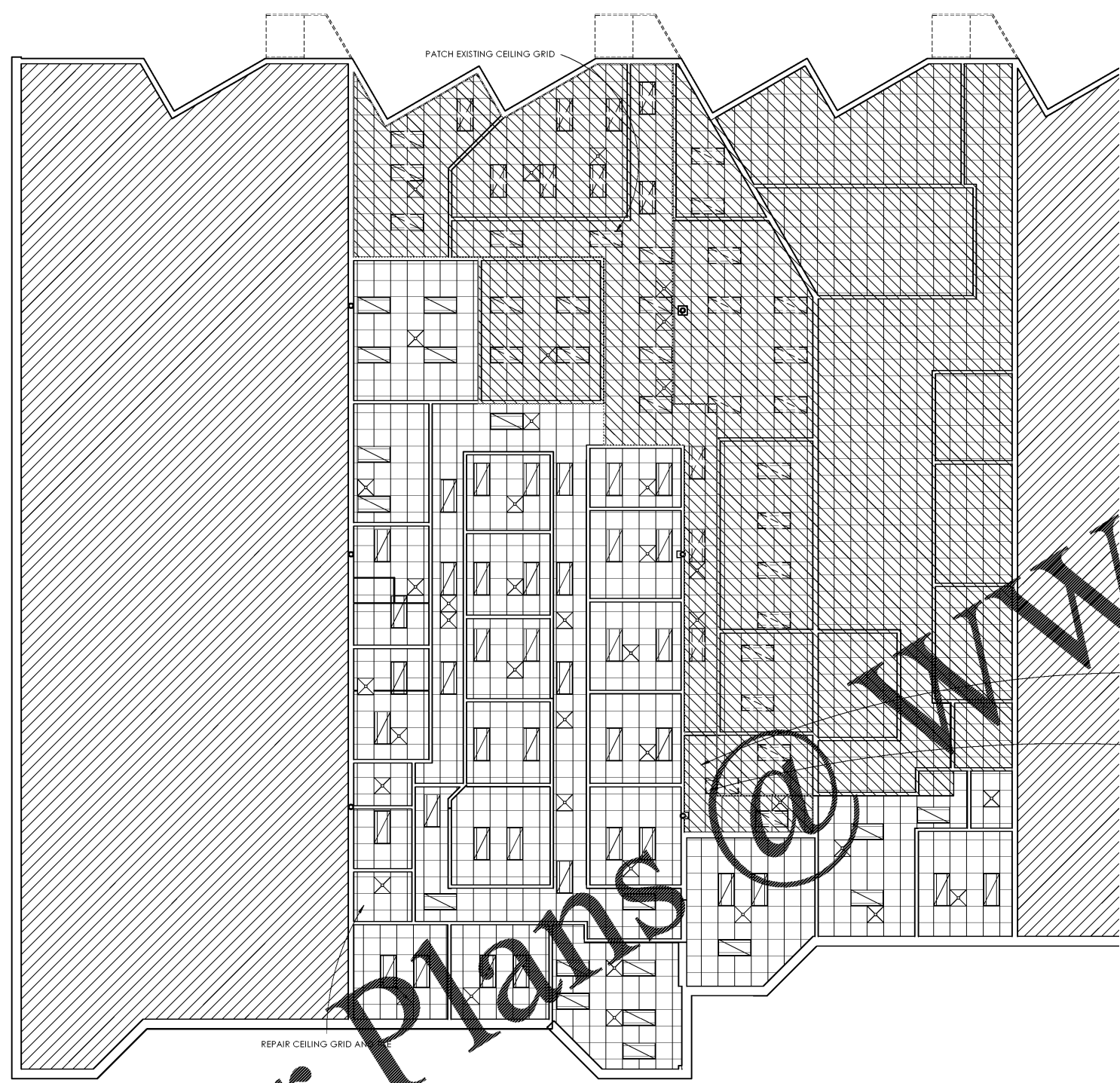

FOR ALL CEILING AREAS REFER TO ELECTRICAL AND MECHANICAL DRAWINGS FOR DEMOLITION OF CEILING GRID AND EXISTING FIXTURES.

DEMO EXISTING CEILING GRID TO RECEIVE NEW LIGHT FIXTURE-REFER TO A320

PATCH EXISTING CEILING GRID

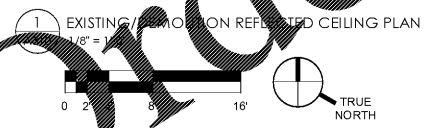

Order Plans