

1 FLOOR PLAN
1/4"=1'-0"

FRAMING SYMBOLS

- (A) 2X4 FRAMING @ 16" O.C.
 - (B) 2X6 FRAMING @ 24" O.C.
 - (C) 2X8 FRAMING @ 24" O.C.
 - (D) 3-5/8" 25 GAUGE STEEL STUDS 24" O.C.
- DOOR NUMBER - SEE SHEET A-17 FOR DETAILS
- 6 A12 - DETAIL NUMBER SHEET NUMBER
- 7 A13 - DETAIL NUMBER SHEET NUMBER
- SECTION DETAIL - ARROW INDICATES DIRECTION OF VIEW
- XXX DENOTES BLOCKING AS REQUIRED

CONSTRUCTION NOTES

- 1 DIMENSIONS ARE SHOWN: 1) EXTERIOR WALLS: FROM INTERIOR FACE OF GYPSUM BOARD TO THE EXTERIOR FACE OF PLYWOOD. 2) INTERIOR WALLS: FROM THE FACE OF FINISH WALL TO THE FACE OF FINISH WALL, U.N.O..
- 2 INSTALL 3'-0" W X 8'-0" H X 18 GA STAINLESS STEEL PANEL BEHIND FRYERS & BATTER STATION, PER A13 ELEVATIONS. SIS SHALL EXTEND 18" BESIDE EQUIPMENT. REFER TO INTERIOR KITCHEN ELEVATIONS AND EQUIPMENT PLAN FOR EXACT LOCATION.
- 3 ALL GYPSUM WALL BOARD BELOW FINISHED CEILING HEIGHT IS TO BE PREPARED FOR PAINTING OR WALLCOVERING AS INDICATED ON INTERIOR ELEVATIONS AND FINISH SCHEDULE. SEE GEN. CONSTR. NOTES FOR DINING AREA.
- 4 GENERAL CONTRACTOR (G.C.) TO PROVIDE 2"x2" FULL HEIGHT CORNER GUARDS ON ALL OUTSIDE CORNERS @ KITCHEN WALLS. SEE DETAILS ON SHEET A2.
- 5 HOOD WALL TO BE CONSTRUCTED WITH 3-5/8" 16 GAUGE (GA) METAL STUDS AT 24" O.C. INSTALL 5/8" MOISTURE RESISTANT TYPE X GYPSUM WALL BOARD ON BOTH WALL SIDES FROM FINISHED FLOOR TO 18" AFF, AND 5/8" TYPE X GYPSUM FROM 18" AFF TO BEYOND CEILING.
- 6 ELECTRIC DRIVE-THRU WINDOW TO BE INSTALLED AT THE LOCATION SHOWN. VERIFY REQUIRED ROUGH-IN AND ELECTRICAL REQUIREMENTS WITH MANUFACTURER BEFORE PROCEEDING.
- 7 THE ARCHITECT AND ENGINEERS OF RECORD SHALL VERIFY ALL ACCESSIBLE APPROACHES AND ENTRANCES TO VERIFY THAT THEY COMPLY WITH ALL APPLICABLE CODES. G.C. TO ENSURE THAT ALL DIRECTIONS AND DIMENSIONS GIVEN ARE STRICTLY ADHERED TO. IF CHANGES ARE MADE THAT CONTRADICT WITH THE DRAWING, OR IF EXISTING FIELD CONDITIONS MAKE THE DRAWINGS NOT APPLICABLE, THE ARCHITECT MUST BE CONTACTED IMMEDIATELY.
- 8 ALL DOORS SHALL BE ABLE TO BE OPENED FROM THE EGRESS SIDE WITHOUT THE USE OF A KEY, SPECIAL KNOWLEDGE OR EFFORT, AND COMPLY WITH ALL CODES. MANUALLY OPERATED FLUSH BOLTS OR SURFACE BOLTS SHALL NOT BE USED.

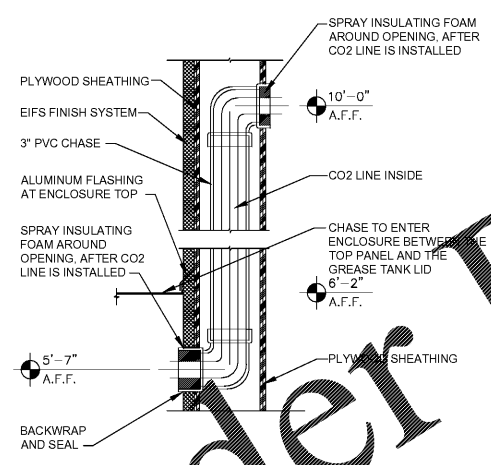

2 TYP. CO2 LINE PENETRATION
1/12"=1'-0"

SPECIFICATIONS

DIVISION 9: FINISHES
SECTION 09 29 00
GYPSUM BOARD

- Part 1 - GENERAL
- 1.1 SECTION INCLUDES
 - A. STANDARD GYPSUM BOARD
 - B. FIRE-RESISTANCE RATED GYPSUM BOARD
 - C. FIRE RESISTANCE RATED - MOISTURE RESISTANT GYPSUM BOARD
- Part 2 - SCOPE
- 1.1 SCOPE: FURNISH AND INSTALL GYPSUM WALL BOARD AS A SUBSTRATE FOR THE INTERIOR FINISH MATERIALS ON INTERIOR WALLS AS SHOWN ON DRAWINGS. FURNISH AND INSTALL GYPSUM WALL BOARD SUSPENDED CEILING WITH HANGERS AND SUPPORTS.
 - 1.2 MATERIALS: MATERIAL NAMES ARE BASED ON A NATIONAL GYPSUM GOLD BOARD STA-SMOOTH EDGE SYSTEM BY U.S. GYPSUM.
- WALLS EXCEPT WHERE NOTED: 1/2" STA-SMOOTH GYPSUM WALL BOARD.
- WALLS WHERE NOTED: 1/2" THINK TAPERED EDGE MOISTURE RESISTANT (MR) GYPSUM WALL BOARD.
- DROPPED CEILING WHERE NOTED: 1/2" STA-SMOOTH GYPSUM WALL BOARD.
- FIRE RATED WHERE NOTED: FIRE RATED GYPSUM BOARD.
2. FASTENERS:
- A. USE #4 1-5/8" LONG ANNUAL RING SHANK NAILS MEETING THE REQUIREMENTS OF ASTM C-380.
 - B. 1-1/2" LONG TYPE-W DRYWALL SCREWS TO WOOD STUDS.
 - C. 1-1/4" LONG TYPE-S DRYWALL SCREWS TO INTERIOR METAL STUDS.
 - D. 1-1/4" LONG TYPE-S12 CORROSION RESISTANT SCREWS FOR EXTERIOR GYPSUM SHEATHING TO METAL STUDS.
- JOINT TREATMENT COMPOUND SHALL BE READY MIXED. JOINT TAPE SHALL BE CROSS FIBERED, PERFORATED, TAPER EDGED. CORNER BEADS SHALL BE GALVANIZED STEEL ROLL-FORMED SHAPED CHANNELS.
- F. FRAMES AND SUPPORTS: 2X4 WOOD FRAMING. SUBSTITUTION: FOR STEEL TRUSS BUILDINGS 1-1/2" CHANGING CHANNELS, 3/4" FURRING CHANNELS, 8 GAUGE HANGER WIRES, 16 GAGE TIE WIRES, AND 1" TYPE S SCREWS.
- PERFORMANCE
1. INSTALLATION
 - A. CUTTING WALLBOARD: GYPSUM WALLBOARD SHALL BE CUT BY SCORING AND BREAKING, OR BY SAWING, WORKING FROM THE FACE SIDE. WHERE BOARD MEETS PROJECTING SURFACES, IT SHALL BE SCRIBED NEATLY.
 - B. INSTALLING WALLBOARD: GYPSUM WALLBOARD SHALL BE APPLIED AT RIGHT ANGLES TO FRAMING MEMBERS. BOARDS OF MAXIMUM PRACTICAL LENGTH SHALL BE USED SO THAT AN ABSOLUTE MINIMUM NUMBER OF END JOINTS OCCUR. WALLBOARD JOINTS AT OPENINGS SHALL BE LOCATED SO THAT NO END JOINT SHALL ALIGN WITH EDGES OF OPENINGS. END JOINTS SHALL BE STAGGERED.
 - C. FASTENING WALLBOARD: ATTACH WITH SCREWS OR NAILS SPACED APPROXIMATELY 8" O.C. THE NAILS SHALL BE DRIVEN HOME WITH THE HEAD SLIGHTLY BELOW THE SURFACE OF THE BOARD IN A DIMPLE FORMED BY THE DRIVING TOOL.
 - D. FASTENING EXTERIOR GYPSUM SHEATHING: ATTACH TO METAL STUDS WITH SCREWS @ 12" O.C. WITH HEAD FLUSH WITH SURFACE.
 - E. JOINTS FINISHING: JOINT COMPOUND, QUICK-TREAT, AND TOPPING COMPOUND SHALL BE APPLIED IN ACCORDANCE WITH PRINTED INSTRUCTIONS CONTAINED IN THE PACKAGE. A UNIFORMLY THIN LAYER OF JOINT COMPOUND SHALL BE APPLIED OVER THE JOINT UNDER THE TAPE TO PROVIDE PROPER BOND. CEILING AND WALL ANGLES AND INSIDE CORNER ANGLES SHALL BE REINFORCED WITH THE TAPE FOLDED TO CONFORM TO THE ANGLE AND EMBEDDED IN THE COMPOUND. AFTER THE COMPOUND IS THOROUGHLY DRY, APPROXIMATELY TWENTY FOUR (24) HOURS FOR REGULAR COMPOUND, 2-1/2 HOURS FOR QUICK TREAT, THE TAPE SHALL BE COVERED WITH A COAT OF JOINT COMPOUND OR TOPPING COMPOUND SPREAD OVER THE TAPE APPROXIMATELY 3" ON EACH SIDE OF TAPE, AND FEATHERED OUT AT THE EDGE. AFTER THOROUGHLY DRY, APPLY ANOTHER COAT OVER JOINTS. THIS COAT SHALL BE SMOOTH AND THE EDGES FEATHERED APPROXIMATELY 3" BEYOND THE PRECEDING COAT. ALLOW EACH APPLICATION OF COMPOUND TO JOINTS AND NAIL HEADS TO DRY, THEN SAND IF NECESSARY. ALL WALLBOARD AND TREATED AREAS SHALL BE SMOOTH AND READY FOR PAINTING OR WALLCOVERING.

GENERAL CONSTRUCTION NOTES

- GYPSUM BOARD / EXTERIOR SHEATHING NOTES:
1. EXTERIOR SHEATHING SHALL BE 1/2" EXTERIOR ORIENTED STRAND BOARD NAILED IN ACCORDANCE WITH THE STRUCTURAL NAILING SCHEDULE. REFER TO SHEETS S-4.
 2. NOT USED.
 3. GYPSUM BOARD SHALL BE TYPE "MOISTURE RESISTANT" IN ALL AREAS TO RECEIVE WALL TILE OR FRP PANELS.
 4. ALL WALLS TO RECEIVE 1/2" MOISTURE RESISTANT GYPSUM WALL BOARD INSTALLED TO 18" AFF UNO.
- INSULATION NOTES:
1. ALL EXTERIOR WALLS TO RECEIVE FIBERGLASS BATT INSULATION TO MATCH DEPTH OF WALL CAVITY.
- KITCHEN WALL NOTES:
1. PROVIDE 1/2" DUROCK FROM 1'-6" AFF TO 9'-6" AFF IN ALL KITCHEN WALLS.
 2. PROVIDE 1/2" DUROCK AT INTERIOR TOILET ROOM WALLS.
- DINING AREA NOTES:
1. PLASTIC LAMINATE TO ADHERE TO 1/2" PLYWOOD. PLYWOOD FROM FINISH FLOOR TO 2'-10" AFF.
 2. VINYL WALL COVERING ON 1/2" GYPSUM BOARD.
- BLOCKING NOTES:
1. "xxxxxxx" INDICATES BLOCKING REQUIRED IN WALL FOR PLUMBING LINES AND RESTROOM ACCESSORIES. BLOCKING SHALL BE FIRE RETARDANT WHERE REQUIRED BY CODE.
 2. CONTRACTOR TO VERIFY REQUIREMENTS WITH LOCAL BUILDING OFFICIALS PRIOR TO BIDDING. CONTRACTOR IS RESPONSIBLE FOR OBTAINING MANUFACTURERS' CUT SHEETS AND LOCATING BLOCKING AS REQUIRED. THIS INCLUDES KITCHEN EQUIPMENT AND ITEMS FURNISHED AND INSTALLED BY OTHERS.
- FRAMING NOTES:
1. CONTRACTOR MAY SUBSTITUTE METAL STUDS FOR INTERIOR WALL AND SOFFIT FRAMING. WHERE USED, METAL FRAMMING TO BE 25 GA. UNLESS NOTED OTHERWISE (U.N.O.).
 2. REFER TO FRAMING NOTES FOR WALL SECTIONS.
 3. ALL INTERIOR WOOD FRAMING TO BE #2 SPRUCE, FIR OR WHITE PINE. WHERE REQUIRED BY CODE, FRAMING SHALL BE #2 FIRE RETARDANT YELLOW PINE. CONTRACTOR TO VERIFY REQUIREMENTS WITH LOCAL BUILDING OFFICIALS PRIOR TO BIDDING.
 4. ALL WOOD IN CONTACT WITH THE SLAB MUST BE PRESSURE TREATED.
 5. ALL INTERIOR WALLS TO BE FRAMED TO UNDERSIDE OF TRUSS U.N.O..
 6. ALL INTERIOR WALLS THAT ARE NOT SHEAR WALLS TO BE ANCHORED W/ 5/8" DIA. EXPANSION ANCHORS AT 6'-0" O.C. SEE STRUCTURAL DWGS. FOR SHEAR WALL ANCHORS.

POPEYES
400 PERIMETER CENTER TERRACE
SUITE 1000
ATLANTA, GA 30348
404-455-4650

henderson huckestein architects, PC
10.30.18
architecture · planning · interior design
2124 Morris Avenue Birmingham, AL 35203
Phone (205) 322-1751
Fax (205) 322-1778
email info@hhplaha.com
www.hhplaha.com

DRAWN BY: DS
CHECKED BY: MRW, EH
DATE: 10.30.2018
HHHA PROJECT #18064.14

PREMIER CAJUN KINGS, LLC - POPEYES
Near 431 Main St.
Shofter, AL 36075
LOUISIANA KITCHEN PLK DESIGN STANDARDS
PLK1 1846-DL PROTOTYPE 46 SEATS / DUAL-LINE PRODUCTION

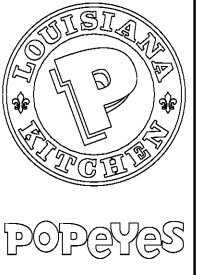

REVISIONS:
PERMIT/BD SET 10.30.18

A1
FLOOR PLAN
DATE: 10/18/2018
CHECKED: MW