

| Luminaire Schedule | | | |
|--------------------|-------|----------------|--|
| Symbol | Label | Catalog Number | Description |
| | A | EWMLD280-3 | EW Area Light with Type 3 Optics |
| | B | EWMLD280-4 | EW Area Light with Type 4 Optics |
| | C | EWMLD280-5 | EW Area Light with Type 5 Optics |
| | D | EWMLD280-3 | EW Area Light with Type 3 Optics (double 180 degree) |
| | F | | Energywise LED Spot Light |

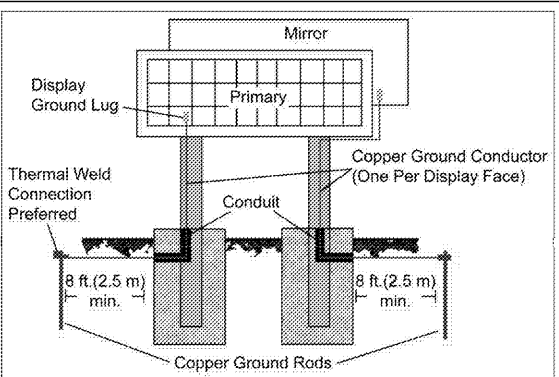

Figure 1: Grounding Detail Diagram

Ground Rod Quantities

This list gives the minimum number of ground rods needed for installation, based on quantity of displays and display configuration.

- Single Face, Qty. 1 = 1 Ground Rod
- Single Face (SF), Qty. 2 = 2 Ground Rods
- Two View (2V), Qty. 1 = 2 Ground Rods
- Double Face (DF), Qty. 1 = 2 Ground Rods

Important Points About Grounding

- Resistance to ground must be 10 ohms or less.
- Follow local and national codes.
- Support structure cannot be used as an earth-ground electrode.

A minimum of one grounding electrode for each display face is required.

DETAIL — SIGN GROUNDING
NO SCALE

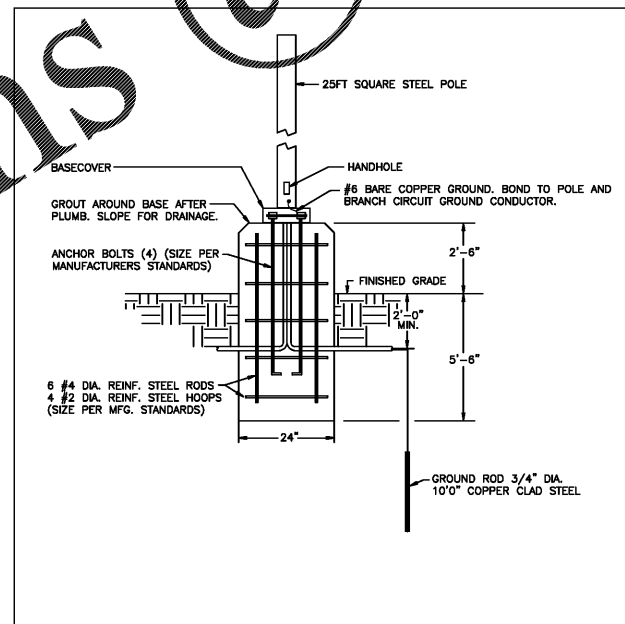

DETAIL — POLE BASE
NO SCALE

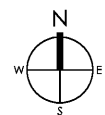
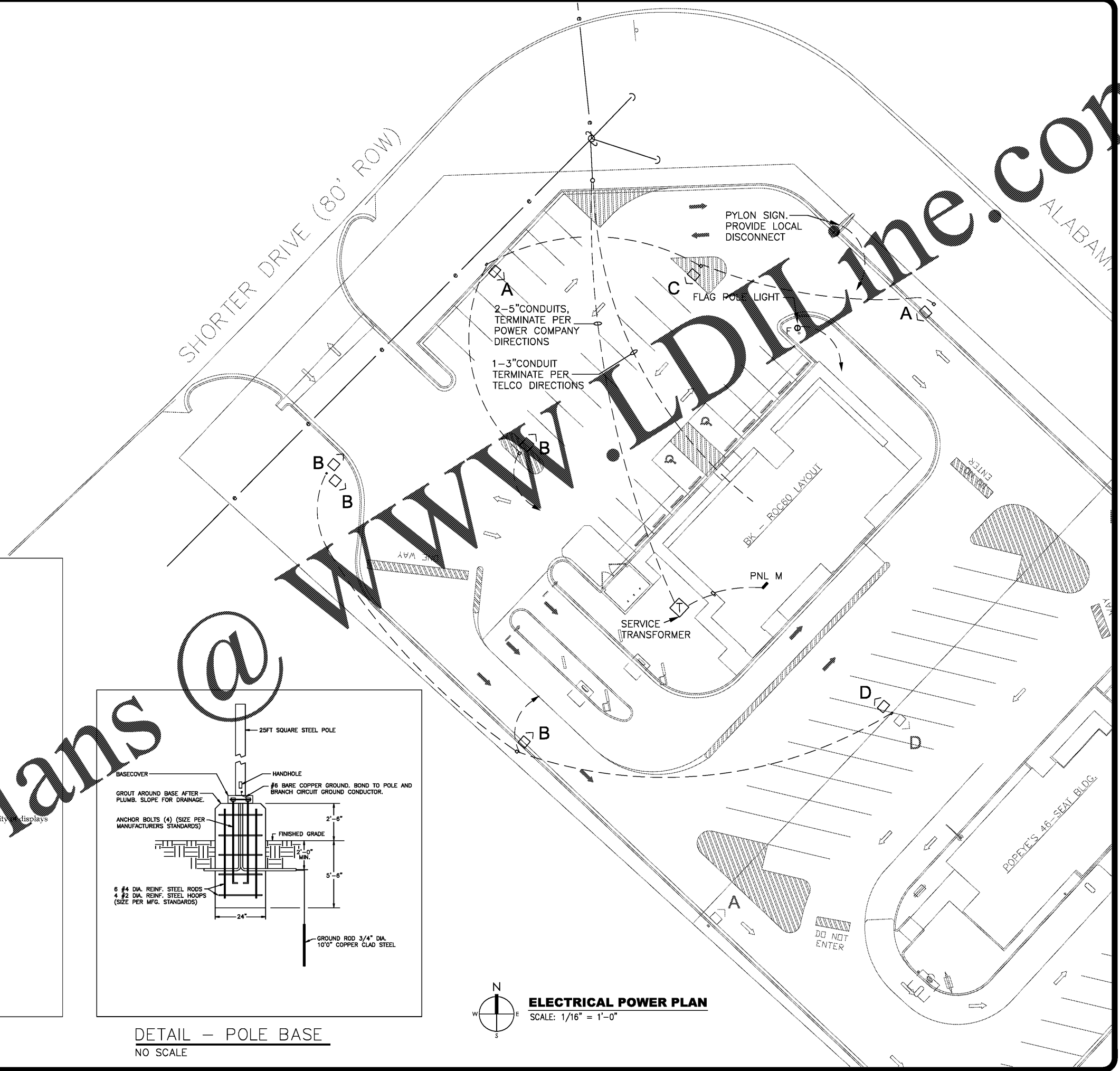

ELECTRICAL POWER PLAN
SCALE: 1/16" = 1'-0"

PROJECT #18026.18
ROC-60 20/20 MAGE, APRIL, 2015 DESIGN RELEASE
BURGER KING RESTAURANT
SHORTER, AL
SITE LIGHTING & SERVICE



PREMIER KINGS, INC.
5529 CARMICHAEL ROAD
MONTGOMERY, ALABAMA 36117
PHONE: (205) 322-1778
LINDSEY@BKBALABAMA.COM

2126 Morris Avenue
Birmingham, AL 35222
Phone: (205) 322-1751
Fax: (205) 322-1778
email: info@hpluata.com
www.hpluata.com

hendon huckestein architects, PC
architecture • planning • interior design



PROJECT #18026.18
ROC-60 20/20 MAGE, APRIL, 2015 DESIGN RELEASE
BURGER KING RESTAURANT
SHORTER, AL
SITE LIGHTING & SERVICE