

Order Plans

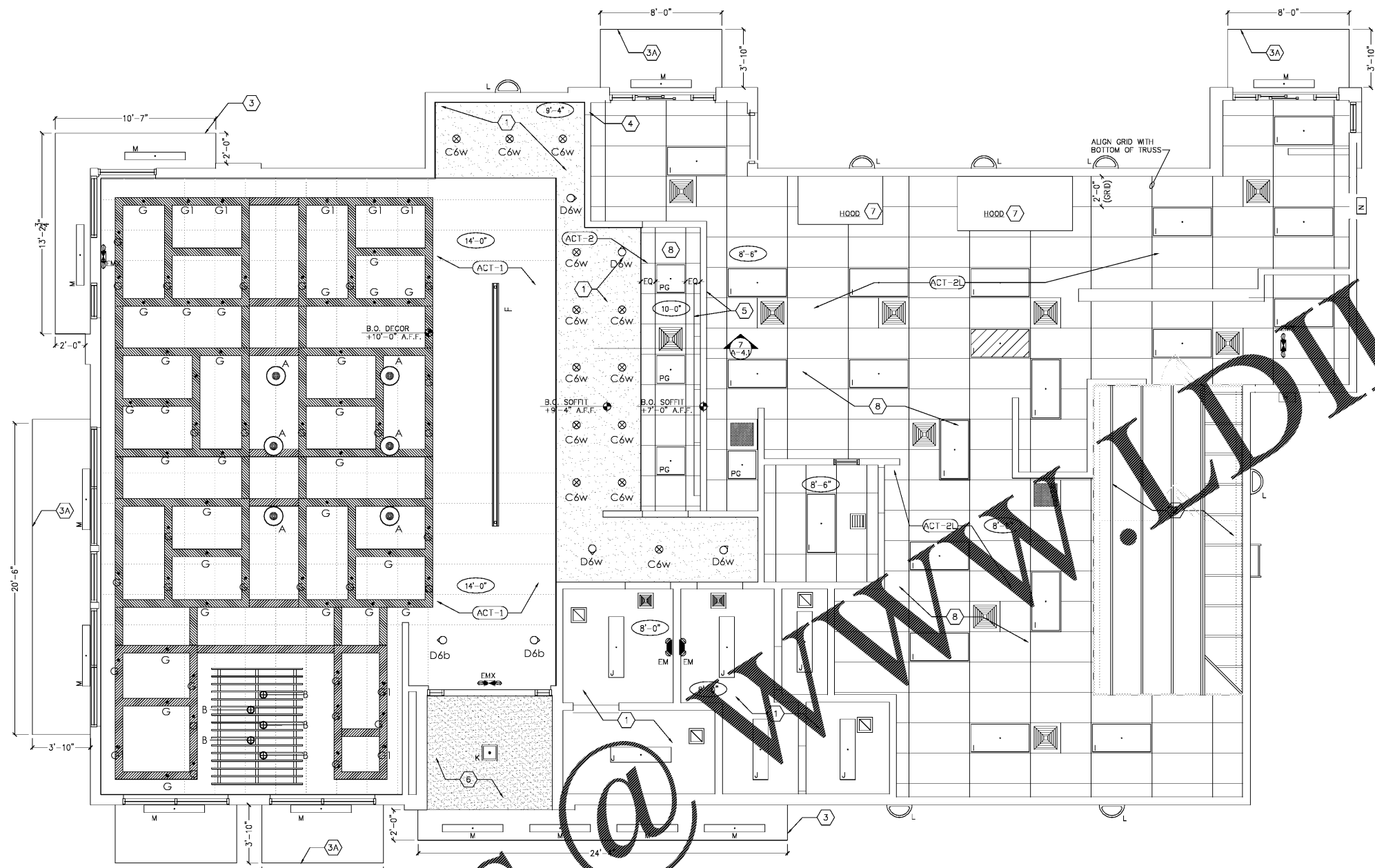

**REFLECTED CEILING PLAN**

SCALE: 1/4" = 1'-0"

NOTE:  
COORDINATE ALL REFLECTING CEILING PLAN ELEMENTS WITH THE INTERIOR DECOR DRAWINGS PROVIDED AS PART OF THIS SET. DETAILS, DECORATIVE LIGHT PLACEMENT, AND OTHER SUCH ITEMS ARE TO BE AS SHOWN ON INTERIOR DECOR.

NOTE:  
DINING ROOMS ARE DESIGNED TO A 35 - 40 FOOT-CANDLE LEVEL.  
KITCHENS ARE DESIGNED TO 50 FOOT-CANDLE LEVEL.  
RESTROOMS ARE DESIGNED TO 50 FOOT-CANDLE.

**GENERAL NOTES:**

- A. ALL DIMENSIONS SHOWN ON REFLECTED CEILING PLAN ARE FROM FACE OF WALL FINISH UNLESS NOTED OTHERWISE.
- B. THE REFERENCE HEIGHTS INDICATED ON PLAN ARE FROM FINISH FLOOR (F.F.).
- C. GENERAL CONTRACTOR TO COORDINATE DINING ROOM LIGHTING WITH APPROVED INTERIOR DECOR DRAWINGS.
- D. CONTRACTOR SHALL VERIFY FIXTURE QUANTITIES AND ALSO MAKE PROPER ADJUSTMENTS FOR ANY CHANGES IN PLAN DUE TO ADDITIONAL REQUIREMENTS, LOCAL CODES, ETC.
- E. FOR H.V.A.C. PLAN, SECTIONS, DUCT LOCATIONS, SUPPLY AND RETURN GRILLE SIZES AND ADDITIONAL INFORMATION, REFERENCE SHEET M-1.
- F. ALL FIXTURES SHALL BE LOCATED IN THE CENTER OF CEILING TILES UNLESS NOTED OTHERWISE.
- G. REFERENCE SHEET E-1 FOR LIGHTING LAYOUT REQUIREMENTS AND ADDITIONAL INFORMATION.
- H. REFERENCE INTERIOR DECOR SHEETS FOR FINISH SPECIFICATIONS.
- I. CONTRACTOR TO COORDINATE PENDANT LIGHT LOCATIONS WITH DECOR SUPPLIER DRAWINGS.

**KEYED NOTES:**

- (1) GYPSUM BOARD CEILING
  - (2) EXPOSED BRACES ABOVE WALK-IN BOX, REFER TO M.I.B. DRAWINGS FOR INTERIOR LIGHT FIXTURES
  - (3) FABRICATED METAL CANOPY
  - (4) FABRICATED METAL CANOPY OR AWNING
  - (5) STAINLESS STEEL SERVICE CHASE
  - (6) MENU BOARD AND HEADER. REFERENCE DTL 1/A-4.1
  - (7) SOFFIT ABOVE ENTRY.
  - (8) -CEILING PAINT TO MATCH INTERIOR CEILING IF VESTIBULE IS ENCLOSED.
  - (9) -CEILING PAINT TO BE EP-2 IF VESTIBULE IS OPEN. (REFER TO EXTERIOR FINISH SCHEDULE)
  - (10) MECHANICAL EXHAUST HOOD ABOVE
  - (11) SUSPENDED ACoustICAL TILE CEILING.
  - AT KITCHEN / SERVICE AREAS:  
USG 24" x 48" x 5/8" GYPSUM CEILING TILES #3270 (STIPPLE DESIGN, WASHABLE) VINYL FACED TO BE LAID IN EXPOSED WHITE ALUMINUM TEE GRID (NOT FIRE RATED CEILING) -OR-  
ARMSTRONG # 793 (24" x 48" x 5/8") GEORGIAN HIGHLY WASHABLE VINYL FACED TO BE LAID IN EXPOSED WHITE ALUMINUM TEE GRID (NOT FIRE RATED CEILING)
  - AT DINING AREAS:  
SEE INTERIOR DECOR
- NOTE: PROVIDE 24" x 24" TILES AT SERVICE COUNTER AREA.

**SYMBOLS LEGEND**

SYMBOL	DESCRIPTION	REF. SHEET
	SUPPLY AIR DIFFUSERS	M-1 FOR SPECIFICATIONS
	RETURN AIR GRILLES	
	EXHAUST FAN GRILLES	
A	PENDANT LIGHT	
B	PENDANT LIGHT	
C	PENDANT LIGHT RECESSED LIGHT	
D	RECESSED ADJUSTABLE WALL-WASH	
D1	TRACK LIGHT	
E	RECESSED 1X4 FIXTURE	
F	STRIP LED FIXTURE	
F1	RECESSED DOWN-LIGHT	
F2	RECESSED WALL-WASH DOWN-LIGHT	
G	2x4 RECESSED FLUORESCENT (NIGHT LIGHT WHEN SHOWN HATCHED)	
H	2x2 RECESSED FLUORESCENT	
K	12x12 RECESSED SOFFIT LIGHT	
L	SURFACE MOUNTED EXTERIOR WALL SCONCE (ALSO USED IN OPEN CANOPIES)	
M	WET LISTED 4'-0" FLUORESCENT (USED UNDER AWNINGS AND CLOSED CANOPIES)	
N	WALL MOUNTED SECURITY LIGHT	
EM	EMERGENCY LIGHT	
EMX	EXIT LIGHT	

DATE: 11/06/18  
DRAWN BY: MRW  
CHECKED BY: [Signature]  
NO. DATE: 11/06/18  
PROJECT: BURGER KING RESTAURANT  
RELEASED FOR CONSTRUCTION: [Signature]



PREMIER KINGS, INC.  
5529 CARMICHAEL ROAD  
MONTOMOERY, ALABAMA 36117  
PHONE: [Number]  
LINDSEY@KALABAMA.COM

2126 Monts Avenue, Sg  
Phone: (205) 322-1751  
Fax: (205) 322-1778  
email: info@hplha.com  
www.hplha.com

henderson huckestein architects, PC  
architecture • planning • interior design

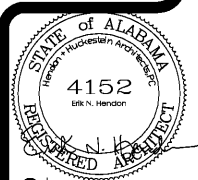

PROJECT # 18026.18  
ROC-60 20/20 WAIVE: APRIL 2015 DESIGN RELEASE  
**BURGER KING RESTAURANT**  
SHORTER, AL  
REFLECTED CEILING - OPTION 1