



310 MILLS AVE. GREENVILLE, SC 29605  
 864.242.9881  
 plans@narramore.net  
 © 2018 NARRAMORE ASSOCIATES, INC.  
 COPYRIGHT PROTECTED BY FEDERAL LAW



1597 DRY POND RD.  
 JEFFERSON, GA 30549  
 706.387.7722  
 FAX: 706.387.7701

**ALDI FOOD STORE # 61**  
 2589 Spring Road  
 Smyrna, GA 30080

**REVISIONS**

**PROJECT DATA**  
 V1.07 100x155 LW Expansion  
**PROJECT NUMBER**  
 18412  
**ISSUE DATE**  
 10-25-18

ALDI FOOD STORE #61  
 Smyrna, GA

**P-101**

PLUMBING PLAN  
 18228P101

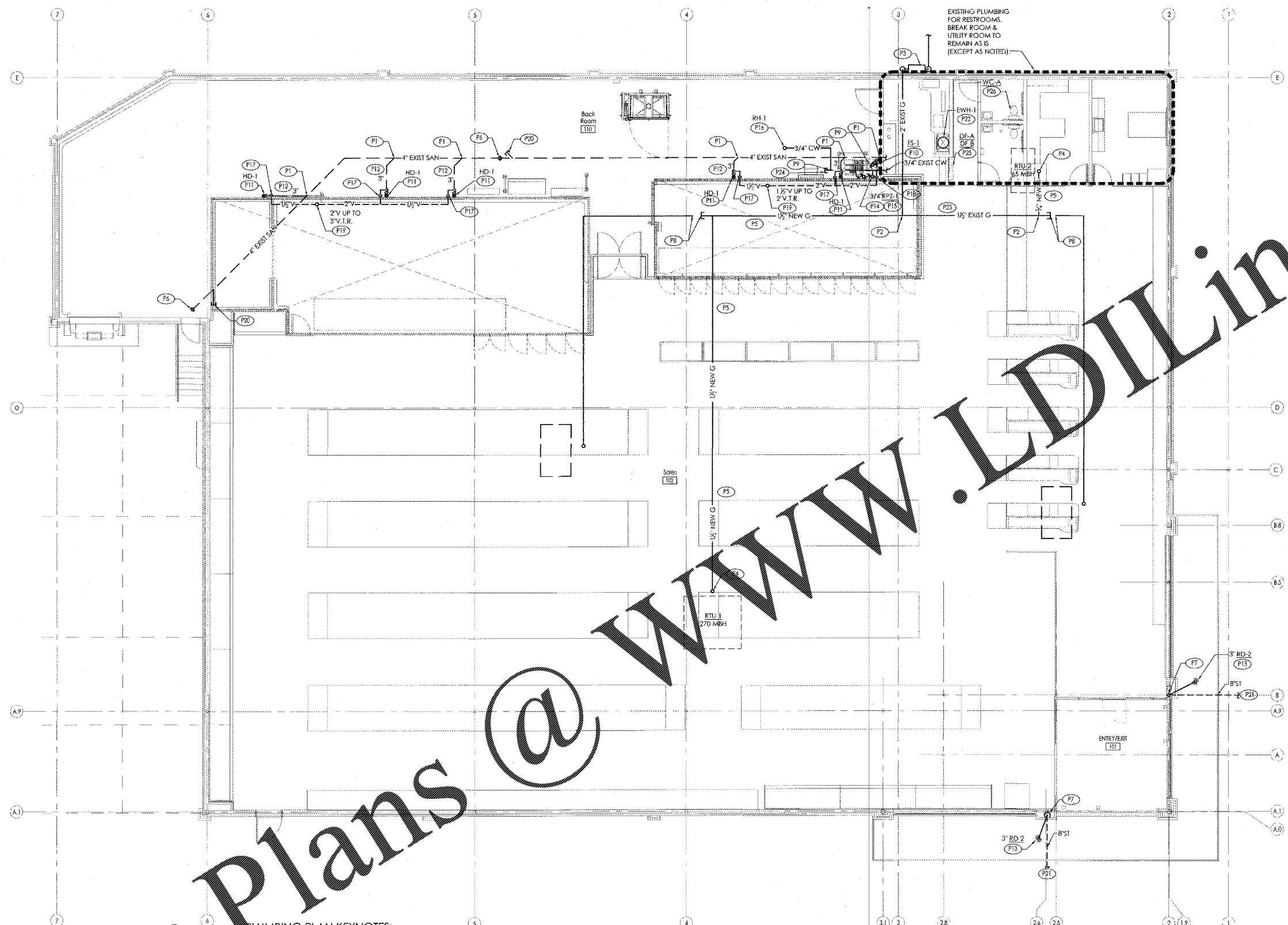

**PLUMBING PLAN KEYNOTES:**

- P1 TIE INTO EXISTING SANITARY SEWER LINE. FIELD VERIFY EXACT LOCATION.
- P2 TIE INTO EXISTING GAS PIPING AND ROUTE TO NEW RTU LOCATION. FIELD VERIFY EXACT TIE-IN LOCATION.
- P3 VERIFY EXISTING GAS METER TO BE MINIMUM CAPACITY OF 335 MBH. GAS REGULATOR SHALL BE 10" W.C.. MINIMUM INLET PRESSURE REQUIRED AT RTU'S IS 7" W.C.. REFER TO DETAIL B1/P-401.
- P4 PROVIDE GAS PIPING UP THRU ROOF TO RTU. PROVIDE WITH DIRT LEG AND ISOLATION SHUTOFF VALVE. MAKE FINAL CONNECTION TO UNIT.
- P5 PROVIDE GAS PIPING. ROUTE AT UNDERSIDE OF STEEL.
- P6 EXISTING FLOOR CLEAN OUT.
- P7 PROVIDE 3" PVC DOWNSPOUT FROM CANOPY TO 8" ST. BELOW GRADE. PROVIDE WALL CLEANOUT WITHIN PLASTER 24" ABOVE FINISHED GRADE.
- P8 REMOVE EXISTING UNUSED GAS PIPING AND CAP.
- P9 TIE INTO EXISTING WATER LINE. FIELD VERIFY EXACT LOCATION.
- P10 PROVIDE INDIRECT WASTE FROM EVAC SYSTEM TO 3" FS-1. COORDINATE WITH REFRIGERATION CONTRACTOR, G.C., AND ALDI FIELD REPRESENTATIVE SUCH THAT A CODE COMPLIANT AIR GAP IS MAINTAINED PRIOR TO ROUGH-IN.

- P11 PROVIDE 3" HUB DRAIN, HD-1, FOR COOLER/FREEZER CONDENSATE. COORDINATE WITH REFRIGERATION CONTRACTOR, G.C., AND ALDI FIELD REPRESENTATIVE SUCH THAT A CODE COMPLIANT AIR GAP IS MAINTAINED PRIOR TO ROUGH-IN. REFER TO DETAIL C2/P-401 AND LOCATION PLAN P-102.
- P12 PROVIDE SANITARY PIPING BELOW FLOOR.
- P13 PROVIDE ROOF DRAIN.
- P14 PROVIDE RIGID WATER PIPE SUPPORT ON EACH SIDE OF PIPING CHANGING DIRECTION UPSTREAM OF EVAC SYSTEM CONNECTIONS. INSTALL SHOCKSTOP AS CLOSE AS POSSIBLE TO QUICK CLOSING VALVES. PROVIDE UNSTRUT SUPPORT WITH HOLDRITE 257-P SIZES UNDER 1" PIPE SIZE AND 287-P SERIES 1" UP TO 2" PIPE SIZE STRUT CLAMP WITH ACCOUSTICAL PADS.
- P15 PROVIDE REDUCED PRESSURE ZONE ASSEMBLY AND 3/4" CW TO EVAC. SYSTEM; P.C. SHALL MAKE ALL FINAL CONNECTIONS. MOUNT RPZ-1 BETWEEN 30" AND 60" AFF.
- P16 PROVIDE ROOF HYDRANT AT A MINIMUM DISTANCE OF 4'-0" FROM ROOF HATCH OPENING.
- P17 PROVIDE 1/2" V UP. ROUTE TIGHT TO WALL.
- P18 PROVIDE 2" V UP. ROUTE TIGHT TO WALL.
- P19 PROVIDE VENT THROUGH ROOF.

- P20 ABANDONED EXISTING SS. REMOVE ALL ABANDONED SANITARY SEWER PIPING BACK TO NEAREST REMAINING LIVE BRANCH LINE AND PLUG OR CAP. REMOVE ALL EXISTING ABANDONED SANITARY VENT PIPING. REMAINING VENT OR SANITARY LINE AND PLUG OR CAP.
- P21 REFER TO SITE UTILITY DRAWINGS FOR CONTINUATION OF PIPING. P.C. SHALL MAKE FINAL CONNECTIONS TO SITE PIPING. COORDINATE WITH S.C. FOR CONNECTIONS.
- P22 REUSE EXISTING WATER HEATER (EWH-1) IF OWNER DEEMS REUSABLE. IF OWNER WANTS TO REPLACE, SEE EWH-1 SPECIFICATION ON P-501. SEE DETAIL A3/P-401 FOR EWH-1 PIPING DETAIL & HW & CW PIPING SCHEMATIC DOWN TO MOP SINK.
- P23 RAISE EXISTING GAS PIPING IN SALES UP TO ROOF DECK (AS REQUIRED).
- P24 REMOVE EXISTING UNUSED WATER PIPING AND CAP.
- P25 REPLACE EXISTING WATER FOUNTAIN WITH NEW. SEE DF-A & B SPECIFICATION ON P-501.
- P26 REPLACE EXISTING WATER CLOSET WITH NEW. SEE WC-A SPECIFICATION ON P-501.

**GAS NOTES:**

1. GAS METER BY UTILITY CO. 335 MBH TOTAL LOAD AND 10" W.C. MIN. AT GAS METER. PIPE SIZES BASED ON INTERNATIONAL FUEL GAS CODE TABLE 402.4(2). 0.5 INCH W.C. PRESSURE DROP. 0.60 S.G. GAS AND 200' EQUIVALENT LENGTH.
2. ALL GAS PIPING SHALL BE INSPECTED AND TESTED IN ACCORDANCE WITH THE REQUIREMENTS OF INTERNATIONAL FUEL GAS CODE SECTION 406.1.
3. GAS PIPING SHALL BE BLACK STEEL, ASTM A-120, STANDARD WEIGHT WITH THREADED ENDS. FITTINGS SHALL BE 150 LB. MALLEABLE IRON WITH THREADED CONNECTIONS. ALL 2" GAS PIPING AND LARGER SHALL BE WELDED PIPING AND WELDED FITTINGS.

Plumbing Plan  
 SCALE: 1/8" = 1'-0"

Order Plans @ WWW.LDILine.com