

SIDE DOCK AREA SUMMARY				
OCCUPANCY USE	ROOM NAME	SQUARE FOOTAGE	PRE REMODEL	V7.0 PROTOTYPE
MERCANTILE	SALES / VESTIBULE	13,023	10,289	12,106
	MEN'S ROOM	45	45	85
	WOMEN'S ROOM	64	64	83
	HALL	71	71	133
SUBTOTAL (MERCANTILE)		13,203	10,465	12,407
BUSINESS	OFFICE	198	198	252
	BREAK ROOM	165	165	304
	SUBTOTAL (BUSINESS)		363	363
STORAGE / STOCK	BACKROOM	2,823	2,422	3,171
	COOLER	1,236	1,014	1,317
	FREEZER	629	1,108	648
SUBTOTAL (STORAGE / STOCK)		4,688	4,544	5,136
SUBTOTAL (OCCUPANCIES)		18,254	15,372	18,099
EXTERIOR / INTERIOR WALLS / UNOCCUPIED SPACE		1,007	1,020	955
BUILDING SQUARE FOOTAGE		19,261	16,392	19,054
EXTERIOR CANOPY		736	966	733
TOTAL SQUARE FOOTAGE (INCLUDING CANOPY)		19,997	17,358	19,787

SIDE DOCK OPERATIONS DATA			
ITEM	REMODEL	PRE-REMODEL	V7.0 PROTOTYPE
LINEAR FOOTAGE OF BASE (PRODUCE INCLUDED)	840'-10"	768'	862'-4"
ASSUMED PALLET STORAGE	58	C.N.V.	62
BUILDING DIMENSIONS	118'-5" X 159'-6 3/4"	100'-0" X 155'-0"	119'-4" X 153'-4"
SALES FLOOR DIMENSIONS	76'-2" X 152'-10 3/4"	77'-6" X 128'-6 3/4"	74'-5" X 151'-1"
LENGTH OF MULTIDECK	116'	52'	96'
COOLER MILK DOORS	4	5	4
COOLER GENERAL DOORS	12	10	12
FREEZER GENERAL DOORS	16	24	16
SPOT MERCHANDISERS	6	C.N.V.	8
CART STORAGE	(119) MODEL 563W	C.N.V.	(119) MODEL 563W

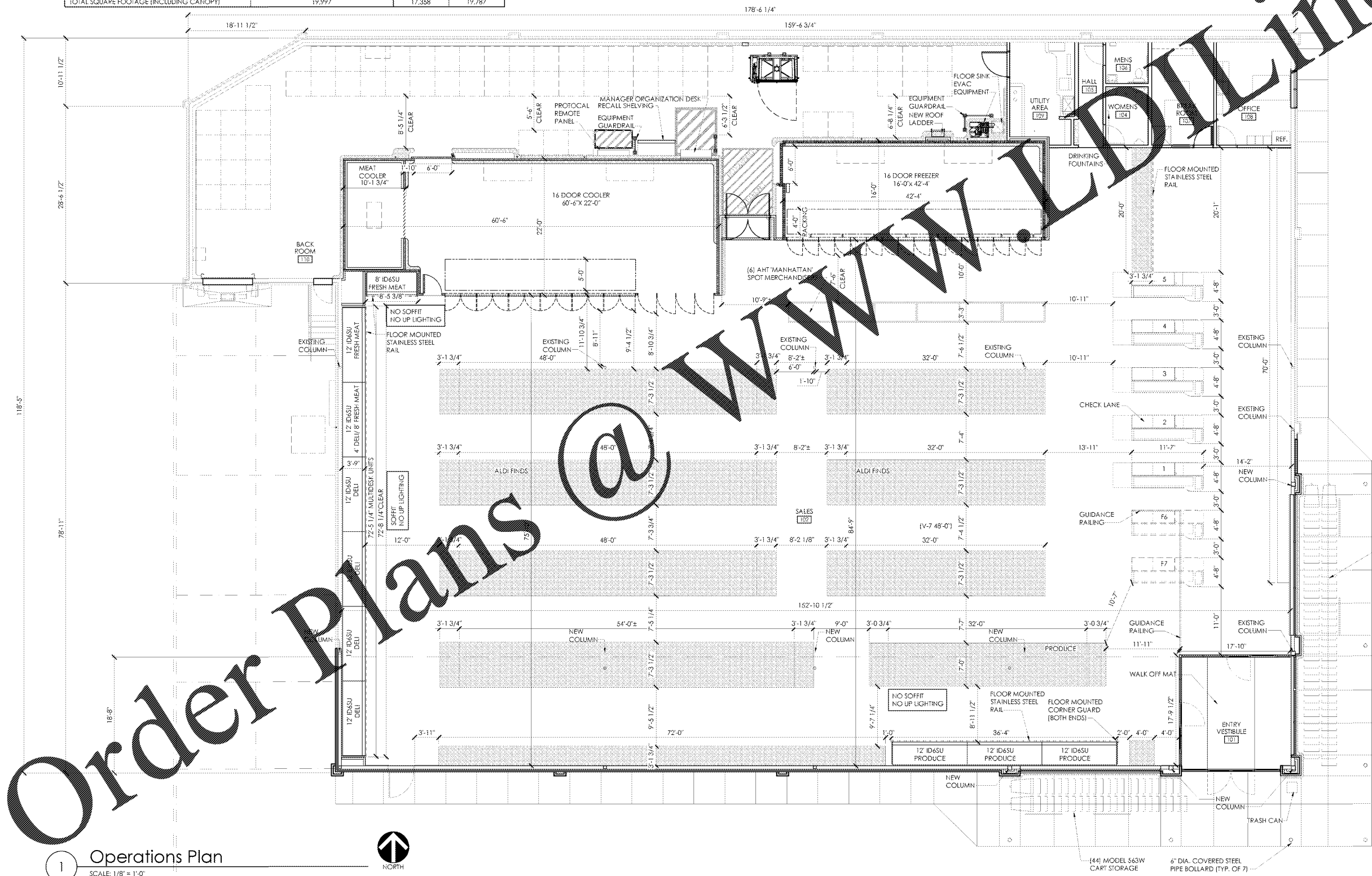

American Institute of Architects
 310 MILLS AVE. GREENVILLE, SC 29605
 864.242.9881
 plans@narramore.net
 © 2018 NARRAMORE ASSOCIATES, INC.
 COPYRIGHT PROTECTED BY FEDERAL LAW



- NOTES**
- THIS DRAWING IS FOR GENERAL FIXTURING LAYOUT AND REFERENCE TO EQUIPMENT ONLY. ALL INFORMATION IS FOR ALLOW OPERATIONAL USE ONLY AND SHALL NOT BE USED FOR CONSTRUCTION OR BIDDING PURPOSES.
 - ALL DIMENSIONS TO WALLS ARE TO FACE OF STUD.
 - ALL SHELVING DIMENSIONS ARE TO FACE OF GONDOLA.
 - THIS FACILITY DOES NOT CONTAIN A BAKERY, A BUTCHER, A DELI OR FISH COUNTER.
 - ALL FOOD IS PREPACKAGED. THERE IS NO ON SITE FOOD PREPARATION.
 - GONDOLA LOCATIONS ARE MEASURED FROM THE FACE OF THE STAINLESS STEEL PRICE TAG MOLDING (SSPTM).



1597 DRY POND RD.
 JEFFERSON, GA 30549
 706.387.7722
 FAX: 706.387.7701

ALDI FOOD STORE # 61
 2589 Spring Road
 Smyrna, GA 30080

REVISIONS

PROJECT DATA
 V1.07 100x155 LW Expansion
PROJECT NUMBER
 18412
ISSUE DATE
 10-25-18

ALDI FOOD STORE #61
 Smyrna, GA

A-131

1 Operations Plan
 SCALE: 1/8" = 1'-0"

