



INTERSECTION OF 1015 S BLVD & ALABAMA AVENUE  
BREVARD, GA 31110

PARCEL ID: Z52 0065

AMERICAN DAIRY QUEEN  
MINNEAPOLIS, MN U.S.A.  
REGISTERED U.S. PATENT OFFICE. AMERICAN DAIRY  
QUEEN CORPORATION. THIS DRAWING, ITS DESIGN  
DETAIL AND INVENTION ARE THE PROPERTY OF  
AMERICAN DAIRY QUEEN INC. (ADQ) AND SHALL NOT BE  
COPIED IN ANY MANNER NOR DISCLOSED TO ANY  
OUTSIDE PARTY WITHOUT ADQ CONSENT.

OUTDOOR FURNITURE SCHEDULE - MAUSAU (BM1) ORDERED BY FRANCHISEE,  
ASSEMBLED AND INSTALLED BY G.C.

CHAIR:  
SERIES: 2307  
OPT. ANCHOR KIT: T205  
COLOR: BLACK-80/MHWOOD-85  
BENCH SEAT:  
SERIES: 2228  
OPT. ANCHOR KIT: T205  
COLOR: BLACK-80/MHWOOD-85  
TABLE (24"x24"):  
TABLE: 1043, SURFACE MOUNT  
COLOR: BLACK-80/MHWOOD-85  
TABLE (36"x36"):  
TABLE: 1076, SURFACE MOUNT  
COLOR: BLACK-80/MHWOOD-85  
ADA TABLE (36"x36"):  
TABLE: 1079, SURFACE MOUNT  
COLOR: BLACK-80/MHWOOD-85  
TABLE (36"x57"):  
TABLE: 1075, SURFACE MOUNT  
COLOR: BLACK-80/MHWOOD-85

ACCESSORIES

(BM3) BENCH: MF2221  
MAUSAU: T205  
OPT. ANCHOR KIT: BLACK-80  
(BM4) TRASH RECEPTACLE W/RAIN BONNET:  
MAUSAU: MF3302  
COLOR: BLACK-80

UMBRELLA OPTIONS  
UMBRELLA- HEAVY DUTY, RIGID FRAME FIXED CANVAS:  
MANUFACTURER: BARABOO ANNING  
SERIES: FERRARI SOLTIS  
FABRIC COLOR(S): JOCKEY RED  
FRAME/POLE COLOR: BLACK  
NOTE: INSTALL PER MANUFACTURERS INSTRUCTIONS,  
UMBRELLA MUST BE ANCHORED/BOLTED TO TABLE  
UMBRELLA- HEAVY DUTY, COLLAPSABLE CANVAS:  
MANUFACTURER: TUGCI  
SERIES: UDGT.0HEX5403NO  
FABRIC COLOR(S): JOCKEY RED  
INCLUDE BASE/ANCHOR  
UMBRELLA- STANDARD DUTY, COLLAPSABLE CANVAS:  
MANUFACTURER: FLYMOLD  
SERIES: MC4T20-015841 (7" DIA)  
FABRIC COLOR(S): JOCKEY RED  
BASE: MC2239848-0150

(BM5) CIGARETTE SNUFFER, (OPTIONAL)  
MAUSAU: MF4012  
COLOR: BLACK-80  
(BM6) AGGREGATE TRASH RECEPTACLE, (OPTIONAL)  
DANN ENTERPRISES: R5395  
COLOR: NATURAL BROWN  
(BM7) AGGREGATE TRASH HOOD, (OPTIONAL)  
DANN ENTERPRISES: TP35H 4 TP35C  
COLOR: BLACK

OUTDOOR FURNITURE SCHEDULE - PLYMOLD (BM2)

CHAIR:  
SERIES: 2051100-0450  
FINISH: CHARCOAL  
TABLE (24"x30"):  
SERIES: SLBB243015DQ  
FINISH: CHARCOAL  
TABLE (46"x9"):  
SERIES: SLBB460015DQ  
FINISH: CHARCOAL  
TABLE (36"x9"):  
SERIES: SLBB360015DQ  
FINISH: CHARCOAL  
TABLE (30"x9"):  
SERIES: SLBB300015DQ  
FINISH: CHARCOAL  
TABLE (30"x30"):  
SERIES: SLBB303015DQ  
FINISH: CHARCOAL  
TABLE (36"x36"):  
SERIES: SLBB363615DQ  
FINISH: CHARCOAL

ACCESSORIES

(BM3) BENCH: MF2221  
MAUSAU: T205  
OPT. ANCHOR KIT: BLACK-80  
(BM4) TRASH RECEPTACLE W/RAIN BONNET:  
MAUSAU: MF3302  
COLOR: BLACK-80

UMBRELLA OPTIONS  
UMBRELLA- HEAVY DUTY, COLLAPSABLE CANVAS:  
MANUFACTURER: TUGCI  
SERIES: UDGT.0HEX5403NO  
FABRIC COLOR(S): JOCKEY RED  
INCLUDE BASE/ANCHOR  
UMBRELLA- STANDARD DUTY, COLLAPSABLE CANVAS:  
MANUFACTURER: FLYMOLD  
SERIES: MC4T20-015841 (7" DIA)  
FABRIC COLOR(S): JOCKEY RED  
BASE: MC2239848-0150

(BM5) CIGARETTE SNUFFER, (OPTIONAL)  
MAUSAU: MF4012  
COLOR: BLACK-80  
(BM6) AGGREGATE TRASH RECEPTACLE, (OPTIONAL)  
DANN ENTERPRISES: R5395  
COLOR: NATURAL BROWN  
(BM7) AGGREGATE TRASH HOOD, (OPTIONAL)  
DANN ENTERPRISES: TP35H 4 TP35C  
COLOR: BLACK

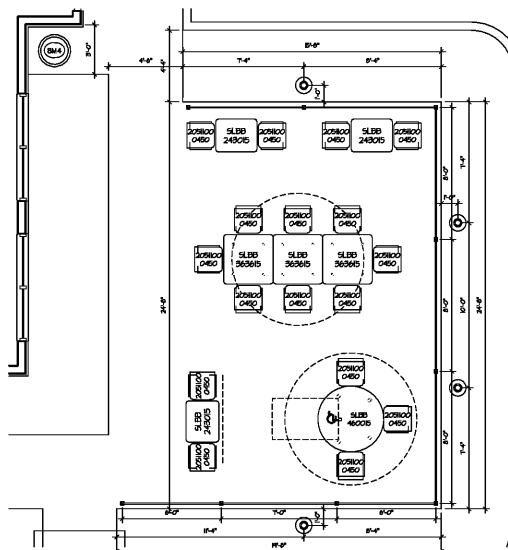
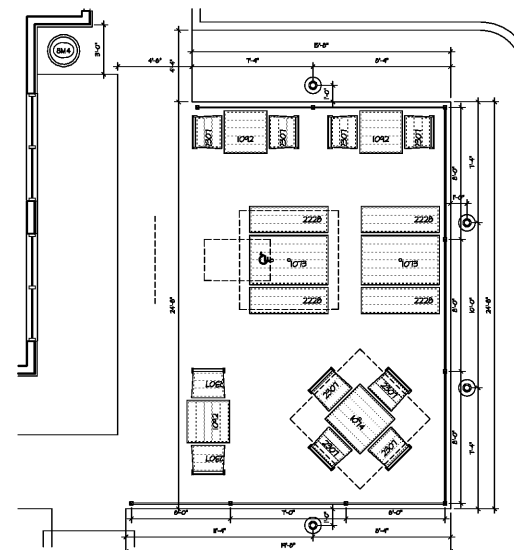

1 PATIO LAYOUT  
A1.3 SCALE: 3/16" = 1'-0"

2 OPTIONAL PATIO LAYOUT  
A1.3 SCALE: 3/16" = 1'-0"

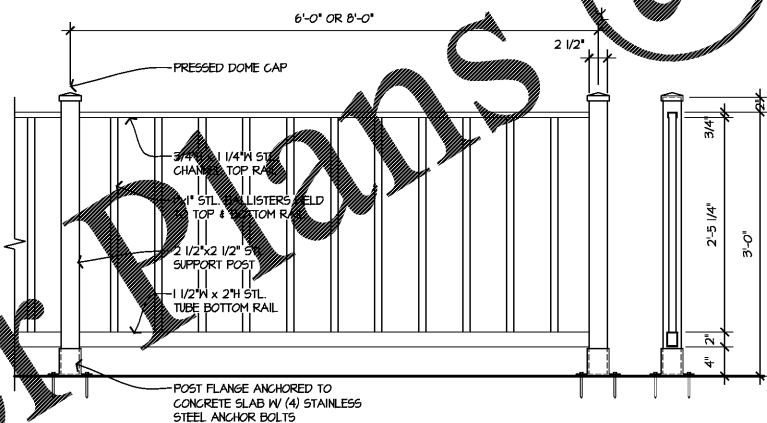

FABRICATION/FINISH OPTIONS:  
A) HIGHTIGHT IRON ALL WELDED  
CONSTRUCTION WITH PAINT FINISH,  
BLACK (HIGH PERFORMANCE  
ACRYLIC).  
B) ALUMINUM ALL WELDED  
CONSTRUCTION, FINISH BLACK  
ANODIZED.  
C) FORTRESS BRAND (BLACK)  
RAILINGS AVAILABLE THROUGH  
H.J.C., SEE ADQ PRIMARY VENDORS  
LIST.

3 NOT USED  
A1.3

4 PATIO FENCE DETAIL  
A1.3 SCALE: 1" = 1'-0"

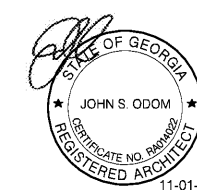

GEORGIA ARCHITECT LICENSE  
NUMBER RA014022

SPECIAL NOTICES  
In the event the client consents to, allows, authorizes or  
approves of changes to any plans, specifications or other  
construction documents, and these changes are not approved  
in writing by the design professional, the client recognizes that  
such changes and the results thereof are not the responsibility  
of the design professional. Therefore, the client agrees to  
release the design professional from any liability arising from  
the construction, use or result of such changes. In addition,  
the client agrees to the fullest extent permitted by law, to  
indemnify and hold the design professional harmless from any  
damages, liability or cost (including reasonable attorneys fees  
and costs of defense) arising from such changes. Copyright ©  
2018 by John S. Odum, Architect. All rights reserved. No part  
of this drawing may be reproduced by photocopy or by any  
other means, or stored, processed, or transmitted in or by any  
computer or other systems without the prior written permission  
of the Architect.

ISSUE DATE: 11-01-18

REVISION DATE:

11-01-18 ORIGINAL ISSUE

PATIO PLAN

SHEET NUMBER:  
A1.3