

PARKING SPACE DETAIL
NOT TO SCALE

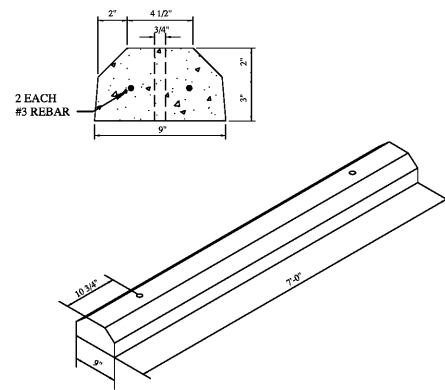

PARKING BLOCK DETAIL
NOT TO SCALE

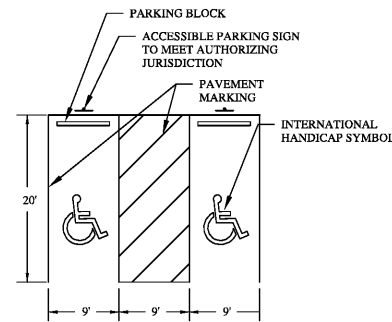

ACCESSIBLE PARKING SPACE DETAIL
NOT TO SCALE

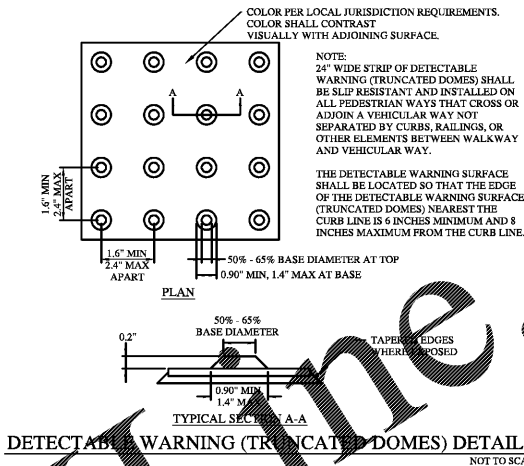

DETECTABLE WARNING (TRUNCATED DOMES) DETAIL
NOT TO SCALE

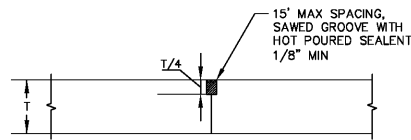

SAWED TRANSVERSE JOINT
NOT TO SCALE

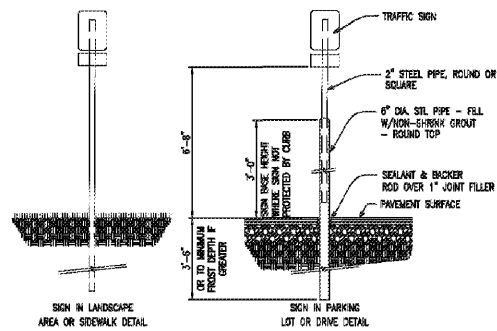

SIGN POST DETAIL
NOT TO SCALE



ACCESSIBLE PARKING SIGN DETAIL
NOT TO SCALE

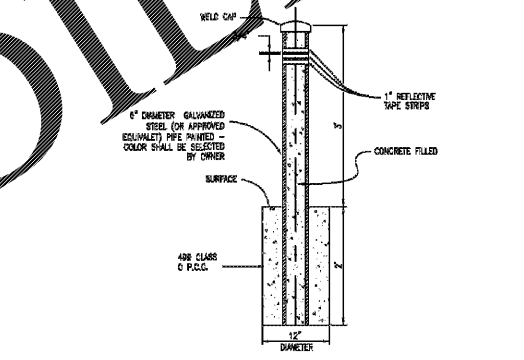

PIPE BOLLARD DETAIL
NOT TO SCALE

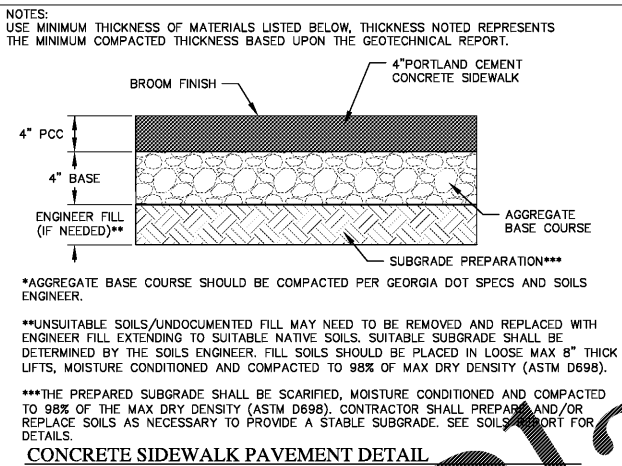

CONCRETE SIDEWALK PAVEMENT DETAIL
NOT TO SCALE

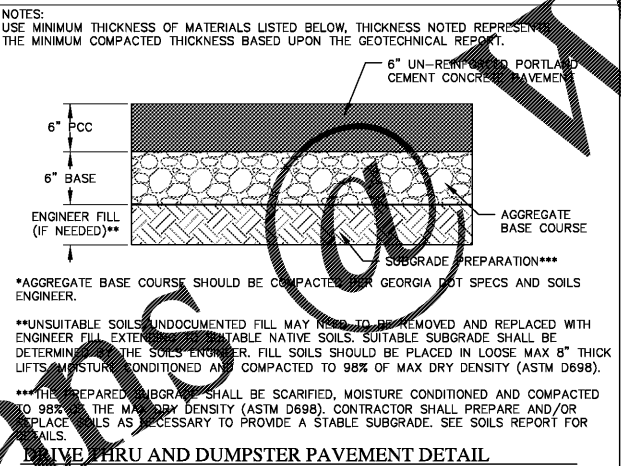

PAVEMENT THRU AND DUMPSTER PAVEMENT DETAIL
NOT TO SCALE

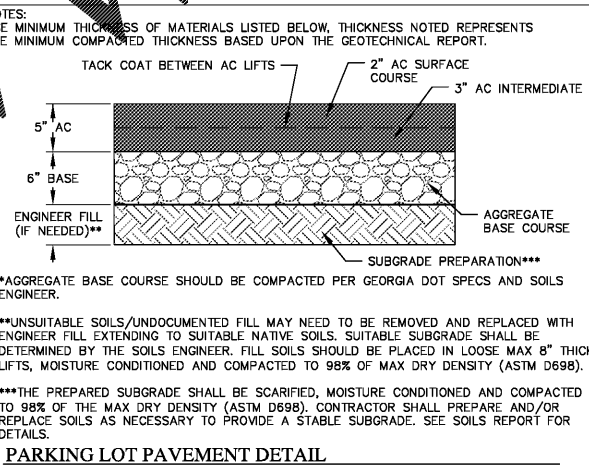

PARKING LOT PAVEMENT DETAIL
NOT TO SCALE

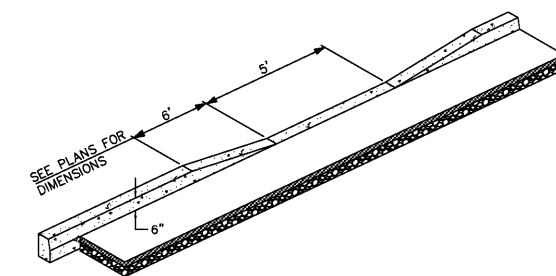

CURB TAPER DETAIL
NOT TO SCALE

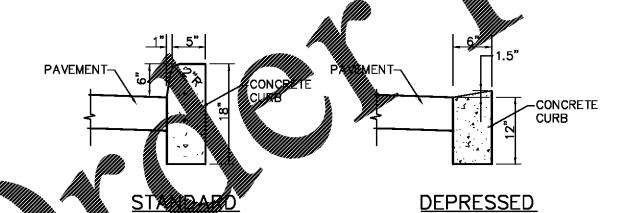

CONCRETE BARRIER CURB DETAIL
NOT TO SCALE

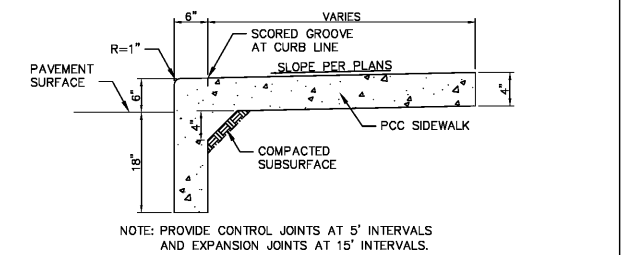

TURN DOWN CURB AND SIDEWALK
NOT TO SCALE

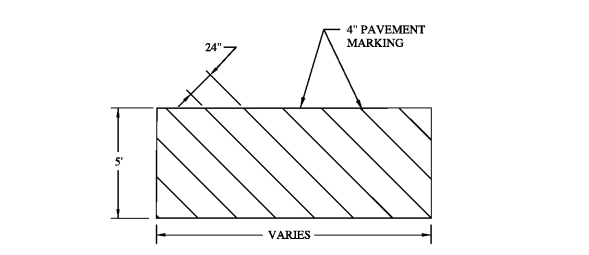

PEDESTRIAN ACCESS PAVEMENT MARKING DETAIL
NOT TO SCALE

Architect:
JOHN S. REYLING
ARCHITECT
100 JEFFREY REYLING DRIVE
SMITHTON, ILLINOIS 62285
TEL: 618.228.2632
FAX: 618.228.2632
WWW.REYLINGDESIGN.COM
E-MAIL: JOHN@REYLINGDESIGN.COM

Civil Engineer:
REYLING DESIGN & CONSULTING
4516 Boardwalk | Smithton, IL | 62285
reylingdc@gmail.com

GEORGIA REGISTERED PROFESSIONAL ENGINEER
No. PE041448
TODD JEFFREY REYLING
LICENSE EXPIRES - 12.31.2018
DATE SIGNED - 10.30.2018

ENGINEER OF RECORD:
Todd J. Reyling, PE
Georgia PE 041448

ISSUED / REVISED DATE
ISSUED FOR REVIEW 10.30.2018

PROJECT NUMBER: 18-163

New Ground Up Building:
DAIRY QUEEN
Alabama Ave. & Davis Road
Bremen, GA 30110
Carroll County

Construction Details
C703

Order Plans @ WWW.WORLDLINE.COM