

STORMWATER MANAGEMENT NOTE:

PER THE CITY OF BREMEN REQUIREMENTS, THE STORMWATER FLOWS OF THE NEW DAIRY QUEEN PROJECT WERE CONSIDERED. PER THE EXISTING SITE CONDITIONS AND SIZE NO ON-SITE DETENTION/RETENTION WILL BE PROVIDED.

STORM DRAIN KEY NOTES:

- 1 PROPOSED STORM DRAIN INLET IN PAVEMENT AREAS, STORM DRAIN INLETS SHALL HAVE TRAFFIC RATED CAST IRON FRAME WITH SITE CAST CONCRETE
- 2 PROPOSED STORM PIPE CONNECTION TO EXISTING STORM SEWER. CONTRACTOR TO COORDINATE WITH THE CITY OF BREMEN FOR CONNECTION POINT.
- 3 EXISTING STORM INLET TO REMAIN - CONTRACTOR TO PROTECT IN PLACE.

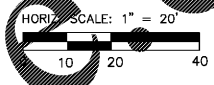
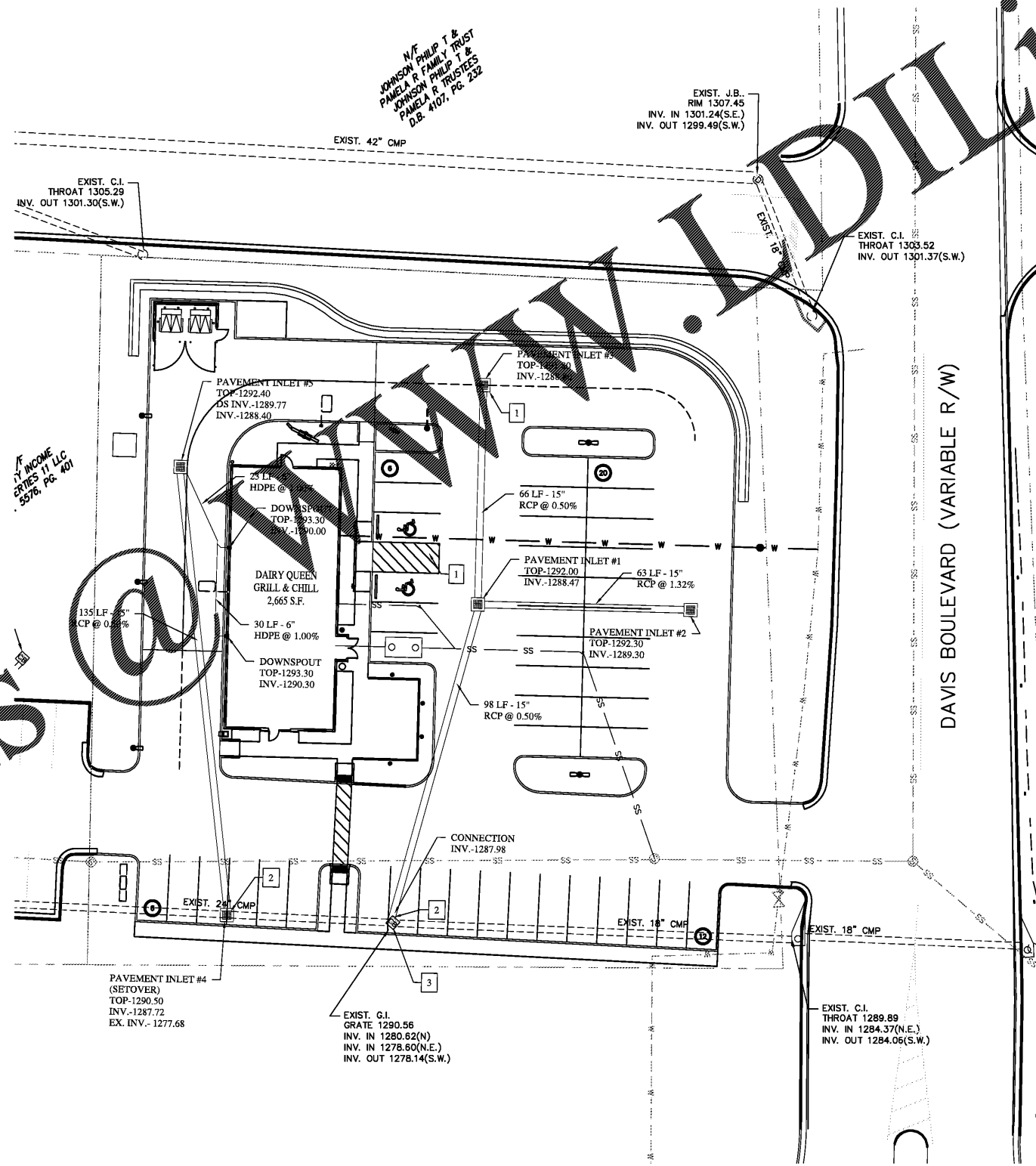

Architect:
 JOHN S. ... ARCHITECTS
 98 N. ...
 ...

Civil Engineer:
RDC
 REYLING DESIGN & CONSULTING
 4516 Boardwalk | Smithton, IL | 62285
 reylingdc@gmail.com



LICENSE EXPIRES - 12.31.2018
 DATE SIGNED - 10.30.2018

ENGINEER OF RECORD:
 Todd J. Reyling, PE
 Georgia PE 041448

ISSUED / REVISED	DATE
ISSUED FOR REVIEW	10.30.2018

PROJECT NUMBER: 18-163

New Ground Up Building:
DAIRY QUEEN
 Alabama Ave. & Davis Road
 Bremen, GA 30110
 Carroll County

Stormwater
 Drainage Plan
C400

Order Plans