

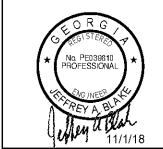

RULE JOY TRAMMELL RUBIO
 ARCHITECTURE | INTERIOR DESIGN
 300 Galleria Parkway Suite 740 Atlanta, Georgia 30329
 770-661-1492 (phone) 770-661-1493 (fax)
 www.rjtdesign.com

PRINTED
 DATE 11/01/18
 ISSUE/REVISION ISSUED FOR PERMIT

JB Electrical Design, P.C.
 Electrical Consulting Engineers
 9330 Birchmont
 Minneapolis, MN 55445
 763-486-0965
 jrb@jbelectricaldesign.com
 MELE Reg. No. 2013-062
 ©2018 by JB Electrical Design, P.C.



LEVEL ONE FLOOR PLAN - FIRE ALARM
EXTENDED STAY AMERICA
 POOLER, GA

COMMISSION NO: 18-120-00
 DRAWING NO:
E501

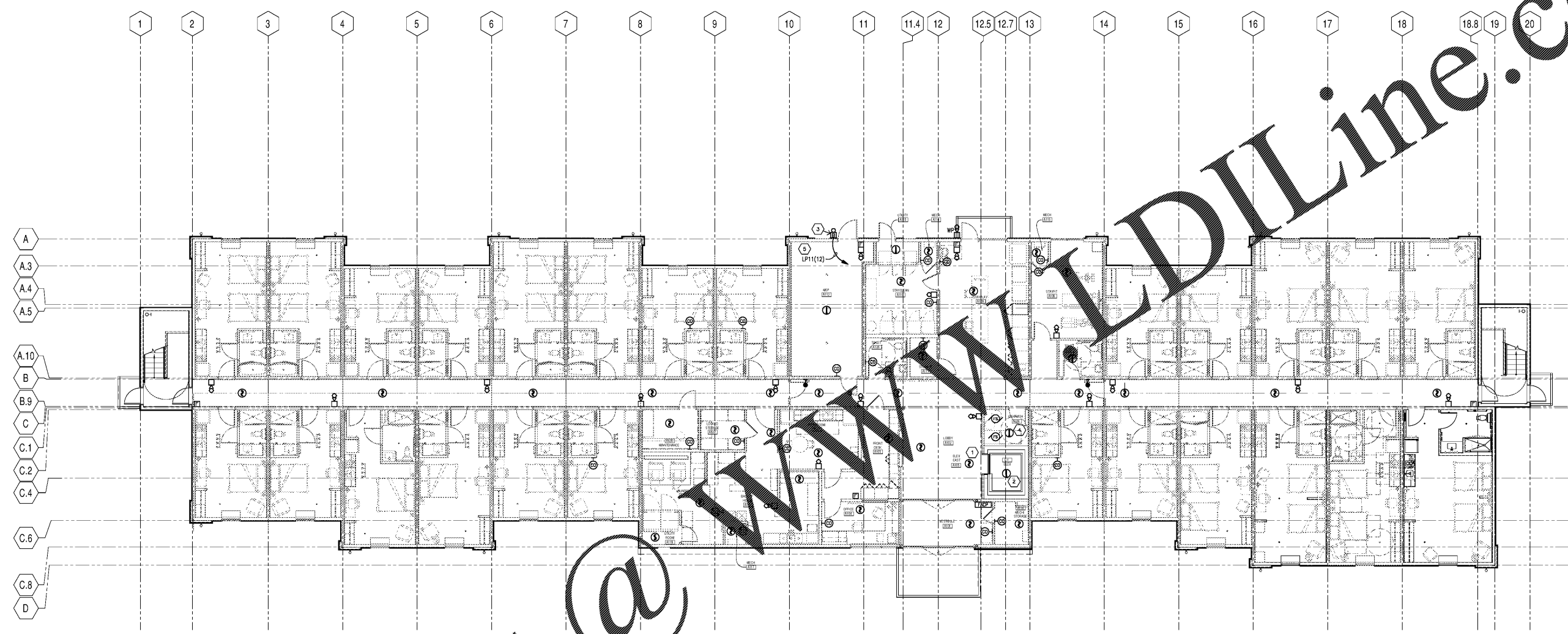

LEVEL ONE FLOOR PLAN - FIRE ALARM
 E501 1/8" = 1'-0"

- SHEET NOTES**
- 1 SMOKE DETECTOR FOR ELEVATOR CAPTURE.
 - 2 INSTALL HEAT DETECTOR IN ELEVATOR PIT PER NFPA 72, WHERE A SPRINKLER HEAD IS INSTALLED.
 - 3 SPRINKLER BELL. COORDINATE LOCATION WITH SPRINKLER CONTRACTOR.
 - 4 PROVIDE ALL REQUIRED DEVICES TO INTERFACE FIRE/SMOKE DAMPERS WITH FIRE ALARM SYSTEM PER NFPA 72 AND FOR PROPER OPERATION TO COMPLY WITH CODE.
 - 5 PROVIDE MONITORING OF SPRINKLER SYSTEM TAMPER AND FLOW SWITCHES PER NFPA 72. COORDINATE WITH SPRINKLER CONTRACTOR.

- GENERAL NOTES**
- A. SEE DRAWING E801 AND E901 FOR DETAILS.
 - B. SEE ARCHITECTURAL DRAWINGS FOR WALL TYPES. SEAL ALL WALL PENETRATIONS WITH APPROPRIATE SEALANT. COORDINATE FIRE PROOFING REQUIREMENTS FOR PENETRATIONS AND PROVIDE UL LISTED FIRESTOP SYSTEM AS REQUIRED.
 - C. COORDINATE MOUNTING HEIGHTS OF DEVICE WITH ARCHITECTURAL ELEVATIONS.
 - D. ADDITIONAL FIRE ALARM REQUIREMENTS ARE SHOWN ON THE LARGE SCALE ROOMS PLANS.
 - E. REFER TO RESPONSIBILITY MATRIX FOR INFORMATION REGARDING CO DETECTORS AND FIRE ALARM SYSTEM. CO DETECTORS SHOULD BE INSTALLED AT LEAST 5'-FT FROM A FUEL BURNING APPLIANCE AND AT LEAST 6'-FT ABOVE FINISHED FLOOR. INSTALL PER NFPA 72.
 - F. PROVIDE COMMUNICATIONS FOR HEARING IMPAIRED ROOMS. SEE LARGE SCALE GUEST ROOM DRAWINGS ON E411.
 - G. COORDINATE SMOKE DETECTOR LOCATIONS WITH CEILING ELEMENTS. DO NOT INSTALL ON ACCESS PANELS.
 - H. DO NOT INSTALL CONDUITS EXPOSED ON EXTERIOR OF BUILDING. CONDUITS SHOWN ARE TO PROVIDE DESIGN INTENT OF CIRCUITING AND CONTROL.
 - I. REFER TO RESPONSIBILITY MATRIX FOR INFORMATION REGARDING CO DETECTORS AND FIRE ALARM SYSTEM. CO DETECTORS SHOULD BE INSTALLED AT LEAST 5'-FT FROM A FUEL BURNING APPLIANCE AND AT LEAST 6'-FT ABOVE FINISHED FLOOR. INSTALL PER NFPA 72.
 - J. FIRE ALARM VISUAL DEVICES ARE RATED FOR 15CD UNLESS NOTED OTHERWISE.

Order Plans @

WWW.DIline.com