



RULE JOY TRAMMELL | RUBICOR DESIGN
 ARCHITECTURE | INTERIOR DESIGN

300 Galleria Parkway Suite 740 Atlanta Georgia 30303
 770-661-1492 (phone) 770-661-1493 (fax)
 www.rjttr.com

PRINTED	
DATE 11/01/18	ISSUE/REVISION Issued for Permit



ENLARGED LOBBY AREA PLAN
 EXTENDED STAY AMERICA
 COMMISSION NO: 18-274-G
 DRAWING NO:

FOOLER, GA

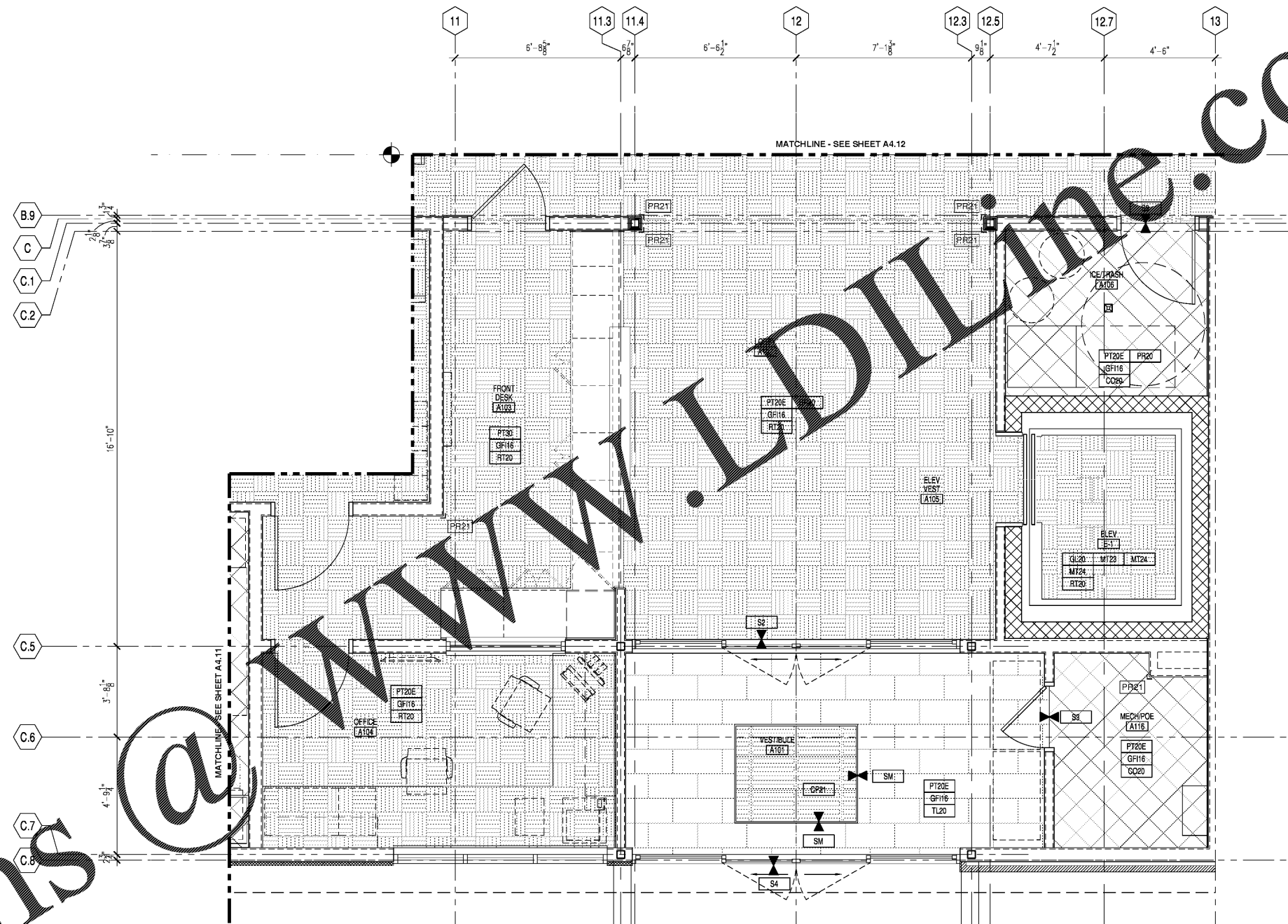

1 ENLARGED LOBBY AREA PLAN
 Scale: 1/2"=1'-0"

FINISH FLOOR LEGEND

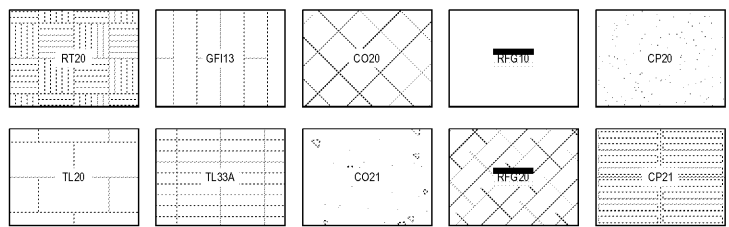

FINISH FLOOR PLAN SYMBOL LEGEND

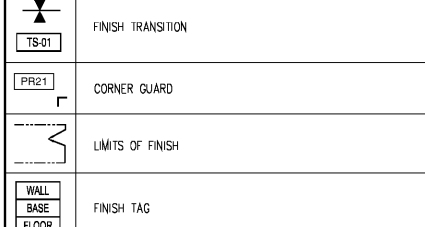

GENERAL NOTES

- DIMENSIONS ARE TO FACE OF STUD.
- REFER TO A3.01 - A3.09 FOR ENLARGED GUESTROOM PLANS.
- REFER TO INTERIOR ELEVATIONS FOR EXTENT OF WALL FINISHES.
- REFER TO AT.06 & AT.07 FOR FINISH MATERIAL DESIGNATIONS.
- REFER TO A9.02 FOR TRANSITION TYPES.
- PROVIDE RUBBER STAIR TREAD & RISER FINISH AT STAIRS, U.N.O. ON FINISH PLANS.
- PROVIDE FIRE-RATED PLYWOOD WALLS AT MDF & IDF ROOMS AND PAINT AS SCHEDULED ON FINISH PLANS.
- WALK-OFF MAT TRANSITION (SM) PROVIDED BY MANUFACTURER.
- PROVIDE PAINT (PT20E) FOR ALL DOORS (U.N.O.), ELECTRICAL PANELS, WALL VENTS, ACCESS PANELS, WINDOW SILLS, AND GUESTROOM BATHROOM DOOR FRAME.

Order Plans @

WWW.IDDLINE.COM

ISSUED FOR CONSTRUCTION

A4.10